



Designation: **E2273–03 (Reapproved 2011) E2273 – 18**

Standard Test Method for Determining the Drainage Efficiency of Exterior Insulation and Finish Systems (EIFS) Clad Wall Assemblies¹

This standard is issued under the fixed designation E2273; the number immediately following the designation indicates the year of original adoption or, in the case of revision, the year of last revision. A number in parentheses indicates the year of last reapproval. A superscript epsilon (ϵ) indicates an editorial change since the last revision or reapproval.

1. Scope

1.1 This test method determines the drainage efficiency of EIFS clad wall assemblies when subjected to a water spray rate in accordance with Test Method **E331**.

1.2 The values stated in SI units are to be regarded as the standard. The values given in parentheses are mathematical conversions to inch-pound units that are provided for information only and are not considered standard.

1.3 *This standard may involve hazardous materials, operations and equipment. This standard does not purport to address all of the safety concerns, if any, associated with its use. It is the responsibility of the user of this standard to establish appropriate safety, health, and environmental practices and determine the applicability of regulatory limitations prior to use.*

1.4 *This international standard was developed in accordance with internationally recognized principles on standardization established in the Decision on Principles for the Development of International Standards, Guides and Recommendations issued by the World Trade Organization Technical Barriers to Trade (TBT) Committee.*

2. Referenced Documents

2.1 *ASTM Standards:*²

E331 Test Method for Water Penetration of Exterior Windows, Skylights, Doors, and Curtain Walls by Uniform Static Air Pressure Difference

E2110 Terminology for Exterior Insulation and Finish Systems (EIFS)

3. Terminology

3.1 Definitions used in this standard shall be in accordance with Terminology **E2110**.

3.2 *Definitions of Terms Specific to This Standard:*

3.2.1 *drainage efficiency*—a percentage value based on the amount of water that passed through the test specimen and was collected divided by the amount of water sprayed into the slot fault.

3.2.2 *test specimen*—the entire assembled unit submitted for testing as described in Section 7.

3.2.3 *test specimen slot fault*—an opening in the test specimen where the insulation board, and other components have been removed exposing the weather-resistive barrier to which water spray is directed.

3.2.4 *water drainage*—the ability of the test specimen to drain water.

4. Summary of Test Method

4.1 This test method consists of sealing a spray box to the test specimen and then concentrating a water spray into the slot fault of the test specimen.

5. Significance and Use

5.1 This test method is a standard procedure for determining the drainage efficiency of an EIFS clad wall assembly.

¹ This test method is under the jurisdiction of ASTM Committee **E06** on Performance of Buildings and is the direct responsibility of Subcommittee **E06.58** on Exterior Insulation and Finish Systems (EIFS).

Current edition approved April 1, 2011; Sept. 1, 2018. Published May 2011; September 2018. Originally approved in 2003. Last previous edition approved in 2003 as **E2273–03**; **E2273–03** (2011). DOI: 10.1520/E2273-03R11; 10.1520/E2273-18.

² For referenced ASTM standards, visit the ASTM website, www.astm.org, or contact ASTM Customer Service at service@astm.org. For *Annual Book of ASTM Standards* volume information, refer to the standard's Document Summary page on the ASTM website.

6. Apparatus

6.1 *Spray Box*, a transparent plastic, or equivalent, box measuring 622 by 241 by 184 mm (24½ by 9½ by 7¼ in.) containing a water spray system that is sealed to the test specimen.

6.2 *Water Spray System*, two spray nozzles installed in the spray box, oriented to apply all the water into the slot fault and located 13 mm (½ in.) from the open side of the spray box and 150 mm (6 in.) to the right and left of vertical center of the slot fault. A pressure regulator, flow meter, and an inline water filter to the spray nozzles control the flow rate of water sprayed into the slot fault. The water spray system shall deliver water at a rate of 106 g (0.234 lb) per minute +10 % - 0 %.

6.3 *Drained Water Container(s)*, a container, or containers, tared to the nearest 1.0 g (0.002 lb) of sufficient size to retain the water drained from the test specimen.

6.4 *Balance*, with a capacity of 20 kg (45 lb) and accuracy of 1.0 g (0.002 lb).

6.5 A means of collection such as a trough, to direct the drained water to the drained water container. The collection method may also be the tared container.

7. Calibration of Flow Rate

7.1 Collect the water from the water spray system in a tared container for a period of 15 min. Obtain the weight of the collected water and adjust the flow rate if necessary to obtain a weight of water of 1590 g (3.5 lb) to 1745 g (3.8 lb). Multiply this weight by 5 to obtain the amount of water that is delivered to the test specimen and report it in 10.1.7.

8. Test Specimen

8.1 The EIFS clad wall assembly test specimen shall be a minimum of 1220 mm (48 in.) by 2440 mm (96 in.).

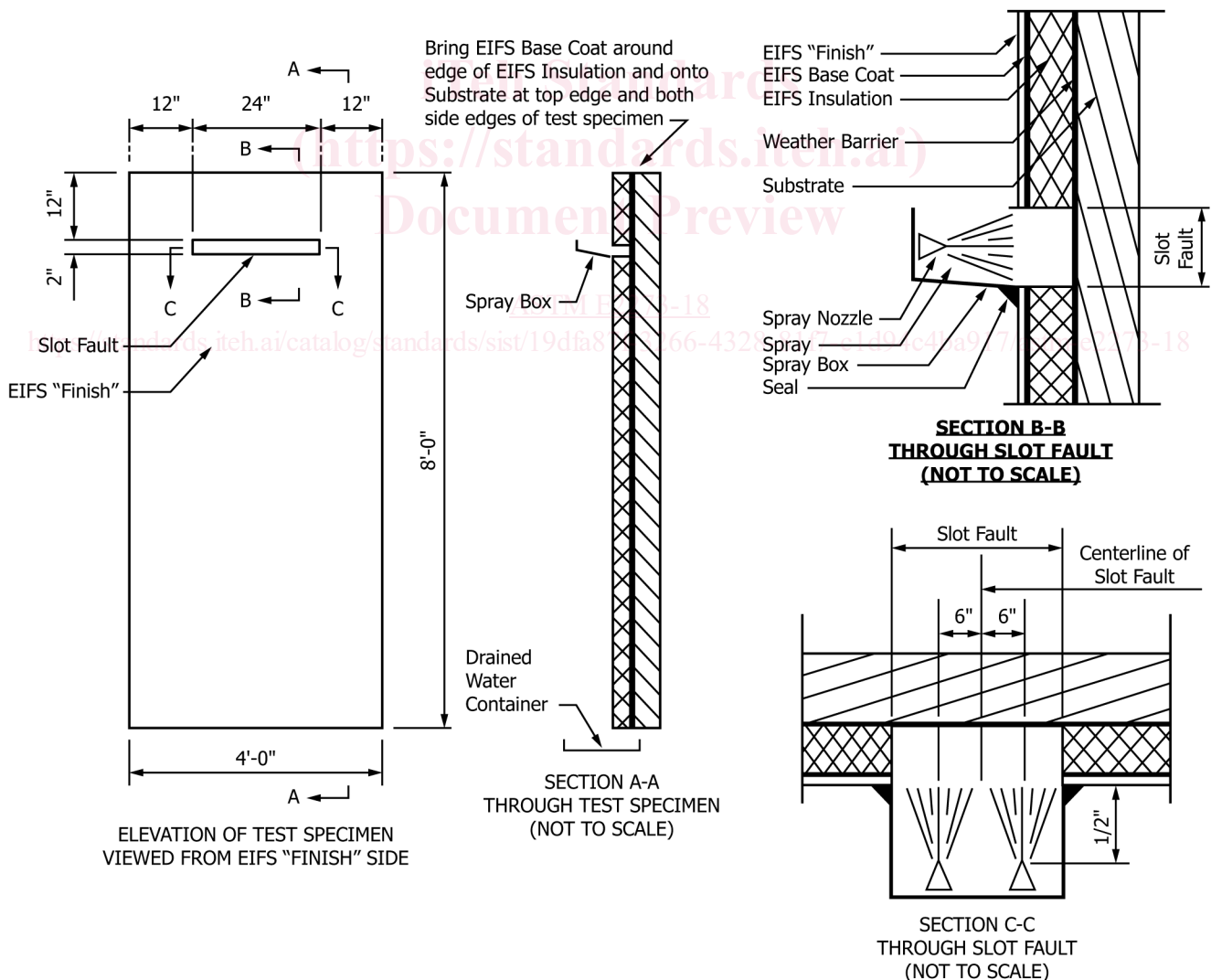

FIG. 1 EIFS Test Specimen