

# INTERNATIONAL STANDARD

## AMENDMENT 1

---

Surface mounted piezoelectric devices for frequency control and selection –  
Standard outlines and terminal lead connections –  
Part 2: Ceramic enclosures

[IEC 61837-2:2018/AMD1:2020](https://standards.iteh.ai/catalog/standards/sist/a9aac703-ed4a-4c51-b11d-015c12b4c281/iec-61837-2-2018-amd1-2020)

<https://standards.iteh.ai/catalog/standards/sist/a9aac703-ed4a-4c51-b11d-015c12b4c281/iec-61837-2-2018-amd1-2020>



**THIS PUBLICATION IS COPYRIGHT PROTECTED**  
**Copyright © 2020 IEC, Geneva, Switzerland**

All rights reserved. Unless otherwise specified, no part of this publication may be reproduced or utilized in any form or by any means, electronic or mechanical, including photocopying and microfilm, without permission in writing from either IEC or IEC's member National Committee in the country of the requester. If you have any questions about IEC copyright or have an enquiry about obtaining additional rights to this publication, please contact the address below or your local IEC member National Committee for further information.

IEC Central Office  
3, rue de Varembe  
CH-1211 Geneva 20  
Switzerland

Tel.: +41 22 919 02 11  
[info@iec.ch](mailto:info@iec.ch)  
[www.iec.ch](http://www.iec.ch)

**About the IEC**

The International Electrotechnical Commission (IEC) is the leading global organization that prepares and publishes International Standards for all electrical, electronic and related technologies.

**About IEC publications**

The technical content of IEC publications is kept under constant review by the IEC. Please make sure that you have the latest edition, a corrigendum or an amendment might have been published.

**IEC publications search - [webstore.iec.ch/advsearchform](http://webstore.iec.ch/advsearchform)**

The advanced search enables to find IEC publications by a variety of criteria (reference number, text, technical committee,...). It also gives information on projects, replaced and withdrawn publications.

**IEC Just Published - [webstore.iec.ch/justpublished](http://webstore.iec.ch/justpublished)**

Stay up to date on all new IEC publications. Just Published details all new publications released. Available online and once a month by email.

**IEC Customer Service Centre - [webstore.iec.ch/csc](http://webstore.iec.ch/csc)**

If you wish to give us your feedback on this publication or need further assistance, please contact the Customer Service Centre: [sales@iec.ch](mailto:sales@iec.ch).

**Electropedia - [www.electropedia.org](http://www.electropedia.org)**

The world's leading online dictionary on electrotechnology, containing more than 22 000 terminological entries in English and French, with equivalent terms in 16 additional languages. Also known as the International Electrotechnical Vocabulary (IEV) online.

**IEC Glossary - [std.iec.ch/glossary](http://std.iec.ch/glossary)**

67 000 electrotechnical terminology entries in English and French extracted from the Terms and definitions clause of IEC publications issued between 2002 and 2015. Some entries have been collected from earlier publications of IEC TC 37, 77, 86 and CISPR.

[IEC 61837-2:2018/AMD1:2020](https://standards.iec.ch/catalog/standards/sis/a9aac703-cd4a-4c51-b11d-015c12b4c281/iec-61837-2-2018-amd1-2020)

<https://standards.iec.ch/catalog/standards/sis/a9aac703-cd4a-4c51-b11d-015c12b4c281/iec-61837-2-2018-amd1-2020>

# INTERNATIONAL STANDARD

## AMENDMENT 1

**Surface mounted piezoelectric devices for frequency control and selection –  
Standard outlines and terminal lead connections –  
Part 2: Ceramic enclosures**

[IEC 61837-2:2018/AMD1:2020](https://standards.iteh.ai/catalog/standards/sist/a9aac703-ed4a-4c51-b11d-015c12b4c281/iec-61837-2-2018-amd1-2020)

<https://standards.iteh.ai/catalog/standards/sist/a9aac703-ed4a-4c51-b11d-015c12b4c281/iec-61837-2-2018-amd1-2020>

INTERNATIONAL  
ELECTROTECHNICAL  
COMMISSION

ICS 31.140

ISBN 978-2-8322-8838-2

**Warning! Make sure that you obtained this publication from an authorized distributor.**

## FOREWORD

This amendment has been prepared by IEC technical committee 49: Piezoelectric, dielectric and electrostatic devices and associated materials for frequency control, selection and detection.

The text of this amendment is based on the following documents:

|             |                  |
|-------------|------------------|
| FDIS        | Report on voting |
| 49/1338/CDV | 49/1347/RVC      |

Full information on the voting for the approval of this amendment can be found in the report on voting indicated in the above table.

The committee has decided that the contents of this amendment and the base publication will remain unchanged until the stability date indicated on the IEC website under "<http://webstore.iec.ch>" in the data related to the specific publication. At this date, the publication will be

- reconfirmed,
- withdrawn,
- replaced by a revised edition, or
- amended.

**ITEH STANDARD PREVIEW**  
**(standards.iteh.ai)**

[IEC 61837-2:2018/AMD1:2020](https://standards.iteh.ai/catalog/standards/sist/a9aac703-ed4a-4c51-b11d-015c12b4c281/iec-61837-2-2018-amd1-2020)

<https://standards.iteh.ai/catalog/standards/sist/a9aac703-ed4a-4c51-b11d-015c12b4c281/iec-61837-2-2018-amd1-2020>

## 8 Designation of ceramic enclosures

*Replace Table 1 with the following:*

**Table 1 – Designation of ceramic enclosures**

| No. | Type                 | Old type      | Sheet No. | Description                                    |
|-----|----------------------|---------------|-----------|--|
| 1   | QCC-18/1809A         | QCC-18/01     | Sheet 1   | Ceramic, welded, eighteen leadless SMD outline |
| 2   | QCC-12/1407A         |               | Sheet 2   | Ceramic, welded, twelve leadless SMD outline   |
| 3   | DCC-4/1206A          | DCC-4/01      | Sheet 3   | Ceramic, four leadless SMD outline             |
| 4   | DCC-2/1206A          |               | Sheet 4   | Ceramic, two leadless SMD outline              |
| 5   | QCC-10/9272A         |               | Sheet 5   | Ceramic, welded, ten leadless SMD outline      |
| 6   | DCC-4/9070A          |               | Sheet 6   | Ceramic, welded, four leadless SMD outline     |
| 7   | DCC-4/8045B          | DCC-04/02, 03 | Sheet 7   | Ceramic, welded, four leadless SMD outline     |
| 8   | DCC-2/8045B          |               | Sheet 8   | Ceramic, welded, two leadless SMD outline      |
| 9   | DCC-6/7834B          |               | Sheet 9   | Ceramic, welded, six leadless SMD outline      |
| 10  | DCC-6/7050A          |               | Sheet 10  | Ceramic, welded, six leadless SMD outline      |
| 11  | DCC-4/7050A          | DCC-4/08      | Sheet 11  | Ceramic, welded, four leadless SMD outline     |
| 12  | DCC-4/7050B          | DCC-4/04, 05  | Sheet 12  | Ceramic, welded, four leadless SMD outline     |
| 13  | QCC-10/7050A         |               | Sheet 13  | Ceramic, welded, ten leadless SMD outline      |
| 14  | QCC-6/7050A          | QCC-6/01, 02  | Sheet 14  | Ceramic, welded, six leadless SMD outline      |
| 15  | DCC-6/6035A          | DCC-4/06, 07  | Sheet 15  | Ceramic, welded, six leadless SMD outline      |
| 16  | DCC-4/6035C          |               | Sheet 16  | Ceramic, welded, four leadless SMD outline     |
| 17  | DCC-2/6035C          |               | Sheet 17  | Ceramic, welded, two leadless SMD outline      |
| 18  | QCC-8/5050A          | QCC-8/02      | Sheet 18  | Ceramic, welded, eight leadless SMD outline    |
| 19  | QCC-12/5045A         | QCC-12/02     | Sheet 19  | Ceramic, welded, twelve leadless SMD outline   |
| 20  | QCC-8/5045A          |               | Sheet 20  | Ceramic, welded, eight leadless SMD outline    |
| 21  | DCC-6/5032A          |               | Sheet 21  | Ceramic, welded, six leadless SMD outline      |
| 22  | DCC-4/5032A          |               | Sheet 22  | Ceramic, welded, four leadless SMD outline     |
| 23  | DCC-4/5032C          |               | Sheet 23  | Ceramic, welded, four leadless SMD outline     |
| 24  | DCC-2/5032B          | DCC-2/01      | Sheet 24  | Ceramic, welded, two leadless SMD outline      |
| 25  | DCC-2/4818C          |               | Sheet 25  | Ceramic, welded, two leadless SMD outline      |
| 26  | DCC-2/4115C          |               | Sheet 26  | Ceramic, welded, two leadless SMD outline      |
| 27  | DCC-4/4025C          | DCC-6/01      | Sheet 27  | Ceramic, welded, four leadless SMD outline     |
| 28  | QCC-8/3838A          |               | Sheet 28  | Ceramic, welded, eight leadless SMD outline    |
| 29  | DCC-6/3838A          |               | Sheet 29  | Ceramic, welded, six leadless SMD outline      |
| 30  | DCC-6/3225A          |               | Sheet 30  | Ceramic, welded, six leadless SMD outline      |
| 31  | DCC-4/3225C          |               | Sheet 31  | Ceramic, welded, four leadless SMD outline     |
| 32  | DCC-4/3215C          |               | Sheet 32  | Ceramic, welded, four leadless SMD outline     |
| 33  | DCC-2/3215C          |               | Sheet 33  | Ceramic, welded, two leadless SMD outline      |
| 34  | QCC-8/3030B          |               | Sheet 34  | Ceramic, welded, eight leadless SMD outline    |
| 35  | DCC-6/3030A          |               | Sheet 35  | Ceramic, welded, six leadless SMD outline      |
| 36  | DCC-6/2520A          |               | Sheet 36  | Ceramic, welded, six leadless SMD outline      |
| 37  | DCC-4/2520C/01,02,03 |               | Sheet 37  | Ceramic, welded, four leadless SMD outline     |
| 38  | DCC-4/2020C          |               | Sheet 38  | Ceramic, welded, six leadless SMD outline      |
| 39  | DCC-6/2016A          |               | Sheet 39  | Ceramic, welded, six leadless SMD outline      |
| 40  | DCC-4/2016C/01,02,03 |               | Sheet 40  | Ceramic, welded, four leadless SMD outline     |
| 41  | DCC-2/2012C          |               | Sheet 41  | Ceramic, welded, two leadless SMD outline      |
| 42  | DCC-4/1612C/01,02    |               | Sheet 42  | Ceramic, welded, four leadless SMD outline     |
| 43  | DCC-2/1612C          |               | Sheet 43  | Ceramic, welded, two leadless SMD outline      |
| 44  | DCC-2/1610C          |               | Sheet 44  | Ceramic, welded, two leadless SMD outline      |
| 45  | DCC-4/1210C          |               | Sheet 45  | Ceramic, welded, four leadless SMD outline     |

| No. | Type               | Old type | Sheet No. | Description                                 |
|-----|--------------------|----------|-----------|---|
| 46  | DCC-8/3225A        |          | Sheet 46  | Ceramic, welded, eight leadless SMD outline |
| 47  | DCC-4/1008C/0,1,02 |          | Sheet 47  | Ceramic, welded, four leadless SMD outline  |

*Add two sheets, Type DCC-8/3225A and Type DCC-4/1008C:*

## **iTeh STANDARD PREVIEW** **(standards.iteh.ai)**

[IEC 61837-2:2018/AMD1:2020](https://standards.iteh.ai/catalog/standards/sist/a9aac703-ed4a-4c51-b11d-015c12b4c281/iec-61837-2-2018-amd1-2020)

<https://standards.iteh.ai/catalog/standards/sist/a9aac703-ed4a-4c51-b11d-015c12b4c281/iec-61837-2-2018-amd1-2020>

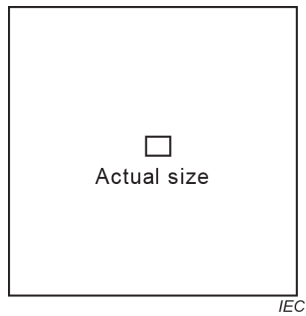

| Ref.     | Dimensions (mm) |       |      | Notes |
|----------|-----------------|-------|------|-------|
|          | Min.            | Nom.  | Max. |       |
| A        | —               | (3,2) | 3,40 |       |
| B        | —               | (2,5) | 2,70 |       |
| G        | —               | —     | 1,00 |       |
| $K_1$    | 0,30            | —     | 0,70 |       |
| $K_2$    | 0,35            | —     | 0,75 |       |
| $L_{B1}$ | 0,50            | —     | 0,90 |       |
| $L_{B2}$ | 0,15            | —     | 0,55 |       |
| $e_1$    | —               | 0,95  | —    |       |
| $e_2$    | —               | 2,70  | —    |       |
| $e_3$    | —               | 1,80  | —    |       |
| y        | —               | —     | 0,10 |       |

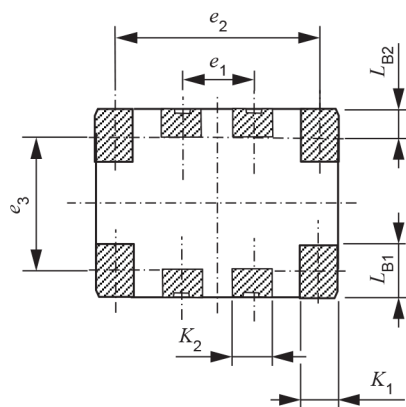
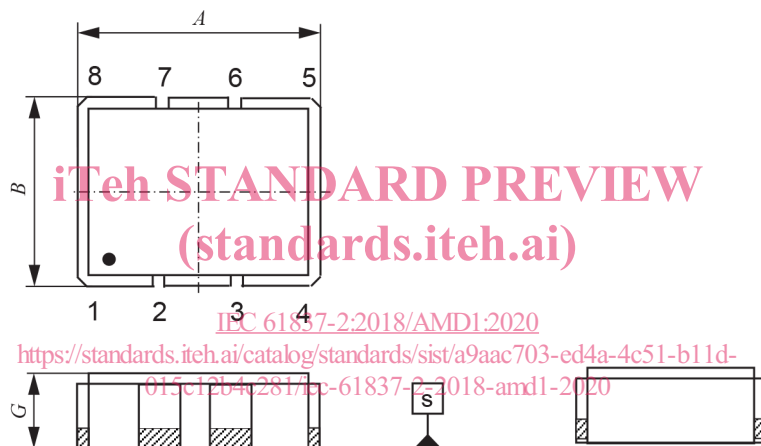

IEC

Ceramic, welded, eight leadless SMD outline-  
 Type DCC-8/3225A

Scale  
 10: 1

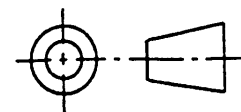

Sheet 46

**Terminal land connections of Type DCC-8/3225A**

| No. | Crystal unit | Crystal oscillator | Crystal filter | SAW devices |
|-----|--------------|--------------------|----------------|-------------|
| 1   |              | Output Enable      |                |             |
| 2   |              | INT                |                |             |
| 3   |              | NC                 |                |             |
| 4   |              | Output             |                |             |
| 5   |              | Ground             |                |             |
| 6   |              | SCL                |                |             |
| 7   |              | SDA                |                |             |
| 8   |              | DC supply          |                |             |

<https://standards.iteh.ai/catalog/standards/sist/a9aac703-ed4a-4c51-b11d-015c12b4c281/iec-61837-2-2018-amd1-2020>  
 IEC 61837-2:2018/AMD1:2020



Actual size omitted

| Ref.  | Dimensions (mm) |       |      | Notes |
|-------|-----------------|-------|------|-------|
|       | Min.            | Nom.  | Max. |       |
| A     | —               | (1,0) | 1,2  |       |
| B     | —               | (0,8) | 1,0  |       |
| $G_1$ | —               | —     | 0,13 | /01   |
| $G_2$ | —               | —     | 0,30 | /02   |
| K     | 0,20            | —     | 0,60 |       |
| $L_B$ | 0,10            | —     | 0,50 |       |
| $e_1$ | —               | 0,60  | —    |       |
| $e_2$ | —               | 0,50  | —    |       |
| y     | —               | —     | 0,1  |       |

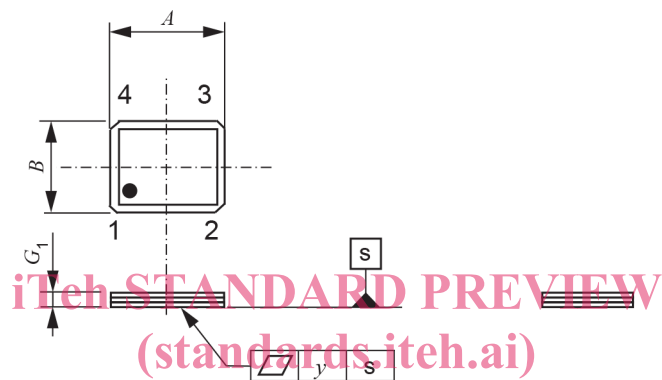

IEC 61837-2:2018/AMD1:2020  
<https://standards.iteh.ai/catalog/standards/sist/a9aac703-ed4a-4c51-b11d-015c12b4c881/iec-61837-2-2018-amd1-2020>

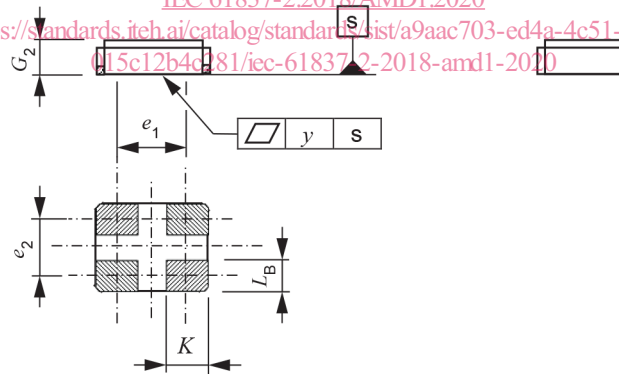

IEC

Ceramic, welded, four leadless SMD outline-  
 Type DCC-4/1008C/01,02

Scale  
 15: 1

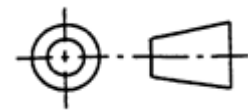

Sheet 47

**Terminal land connections of Type DCC-4/1008C/01,02**

| No. | Crystal unit | Crystal oscillator | Crystal filter | SAW devices |
|-----|--------------|--------------------|----------------|-------------|
| 1   | Terminal 1   |                    |                |             |
| 2   | Ground       |                    |                |             |
| 3   | Terminal 2   |                    |                |             |
| 4   | NC           |                    |                |             |

*Replace eight types with the following new sheets, Type DCC-6/7050A, Type DCC-4/7050A, Type DCC-6/5032A, Type DCC-4/5032A, Type DCC-6/3225A, Type DCC-4/3225C, Type DCC-4/2016C, Type and DCC-4/1612C:*

<https://standards.iteh.ai/catalog/standards/sist/a9aac703-ed4a-4c51-b11d-015c12b4c281/iec-61837-2-2018-amd1-2020>

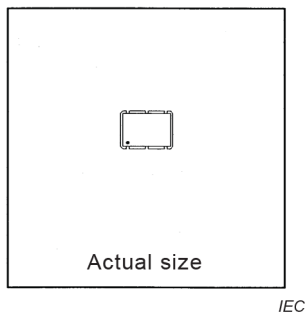

| Ref.                 | Dimensions (mm) |       |      | Notes |
|----------------------|-----------------|-------|------|-------|
|                      | Min.            | Nom.  | Max. |       |
| <i>A</i>             | —               | (7,0) | 7,30 |       |
| <i>B</i>             | —               | (5,0) | 5,30 |       |
| <i>G</i>             | —               | —     | 2,00 |       |
| <i>K</i>             | 1,10            | —     | 1,70 |       |
| <i>L<sub>B</sub></i> | 0,80            | —     | 1,40 |       |
| <i>e</i>             | —               | 2,54  | —    |       |
| <i>e<sub>1</sub></i> | —               | 3,90  | —    |       |
| <i>y</i>             | —               | —     | 0,10 |       |

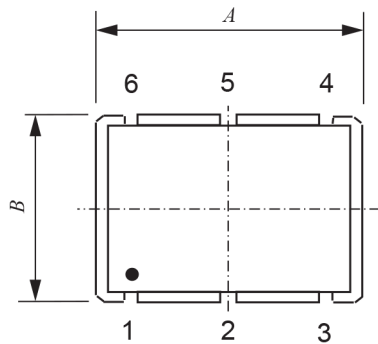

**iTeh STANDARD PREVIEW**  
 (standards.iteh.ai)

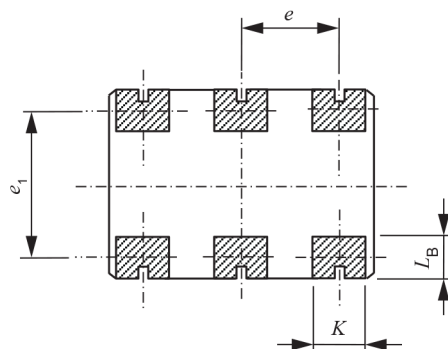

IEC

Ceramic, welded, six leadless SMD outline –  
 Type DCC-6/7050A

Scale  
 15: 1

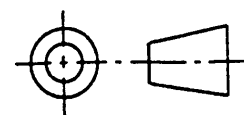

Sheet 10