



Designation: D1929 – 19

## Standard Test Method for Determining Ignition Temperature of Plastics<sup>1</sup>

This standard is issued under the fixed designation D1929; the number immediately following the designation indicates the year of original adoption or, in the case of revision, the year of last revision. A number in parentheses indicates the year of last reappraisal. A superscript epsilon ( $\epsilon$ ) indicates an editorial change since the last revision or reappraisal.

### 1. Scope\*

1.1 This fire test response test method<sup>2</sup> covers a laboratory determination of the flash ignition temperature and spontaneous ignition temperature of plastics using a hot-air furnace.

1.2 The values stated in SI units are to be regarded as standard. No other units of measurement are included in this standard.

1.3 *Caution*—During the course of combustion, gases or vapors, or both, are evolved that have the potential to be hazardous to personnel.

1.4 *This standard is used to measure and describe the response of materials, products, or assemblies to heat and flame under controlled conditions, but does not by itself incorporate all factors required for fire-hazard or fire-risk assessment of the materials, products, or assemblies under actual fire conditions.*

1.5 *Fire testing is inherently hazardous. Adequate safeguards for personnel and property shall be employed in conducting these tests.*

1.6 *This standard does not purport to address all of the safety concerns, if any, associated with its use. It is the responsibility of the user of this standard to establish appropriate safety, health, and environmental practices and determine the applicability of regulatory limitations prior to use.* Specific precautionary statements are given in 1.3 and 1.4.

NOTE 1—This test method and ISO 871-1996 are similar in all technical details.

1.7 *This international standard was developed in accordance with internationally recognized principles on standardization established in the Decision on Principles for the*

<sup>1</sup> This test method is under the jurisdiction of ASTM Committee D20 on Plastics and is the direct responsibility of Subcommittee D20.30 on Thermal Properties.30.03).

Current edition approved Dec. 1, 2019. Published January 2020. Originally approved in 1962. Last previous edition approved in 2016 as D1929–16. DOI:10.1520/D1929-19.

In 1996, this test method was totally revised to be technically equal to ISO 871-1996, and a specific air velocity is specified, which eliminates the need for approximations.

<sup>2</sup> The following reference may be of interest in connection with this test method: Stetchkin, N. P., "A Method and Apparatus for Determining the Ignition Characteristics of Plastics," *Journal of Research*, National Institute of Standards and Technology, Vol 43, No. 6, December 1949 (RP 2052), p. 591.

*Development of International Standards, Guides and Recommendations issued by the World Trade Organization Technical Barriers to Trade (TBT) Committee.*

### 2. Referenced Documents

#### 2.1 ASTM Standards:<sup>3</sup>

D618 Practice for Conditioning Plastics for Testing

D883 Terminology Relating to Plastics

E176 Terminology of Fire Standards

E456 Terminology Relating to Quality and Statistics

E691 Practice for Conducting an Interlaboratory Study to Determine the Precision of a Test Method

E2653 Practice for Conducting an Interlaboratory Study to Determine Precision Estimates for a Fire Test Method with Fewer Than Six Participating Laboratories

E2935 Practice for Conducting Equivalence Testing in Laboratory Applications

#### 2.2 International Standards:<sup>4,5</sup>

ISO 871-1996 Plastics—Determination of Ignition Temperature Using a Hot-Air Furnace

ISO 5725:1994 Accuracy (trueness and precision) of Measurement Methods and Results

ISO 13943:2017 Fire Safety—Vocabulary

IEC 584-2 Thermocouples—Part 2: Tolerances

### 3. Terminology

3.1 Terms used in this standard are defined in accordance with Terminology D883, unless otherwise specified. For terms relating to precision and bias and associated issues, the terms used in this standard are defined in accordance with Terminology E456. For terms relating to fire, the terms in this standard are defined in accordance with Terminology E176.

#### 3.2 Definitions of Terms Specific to This Standard:

3.2.1 *flash ignition temperature (FIT)*—the minimum temperature at which, under specified test conditions, sufficient

<sup>3</sup> For referenced ASTM standards, visit the ASTM website, [www.astm.org](http://www.astm.org), or contact ASTM Customer Service at [service@astm.org](mailto:service@astm.org). For *Annual Book of ASTM Standards* volume information, refer to the standard's Document Summary page on the ASTM website.

<sup>4</sup> Available from American National Standards Institute (ANSI), 25 W. 43rd St., 4th Floor, New York, NY 10036, <http://www.ansi.org>.

<sup>5</sup> Available from International Organization for Standardization (ISO), ISO Central Secretariat, BIBC II, Chemin de Blandonnet 8, CP 401, 1214 Vernier, Geneva, Switzerland, <http://www.iso.org>.

\*A Summary of Changes section appears at the end of this standard

flammable gases are emitted to ignite momentarily upon application of a small external pilot flame.

3.2.2 *glowing combustion*—combustion of a material in the solid phase without flame but with emission of light from the combustion zone, caused by slow decomposition and carbonization at various points in the specimen, without general ignition occurring.

3.2.3 *spontaneous ignition temperature or self-ignition temperature (SIT)*—the minimum temperature at which the self-heating properties of the specimen lead to ignition or ignition occurs of itself, under specified test conditions, in the absence of any additional flame ignition source.

#### 4. Significance and Use

4.1 Tests made under conditions herein prescribed can be of considerable value in comparing the relative ignition characteristics of different materials. Values obtained represent the lowest ambient air temperature that will cause ignition of the material under the conditions of this test. Test values are expected to rank materials according to ignition susceptibility under actual use conditions.

4.2 This test is not intended to be the sole criterion for fire hazard. In addition to ignition temperatures, fire hazards include other factors such as burning rate or flame spread, intensity of burning, fuel contribution, products of combustion, and others.

#### 5. Apparatus

5.1 *Hot-Air Ignition Furnace*—A furnace similar to that shown in Fig. 1, consisting primarily of an electrical heating unit and specimen holder.

5.2 *Furnace Tube*—A vertical tube with an inside diameter of  $100 \pm 5$  mm and a length of  $230 \pm 20$  mm, made of a ceramic that will withstand at least  $750^\circ\text{C}$ . The vertical tube stands on the furnace floor, fitted with a plug for the removal of accumulated residue.

5.3 *Inner Ceramic Tube*—A ceramic tube that will withstand at least  $750^\circ\text{C}$ , with an inside diameter of  $75 \pm 5$  mm, length of  $230 \pm 20$  mm, and thickness of approximately 3 mm, placed inside the furnace tube and positioned  $20 \pm 2$  mm above the furnace floor on three small spacer blocks. The top is covered by a disk of heat-resistant material with a  $25 \pm 2$ -mm diameter opening in the center that is used for observation and passage of smoke and gases. The pilot flame is located immediately above the opening.

NOTE 2—Fire resistant materials such as silica glass and stainless steel have also been found suitable for this application.

5.4 *Air Source*—An outside air source to supply clean air near the top of the annular space between the ceramic tubes, through a copper tube at a steady and controllable rate. Air shall be heated and circulated in the space between the two tubes and enter the inner furnace tube at the bottom. Air shall be metered by a rotameter or other suitable device.

5.5 *Electrical Heating Unit*, contained within the mineral fiber sleeve and constructed of 50 turns of  $1.3 \pm 0.1$  mm

Nichrome V alloy wire, wound around the furnace tube and embedded in heat-resistant cement.

NOTE 3—Other constructions such as finely coiled wire embedded in molded ceramic fiber have also been found to be acceptable.

5.6 *Insulation*, consisting of a layer of mineral fiber, approximately 60-mm thick, and covered by a metal jacket.

5.7 *Pilot Igniter*, consisting of a nominal  $1.8 \pm 0.3$ -mm inside diameter (ID) copper tubing attached to a gas supply of 94 % minimum purity propane and placed horizontally  $5 \pm 1$  mm above the top surface of the disk cover. The pilot flame shall be adjusted to  $20 \pm 2$  mm in length and centered above the opening in the disk cover.

5.8 *Specimen Support and Holder*—The specimen pan consists of a metal container of approximately 0.5-mm thick steel measuring  $40 \pm 2$  mm in diameter by  $15 \pm 2$  mm in depth. It is held in a ring of approximately 2.0-mm diameter stainless steel welding rod. The ring is welded to a length of the same type of rod extending through the cover of the furnace, as shown in Fig. 1. The bottom of the specimen pan shall be located  $185 \pm 5$  mm down from the top of the inner furnace tube.

5.9 *Thermocouples*, 0.5-mm diameter, Chromel-Alumel (Type K) or Iron-Constantan (Type J), for temperature measurement connected to a calibrated recording instrument with a tolerance not exceeding  $\pm 2^\circ\text{C}$ . The thermocouple tolerance shall be in accordance with IEC 584-2, Table 1, Class 2 or better.

5.10 *Heating Control*—A suitable variable transformer or an automatic controller connected in series with the heating coils.

5.11 *Timing Device*, having an accuracy of at least 1 s.

#### 6. Location of Thermocouples

6.1 Thermocouple  $TC_1$  measures the temperature,  $T_1$ , of the specimen. It is located as close as possible to the center of the upper surface of the specimen when the specimen is in place within the furnace. The thermocouple wire is attached to the specimen support rod.

6.2 Thermocouple  $TC_2$  gives some indication of the temperature,  $T_2$ , of the air traveling past the specimen. It is located  $10 \pm 2$  mm below the center of the specimen pan. The thermocouple wire is attached to the specimen support rod.

6.2.1 It is acceptable to install thermocouple  $TC_2$  through a hole drilled adjacent to the inspection plug below the specimen pan, instead of introducing it from the top, as shown in Fig. 1.

6.3 Thermocouple  $TC_3$  measures the temperature,  $T_3$ , of the heating coil. It is located adjacent to the furnace heating coil and is used as a reference for temperature adjustment purposes. A metallic sheathed thermocouple with a diameter not greater than 1.7 mm is permitted to be used for thermocouple  $TC_3$ . The limit on thermocouple thickness in 5.9 does not apply to thermocouple  $TC_3$ .

#### 7. Test Specimens

7.1 It is acceptable to use as test specimens materials, or products, supplied in any form, with some examples being

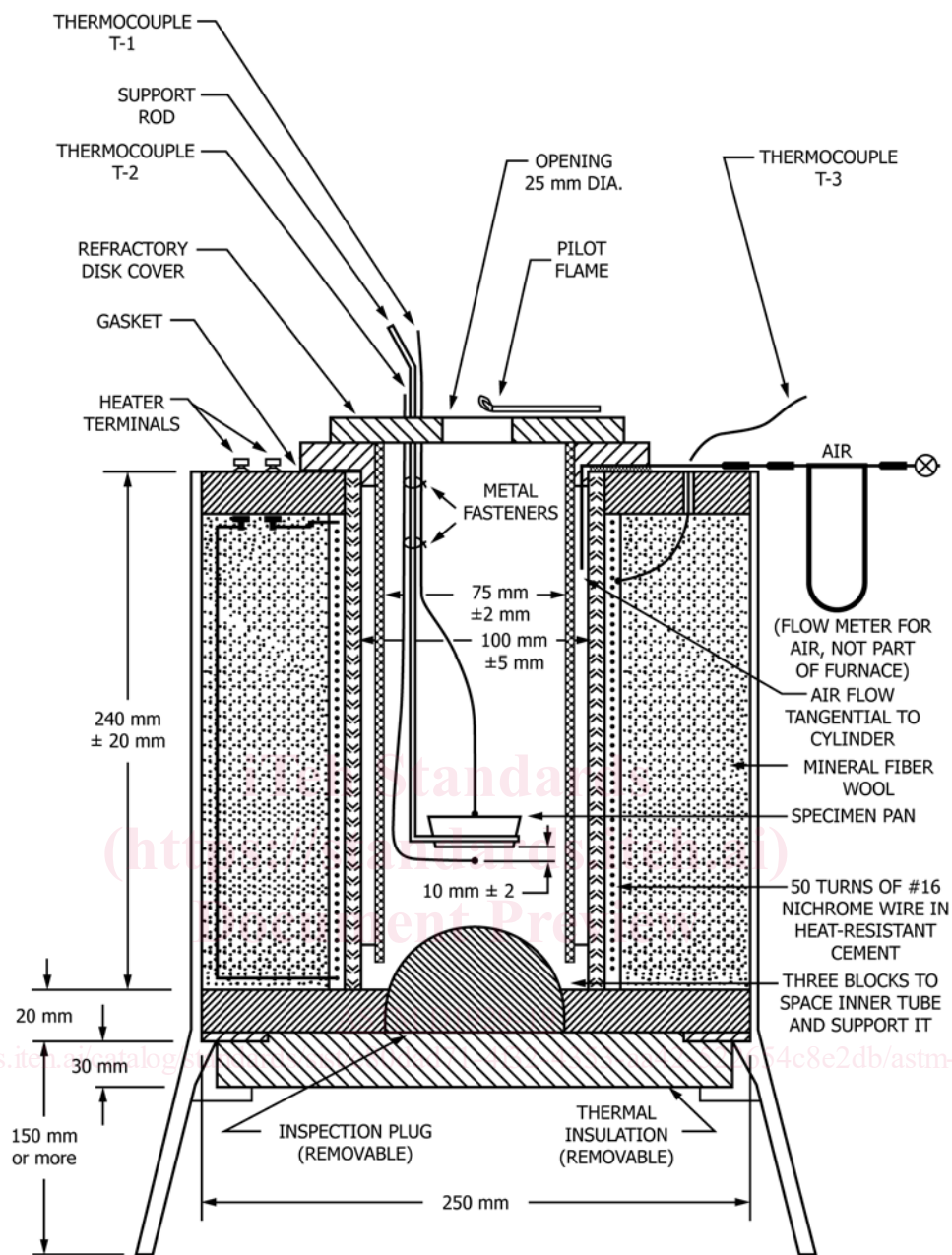

FIG. 1 Cross Section of Hot-Air Ignition Furnace

pellets, powders and films. It is also acceptable to use composites as test specimens. The test report shall include full details of the form in which the test specimens have been tested.

NOTE 4—Specimens containing high levels of inorganic fillers are difficult to evaluate.

NOTE 5—In some cases the same material will give different results if tested in different forms.

7.2 A specimen mass of  $3.0 \pm 0.2$  g shall be used for materials having a density greater than  $100 \text{ kg/m}^3$ .

7.2.1 Instructions for Specific Types of Test Specimens:

7.2.1.1 For sheet materials, cut the sheet into squares of  $20 \pm 2$  by  $20 \pm 2$  mm maximum size, and stack these to a height that gives the required specimen mass.

7.2.1.2 For film materials, roll a strip  $20 \pm 2$  mm wide and of length sufficient to give the required specimen mass.

7.2.1.3 For cellular materials having a density less than  $100 \text{ kg/m}^3$ , remove any outer skin and cut the specimens in the form of a block measuring  $20 \pm 2$  by  $20 \pm 2$  by  $50 \pm 5$  mm.

7.3 Sufficient material is required for at least two determinations.

7.4 The test specimens shall be conditioned at  $23 \pm 2^\circ\text{C}$  and  $50 \pm 10\%$  relative humidity for not less than 40 h prior to test, in accordance with Practice D618.

8. Procedure

8.1 Flash Ignition Temperature (FIT):