

INTERNATIONAL STANDARD

NORME INTERNATIONALE

**Electric motor-operated hand-held tools, transportable tools and lawn and garden machinery – Safety –
Part 4-8: Particular requirements for shredders/chippers**

**Outils électroportatifs à moteur, outils portables et machines pour jardin et pelouses – Sécurité –
Partie 4-8: Exigences particulières pour les déchiqueteuses/machines à déchiqueter**



THIS PUBLICATION IS COPYRIGHT PROTECTED
Copyright © 2025 IEC, Geneva, Switzerland

All rights reserved. Unless otherwise specified, no part of this publication may be reproduced or utilized in any form or by any means, electronic or mechanical, including photocopying and microfilm, without permission in writing from either IEC or IEC's member National Committee in the country of the requester. If you have any questions about IEC copyright or have an enquiry about obtaining additional rights to this publication, please contact the address below or your local IEC member National Committee for further information.

Droits de reproduction réservés. Sauf indication contraire, aucune partie de cette publication ne peut être reproduite ni utilisée sous quelque forme que ce soit et par aucun procédé, électronique ou mécanique, y compris la photocopie et les microfilms, sans l'accord écrit de l'IEC ou du Comité national de l'IEC du pays du demandeur. Si vous avez des questions sur le copyright de l'IEC ou si vous désirez obtenir des droits supplémentaires sur cette publication, utilisez les coordonnées ci-après ou contactez le Comité national de l'IEC de votre pays de résidence.

IEC Secretariat
3, rue de Varembe
CH-1211 Geneva 20
Switzerland

Tel.: +41 22 919 02 11
info@iec.ch
www.iec.ch

About the IEC

The International Electrotechnical Commission (IEC) is the leading global organization that prepares and publishes International Standards for all electrical, electronic and related technologies.

About IEC publications

The technical content of IEC publications is kept under constant review by the IEC. Please make sure that you have the latest edition, a corrigendum or an amendment might have been published.

IEC publications search - webstore.iec.ch/advsearchform

The advanced search enables to find IEC publications by a variety of criteria (reference number, text, technical committee, ...). It also gives information on projects, replaced and withdrawn publications.

IEC Just Published - webstore.iec.ch/justpublished

Stay up to date on all new IEC publications. Just Published details all new publications released. Available online and once a month by email.

IEC Customer Service Centre - webstore.iec.ch/csc

If you wish to give us your feedback on this publication or need further assistance, please contact the Customer Service Centre: sales@iec.ch.

IEC Products & Services Portal - products.iec.ch

Discover our powerful search engine and read freely all the publications previews, graphical symbols and the glossary. With a subscription you will always have access to up to date content tailored to your needs.

Electropedia - www.electropedia.org

The world's leading online dictionary on electrotechnology, containing more than 22 500 terminological entries in English and French, with equivalent terms in 25 additional languages. Also known as the International Electrotechnical Vocabulary (IEV) online.

A propos de l'IEC

La Commission Electrotechnique Internationale (IEC) est la première organisation mondiale qui élabore et publie des Normes internationales pour tout ce qui a trait à l'électricité, à l'électronique et aux technologies apparentées.

A propos des publications IEC

Le contenu technique des publications IEC est constamment revu. Veuillez vous assurer que vous possédez l'édition la plus récente, un corrigendum ou amendement peut avoir été publié.

Recherche de publications IEC -

webstore.iec.ch/advsearchform

La recherche avancée permet de trouver des publications IEC en utilisant différents critères (numéro de référence, texte, comité d'études, ...). Elle donne aussi des informations sur les projets et les publications remplacées ou retirées.

IEC Just Published - webstore.iec.ch/justpublished

Restez informé sur les nouvelles publications IEC. Just Published détaille les nouvelles publications parues. Disponible en ligne et une fois par mois par email.

Service Clients - webstore.iec.ch/csc

Si vous désirez nous donner des commentaires sur cette publication ou si vous avez des questions contactez-nous: sales@iec.ch.

IEC Products & Services Portal - products.iec.ch

Découvrez notre puissant moteur de recherche et consultez gratuitement tous les aperçus des publications, symboles graphiques et le glossaire. Avec un abonnement, vous aurez toujours accès à un contenu à jour adapté à vos besoins.

Electropedia - www.electropedia.org

Le premier dictionnaire d'électrotechnologie en ligne au monde, avec plus de 22 500 articles terminologiques en anglais et en français, ainsi que les termes équivalents dans 25 langues additionnelles. Egalement appelé Vocabulaire Electrotechnique International (IEV) en ligne.



INTERNATIONAL STANDARD

NORME INTERNATIONALE

**Electric motor-operated hand-held tools, transportable tools and lawn and garden machinery – Safety –
Part 4-8: Particular requirements for shredders/chippers**

**Outils électroportatifs à moteur, outils portables et machines pour jardin et pelouses – Sécurité –
Partie 4-8: Exigences particulières pour les déchiqueteuses/machines à déchiqueter**

INTERNATIONAL
ELECTROTECHNICAL
COMMISSION

COMMISSION
ELECTROTECHNIQUE
INTERNATIONALE

ICS 25.140.20

ISBN 978-2-8327-0131-7

**Warning! Make sure that you obtained this publication from an authorized distributor.
Attention! Veuillez vous assurer que vous avez obtenu cette publication via un distributeur agréé.**

CONTENTS

FOREWORD.....	5
1 Scope.....	7
2 Normative references	7
3 Terms and definitions	8
4 General requirements	10
5 General conditions for the tests	11
6 Radiation, toxicity and similar hazards.....	11
7 Classification.....	11
8 Marking and instructions.....	11
9 Protection against access to live parts.....	16
10 Starting	16
11 Input and current	16
12 Heating.....	17
13 Resistance to heat and fire.....	17
14 Moisture resistance	17
15 Resistance to rusting.....	18
16 Overload protection of transformers and associated circuits	18
17 Endurance.....	18
18 Abnormal operation.....	19
19 Mechanical hazards.....	20
20 Mechanical strength	36
21 Construction	37
22 Internal wiring.....	37
23 Components	38
24 Supply connection and external flexible cords	41
25 Terminals for external conductors.....	43
26 Provision for earthing	43
27 Screws and connections	43
28 Creepage distances, clearances and distances through insulation.....	43
Annexes	48
Annex I (informative) Measurement of noise and vibration emissions.....	49
Annex K (normative) Battery tools and battery packs	57
Annex L (normative) Battery tools and battery packs provided with mains connection or non-isolated sources.....	71
Annex AA (normative) Product safety labels which may be used on machines	74
Annex BB (informative) Methods of combining round, square and slot shapes ≤ 50 mm complying with safety distance ≥ 200 mm	79
Annex CC (normative) Thrown objects test enclosure	83
Annex DD (normative) Target panels – Specification for fibreboard.....	88
Annex EE (informative) Example of a material and construction fulfilling the requirements for an artificial surface	91
Annex FF (informative) Determination of applicable requirements for machines covered by Annex K.....	93

Bibliography.....	96
Figure 101 – Examples of a shredder/chipper	10
Figure 102 – Distance from feed safety opening to shredding means	26
Figure 103 – Arm probe for testing tortuous path guarding of shredding means through the feed intake opening.....	28
Figure 104 – Examples of discharge chute distance requirements	30
Figure 105 – Wood dowel length.....	33
Figure 106 – Ceramic prism test piece	33
Figure 107 – Wood dowel insertion points.....	34
Figure 108 – Test assembly for accessibility of attachment plug blades	42
Figure I.101 – Microphone positions on the hemisphere (see Table I.101)	49
Figure I.102 – Microphone position for measurement of emission sound pressure level and location of machine with respect to the microphone co-ordinate system	54
Figure AA.1 – Product safety labels illustrating "WARNING – Rotating blades. Keep hands out of openings while machine is running"	74
Figure AA.2 – Product safety labels illustrating "WARNING – Keep bystanders away"	75
Figure AA.3 – Product safety label illustrating – "WARNING – Beware of thrown objects".....	75
Figure AA.4 – Product safety labels illustrating – "WARNING – Remove plug from mains before maintenance or if the cord is damaged"	76
Figure AA.5 – Product safety labels illustrating – "Wear eye protection".....	76
Figure AA.6 – Product safety label illustrating – "Wear ear protection".....	77
Figure AA.7 – Optional product safety label illustrating – "Wear eye and ear protection".....	77
Figure AA.8 – Product safety label illustrating "WARNING – Wait until all machine components have completely stopped before touching them".....	77
Figure AA.9 – Product safety labels illustrating – "WARNING – Disconnect battery before maintenance"	78
Figure BB.1 – Example 1 – Opening sizes ≤ 45 mm	79
Figure BB.2 – Example 2 – Opening sizes ≤ 45 mm	79
Figure BB.3 – Example 3 – Opening sizes ≤ 45 mm	80
Figure BB.4 – Example 1 – Opening sizes > 45 mm and ≤ 50 mm.....	80
Figure BB.5 – Example 2 – Opening sizes > 45 mm and ≤ 50 mm.....	81
Figure BB.6 – Example 3 – Opening sizes > 45 mm and ≤ 50 mm.....	81
Figure BB.7 – Example 4 – Opening sizes > 45 mm and ≤ 50 mm.....	81
Figure BB.8 – Example – Opening sizes ≤ 50 mm, constriction ≤ 26 mm.....	82
Figure CC.1 – Test enclosure, construction detail	83
Figure CC.2 – Test surface detail.....	84
Figure CC.3 – Example of base, nail plan	84
Figure CC.4 – Thrown objects test enclosure – General layout	86
Figure CC.5 – Intake target panel placement	87
Figure DD.1 – Test fixture for fibreboard penetration test.....	89
Figure EE.1 – Sketch of the measurement surface covered with an artificial surface.....	92
Figure FF.1 – Flowchart depicting the determination of applicable requirements for machines covered by Annex K.....	93

Figure FF.2 – Diagram depicting how Annex K in a Part 2, 3 or 4 overrides requirements in the main body of the Part 2, 3 or 4, Annex K in Part 1 and the main body of Part 1 94

Figure FF.3 – Diagram depicting how the main body in a Part 2, 3 or 4 overrides requirements in Annex K in Part 1 and the main body of Part 1 94

Figure FF.4 – Diagram depicting how Annex K in Part 1 overrides requirements in the main body of Part 1 95

Figure FF.5 – Diagram depicting no overriding of requirements in the main body of Part 1 95

Table 4 – Required performance levels 19

Table 101 – Safety distances of shredding means to feed intake openings 21

Table 9 – Pull and torque value 43

Table 12 – Minimum creepage distances and clearances 44

Table I.101 – Co-ordinates of microphone positions 51

Table I.102 – Absorption coefficients 52

Table K.301 – Pull and torque value 67

Table K.1 – Minimum creepage distances and clearances between parts of different potential 69

Table K.2 – Minimum total sum of creepage distances and clearances to accessible surfaces 70

 (https://standards.iteh.ai)
 Document Preview

[IEC 62841-4-8:2025](https://standards.iteh.ai/catalog/standards/iec/d570f8f3-92dd-4193-b0a7-158cd59378e1/iec-62841-4-8-2025)

<https://standards.iteh.ai/catalog/standards/iec/d570f8f3-92dd-4193-b0a7-158cd59378e1/iec-62841-4-8-2025>

INTERNATIONAL ELECTROTECHNICAL COMMISSION

**ELECTRIC MOTOR-OPERATED HAND-HELD TOOLS,
TRANSPORTABLE TOOLS AND LAWN AND GARDEN MACHINERY –
SAFETY –**

Part 4-8: Particular requirements for shredders/chippers

FOREWORD

- 1) The International Electrotechnical Commission (IEC) is a worldwide organization for standardization comprising all national electrotechnical committees (IEC National Committees). The object of IEC is to promote international co-operation on all questions concerning standardization in the electrical and electronic fields. To this end and in addition to other activities, IEC publishes International Standards, Technical Specifications, Technical Reports, Publicly Available Specifications (PAS) and Guides (hereafter referred to as "IEC Publication(s)"). Their preparation is entrusted to technical committees; any IEC National Committee interested in the subject dealt with may participate in this preparatory work. International, governmental and non-governmental organizations liaising with the IEC also participate in this preparation. IEC collaborates closely with the International Organization for Standardization (ISO) in accordance with conditions determined by agreement between the two organizations.
- 2) The formal decisions or agreements of IEC on technical matters express, as nearly as possible, an international consensus of opinion on the relevant subjects since each technical committee has representation from all interested IEC National Committees.
- 3) IEC Publications have the form of recommendations for international use and are accepted by IEC National Committees in that sense. While all reasonable efforts are made to ensure that the technical content of IEC Publications is accurate, IEC cannot be held responsible for the way in which they are used or for any misinterpretation by any end user.
- 4) In order to promote international uniformity, IEC National Committees undertake to apply IEC Publications transparently to the maximum extent possible in their national and regional publications. Any divergence between any IEC Publication and the corresponding national or regional publication shall be clearly indicated in the latter.
- 5) IEC itself does not provide any attestation of conformity. Independent certification bodies provide conformity assessment services and, in some areas, access to IEC marks of conformity. IEC is not responsible for any services carried out by independent certification bodies.
- 6) All users should ensure that they have the latest edition of this publication.
- 7) No liability shall attach to IEC or its directors, employees, servants or agents including individual experts and members of its technical committees and IEC National Committees for any personal injury, property damage or other damage of any nature whatsoever, whether direct or indirect, or for costs (including legal fees) and expenses arising out of the publication, use of, or reliance upon, this IEC Publication or any other IEC Publications.
- 8) Attention is drawn to the Normative references cited in this publication. Use of the referenced publications is indispensable for the correct application of this publication.
- 9) IEC draws attention to the possibility that the implementation of this document may involve the use of (a) patent(s). IEC takes no position concerning the evidence, validity or applicability of any claimed patent rights in respect thereof. As of the date of publication of this document, IEC had not received notice of (a) patent(s), which may be required to implement this document. However, implementers are cautioned that this may not represent the latest information, which may be obtained from the patent database available at <https://patents.iec.ch>. IEC shall not be held responsible for identifying any or all such patent rights.

IEC 62841-4-8 has been prepared by IEC technical committee 116: Safety of motor-operated electric tools. It is an International Standard.

The text of this International Standard is based on the following documents:

Draft	Report on voting
116/853/FDIS	116/867/RVD

Full information on the voting for its approval can be found in the report on voting indicated in the above table.

The language used for the development of this International Standard is English.

This document was drafted in accordance with ISO/IEC Directives, Part 2, and developed in accordance with ISO/IEC Directives, Part 1 and ISO/IEC Directives, IEC Supplement, available at www.iec.ch/members_experts/refdocs. The main document types developed by IEC are described in greater detail at www.iec.ch/publications.

This document is to be used in conjunction with IEC 62841-1:2014.

This document supplements or modifies the corresponding clauses in IEC 62841-1, so as to convert it into the IEC Standard: Particular requirements for shredders/chippers.

Where a particular subclause of IEC 62841-1 is not mentioned in this document, that subclause applies as far as reasonable. Where this document states "addition", "modification" or "replacement", the relevant text in IEC 62841-1 is to be adapted accordingly.

The following print types are used:

- test specifications: *in italic type*;
- terms defined in Clause 3: **in bold type**;

Subclauses, notes, tables and figures which are additional to those in IEC 62841-1 are numbered starting from 101.

Subclauses, notes, tables and figures in Annex K and Annex L which are additional to those in the main body of this document are numbered starting from 301.

A list of all parts in the IEC 62841 series, published under the general title *Electric motor-operated hand-held tools, transportable tools and lawn and garden machinery – Safety*, can be found on the IEC website.

The committee has decided that the contents of this document will remain unchanged until the stability date indicated on the IEC website under webstore.iec.ch in the data related to the specific document. At this date, the document will be ²⁰²⁵

- reconfirmed,
- withdrawn, or
- revised.

NOTE The attention of National Committees is drawn to the fact that equipment manufacturers and testing organizations may need a transitional period following publication of a new, amended or revised IEC publication in which to make products in accordance with the new requirements and to equip themselves for conducting new or revised tests.

It is the recommendation of the committee that the content of this publication be adopted for implementation nationally not earlier than 36 months from the date of publication.

ELECTRIC MOTOR-OPERATED HAND-HELD TOOLS, TRANSPORTABLE TOOLS AND LAWN AND GARDEN MACHINERY – SAFETY –

Part 4-8: Particular requirements for shredders/chippers

1 Scope

IEC 62841-1:2014, Clause 1, is applicable, except as follows.

Replacement of the third paragraph:

The **rated voltage** is not more than 250 V for single-phase a.c. or d.c. machines, and 480 V for three-phase a.c. machines.

Addition:

This document specifies safety requirements and their verification for the design and construction of hand fed, **shredders/chippers** with an integral electric motor, with or without vacuum assisted collection, which are designed to reduce organic material to smaller pieces and are used in a stationary position by an operator standing on the ground. This document applies to **shredders/chippers** with **feed intake openings** or **feed safety openings** that in total will fit into a square of 250 mm × 250 mm.

NOTE 101 The requirements for the measurement of the square of 250 mm × 250 mm are specified in 19.101.1.

In this document, **shredders/chippers** are referred to collectively as machine(s).

This document does not cover requirements for

- machines powered by combustion engines; or
- machines driven by an external power source; or
- machines with powered discharge intended to broadcast material or load vehicles; or
- machines with mechanically powered feed intake or **attachments**; or
- wood chippers for forestry, agriculture, horticulture and landscaping.

2 Normative references

IEC 62841-1:2014, Clause 2, is applicable, except as follows.

Addition:

IEC 60664-3:2016, *Insulation coordination for equipment within low-voltage systems – Part 3: Use of coating, potting or moulding for protection against pollution*

IEC 60664-4:2005, *Insulation coordination for equipment within low-voltage systems – Part 4: Consideration of high-frequency voltage stress*

IEC 61058-1-1:2016, *Switches for appliances – Part 1-1: Requirements for mechanical switches*

IEC 61058-1-2:2016, *Switches for appliances – Part 1-2: Requirements for electronic switches*

IEC 61058-2-6:2018, *Switches for appliances – Part 2-6: Particular requirements for switches used in electric motor-operated hand-held tools, transportable tools and lawn and garden machinery*

IEC 61672-1:2013, *Electroacoustics – Sound level meters – Part 1: Specifications*

IEC 62841-1:2014, *Electric motor-operated hand-held tools, transportable tools and lawn and garden machinery – Safety – Part 1: General requirements*

ISO 354:2003, *Acoustics – Measurement of sound absorption in a reverberation room*

ISO 13857:2019, *Safety of machinery – Safety distances to prevent hazard zones being reached by upper and lower limbs*

ISO 21920-3:2021, *Geometrical product specifications (GPS) – Surface texture: Profile – Part 3: Specification operators*

Replacement:

IEC 61058-1:2016, *Switches for appliances – Part 1: General requirements*

ISO 3744:2010, *Acoustics – Determination of sound power levels and sound energy levels of noise sources using sound pressure – Engineering methods for an essentially free field over a reflecting plane*

ISO 11201:2010, *Acoustics – Noise emitted by machinery and equipment – Determination of emission sound pressure levels at a workstation and at other specified positions in an essentially free field over a reflecting plane with negligible environmental corrections*

3 Terms and definitions

[IEC 62841-4-8:2025](https://standards.iteh.ai/catalog/standards/iec/62841-4-8:2025)

IEC 62841-1:2014, Clause 3, is applicable, except as follows.

Addition:

3.101

appliance inlet

device which is incorporated in the enclosure of the machine for insertion of an electrical plug connection to the mains supply

3.102

debris collector

part or combination of parts that is required for **normal operation** of the machine and provides a means for collecting organic material from the **discharge chute**

3.103

direct opening action

achievement of contact separation as a direct result of a specified movement of the switch actuator through non-resilient members (e.g. non-dependent upon springs)

3.104

discharge chute

extension of the opening through which the shredded or chipped material is discharged

3.105**feed intake opening**

opening through which material is inserted to be fed to the **shredding means**

Note 101 to entry: A **feed intake opening** can become a **feed safety opening(s)** if the relevant safety distance from the **shredding means** is met.

3.106**feed safety opening**

opening through which material is passed and which is located at the relevant safety distance from the **shredding means**

Note 101 to entry: A feed safety opening can be the same as the **feed intake opening** in 3.105 or at some point between the **feed intake opening** and the **shredding means**.

3.107**maximum speed**

highest steady-state **shredding means** speed attainable under all conditions of **normal use**, including no-load, when adjusted in accordance with the manufacturer's specifications and/or instructions

Note 101 to entry: The steady-state **shredding means** speed excludes transients such as overshoot that can occur before attaining a steady-state condition.

3.108**screen****grid**

perforated piece or bar(s) located between the **shredding means** and **discharge chute** or opening of the machine to assist in reducing organic materials to smaller pieces

3.109**shredder/chipper**

machine designed for use in a stationary position having a **shredding means** for the purpose of reducing organic materials to smaller pieces

Note 101 to entry: See Figure 101.

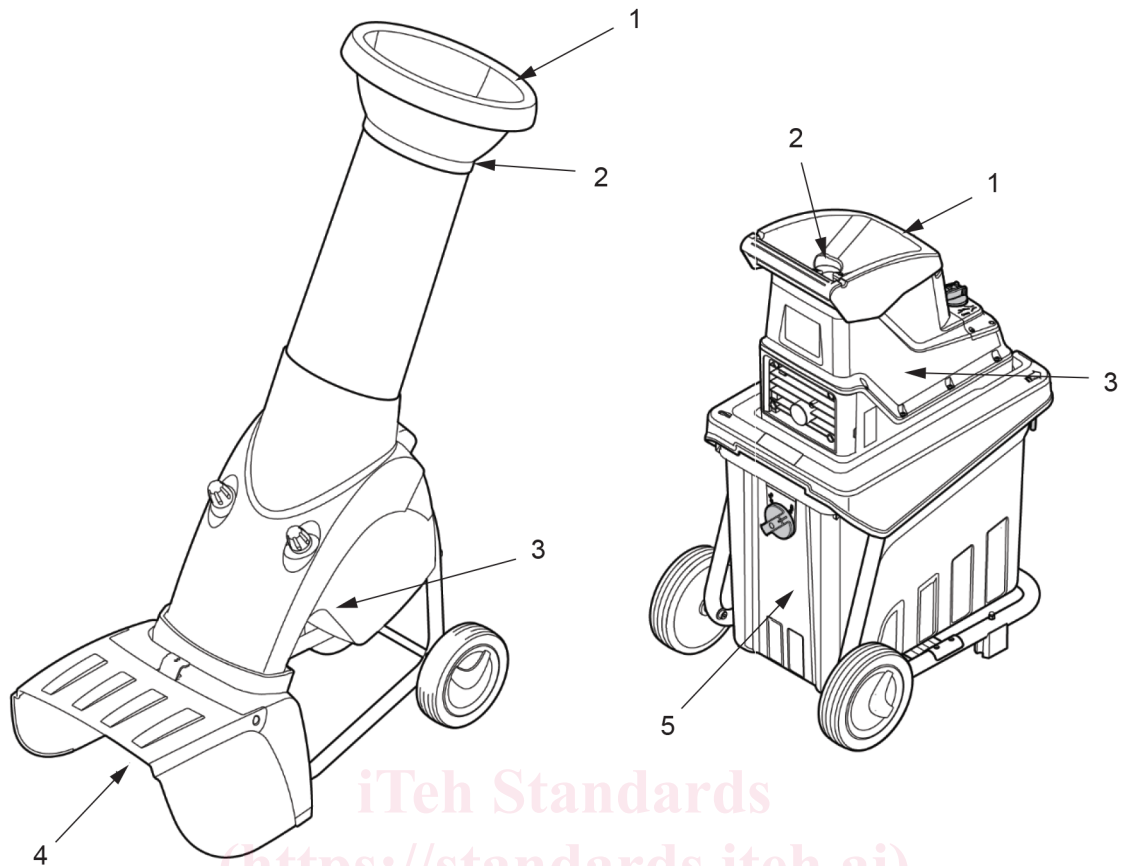

Key

- 1 feed intake opening
- 2 feed safety opening
- 3 shredding means
- 4 discharge chute
- 5 debris collector

Figure 101 – Examples of a shredder/chipper

3.110

shredding means

mechanism consisting of one or more cutting means with or without a **screen (grid)**, designed to reduce the size of organic material to smaller pieces

4 General requirements

IEC 62841-1:2014, Clause 4, is applicable, except as follows.

Replacement of the first paragraph:

Machines shall be so constructed that they operate safely so as to cause no danger to persons or surroundings, both under intended use as well as under reasonably foreseeable misuse.

5 General conditions for the tests

IEC 62841-1:2014, Clause 5, is applicable, except as follows.

5.17 Addition:

*The mass of the machine includes the **shredding means** and **debris collector** (empty) (if any), in the heaviest configuration in accordance with 8.14.2.*

5.101 *The tests are performed using all **shredding means** in accordance with 8.14.2 a) 104).*

6 Radiation, toxicity and similar hazards

IEC 62841-1:2014, Clause 6, is applicable.

7 Classification

IEC 62841-1:2014, Clause 7, is applicable, except as follows.

7.2 Addition:

Class I tools (machines) and **class II tools** (machines) shall be at least IPX4. **Class III tools** (machines) shall be at least IPX1.

8 Marking and instructions

IEC 62841-1:2014, Clause 8, is applicable, except as follows.

8.1 Replacement of the third dash:

- for machines intended to be operated continuously, the **rated input**, in watts, or **rated current**, in amperes. The **rated input** or **rated current** to be marked on the machine is the total maximum input or current that can be drawn from external circuit at the same time. If a machine has alternative components which can be selected by a **control device**, the **rated input** or **rated current** is that corresponding to the highest loading possible;

Addition:

- for machines intended to be operated intermittently, the **rated input**, in watts, or **rated current**, in amperes. The **rated input** or **rated current** to be marked on the machine is the total maximum input or current that can be drawn from external circuit at the same time. If a machine has alternative components which can be selected by a **control device**, the **rated input** or **rated current** is that corresponding to the highest loading possible. The marking of the **rated input** or **rated current** value shall be followed by the text "(P40)".

8.2 Addition:

Shredders/chippers shall be marked with the following safety warnings:

- "⚠️WARNING – Rotating blades. Keep hands and feet out of openings while machine is running" or one of the product safety labels specified in Figure AA.1;
- "⚠️WARNING – Keep bystanders away", or "⚠️WARNING – Keep bystanders away by at least _____", where "_____" is the recommended minimum distance between the machine and the bystander, or one of the product safety labels specified in Figure AA.2;

- "⚠️ WARNING – Beware of thrown objects" or a relevant safety sign of ISO 7010 or the product safety label specified in Figure AA.3;
- "⚠️ WARNING – Remove plug from mains before maintenance or if the cord is damaged" or one of the product safety labels specified in Figure AA.4;
- "Wear eye protection" or a relevant safety sign of ISO 7010 or one of the product safety labels specified in Figure AA.5;
- "Wear ear protection" or a relevant safety sign of ISO 7010 or the product safety label specified in Figure AA.6. This marking may be omitted if the measured A-weighted emission sound pressure level at the operator's ear in accordance with Annex I does not exceed 85 dB(A);

A combination of ISO 7010 safety signs for eye and ear protection is allowed. In addition, a combination of product safety labels as specified in Figure AA.7 is allowed.

- "Wear protective gloves" or symbol ISO 7010-M009:2011-05;
- "⚠️ WARNING – Wait until all machine components have completely stopped before touching them" or the product safety label specified in Figure AA.8. This marking shall be located in the vicinity of the **discharge chute** and also visible before opening or removing any **guard** in accordance with 19.103 that is designed to be opened or removed for **user maintenance** that permits access to moving parts in accordance with 8.14.2 c) 106). This requirement may be fulfilled by one or more warnings or product safety labels;
- when a **guard** or **debris collector** is so positioned or shaped that it could be misused as a step, there shall be a warning marking "Do not use as a step" or symbol ISO 7010-P024:2011-05, located as close as practicable to the **guard** or **debris collector**.

8.3 Addition:

The **shredding means**, where replaceable during **user maintenance**, shall be marked to identify the part number(s) and the manufacturer, importer or supplier. This marking is not required to be clearly discernible from the outside of the machine.

Replacement of the sixth dashed item:

- "> 25 kg" or the mass of the machine in kg if the mass of the machine is over 25 kg. For this requirement, the mass of the machine shall be the mass specified in 8.14.3.

NOTE 101 In Europe (EN IEC 62841-4-8), the following requirement applies:

Replacement of the sixth dashed item:

- the mass of the machine in kg. For this requirement, the mass of the machine shall be the mass specified in 8.14.3.

8.4 Addition:

The warning marking "Do not use as a step" or symbol ISO 7010-P024:2011-05 specified in 8.2 may be located on the **guard** or **debris collector** if it is a **detachable part**.

The warning or product safety label that is visible before opening or removing any **guard** in accordance with 19.103 specified in 8.2 may be located on the **guard** if it is a **detachable part**.

8.9 Addition:

This requirement is not applicable for the **power switch**.