



Designation: D4364 – 13 (Reapproved 2022)^{ε1}

Standard Practice for Performing Outdoor Accelerated Weathering Tests of Plastics Using Concentrated Sunlight¹

This standard is issued under the fixed designation D4364; the number immediately following the designation indicates the year of original adoption or, in the case of revision, the year of last revision. A number in parentheses indicates the year of last reapproval. A superscript epsilon (ϵ) indicates an editorial change since the last revision or reapproval.

^{ε1} NOTE—Reapproved with editorial changes in January 2022.

1. Scope*

1.1 This practice covers the use of Fresnel-reflecting concentrators that use the sun as a source of ultraviolet (UV) and longer wavelength radiation. Such devices are used in the outdoor accelerated exposure testing of plastics.

1.2 This practice provides a procedure for performing outdoor accelerated exposure testing of plastics using a Fresnel-reflector outdoor accelerated weathering test machine. The apparatus is described herein and in Practice G90 more completely.

1.3 This practice is applicable to a range of plastic materials including, but not limited to, plastic films, sheets, laminates, and extruded and molded products in a variety of shapes and sizes, as specified in 8.2 and 8.3.

1.4 This practice describes test conditions that attempt to simulate plastics exposures in desert and subtropical climates. Specimen preparation, property testing procedures, and the evaluation of results are covered in existing test methods or specifications for specific materials.

1.5 The values stated in SI units are to be regarded as standard. No other units of measurement are included in this standard.

1.6 *This standard does not purport to address all of the safety concerns, if any, associated with its use. It is the responsibility of the user of this standard to establish appropriate safety, health, and environmental practices and determine the applicability of regulatory limitations prior to use.* Specific precautionary statements are given in Section 7.

NOTE 1—This standard is equivalent to ISO 877-3: 2009.

1.7 *This international standard was developed in accordance with internationally recognized principles on standardization established in the Decision on Principles for the Development of International Standards, Guides and Recom-*

mendations issued by the World Trade Organization Technical Barriers to Trade (TBT) Committee.

2. Referenced Documents

2.1 ASTM Standards:²

- D859 Test Method for Silica in Water
- D883 Terminology Relating to Plastics
- D1435 Practice for Outdoor Weathering of Plastics
- D1600 Terminology for Abbreviated Terms Relating to Plastics
- D1898 Practice for Sampling of Plastics (Withdrawn 1998)³
- D4141/D4141M Practice for Conducting Black Box and Solar Concentrating Exposures of Coatings
- D4517 Test Method for Low-Level Total Silica in High-Purity Water by Flameless Atomic Absorption Spectroscopy
- E772 Terminology of Solar Energy Conversion
- E824 Test Method for Transfer of Calibration From Reference to Field Radiometers
- G7/G7M Practice for Natural Weathering of Materials
- G24 Practice for Conducting Exposures to Daylight Filtered Through Glass
- G90 Practice for Performing Accelerated Outdoor Weathering of Materials Using Concentrated Natural Sunlight
- G113 Terminology Relating to Natural and Artificial Weathering Tests of Nonmetallic Materials

2.2 ISO Standard:⁴

- ISO 877-3: 2009 Plastics—Methods of exposure to solar radiation—Part 3: Intensified weathering using concentrated solar radiation

² For referenced ASTM standards, visit the ASTM website, www.astm.org, or contact ASTM Customer Service at service@astm.org. For *Annual Book of ASTM Standards* volume information, refer to the standard's Document Summary page on the ASTM website.

³ The last approved version of this historical standard is referenced on www.astm.org.

⁴ Available from American National Standards Institute (ANSI), 25 W. 43rd St., 4th Floor, New York, NY 10036, <http://www.ansi.org>.

¹ This practice is under the jurisdiction of ASTM Committee D20 on Plastics and is the direct responsibility of Subcommittee D20.50 on Durability of Plastics.

Current edition approved Jan. 1, 2022. Published February 2022. Originally approved in 1984. Last previous edition approved in 2013 as D4364 – 13. DOI: 10.1520/D4364-13R22E01.

*A Summary of Changes section appears at the end of this standard

3. Terminology

3.1 *Definitions*—For definitions of technical terms pertaining to plastics used in this practice, see Terminologies **D883**, **D1600**, **E772**, and **G113** (for weathering terminology).

4. Significance and Use

4.1 This practice involves the concentration of sunlight by a system of plane mirrors, arranged to simulate a parabolic trough focused on an air-cooled target board on which the test specimens are mounted. Exposure cycles with and without water spray that are commonly used for this method are described in **Table 1**. Other exposure cycles not listed in **Table 1** can be used, upon consensual agreement between interested parties.

4.1.1 Accelerated outdoor exposure tests performed using this practice in an absence of a programmed moisture cycle are intended to simulate conventional exposure testing on racks facing the equator in desert and arid regions.

4.1.2 Accelerated outdoor exposure tests performed using this practice with a programmed moisture cycle shall possess the feature of spraying high purity water on the specimens in a regular, periodic fashion that is intended to simulate the results of conventional exposure testing on fixed racks facing the equator in subtropical, semi-humid, and temperate regions. Water-spray cycles that are recommended by this practice are given in **Table 1**.

4.2 The effectiveness of the Fresnel-reflector accelerated outdoor weathering test machines depends primarily on the amount and character of the UV in the direct-beam component of sunlight.

NOTE 2—Use of the apparatus in regions of moderate- to high-diffuse irradiance will reduce the test machine’s effectiveness substantially for providing concentrated UV in the target (specimen) area.

4.3 Testing to specific levels (quantities) of solar ultraviolet radiant exposure is recommended. Elapsed time exposure-level determinations shall not be used for testing with this practice. Testing to specific levels of UV irradiation, whether to total UV or within selected wavebands, is an effective method for improving agreement between wintertime and summertime testing on the Fresnel-reflector weathering-test machines. Other seasonal factors such as temperature and time of wetness can affect the weathering of test specimens significantly.

4.4 The weathering machines described provide for specimen cooling that reduces thermal problems in most materials. It is recommended that monthly temperature measurements be

performed on heat-sensitive plastics to record the typical monthly test specimen temperatures.

NOTE 3—It is possible for heat-sensitive plastic materials and thick specimens that are self-insulating to exhibit thermal-induced degradation that is unrealistic compared to natural weathering. Clear, thin-film photodegradable plastics are not recommended for testing with this practice for this reason.

4.5 Since the natural environment varies with respect to time, geography, and topography, it can be expected that the effects of natural exposure will vary accordingly. Furthermore, all materials are not affected equally by increased irradiance and temperature. The quantitative correlation between exposures conducted in accordance with this practice and those conducted under specified natural exposure conditions will therefore vary with the type and composition of the material.

4.6 While reference materials tested in accordance with this practice and Practices **G7/G7M** and **D1435** are useful for providing information on the relationship between accelerated and real-time tests, the acceleration factor found for the reference material cannot be used to extrapolate results of the accelerated test to predict lifetimes under natural exposure except for the specific material for which the relationship has been established.

5. Apparatus

5.1 The testing apparatus shall be a Fresnel-reflecting device possessing ten flat mirrors that focus direct sunlight onto an air-cooled specimen area. A more complete description of the apparatus can be found in Practice **G90**. See **Fig. 1** (Single Axis Tracking) and **Fig. 2** (Dual Axis Tracking).

NOTE 4—The apparatus should be operated in dry, sunny climates receiving 3500 to 4000 h or more of sunshine per year and an average annual relative humidity of approximately 30 % or less.

5.2 *Water Quality:*

5.2.1 The purity of water used for specimen spray is very important. Without proper treatment to remove cations, anions, organics, and particularly silica, exposed panels will develop spots or stains that do not occur in exterior exposures.

5.2.2 Water used for specimen spray shall leave no objectionable deposits or stains on the exposed specimens. It is strongly recommended that the water contain below 1 ppm solids and below 0.2 ppm silica. Determine silica levels in accordance with the procedures in Test Methods **D859** or **D4517**. Prepackaged analysis kits are commercially available that are capable of detecting silica levels of below 200 ppb. A

TABLE 1 Fresnel-Reflector Test Machine Standard Spray Cycles

Cycle	Daytime			Nighttime		
	Spray Duration	Dry-Time Duration	Cycles, h	Spray Duration	Dry-Time Duration	Cycles, h
1	8 min	52 min	1	8 min	172 min	Water is sprayed on the test specimens at: 9:00 p.m. 12:00 midnight 3:00 a.m.
2	no water spray used			no water spray used		
3 ^A	no water spray used			3 min	12 min	4 cycles per hour (from 7PM to 5 AM)

^A This is the cycle specified in Procedure C of Practice **D4141/D4141M**.

- | | |
|--------------------------|-----------------------------|
| A - AIR PLENUM | H - MAST, AZIMUTH ADJUST |
| B - AIR BLOWER | I - AIR FLOW SWITCH |
| C - ROTOR ASSEMBLY | J - WATER SPRAY NOZZLE |
| D - AIR DEFLECTOR | K - CLUTCH DISC, ELEV DRIVE |
| E - A-FRAME ASSEMBLY | L - SOLAR CELLS/SHADOW HAT |
| F - MIRROR | M - SAMPLE PROTECTION DOOR |
| G - GEAR BOX, ELEV DRIVE | N - DOOR RELEASE MECHANISM |

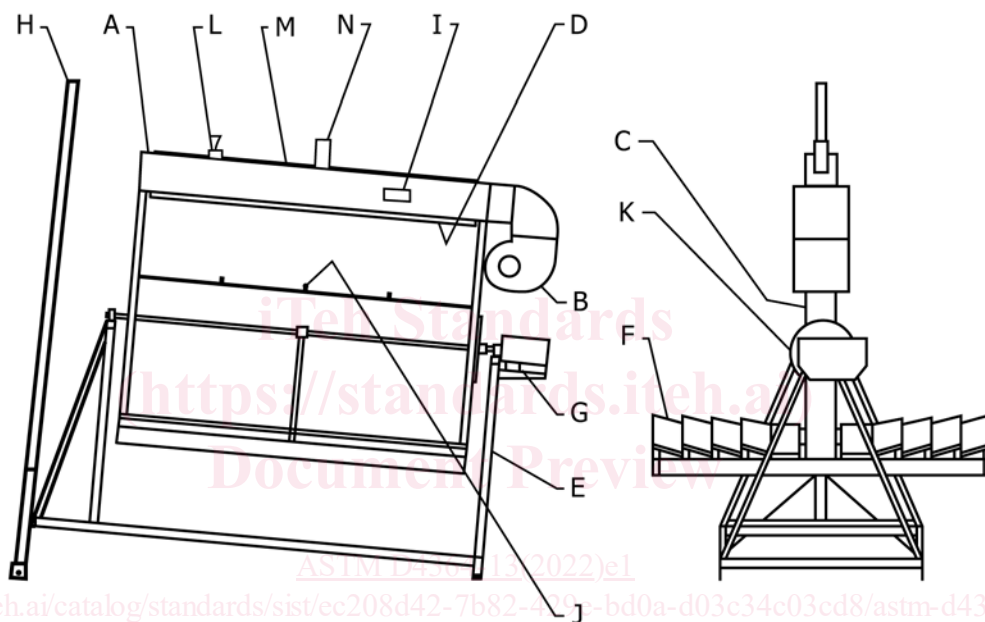

FIG. 1 Schematic of a Fresnel-Reflecting Concentrator-Accelerated Weathering Machine Single Axis Tracking

combination of deionization and reverse-osmosis treatment can produce water with the desired purity effectively. The solids and silica levels must be reported if the spray water used is above 1 ppm solids.

5.2.3 If specimens are found to have deposits or stains after exposure in the apparatus, the water purity must be checked to determine if it meets the requirements above. On some occasions, exposed specimens can be contaminated by deposits from bacteria that can grow in the purified water used for specimen spray. If bacterial contamination is detected, the entire system used for specimen spray must be flushed with chlorine and thoroughly rinsed before resuming exposures. Although it does not always correlate with silica content, it is recommended that resistivity of water used for specimen spray be continuously monitored and that exposures be discontinued whenever the resistivity falls below 1 MΩ.

6. Reagents and Materials

6.1 Water shall conform to the specifications presented in 5.2.1 – 5.2.3.

6.2 The mirrors used on Fresnel-reflector test machines shall be flat and have a specular UV reflectance of 65 % or greater at 310 nm wavelength.

7. Safety Precautions

7.1 Suitable eye protection shall be required when working with Fresnel-reflector test machines to prevent UV and infrared damage. Manipulation of the reflectors for daily maintenance, or for the purpose of specimen mounting, dismounting, and inspection, can reflect the concentrated sunlight on the face accidentally. The use of sunglasses that absorb most of the UV radiation below 360-nm wavelength is essential; aluminized glasses will prevent accidental burning of the retina by infrared.

7.2 Suitable clothing or sunscreen ointments having an SPF of 15 or higher, or both, need to be used to cover exposed skin for persons working with the test machines described in this practice.

- | | |
|---|-----------------------------|
| A - AIR PLENUM | I - GEAR BOX, AZIMUTH DRIVE |
| B - AIR BLOWER | J - AIR FLOW SWITCH |
| C - ROTOR ASSEMBLY | K - WATER SPRAY NOZZLE |
| D - TURN TABLE ASSEMBLY | L - CLUTCH DISC, ELEV DRIVE |
| E - A-FRAME ASSEMBLY | M - SOLAR CELLS/SHADOW HAT |
| F - MIRROR | N - SAMPLE PROTECTION DOOR |
| G - GEAR BOX, ELEV DRIVE | O - DOOR RELEASE MECHANISM |
| H - CONTROL BOX </td <td>P - AIR DEFLECTOR</td> | P - AIR DEFLECTOR |

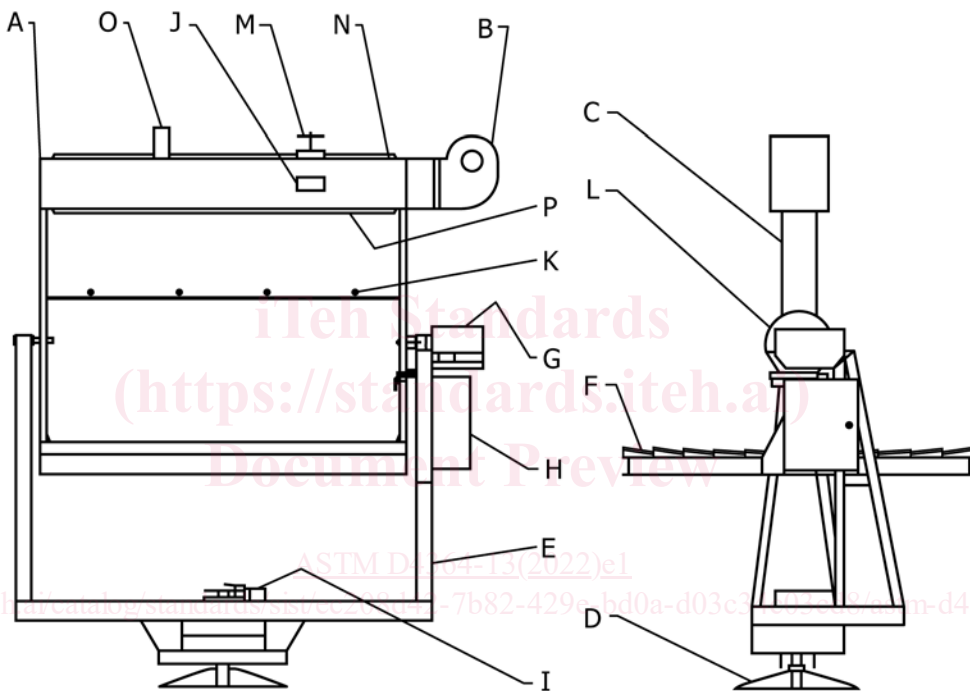

FIG. 2 Schematic of Fresnel-Reflecting Concentrator Accelerated Weathering Machine Dual Axis Tracking

7.3 The squirrel-cage blower shall be covered with a heavy-duty protective screen to prevent accidental injury and to keep loose clothing from the fan during startup, shutdown, maintenance, inspection, or specimen exchange.

8. Test Specimens

8.1 It is strongly recommended that users of this accelerated outdoor exposure practice follow the statistical procedures for sampling presented in Practice D1898.

8.2 The target dimensions presently used for most Fresnel-reflector accelerated weathering machines are 130 by 1400 mm. The target dimensions shall dictate the test specimen dimensions.

8.3 It is strongly recommended that the maximum specimen thickness used is 13 mm. The air cooling process and mechanism dictates that the thickness of test specimens be limited to

13 mm. The adequacy of cooling can be questionable for test specimens thicker than 13 mm.

8.4 Test specimens smaller than the maximum size shall be arranged as shown in Practice G90.

9. Procedures

9.1 Mounting:

9.1.1 Mount the test specimens in a suitable frame such that a minimum of the test specimen is covered by the clamping fixture used.

NOTE 5—A masked area or specimen overlapping should not be used in an attempt to estimate the effects of a dark exposure at the same temperature since a masked area or specimen overlapping is not unexposed and the temperature may actually be higher than the unmasked areas.

9.1.2 Mount the framed test specimens approximately 5 mm off the target board. Position the specimen such that adequate