



Designation: C686 – 17 (Reapproved 2023)

Standard Test Method for Parting Strength of Mineral Fiber Batt- and Blanket-Type Insulation¹

This standard is issued under the fixed designation C686; the number immediately following the designation indicates the year of original adoption or, in the case of revision, the year of last revision. A number in parentheses indicates the year of last reapproval. A superscript epsilon (ϵ) indicates an editorial change since the last revision or reapproval.

1. Scope

1.1 This test method covers evaluation of strength in tension on mineral fiber batt- and blanket-type insulation products. It is useful for determining the comparative tensile properties of these products, specimens of which cannot be held by the more conventional clamp-type grips. This is a quality control method, and the results shall not be used for design purposes. It is not suitable for board-type products.

1.2 The values stated in inch-pound units are to be regarded as standard. The values given in parentheses are mathematical conversions to SI units that are provided for information only and are not considered standard.

1.3 *This standard does not purport to address all of the safety concerns, if any, associated with its use. It is the responsibility of the user of this standard to establish appropriate safety, health, and environmental practices and determine the applicability of regulatory limitations prior to use.*

1.4 *This international standard was developed in accordance with internationally recognized principles on standardization established in the Decision on Principles for the Development of International Standards, Guides and Recommendations issued by the World Trade Organization Technical Barriers to Trade (TBT) Committee.*

2. Referenced Documents

2.1 *ASTM Standards:*²

C167 Test Methods for Thickness and Density of Blanket or Batt Thermal Insulations

E171 Practice for Conditioning and Testing Flexible Barrier Packaging

E691 Practice for Conducting an Interlaboratory Study to Determine the Precision of a Test Method

¹ This test method is under the jurisdiction of ASTM Committee C16 on Thermal Insulation and is the direct responsibility of Subcommittee C16.32 on Mechanical Properties.

Current edition approved March 1, 2023. Published March 2023. Originally approved in 1971. Last previous edition approved in 2017 as C686 – 17. DOI: 10.1520/C0686-17R23.

² For referenced ASTM standards, visit the ASTM website, www.astm.org, or contact ASTM Customer Service at service@astm.org. For *Annual Book of ASTM Standards* volume information, refer to the standard's Document Summary page on the ASTM website.

3. Significance and Use

3.1 Tensile strength is a fundamental property associated with mineral fiber manufacture since it is influenced by the type of fiber, the deposition of fiber, the type and the amount of bonding agent, and the method of curing the resin to form a bonded insulation product. The test is an indication of product integrity and the ability of the product to be successfully handled and applied in the field.

4. Apparatus

4.1 *Constant Rate of Traverse Tension Test Unit* of 50-lbf (223-N) capacity calibrated in increments of 0.1 lbf (0.4 N) and having a moving head speed of 12 in. (305 mm)/min or equivalent (see Fig. 1).

4.2 *Post-Type Grips* with 1-in. (25.4-mm) diameter rods (see Fig. 2).

4.3 *Die* for cutting specimens (see Fig. 3). The O-ring specimen dimensions are 3 by 4.75 in. (76 by 120.6 mm) in outside diameter, and 1 by 2.75 in. (25 by 69.8 mm) in inside diameter (see Fig. 4).

4.4 *Balance* to weigh to an accuracy of 0.01 g.

5. Test Specimen

5.1 The test specimen shall consist of the entire O-ring cut from the full thickness of the product to be tested.

5.2 Specimens shall not be cut from a product that varies in thickness $\pm 5\%$ from normal when tested in accordance with Test Method C167.

5.3 No specimen shall be tested that exhibits any obvious damage in the insulation or that shows delamination within the insulation thickness.

6. Conditioning

6.1 Condition the specimens for 1 h in a room maintained at atmospheric conditions of $73.4 \pm 1.8^\circ\text{F}$ ($23 \pm 1^\circ\text{C}$) and $50 \pm 2\%$ relative humidity in accordance with Specification E171.

7. Procedure

7.1 Weigh each specimen to the nearest 0.01 g and record the weight.

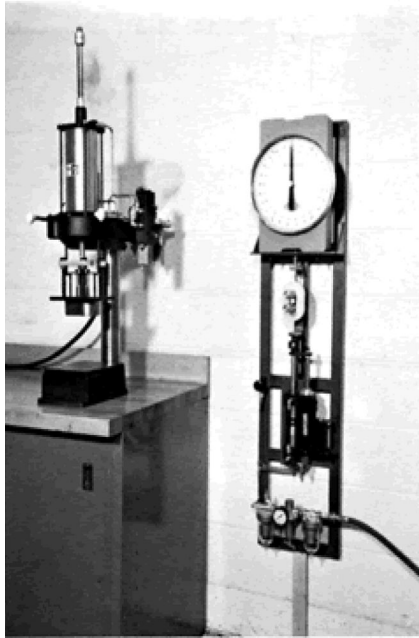

FIG. 1 Tension Test Units

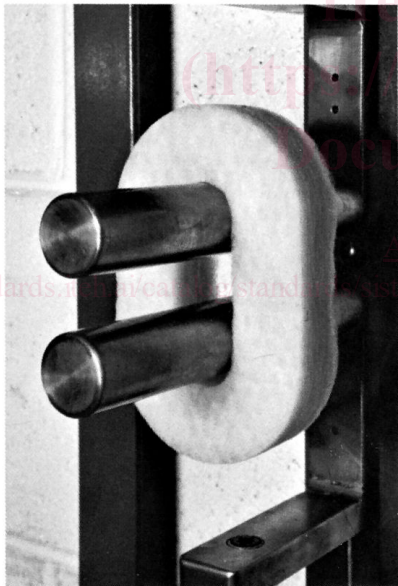

FIG. 2 Post-Type Grips

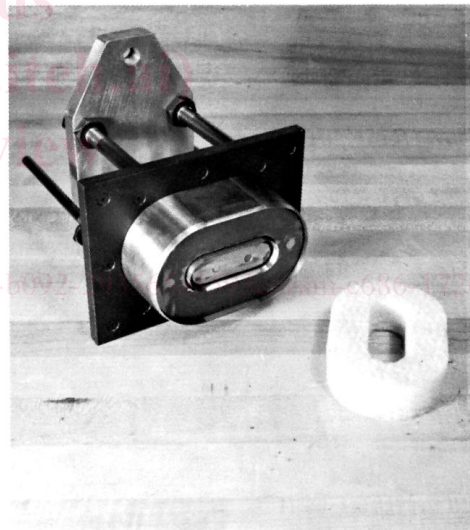

FIG. 3 Specimen Die Cutter

7.2 Attach the post-type grips to the tension test unit and align the grips in the vertical plane.

7.3 Adjust the speed of the moving head to 12 in. (305 mm)/min.

7.4 Set the stops of the moving head until the grips are approximately ¼ in. (6.3 mm) apart in the starting position.

7.5 Place the specimen on the post-type grip (higher density side first if it is evident that such exists) so that both posts are within the oblong hole of the specimen. The high density side of the specimen shall be in contact with the post shield.

7.6 Apply the load; read and record the maximum load to failure to the nearest 0.1 lbf (0.4 N).

7.7 Test ten specimens each cut in the machine and cross-machine directions. If the machine direction is not readily determinable, refer to the longest dimension of the sample to be tested as lengthwise and call the shortest dimension cross-wise.

8. Calculation

8.1 Calculate the parting strength, S , in grams per gram as follows:

$$S = (L \times 453.59) / W \quad (1)$$

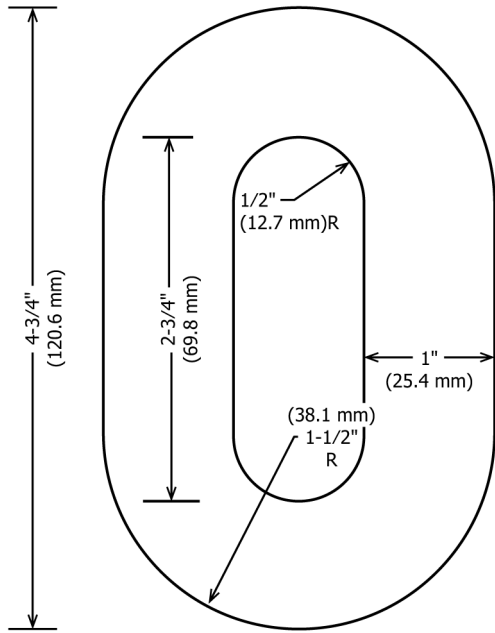

FIG. 4 Test Specimen

where:

- L = breaking load, lbf, and
- W = weight of specimen, g.

9. Report

- 9.1 The report shall include the following:
 - 9.1.1 Thickness and density of the product being reported in accordance with Test Method C167,
 - 9.1.2 Weight and load at failure of each specimen,
 - 9.1.3 Calculated parting strength for each specimen,
 - 9.1.4 Total number of specimens tested in both the machine and cross-machine direction, and
 - 9.1.5 Average of the parting strength in the machine and cross-machine direction.

10. Precision and Bias³

10.1 *Precision*—An interlaboratory round robin involving four laboratories and three specimens was conducted in 1988. Specimens were tested in both machine and crossmachine directions. The three mineral fiber samples were typical of current production. Table 1 gives the results of the round robin which were analyzed using Practice E691 guidelines.

10.2 *Bias*—Since there are no reference materials available for this test method, it is not possible to estimate bias.

11. Keywords

- 11.1 insulation; physical strength; tensile strength

³ Supporting data have been filed at ASTM International Headquarters and may be obtained by requesting Research Report RR:16-1013.

iTeh Standards
 (https://standards.itih.ai)
 Document Preview

ASTM C686-17(2023)

<https://standards.itih.ai/catalog/standards/sist/0b496315-99b9-46af-b092-293565a3593c/astm-c686-172023>