International Standard



6533

INTERNATIONAL ORGANIZATION FOR STANDARDIZATION • МЕЖДУНАРОДНАЯ ОРГАНИЗАЦИЯ ПО СТАНДАРТИЗАЦИИ • ORGANISATION INTERNATIONALE DE NORMALISATION

Forestry machinery — Portable chain saws — Front hand guard — Dimensions

Machines forestières — Scies à chaîne portatives — Dispositif de protection de la main tenant la poignée avant — Dimensions

First edition — 1983-08-15

ITeH STANDARD PREVIEW
(standards.iteh.ai)

[ISO 6533:1983](#)

<https://standards.iteh.ai/catalog/standards/sist/f9b92cd0-cbee-474e-9ae5-56b8a6cd9ff9/iso-6533-1983>

UDC 621.936.6 : 634.0.36

Ref. No. ISO 6533-1983 (E)

Descriptors : agricultural machinery, portable equipment, wood working, saws, dimensions.

Price based on 3 pages

Foreword

ISO (the International Organization for Standardization) is a worldwide federation of national standards bodies (ISO member bodies). The work of developing International Standards is carried out through ISO technical committees. Every member body interested in a subject for which a technical committee has been authorized has the right to be represented on that committee. International organizations, governmental and non-governmental, in liaison with ISO, also take part in the work.

Draft International Standards adopted by the technical committees are circulated to the member bodies for approval before their acceptance as International Standards by the ISO Council.

International Standard ISO 6533 was developed by Technical Committee ISO/TC 23, *Tractors and machinery for agriculture and forestry*, and was circulated to the member bodies in October 1981.

ITeH STANDARD PREVIEW
(standards.iteh.ai)

It has been approved by the member bodies of the following countries :

Australia	Finland	Portugal
Austria	Germany, F. R.	Romania
Belgium	India	South Africa, Rep. of
Brazil	Iraq	Spain
Canada	Italy	Sweden
China	Mexico	Turkey
Czechoslovakia	New Zealand	United Kingdom
Denmark	Poland	USA

The member body of the following country expressed disapproval of the document on technical grounds :

France

Forestry machinery — Portable chain saws — Front hand guard — Dimensions

iTeh STANDARD PREVIEW
(standards.iteh.ai)

1 Scope and field of application

This International Standard specifies the dimensions and clearances of front hand guards on portable hand-held chain saws.

2 Dimensions and clearances

The limiting dimensions and clearances of the front hand guard, measured relative to the centre line of the guide bar at the midpoint of the guard length, shall be as shown in the figure and given in the table.

If the guard is a brake arm, a force of 10 N shall be applied, at 45° in a forward and downward direction, at the centre of the top edge when dimensions *A*, *F*, *G* and *H* are measured.

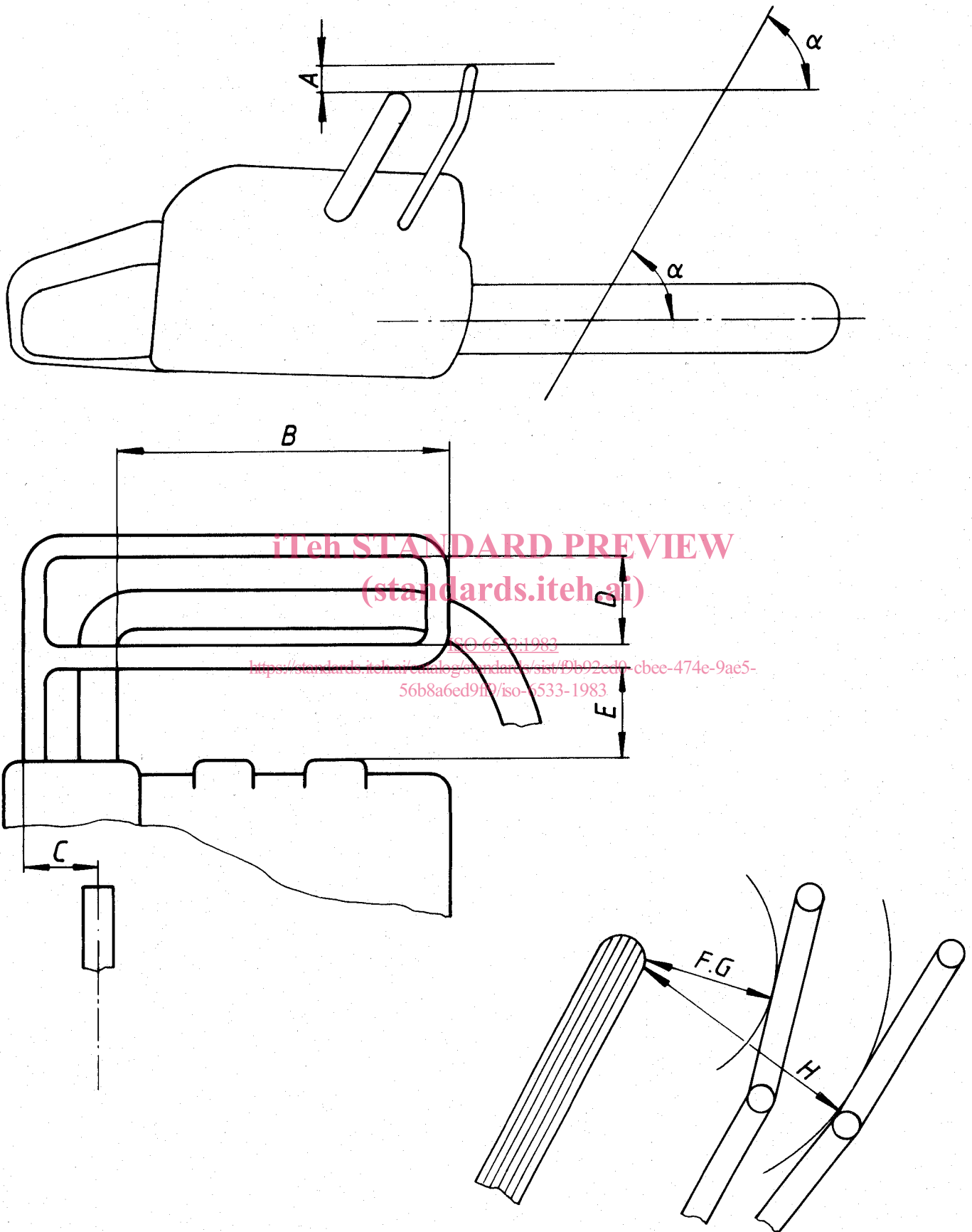

Figure – Dimensions and clearances

Table — Dimensions and clearances

Dimension in figure	Description	Dimension mm
<i>A</i>	Minimum guard height (measured perpendicular to the centre line of the guide bar). ¹⁾	20
<i>B</i>	Minimum effective guard length (measured from the right inside surface of the right end of the front handle) ²⁾	100
<i>C</i>	Minimum overlap, guard-guide bar vertical to the plane of the guide bar	0
<i>D</i>	Maximum guard opening ³⁾⁴⁾	55
<i>E</i>	Maximum clearance between the lower edge of the guard and the nearest part of the saw body (for example, fuel caps) ²⁾³⁾⁴⁾	55
<i>F</i>	Minimum clearance between any part of guard and front handle	40
<i>G</i>	Maximum clearance between any part of guard and front handle	70
<i>H</i>	Maximum clearance between any part of guard and front handle when the guard is released	100

1) The measurement shall be made in relation to the horizontal plane parallel to the centre line of the bar through the middle of dimension *B*.

2) The measurement shall apply from the right inside surface of the right end of the front handle or the point where the vertical distance between saw housing and handle is 35 mm (for dimension *E* to a point 100 mm to the left).

3) The intention is to provide an obstacle to prevent the hand from passing through.

4) A cylindrical gauge, 56 mm in diameter and 82 mm long, held parallel to the hand guard, and pushed forward with a force of 30 N shall not pass through. (For dimension *E*, the procedure shall be applied between the lower edge of the guard and the nearest part of the saw body in any parallel position over the whole range of 100 mm.)

(standards.iteh.ai)

ISO 6533:1983

<https://standards.iteh.ai/catalog/standards/sist/f9b92cd0-cbee-474e-9ae5-56b8a6ed9ff9/iso-6533-1983>

iTeh STANDARD PREVIEW
(standards.iteh.ai)

ISO 6533:1983

<https://standards.iteh.ai/catalog/standards/sist/f9b92cd0-cbee-474e-9ae5-56b8a6ed9ff9/iso-6533-1983>

iTeh STANDARD PREVIEW
(standards.iteh.ai)

ISO 6533:1983

<https://standards.iteh.ai/catalog/standards/sist/f9b92cd0-cbee-474e-9ae5-56b8a6ed9ff9/iso-6533-1983>

iTeh STANDARD PREVIEW
(standards.iteh.ai)

ISO 6533:1983

<https://standards.iteh.ai/catalog/standards/sist/f9b92cd0-cbee-474e-9ae5-56b8a6ed9ff9/iso-6533-1983>