

INTERNATIONAL STANDARD

ISO
6699

First edition
1990-11-01

Cycles — Stem and handlebar bend — Assembly dimensions

iTeh STANDARD PREVIEW
Cycles — Potence et cintre de guidon — Dimensions d'assemblage
(standards.iteh.ai)

ISO 6699:1990

<https://standards.iteh.ai/catalog/standards/sist/8a093556-cef4-4747-ba5b-2973da936128/iso-6699-1990>



Reference number
ISO 6699:1990(E)

Foreword

ISO (the International Organization for Standardization) is a worldwide federation of national standards bodies (ISO member bodies). The work of preparing International Standards is normally carried out through ISO technical committees. Each member body interested in a subject for which a technical committee has been established has the right to be represented on that committee. International organizations, governmental and non-governmental, in liaison with ISO, also take part in the work. ISO collaborates closely with the International Electrotechnical Commission (IEC) on all matters of electrotechnical standardization.

Draft International Standards adopted by the technical committees are circulated to the member bodies for voting. Publication as an International Standard requires approval by at least 75 % of the member bodies casting a vote.

International Standard ISO 6699 was prepared by Technical Committee ISO/TC 149, *Cycles*.

iTeh STANDARD PREVIEW
(standards.iteh.ai)

[ISO 6699:1990](#)

<https://standards.iteh.ai/catalog/standards/sist/8a093556-cef4-4747-ba5b-2973da936128/iso-6699-1990>

© ISO 1990

All rights reserved. No part of this publication may be reproduced or utilized in any form or by any means, electronic or mechanical, including photocopying and microfilm, without permission in writing from the publisher.

International Organization for Standardization
Case Postale 56 • CH-1211 Genève 20 • Switzerland

Printed in Switzerland

Cycles — Stem and handlebar bend — Assembly dimensions

1 Scope

This International Standard specifies the dimensions and tolerances to ensure secure assembly between the stem and the handlebar bend of a bicycle.

It applies to bicycles intended for use on public roads, and on which the saddle can be adjusted to provide a saddle height of 635 mm or more.

It does not apply to specialized types of bicycle such as tradesmen's delivery bicycles, tandems, toy bicycles and bicycles designed and equipped for use in sanctioned competitive events.

2 Normative reference

The following standard contains provisions which, through reference in this text, constitute provisions of this International Standard. At the time of publi-

cation, the edition indicated was valid. All standards are subject to revision, and parties to agreements based on this International Standard are encouraged to investigate the possibility of applying the most recent edition of the standard indicated below. Members of IEC and ISO maintain registers of currently valid International Standards.

ISO 4210:1989, *Cycles — Safety requirements of bicycles*.

3 Dimensions

3.1 External diameter

The handlebar diameter D at the stem interface shall be 25,4 mm $^{0}_{-0,2}$ mm (see figure 1).

Dimensions in millimetres

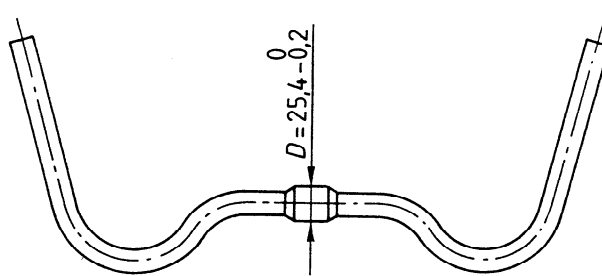

Figure 1 — Handlebar diameter

3.2 Internal diameter

The nominal internal diameter d in the stem shall be 25,4 mm (see figure 2).

3.3 Assembly conditions

The assembly of the stem and the handlebar bend, with the clamping bolt tightened with the torque recommended by the manufacturer, shall comply with the requirements of ISO 4210:1989, clauses 2.3.5 and 4.5.1.1.

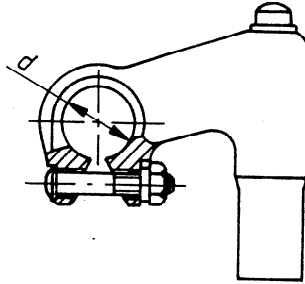

Figure 2 — Nominal stem diameter

iTeh STANDARD PREVIEW
(standards.iteh.ai)

[ISO 6699:1990](https://standards.iteh.ai/catalog/standards/sist/8a093556-cef4-4747-ba5b-2973da936128/iso-6699-1990)

<https://standards.iteh.ai/catalog/standards/sist/8a093556-cef4-4747-ba5b-2973da936128/iso-6699-1990>

UDC 629.118.3-514.5

Descriptors: road vehicles, bicycles, cycle handle-bars, dimensions.

Price based on 2 pages
