



SLOVENSKI STANDARD

SIST EN 14798:2006

01-februar-2006

GHY`YbUYa VUÛjUËFc b]cXd]fU]nUghY`Yb]W'g'_fcbg_]a]dc_fcj _]!'AYfY

Glass packaging - Hand-held crown bottle openers - Dimensions

Verpackungen aus Glas - Manueller Kronenkorköffner - Maße

Emballage en verre - Décapsuleurs manuels - Spécifications

Ta slovenski standard je istoveten z: **EN 14798:2005**

SIST EN 14798:2006
<https://standards.iteh.ai/catalog/standards/sist/cbd5b114-2519-4dcd-83a6-601ace712274/sist-en-14798-2006>

ICS:

55.100	Steklenice. Lonci. Kozarci	Bottles. Pots. Jars
97.180	Razna oprema za dom in trgovino	Miscellaneous domestic and commercial equipment

SIST EN 14798:2006

en,fr,de

iTeh STANDARD PREVIEW
(standards.iteh.ai)

SIST EN 14798:2006

<https://standards.iteh.ai/catalog/standards/sist/ebd3b114-2519-4dcd-83a6-601aee712274/sist-en-14798-2006>

EUROPEAN STANDARD
NORME EUROPÉENNE
EUROPÄISCHE NORM

EN 14798

October 2005

ICS 55.100; 97.180

English Version

Glass packaging - Hand-held crown bottle openers - Dimensions

Emballage en verre - Décapsuleurs manuels -
Spécifications

Verpackungen aus Glas - Manueller Kronenkorköffner -
Maße

This European Standard was approved by CEN on 29 August 2005.

CEN members are bound to comply with the CEN/CENELEC Internal Regulations which stipulate the conditions for giving this European Standard the status of a national standard without any alteration. Up-to-date lists and bibliographical references concerning such national standards may be obtained on application to the Central Secretariat or to any CEN member.

This European Standard exists in three official versions (English, French, German). A version in any other language made by translation under the responsibility of a CEN member into its own language and notified to the Central Secretariat has the same status as the official versions.

CEN members are the national standards bodies of Austria, Belgium, Cyprus, Czech Republic, Denmark, Estonia, Finland, France, Germany, Greece, Hungary, Iceland, Ireland, Italy, Latvia, Lithuania, Luxembourg, Malta, Netherlands, Norway, Poland, Portugal, Slovakia, Slovenia, Spain, Sweden, Switzerland and United Kingdom.

STANDARD PREVIEW
(standards.iteh.ai)

SIST EN 14798:2006
<https://standards.iteh.ai/catalog/standards/sist/ebd3b114-2519-4dcd-83a6-601ace712274/sist-en-14798-2006>



EUROPEAN COMMITTEE FOR STANDARDIZATION
COMITÉ EUROPÉEN DE NORMALISATION
EUROPÄISCHES KOMITEE FÜR NORMUNG

Management Centre: rue de Stassart, 36 B-1050 Brussels

Contents	Page
Foreword	3
1 Scope	4
2 Normative references	4
3 Dimensions	4
4 Material	6
4.1 Elasticity	6
4.2 Resistance to wear	6
5 Use of crown bottle openers	7
6 Marking	8
Bibliography	9

iTeh STANDARD PREVIEW
(standards.iteh.ai)

[SIST EN 14798:2006](https://standards.iteh.ai/catalog/standards/sist/ebd3b114-2519-4dcd-83a6-601aee712274/sist-en-14798-2006)

<https://standards.iteh.ai/catalog/standards/sist/ebd3b114-2519-4dcd-83a6-601aee712274/sist-en-14798-2006>

Foreword

This European Standard (EN 14798:2005) has been prepared by Technical Committee CEN/TC 261 "Packaging", the secretariat of which is held by AFNOR.

This European Standard shall be given the status of a national standard, either by publication of an identical text or by endorsement, at the latest by April 2006, and conflicting national standards shall be withdrawn at the latest by April 2006.

It is based on CE.T.I.E. (International Technical Centre for Bottling and Packaging) data sheet DT 24 - 04/02.

Efficient packaging is of great importance for the distribution and the protection of goods. Insufficient or inappropriate packaging can lead to damage or wastage of the contents of the pack.

According to the CEN/CENELEC Internal Regulations, the national standards organizations of the following countries are bound to implement this European Standard: Austria, Belgium, Cyprus, Czech Republic, Denmark, Estonia, Finland, France, Germany, Greece, Hungary, Iceland, Ireland, Italy, Latvia, Lithuania, Luxembourg, Malta, Netherlands, Norway, Poland, Portugal, Slovakia, Slovenia, Spain, Sweden, Switzerland and United Kingdom.

iTeh STANDARD PREVIEW (standards.iteh.ai)

SIST EN 14798:2006

<https://standards.iteh.ai/catalog/standards/sist/ebd3b114-2519-4dcd-83a6-601aee712274/sist-en-14798-2006>

EN 14798:2005 (E)**1 Scope**

This European Standard specifies requirements for crown bottle openers designed for 26 mm crown closures, to suit the glass bottle finishes specified in EN 14634 and EN 14635. It applies to hand-held openers of the aperture type.

2 Normative references

The following referenced documents are indispensable for the application of this European Standard. For dated references, only the edition cited applies. For undated references, the latest edition of the referenced document (including any amendments) applies.

EN ISO 6507-1, *Metallic materials — Vickers hardness test — Part 1: Test method (ISO 6507-1:1997)*.

3 Dimensions

3.1 For dimensions see figures 1, 2 and 3.

3.2 The dimensions of the opening space (see figure 1) shall conform to figure 2.

3.3 The shape of the opener shown in figure 1 is an example only, and is not intended to preclude other designs, however, the dimensions in figure 2 are obligatory.

3.4 The shape of the opener shall allow the skirt of the crown to spread freely when being removed.

3.5 The lever edge shall not protrude into the opening space (see figure 2).

Dimensions in mm

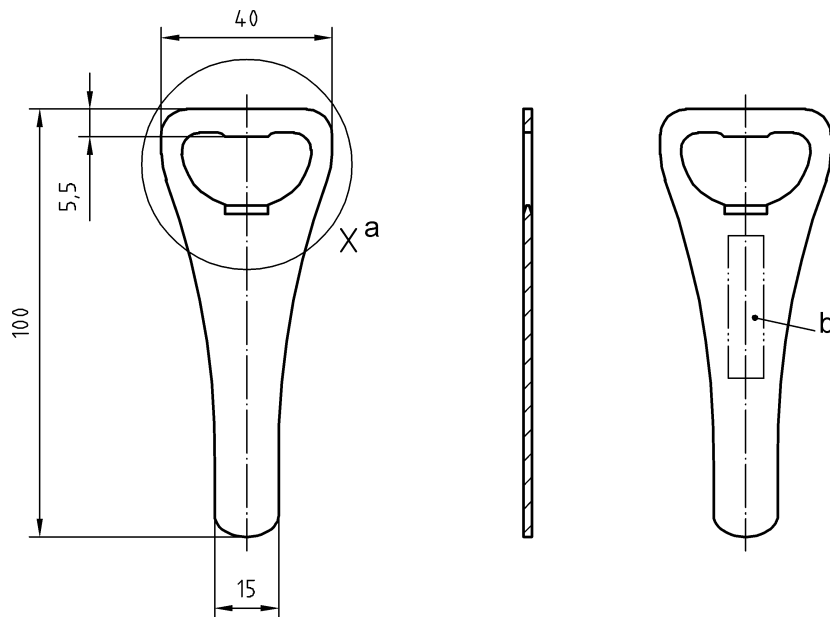
**Key**

- ^a Detail of opening space (see figure 2)
^b suggested position for warning

STANDARD PREVIEW
(standards.iteh.ai)

Figure 1 — Recommended dimensions

SIST EN 14798:2006

<https://standards.iteh.ai/catalog/standards/sist/ebd3b114-2519-4dcd-83a6-601aee712274/sist-en-14798-2006>

Dimensions in mm

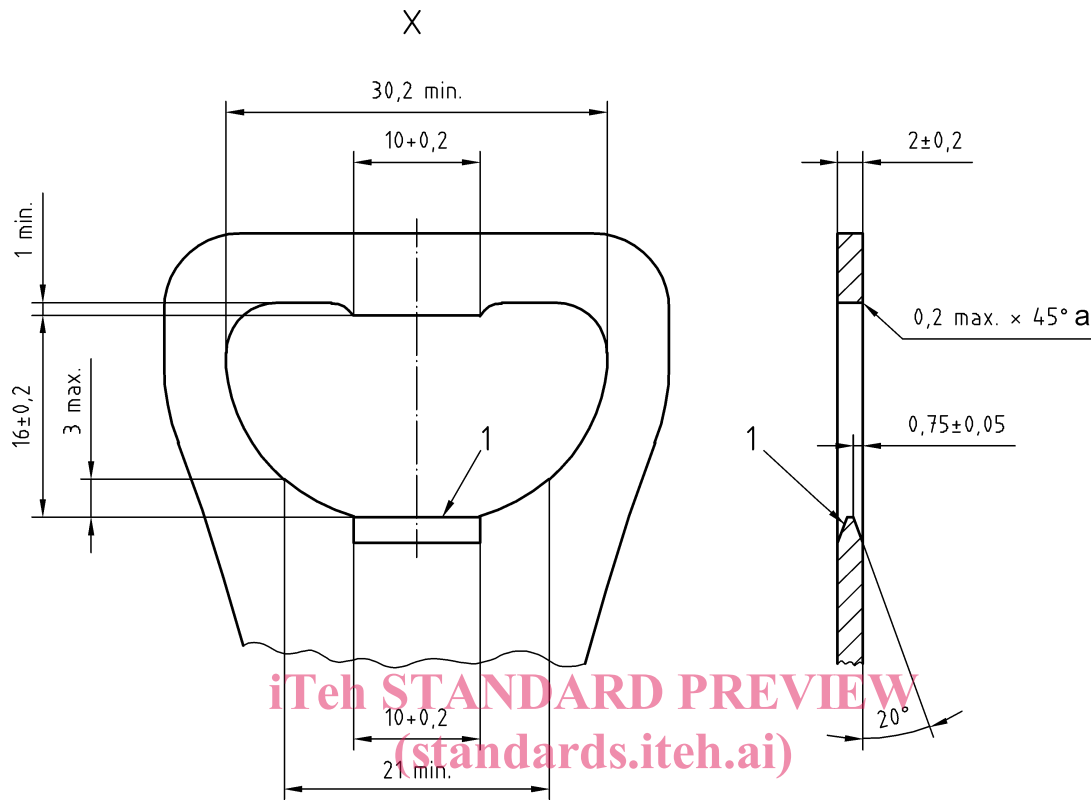

iTeh STANDARD PREVIEW
(standards.iteh.ai)

SIST EN 14798:2006

<https://standards.iteh.ai/catalog/standards/sist/ebd3b114-2519-4dcd-83a6-601aec712274/sist-en-14798-2006>

Key

- 1 lever edge
- a chamfer

Figure 2 — Dimensions of opening space**4 Material****4.1 Elasticity**

The opener shall be manufactured from material having a modulus of elasticity which exceeds 200 kN/mm².

NOTE Steel is a suitable material in this respect.

4.2 Resistance to wear

The areas of the opener which are in direct contact with the closure shall have a minimum hardness value of 490 HV 5, determined in accordance with EN ISO 6507-1.

NOTE 1 This is equivalent to a hardness value of 1,65 kN/mm².

NOTE 2 Other areas of the opener may require the same hardness in order to exhibit sufficient strength.

5 Use of crown bottle openers

(see figure 3)

- 5.1** The lever edge shall contact at least two corrugations of the crown closure (see footnote a).
- 5.2** The point of leverage on the top of the opener shall coincide with the centre of the crown closure when the lever edge is engaged beneath the corrugations of the crown skirt.
- 5.3** When engaged beneath the corrugations of the crown skirt, the lever edge shall not come into contact with the bottle.
- 5.4** Crown bottles openers are not intended for use on twist crowns. A warning marked on the opener shall be supplemented with a symbol as in figure 4.

Dimensions in mm

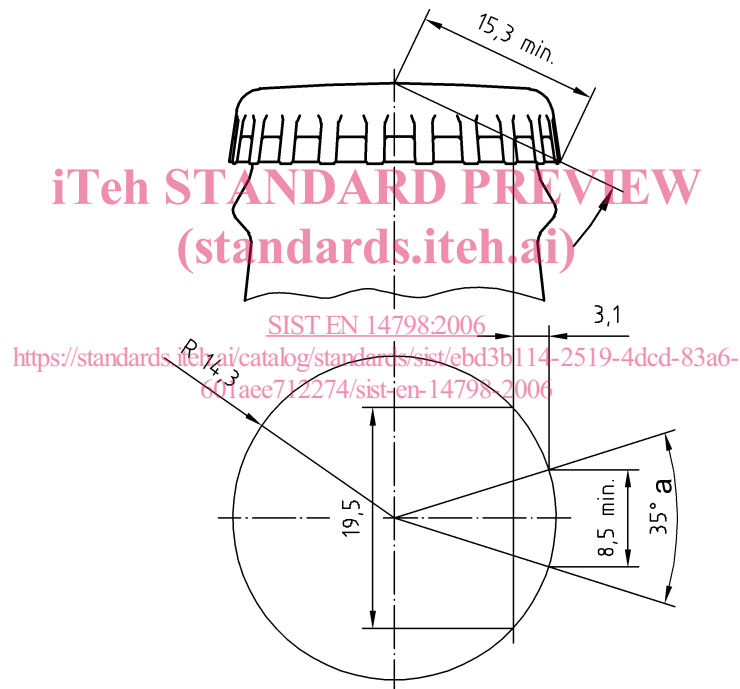

Key

- ^a to bear on two corrugations of the crown skirt

Figure 3 — View of crown closure removal area

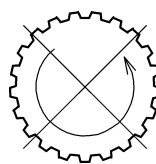

Figure 4 — Recommended symbol