International Standard



7442

INTERNATIONAL ORGANIZATION FOR STANDARDIZATION • МЕЖДУНАРОДНАЯ ОРГАНИЗАЦИЯ ПО СТАНДАРТИЗАЦИИ • ORGANISATION INTERNATIONALE DE NORMALISATION

Tyre valves — ISO core chamber No. 1

Valves pour pneumatiques — Logement du mécanisme ISO n° 1

First edition — 1982-10-01

iTeh STANDARD PREVIEW
(standards.iteh.ai)

[ISO 7442:1982](#)

<https://standards.iteh.ai/catalog/standards/sist/3220897-0dd9-4d47-a286-5972b8d61017/iso-7442-1982>

UDC 629.11.012.551-396.2

Ref. No. ISO 7442-1982 (E)

Descriptors : tyre-valves, dimensions, dimensional tolerances, interchangeability, agricultural machinery, aircraft, road vehicles.

Foreword

ISO (the International Organization for Standardization) is a worldwide federation of national standards institutes (ISO member bodies). The work of developing International Standards is carried out through ISO technical committees. Every member body interested in a subject for which a technical committee has been set up has the right to be represented on that committee. International organizations, governmental and non-governmental, in liaison with ISO, also take part in the work.

Draft International Standards adopted by the technical committees are circulated to the member bodies for approval before their acceptance as International Standards by the ISO Council.

International Standard ISO 7442 was developed by Technical Committee ISO/TC 31, *Tyres, rims and valves*, and was circulated to the member bodies in May 1981.

It has been approved by the member bodies of the following countries :

Austria	Germany, F. R.	Romania
Belgium	Israel	South Africa, Rep. of
Brazil	Italy	Spain
China	Japan	Sweden
Czechoslovakia	Korea, Rep. of	Switzerland
Egypt, Arab Rep. of	Netherlands	United Kingdom
France	Poland	USSR

The member bodies of the following countries expressed disapproval of the document on technical grounds :

India
USA

Tyre valves — ISO core chamber No. 1

iTeh STANDARD PREVIEW (standards.iteh.ai)

1 Scope and field of application

This International Standard specifies the interchangeability dimensions of an ISO core chamber No. 1, and applies principally to core chambers of valves used on tyres for agricultural machines, road vehicles and civil aircraft.

2 References

ISO 1502, *ISO general purpose metric screw threads — Gauging*.

ISO 4570/1, *Tyre valve threads — Part 1 : Threads 5V1, 5V2, 6V1 and 8V1*.

<https://standards.iteh.ai/catalog/standards/sist/3220897-0dd9-4d47-a286-5d72b8126161/iso-7442-1982>

3 Dimensions

The dimensions of the core chamber are given in the table. The tolerance of the core pin head position is given in figure 2.

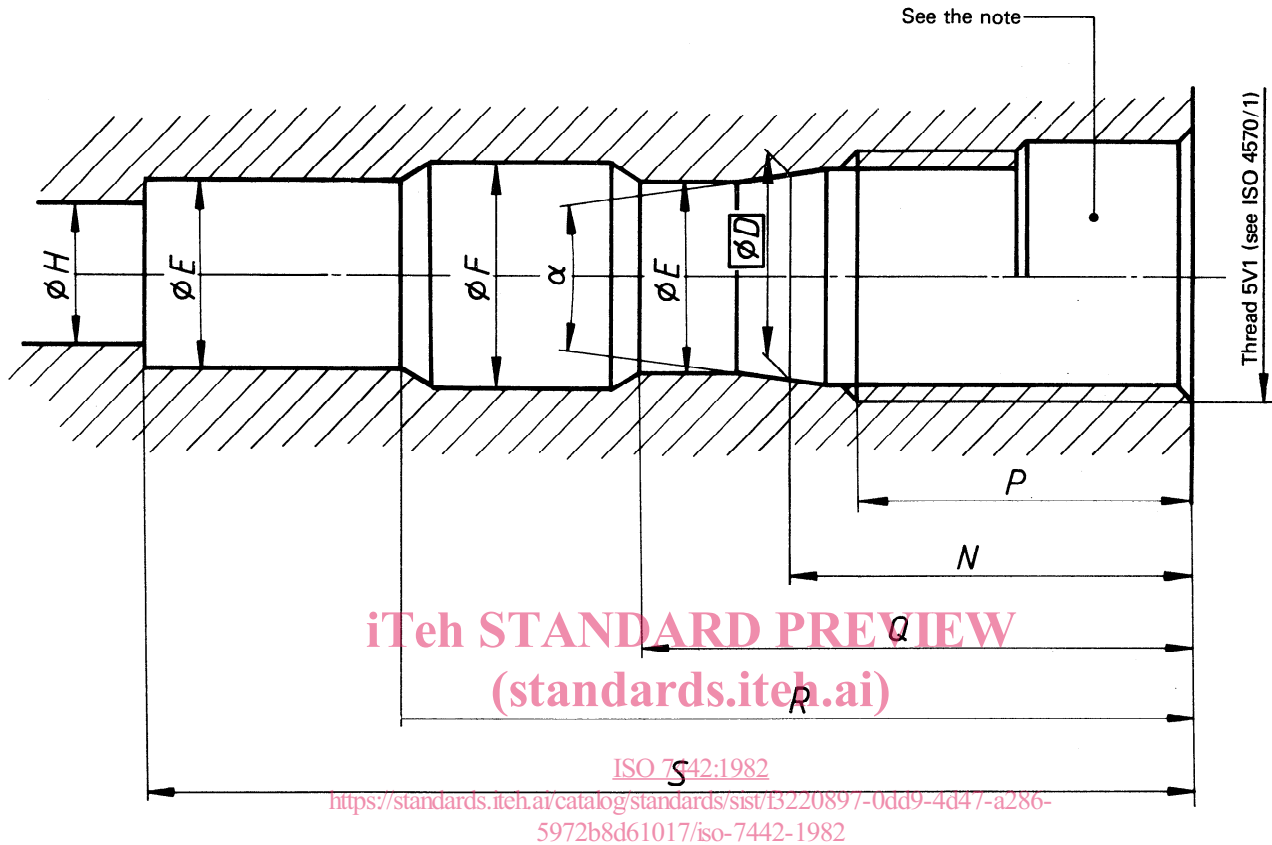

NOTE — The counterbore of the valve mouth is optional. The dimensions of this counterbore are presented in the annex.

Figure 1 — Core chamber

Table — Core chamber dimensions

Dimensions in millimetres

	Min.	Max.
D	4,30	
E	3,82	3,94
F	4,27	4,70
H	—	3,20
N	10,00	10,40
P ¹⁾	7,80	8,60
Q	13,50	14,50
R	22,70	25,00
S	30,50	31,00
α	16°	18°

1) The length of the thread is determined by using a "GO" thread plug gauge. (See clause 11.3 and figure 12 in ISO 1502.) The dimension is to be measured from the end of the gauge and is to include a chamfer length of $0,5 \times$ pitch.

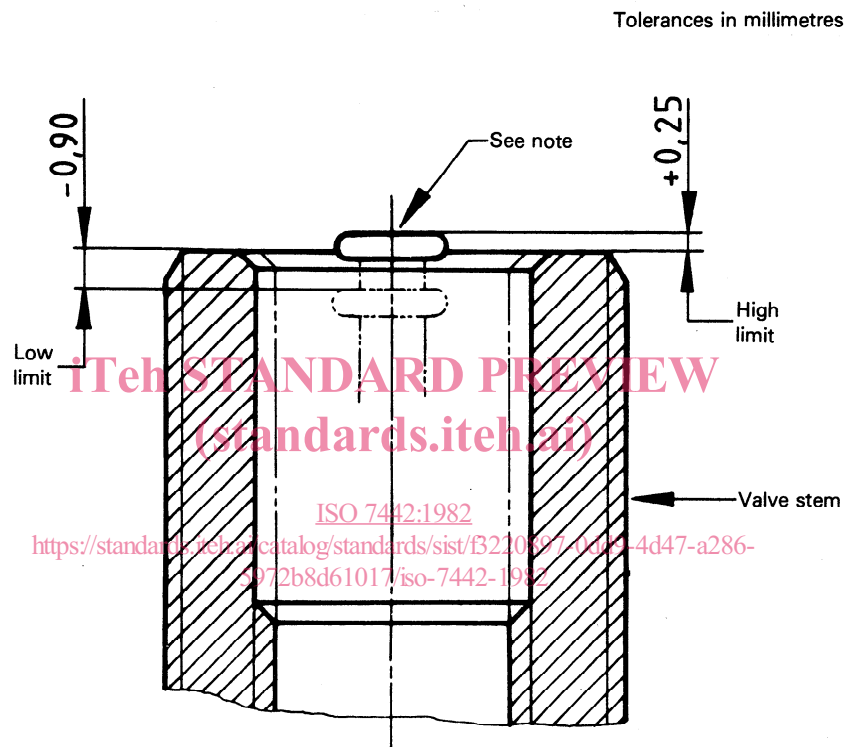

NOTE — The pin head shall not be more than 0,25 mm above or 0,90 mm below the valve mouth after inserting the core at a torque of :

- 0,17 to 0,34 N·m for a core with an elastomeric barrel gasket;
- 0,34 to 0,54 N·m for a core with a metallic sealing gasket.

Figure 2 — Core pin head position — Tolerances

Annex

Counterbore dimensions

Dimensions and tolerances in millimetres

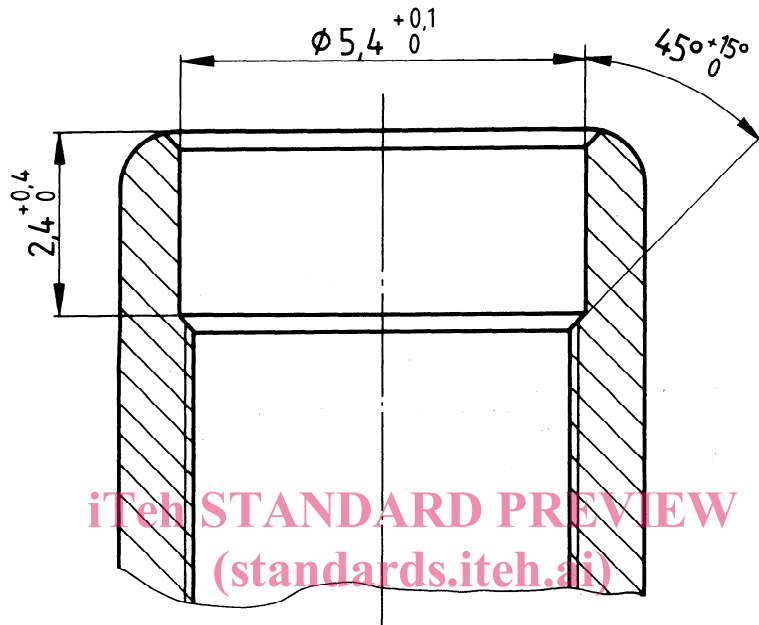

iteh STANDARD PREVIEW
(standards.iteh.ai)

ISO 7442:1982

NOTE <https://standards.iteh.ai/catalog/standards/sist/3220897-0dd9-4d47-a286-5972b8d61017/iso-7442-1982> The counterbore of the valve mouth is optional.

Figure 3 — Counterbore dimensions

iTeh STANDARD PREVIEW
(standards.iteh.ai)

This page intentionally left blank

ISO 7442:1982

<https://standards.iteh.ai/catalog/standards/sist/3220897-0dd9-4d47-a286-5972b8d61017/iso-7442-1982>

iTeh STANDARD PREVIEW
(standards.iteh.ai)

This page intentionally left blank

ISO 7442:1982

<https://standards.iteh.ai/catalog/standards/sist/3220897-0dd9-4d47-a286-5972b8d61017/iso-7442-1982>