International Standard



7575

INTERNATIONAL ORGANIZATION FOR STANDARDIZATION • МЕЖДУНАРОДНАЯ ОРГАНИЗАЦИЯ ПО СТАНДАРТИЗАЦИИ • ORGANISATION INTERNATIONALE DE NORMALISATION

Road vehicles — Wheels for commercial vehicles — Flat attachment — Fixing nuts

Véhicules routiers — Roues pour véhicules utilitaires — Attache plate — Écrous de fixation

First edition — 1984-12-15

iTeh STANDARD PREVIEW
(standards.iteh.ai)

ISO 7575:1984

<https://standards.iteh.ai/catalog/standards/sist/c37eba35-436a-40a8-ad24-4b1473cb6833/iso-7575-1984>

UDC 629.11.012.323 : 629.114.4

Ref. No. ISO 7575-1984 (E)

Descriptors : road vehicles, commercial road vehicles, vehicle wheels, fastenings, nuts (fasteners), hexagonal nuts, dimensions.

Price based on 2 pages

Foreword

ISO (the International Organization for Standardization) is a worldwide federation of national standards bodies (ISO member bodies). The work of preparing International Standards is normally carried out through ISO technical committees. Each member body interested in a subject for which a technical committee has been established has the right to be represented on that committee. International organizations, governmental and non-governmental, in liaison with ISO, also take part in the work.

Draft International Standards adopted by the technical committees are circulated to the member bodies for approval before their acceptance as International Standards by the ISO Council. They are approved in accordance with ISO procedures requiring at least 75 % approval by the member bodies voting.

International Standard ISO 7575 was prepared by Technical Committee ISO/TC 22, *Road vehicles*.

ITeH STANDARD PREVIEW

(standards.iteh.ai)

[ISO 7575:1984](#)

<https://standards.iteh.ai/catalog/standards/sist/c37eba35-436a-40a8-ad24-4b1473cb6833/iso-7575-1984>

Road vehicles — Wheels for commercial vehicles — Flat attachment — Fixing nuts

iTeh STANDARD PREVIEW (standards.iteh.ai)

1 Scope

This International Standard specifies the essential dimensional characteristics of hexagon nuts with a flat seat captive washer for 18, 20 and 22 mm studs. <https://standards.iteh.ai/catalog/standards/sist/c37eba35-436a-40a8-ad24-4b1473cb6833/iso-7575-1984>

2 Field of application

This International Standard applies to nuts designed for fixing flat attachment wheels with centring on central bore the dimensional characteristics of which are covered in ISO 4107.

Only the dimensions necessary to ensure interchangeability are specified. The nut technology, and particularly the design of the nut relative to the washer, is left to the manufacturer.

3 Reference

ISO 4107, *Road vehicles — Wheels for commercial vehicles — Dimensional characteristics of attachment on hub.*

4 Dimensional characteristics

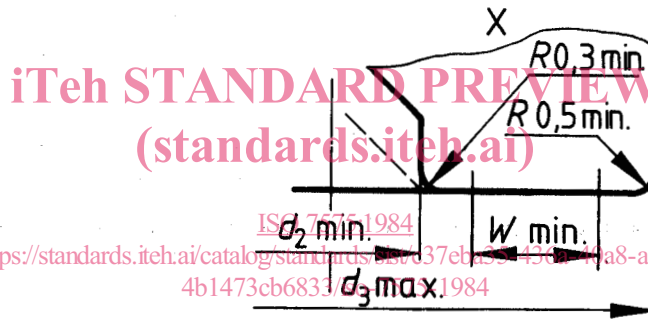
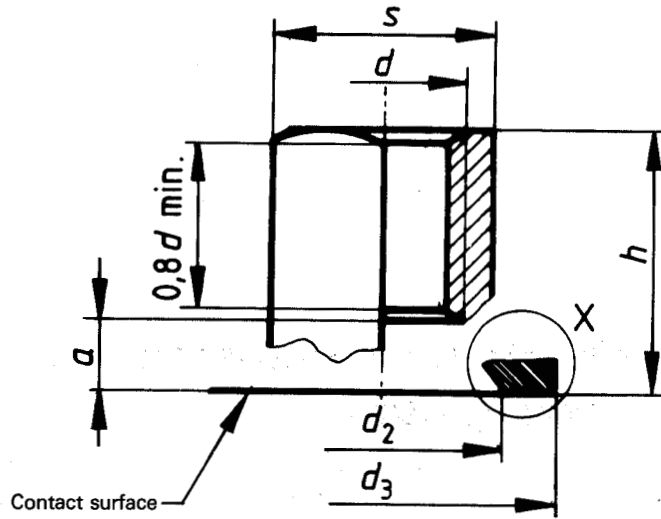

Dimensions in millimetres

Thread ¹⁾	Width across flats	Inner diameter of the washer	Outer diameter of the washer	Radial width of flat contact surface	Overall ²⁾ height of nut and thrust ring	Distance between contact surface of thrust ring and first thread
d	s h13	d_2 min.	d_3 max.	W min.	h max.	a min.
M18 × 1,5	27	23	40	5	27	4,5
M20 × 1,5	30	26	45	5,5	29	4,5
M22 × 1,5	33	28	49	6	34	4,5

1) The effective thread length shall be 0,8 d min. (see the figure).

2) Attention should be drawn to the overall width of the axle which may demand significantly lower values of h .