International Standard



7740

INTERNATIONAL ORGANIZATION FOR STANDARDIZATION • МЕЖДУНАРОДНАЯ ОРГАНИЗАЦИЯ ПО СТАНДАРТИЗАЦИИ • ORGANISATION INTERNATIONALE DE NORMALISATION

Instruments for surgery — Scalpels with detachable blades — Fitting dimensions

Instruments chirurgicaux — Bistouris à lames détachables — Dimensions d'assemblage

First edition — 1985-12-01

ITeH STANDARD PREVIEW
(standards.iteh.ai)

ISO 7740:1985

<https://standards.iteh.ai/catalog/standards/sist/7ec0e06a-ba71-4e39-8b27-e495df815984/iso-7740-1985>

UDC 615.472.3

Ref. No. ISO 7740-1985 (E)

Descriptors : medical equipment, surgical equipment, scalpels, handles, blades, connecting dimensions.

Foreword

ISO (the International Organization for Standardization) is a worldwide federation of national standards bodies (ISO member bodies). The work of preparing International Standards is normally carried out through ISO technical committees. Each member body interested in a subject for which a technical committee has been established has the right to be represented on that committee. International organizations, governmental and non-governmental, in liaison with ISO, also take part in the work.

Draft International Standards adopted by the technical committees are circulated to the member bodies for approval before their acceptance as International Standards by the ISO Council. They are approved in accordance with ISO procedures requiring at least 75 % approval by the member bodies voting.

International Standard ISO 7740 was prepared by Technical Committee ISO/TC 170, *Surgical instruments*.

Users should note that all International Standards undergo revision from time to time and that any reference made herein to any other International Standard implies its latest edition, unless otherwise stated.

iTeh STANDARD PREVIEW
(standards.iteh.ai)
ISO 7740:1985
<https://standards.iteh.ai/catalog/standards/sist/7ec0e06a-ba71-4e39-8b27-e495df815984/iso-7740-1985>

Instruments for surgery — Scalpels with detachable blades — Fitting dimensions

iTeh STANDARD PREVIEW
(standards.iteh.ai)

0 Introduction

This International Standard has been prepared to meet the need for good fitting and interchangeability of detachable blades for scalpels.

Scalpel blades and handles currently in use are manufactured with fitting dimensions that do not always ensure a satisfactory fit between blades and handles manufactured in different countries or by different manufacturers. A transitional period during which the fitting dimensions specified in this International Standard may be gradually adopted should last for five years and ends therefore on 31 December 1990.

1 Scope and field of application

This International Standard lays down the dimensions of two sizes of fitting features for detachable scalpel blades and the handles with which they are used.

2 Fitting dimensions for blades and handles

2.1 Small fitting feature (No. 3)

The fitting dimensions for blades and handles with a small fitting feature shall be in accordance with table 1 and figures 1 and 2.

		Table 1								
		Dimensions in millimetres								
		Fitting dimensions								
		α	c		d		e		f	
		$\pm 0,5^\circ$	min.	max.	min.	max.	min.	max.	min.	max.
Blade		30°	4,50	4,65	17,83	17,90	2,43	2,48	1,18	1,23
Handle		30°	4,40	4,50	17,73	17,81	2,31	2,41	1,12	1,17

2.2 Large fitting feature (No. 4)

The fitting dimensions for blades and handles with a large fitting feature shall be in accordance with table 2 and figures 1 and 2.

		Table 2								
		Dimensions in millimetres								
		Fitting dimensions								
		α	c		d		e		f	
		$\pm 0,5^\circ$	min.	max.	min.	max.	min.	max.	min.	max.
Blade		35°	7,50	7,65	24,20	24,27	3,72	3,77	1,95	2,00
Handle		35°	7,40	7,50	24,10	24,18	3,60	3,70	1,88	1,93

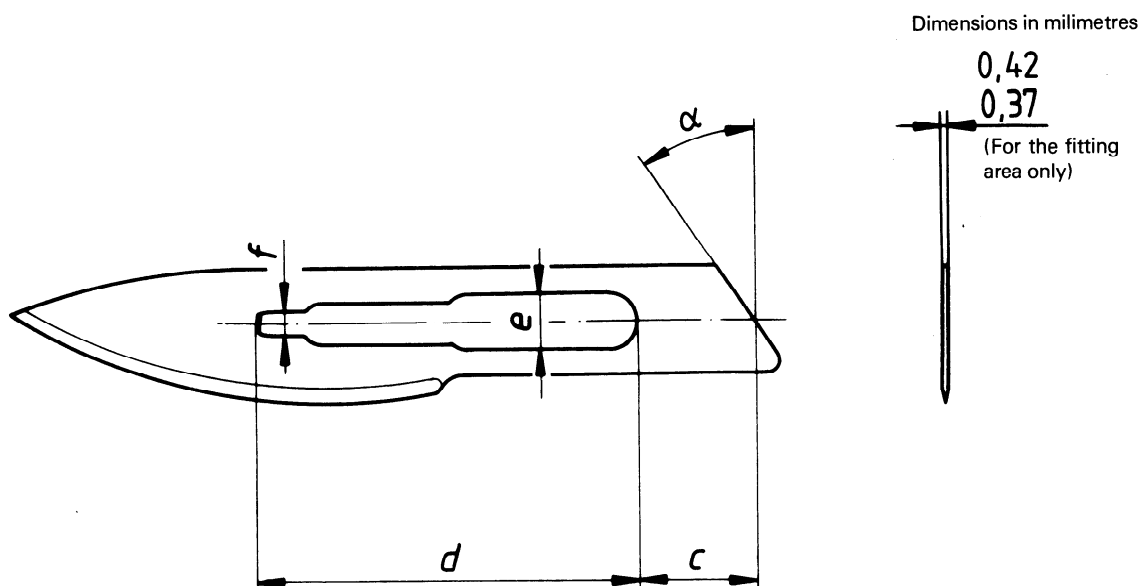

Figure 1 — Detachable blade

NOTE — The design of the blade is intended to be illustrative but does not otherwise form part of the requirements laid down in this International Standard.

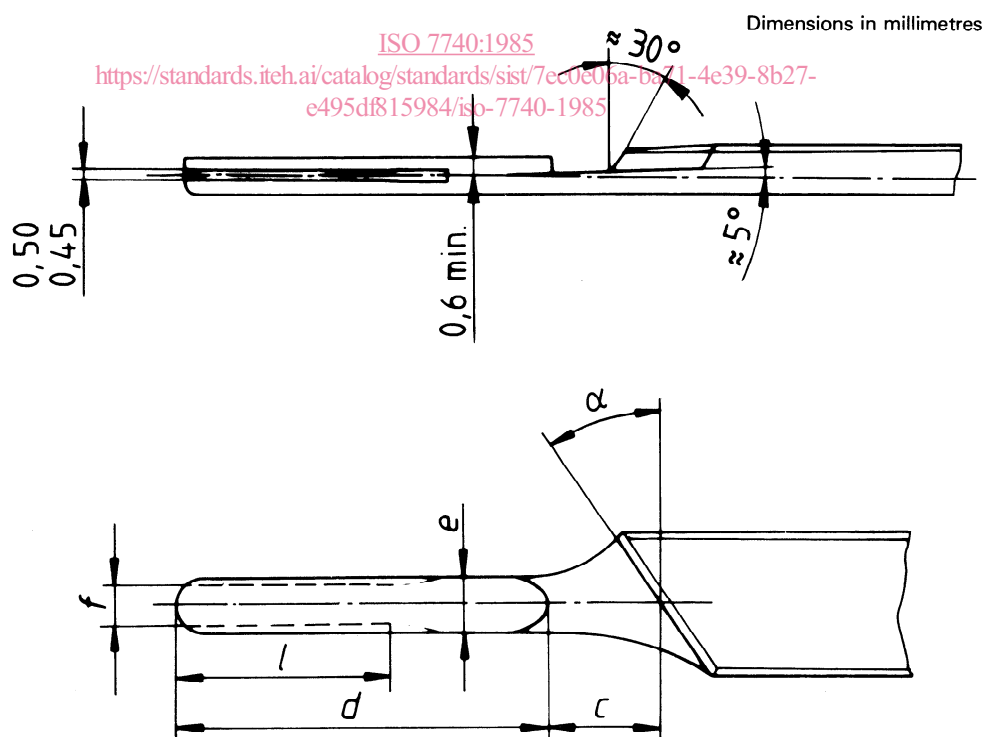

Figure 2 — Scalpel handle

iTeh STANDARD PREVIEW

(standards.iteh.ai)

This page intentionally left blank

ISO 7740:1985

<https://standards.iteh.ai/catalog/standards/sist/7ec0e06a-ba71-4e39-8b27-e495df815984/iso-7740-1985>

iTeh STANDARD PREVIEW
(standards.iteh.ai)

This page intentionally left blank

ISO 7740:1985

<https://standards.iteh.ai/catalog/standards/sist/7ec0e06a-ba71-4e39-8b27-e495df815984/iso-7740-1985>

iTeh STANDARD PREVIEW (standards.iteh.ai)

This page intentionally left blank

ISO 7740:1985

<https://standards.iteh.ai/catalog/standards/sist/7ec0e06a-ba71-4e39-8b27-e495df815984/iso-7740-1985>