International Standard



7804

INTERNATIONAL ORGANIZATION FOR STANDARDIZATION • МЕЖДУНАРОДНАЯ ОРГАНИЗАЦИЯ ПО СТАНДАРТИЗАЦИИ • ORGANISATION INTERNATIONALE DE NORMALISATION

Commercial road vehicles — Side openings for truck power take-offs

Véhicules routiers utilitaires — Fenêtre latérale pour prise de puissance sur camion

First edition — 1985-11-01

ITeH STANDARD PREVIEW
(standards.iteh.ai)

[ISO 7804:1985](https://standards.iteh.ai/catalog/standards/sist/c7c1619d-e515-40dd-ab82-2633e54b33a3/iso-7804-1985)

<https://standards.iteh.ai/catalog/standards/sist/c7c1619d-e515-40dd-ab82-2633e54b33a3/iso-7804-1985>

UDC 629.11.013 : 629.114.4

Ref. No. ISO 7804-1985 (E)

Descriptors : road vehicles, commercial road vehicles, power take-off, openings, classification, designation, dimensions.

Foreword

ISO (the International Organization for Standardization) is a worldwide federation of national standards bodies (ISO member bodies). The work of preparing International Standards is normally carried out through ISO technical committees. Each member body interested in a subject for which a technical committee has been established has the right to be represented on that committee. International organizations, governmental and non-governmental, in liaison with ISO, also take part in the work.

Draft International Standards adopted by the technical committees are circulated to the member bodies for approval before their acceptance as International Standards by the ISO Council. They are approved in accordance with ISO procedures requiring at least 75 % approval by the member bodies voting.

International Standard ISO 7804 was prepared by Technical Committee ISO/TC 22, *Road vehicles*.

Users should note that all International Standards undergo revision from time to time and that any reference made herein to any other International Standard implies its latest edition, unless otherwise stated.

Commercial road vehicles — Side openings for truck power take-offs

iTeh STANDARD PREVIEW (standards.iteh.ai)

1 Scope and field of application

This International Standard lays down the dimensions of side openings for truck power take-offs. These specifications are applicable for all general installations of power take-offs on the transmission gear box of trucks and tractors where the size of the transmission permits.

2 Definition

gear depth : Distance from transmission face to pitch line of power take-off drive gear.

3 Specifications

3.1 Types

This International Standard defines two types of side opening :

- Type R : regular duty type, 6 bolts M10
- Type H : heavy duty type, 8 bolts M12

Both types are specified with two alternative gear depths and subdivided accordingly.

3.2 Type R

Type R shall have one of the following gear depths :

- Type R1 : 20 ± 10 mm
- Type R2 : 70 ± 10 mm

Type R1 shall comply with the requirements of figure 1.

Type R2 shall comply with the additional requirements of figure 2.

3.3 Type H

Type H shall have one of the following gear depths :

- Type H1 : 14 ± 10 mm
- Type H2 : 64 ± 10 mm

Types H1 and H2 shall comply with the requirements of figure 3.

4 Designation

Example for the designation of a 6 bolt M10 side opening (type R) with gear depth 20 ± 10 mm (code 1) :

PTO opening ISO 7804-R1

Dimensions in millimetres

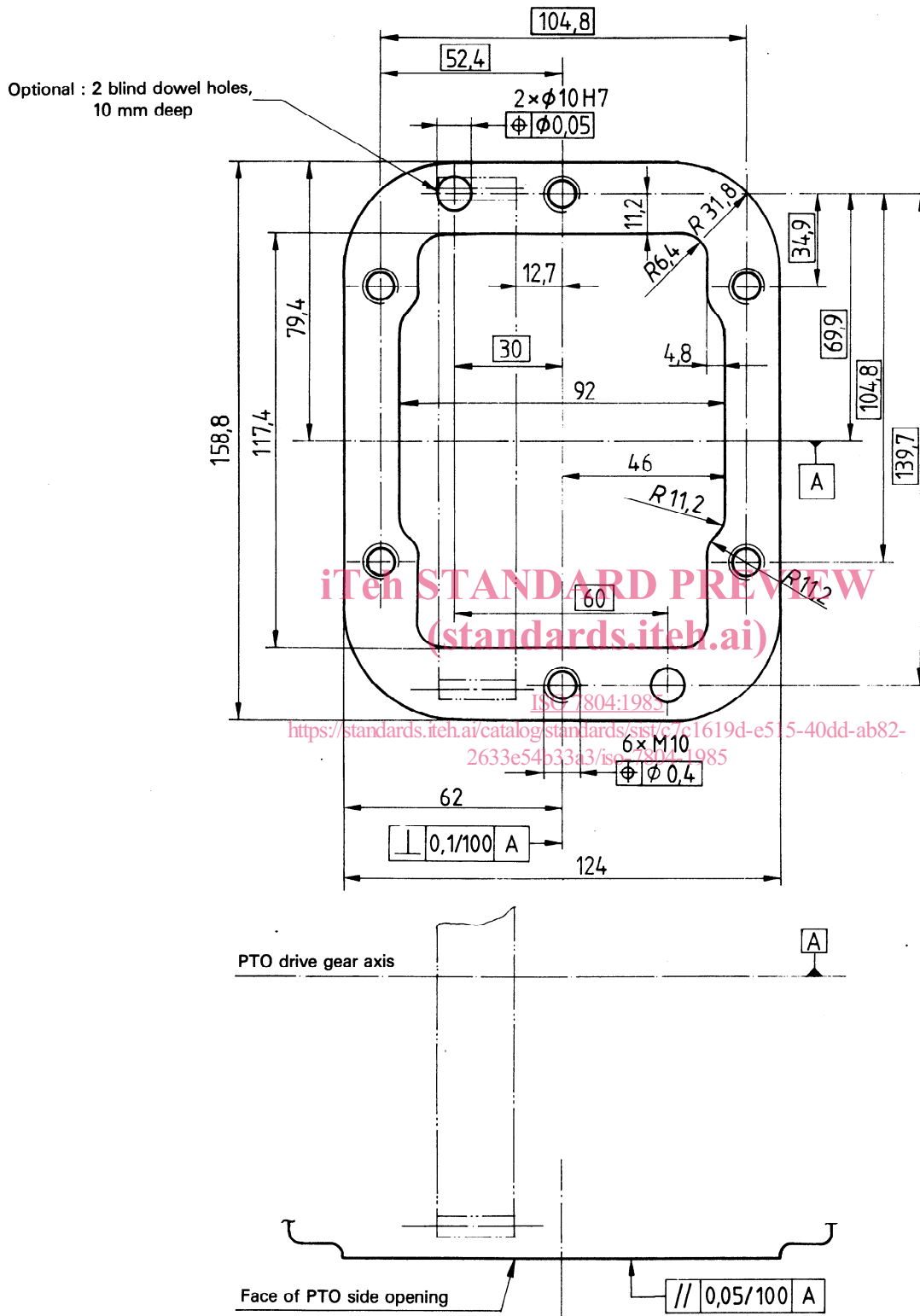

NOTES

- 1 Gear data and backlash are specified by gearbox manufacturer.
- 2 PTO drive gear may be located either side of the vertical centre-line

Figure 1 – Type R regular duty type 6 bolts M10 – Type R1

Dimension in millimetres

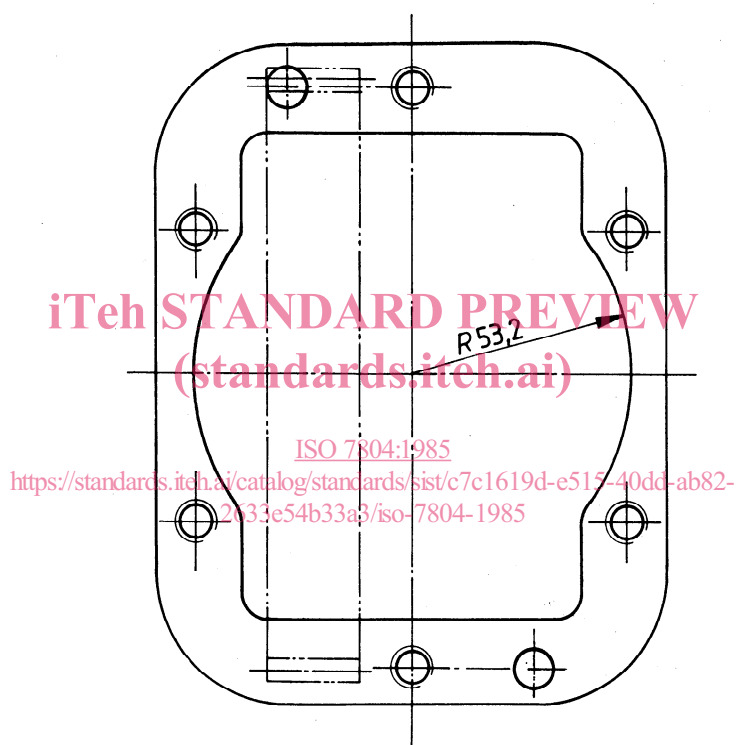

NOTE — For all other dimensions, see figure 1.

Figure 2 — Type R regular duty type 6 bolts M10 — Type R2 (wide centre opening)

Dimensions in millimetres

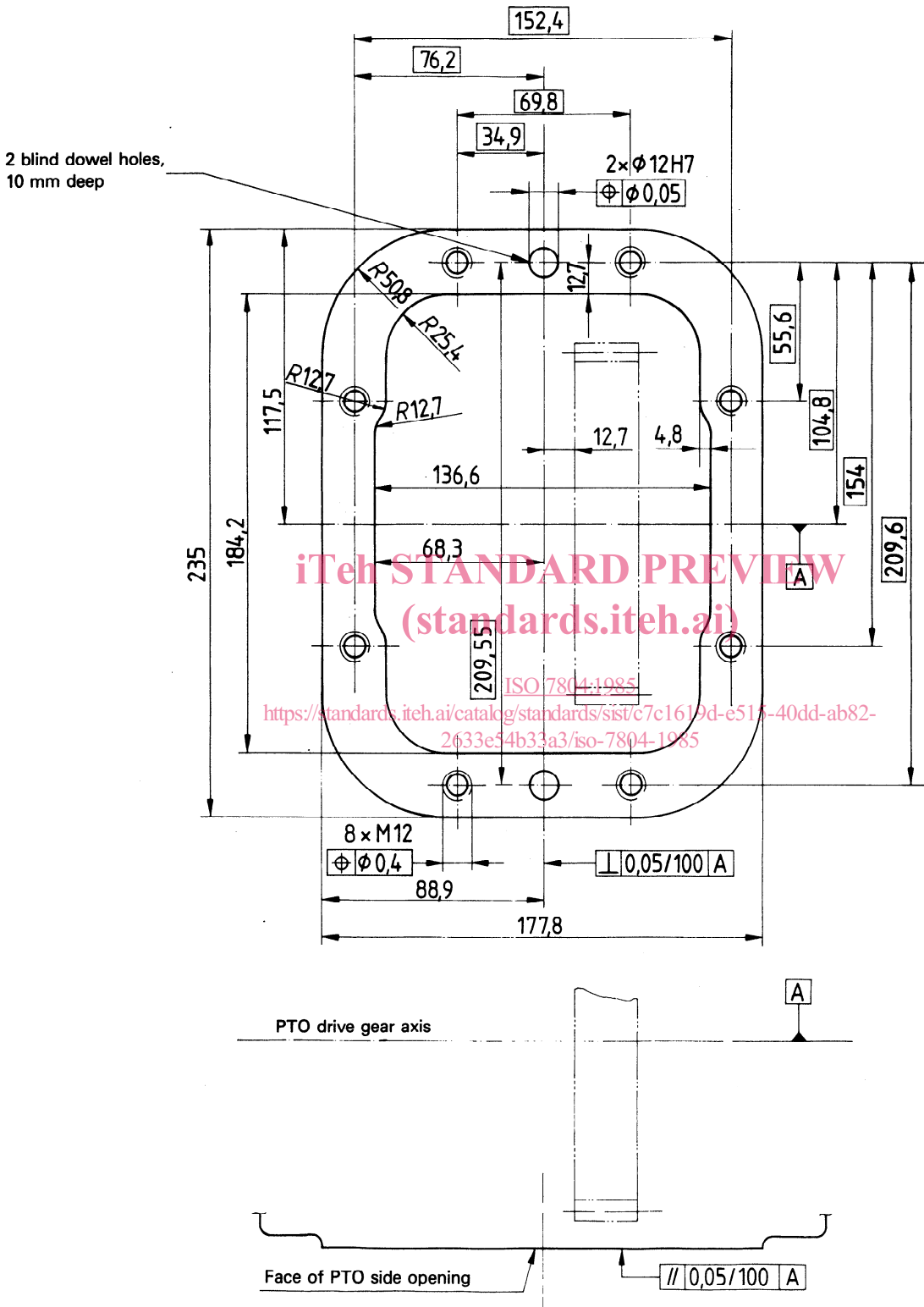

NOTES

- 1 Gear data and backlash are specified by gearbox manufacturer.
- 2 PTO drive gear may be located either side of the vertical centre-line.

Figure 3 — Type H (H1 and H2) heavy duty type 8 bolts M12

iTeh STANDARD PREVIEW
(standards.iteh.ai)

This page intentionally left blank

[ISO 7804:1985](#)

<https://standards.iteh.ai/catalog/standards/sist/c7c1619d-e515-40dd-ab82-2633e54b33a3/iso-7804-1985>

iTeh STANDARD PREVIEW
(standards.iteh.ai)

This page intentionally left blank

[ISO 7804:1985](#)

<https://standards.iteh.ai/catalog/standards/sist/c7c1619d-e515-40dd-ab82-2633e54b33a3/iso-7804-1985>