

International Standard



7914

INTERNATIONAL ORGANIZATION FOR STANDARDIZATION • МЕЖДУНАРОДНАЯ ОРГАНИЗАЦИЯ ПО СТАНДАРТИЗАЦИИ • ORGANISATION INTERNATIONALE DE NORMALISATION

Forestry machinery — Portable chain saws — Minimum handle clearance and sizes

Machines forestières — Scies à chaîne portatives — Espaces libres minimaux et dimensions des poignées

First edition — 1986-09-01

iTeh STANDARD PREVIEW
(standards.iteh.ai)

ISO 7914:1986

<https://standards.iteh.ai/catalog/standards/sist/94788df5-f507-4434-9169-78982675e158/iso-7914-1986>

UDC 630.822 : 621.936.6

Ref. No. ISO 7914-1986 (E)

Descriptors : agricultural machinery, forest equipment, portable equipment, saws, handles, dimensions, clearances.

Price based on 3 pages

Foreword

ISO (the International Organization for Standardization) is a worldwide federation of national standards bodies (ISO member bodies). The work of preparing International Standards is normally carried out through ISO technical committees. Each member body interested in a subject for which a technical committee has been established has the right to be represented on that committee. International organizations, governmental and non-governmental, in liaison with ISO, also take part in the work.

Draft International Standards adopted by the technical committees are circulated to the member bodies for approval before their acceptance as International Standards by the ISO Council. They are approved in accordance with ISO procedures requiring at least 75 % approval by the member bodies voting.

International Standard ISO 7914 was prepared by Technical Committee ISO/TC 23, *Tractors and machinery for agriculture and forestry*.

STANDARD PREVIEW
(standards.iteh.ai)

Users should note that all International Standards undergo revision from time to time and that any reference made herein to any other International Standard implies its latest edition, unless otherwise stated.

<https://standards.iteh.ai/catalog/standards/sist/94788df5-f507-4434-9169-78982675e158/iso-7914-1986>

Forestry machinery – Portable chain saws – Minimum handle clearance and sizes

1 Scope and field of application

This International Standard lays down the dimensions of the front and rear handle clearance and the handle dimensions of portable hand-held chain saws in order to ensure safe and comfortable operation.

2 General requirements

2.1 Front handle

The front handle shall be so constructed and positioned that it presents an unobstructed surface throughout the working area.

2.2 Rear handle

The rear handle shall provide enough space behind the throttle trigger for a gloved hand operating the saw.

3 Clearance dimensions

The minimum clearance dimensions of the handles shall be as shown in the table and the appropriate figures in accordance with the indications in the table.

Table – Clearance dimensions

| Handle | Description | Dimension (see figures) | Figure | Minimum size mm |
|--------------------|--|-------------------------|--------|-----------------|
| Front | Finger clearance in the handle grip area. | A | 1 | 35 |
| | Handle grip area. | — | 2 | — |
| | Clearance between the front of the chain saw body and the handle at the top measured 60 mm to the left of the guide bar plane. ¹⁾ | B | 1 | 40 |
| | Clearance between the front of the chain saw body and the handle measured at the centre-line of the guide bar. | C | 1 | 25 |
| Front and rear | Perimeter of the cross-section of the handle. | — | — | 65 |
| | Distance from rear side of the throttle trigger to the centre of front handle at the top. | D | 1 | — ²⁾ |
| Rear ³⁾ | Finger clearance at the released throttle trigger. | E | 3 | 30 |
| | Clearance below the released throttle trigger. | F | 3 | 35 |
| | Clearance behind the released throttle trigger. | G | 4 | 4 × 25 |

1) If the saw has a permanently fixed spiked bumper, the measurement shall be made from the plane of the root of the bumper teeth.

2) Dimension D shall be 225 mm. If an overall length of less than 225 mm is desirable, dimension D should not be less than 30 % of the overall length of the saw, including guide bar and chain.

3) The dimensions shall be gauged free from play i.e. with a slight initial pressure on the throttle trigger.

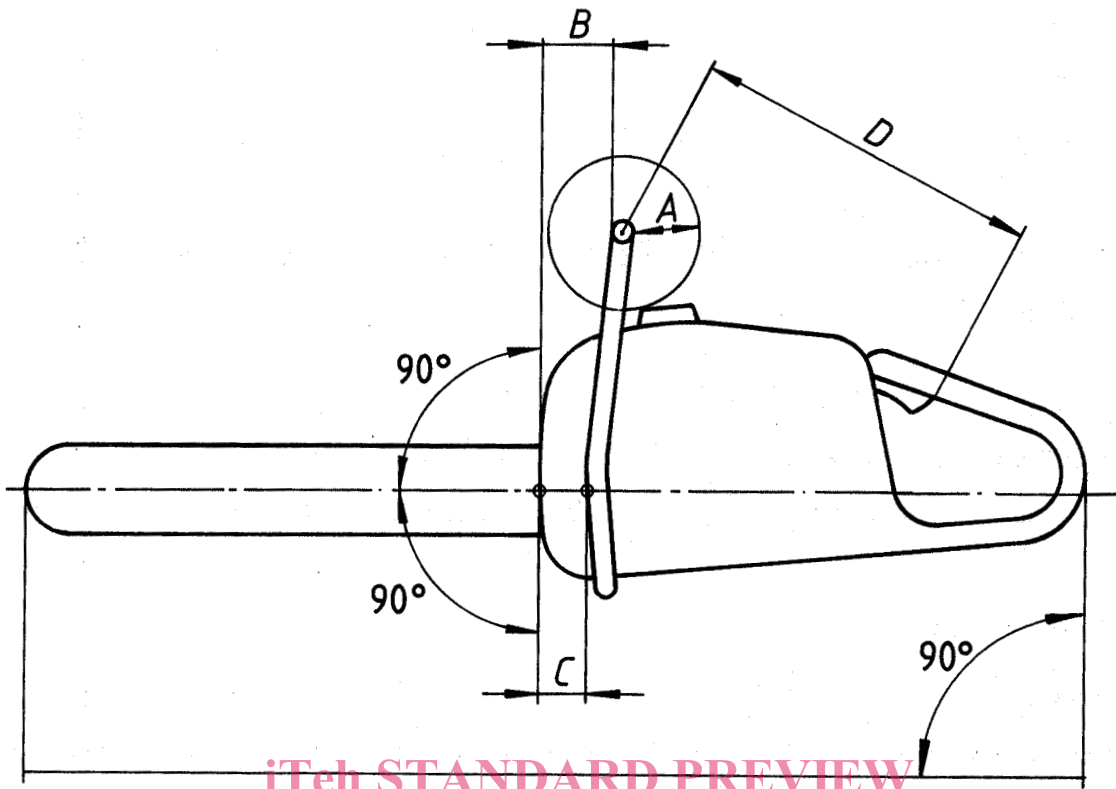

iTeh STANDARD PREVIEW
(standards.iteh.ai)

Figure 1 — Front handle clearances and distance between front and rear handle

ISO 7914:1986

<https://standards.iteh.ai/catalog/standards/sist/94788df5-f507-4434-9169-78982675e158/iso-7914-1986>

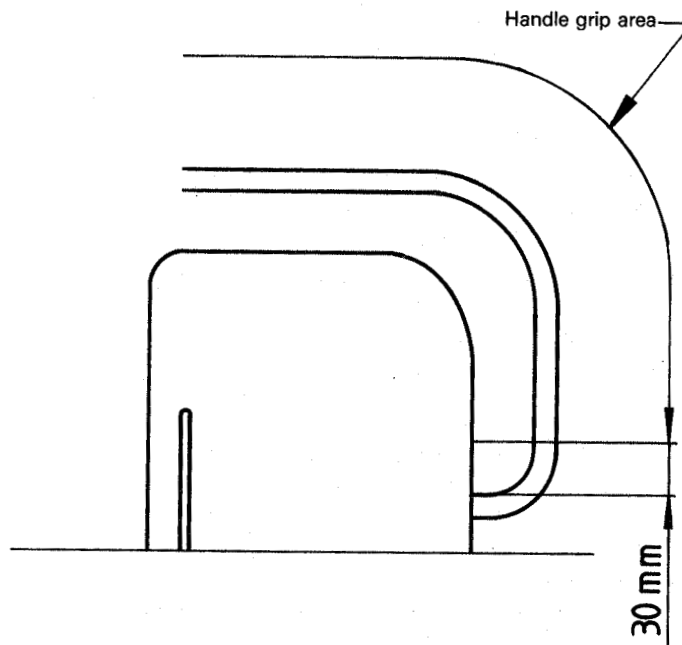

Figure 2 — Handle grip area

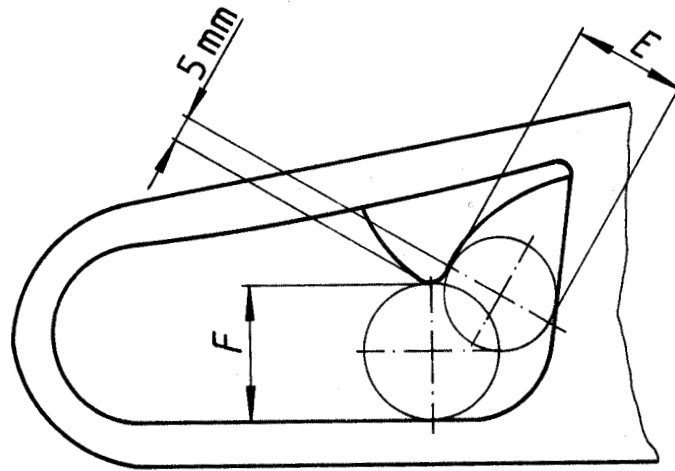
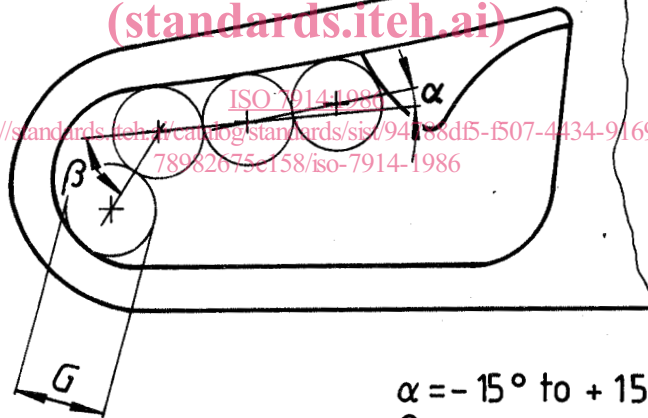

Figure 3 — Clearance at and below throttle trigger

iTeh STANDARD PREVIEW
(standards.iteh.ai)

ISO 7914-1986
<https://standards.iteh.ai/catalog/standards/sis/94188d5-f507-4434-9169-78982675c158/iso-7914-1986>



$$\alpha = -15^\circ \text{ to } +15^\circ$$

$$\beta = -75^\circ \text{ to } +75^\circ$$

Figure 4 — Clearance behind throttle trigger