



SLOVENSKI STANDARD

SIST ISO 8048:1995

01-junij-1995

Tehnične risbe - Gradbeniške risbe - Prikazovanje pogledov in prerezov

Technical drawings -- Construction drawings -- Representation of views, sections and cuts

Dessins techniques -- Dessins de construction -- Représentation des vues, des sections et des coupes

STANDARD PREVIEW
(standards.iteh.ai)

Ta slovenski standard je istoveten z: **ISO 8048:1984**
<https://standards.iteh.ai/catalog/standards/sist/d611b58e-687e-439e-8304-738c7b0aeac0/sist-iso-8048-1995>

ICS:

01.100.30 Gradbeni načrti Construction drawings

SIST ISO 8048:1995 en

iTeh STANDARD PREVIEW
(standards.iteh.ai)

[SIST ISO 8048:1995](#)

<https://standards.iteh.ai/catalog/standards/sist/d61ff58e-687e-439e-8304-738c7b0aeac0/sist-iso-8048-1995>

International Standard



8048

INTERNATIONAL ORGANIZATION FOR STANDARDIZATION • МЕЖДУНАРОДНАЯ ОРГАНИЗАЦИЯ ПО СТАНДАРТИЗАЦИИ • ORGANISATION INTERNATIONALE DE NORMALISATION

**Technical drawings — Construction drawings —
Representation of views, sections and cuts**

Dessins techniques — Dessins de construction — Représentation des vues, des sections et des coupes

First edition — 1984-12-15

ITeh STANDARD PREVIEW
(standards.iteh.ai)

[SIST ISO 8048:1995](https://standards.iteh.ai/catalog/standards/sist/d61ff58e-687e-439e-8304-738c7b0aeac0/sist-iso-8048-1995)

<https://standards.iteh.ai/catalog/standards/sist/d61ff58e-687e-439e-8304-738c7b0aeac0/sist-iso-8048-1995>

UDC 744.43 : 69

Ref. No. ISO 8048-1984 (E)

Descriptors: technical drawings, construction, graphic methods, sections (drawings), views, generalities.

Foreword

ISO (the International Organization for Standardization) is a worldwide federation of national standards bodies (ISO member bodies). The work of preparing International Standards is normally carried out through ISO technical committees. Each member body interested in a subject for which a technical committee has been established has the right to be represented on that committee. International organizations, governmental and non-governmental, in liaison with ISO, also take part in the work.

Draft International Standards adopted by the technical committees are circulated to the member bodies for approval before their acceptance as International Standards by the ISO Council. They are approved in accordance with ISO procedures requiring at least 75 % approval by the member bodies voting.

International Standard ISO 8048 was prepared by Technical Committee ISO/TC 10, *Technical drawings*.

ITeH STANDARD PREVIEW
(standards.iteh.ai)

SIST ISO 8048:1995
<https://standards.iteh.ai/catalog/standards/sist/d61ff58e-687e-439e-8304-738c7b0aeac0/sist-iso-8048-1995>

Technical drawings – Construction drawings – Representation of views, sections and cuts

1 Scope and field of application

This International Standard lays down general rules for marking, designation, placing and orientation of views, sections and cuts, and the position of text in relation to figures on construction drawings.

For all general rules, reference is made to ISO 128. As regards relative positions of views, the method using reference arrows according to ISO 128 is used.

The position and direction of viewing of a section or cut shall be marked with a cutting plane (see ISO 128, type H) and arrows near the reference figure (see figures 2, 3 and 5). The direction of view should be chosen to suit the needs of each individual project and of the information to be conveyed.

The cutting plane shall be drawn to a suitable length for legibility (see figure 2).

If the cutting plane is not straight, the plane shall be drawn to its full length (see figure 3).

2 References

ISO 128, *Technical drawings – General principles of presentation*.

ISO 1046, *Architectural and building drawings – Vocabulary*.

ISO 3098/1, *Technical drawings – Lettering – Part 1: Currently used characters*.

ISO 4069, *Building and civil engineering drawings – Representation of areas on sections and views – General principles*.

ISO/TR 7084, *Technical drawings – Coding and referencing systems for building and civil engineering drawings and associated documents*.

iTeh STANDARD PREVIEW

(standards.iteh.ai)

ISO 8048:1995
<https://standards.iteh.ai/catalog/standards/sist/db1ff58e-687c-439e-8304-7387b0ac0/sist-iso-8048-1995>

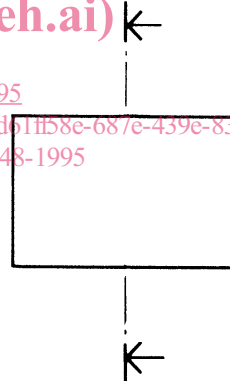

Figure 2

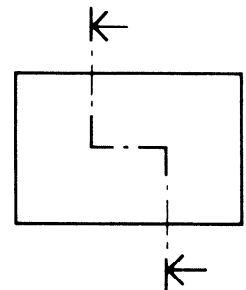

Figure 3

3 Marking of views, sections and cuts

The direction of a view shall be marked with an arrow near the reference figure (see figures 1, 5 and 6).

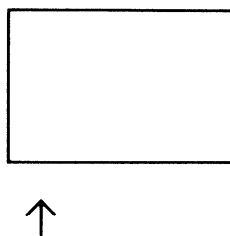

Figure 1

The location of a detail, showing a part of the same view, section or cut as the main figure, shall be marked on it with a thin line circle (ISO 128, type B) (see figure 4).

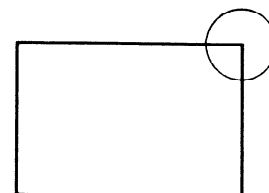

Figure 4

ISO 8048-1984 (E)

4 Designation

For identification, location and reference between various parts of the documentation for a project, denominations or designations of the documented parts shall be used.

Designations of views, sections, cuts and details shall be used in order, as shown in figure 5:

- a) capital letters;
- b) numerals;
- c) lower-case letters.

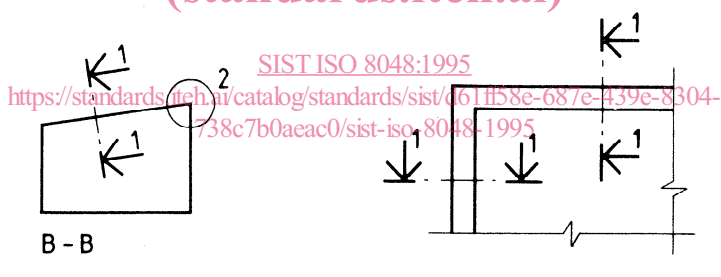
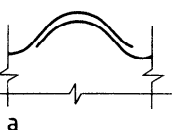
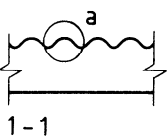
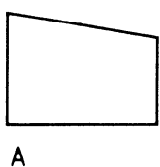
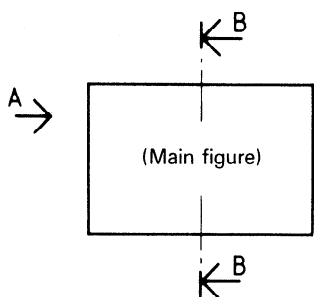

SIST ISO 8048:1995
<https://standards.iteh.ai/catalog/standards/sist/061ff58e-687e-439e-8304-738c7b0aead0/sist-iso-8048-1995>

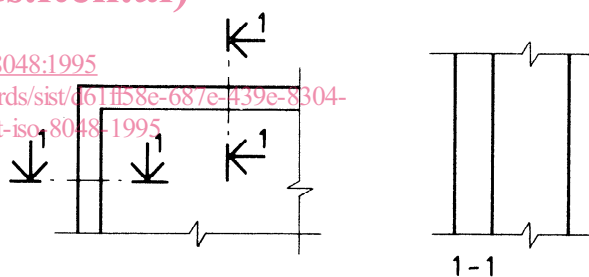

Figure 5

The designation can be supplemented by a drawing number, which is then placed after the designation, for example B-B/24, including section B-B on drawing 24, and 2/45, indicating section 2 on drawing 45.

Designations shall be chosen so that a systematic and well-arranged disposition of figures on the drawing is obtained (see figure 6).

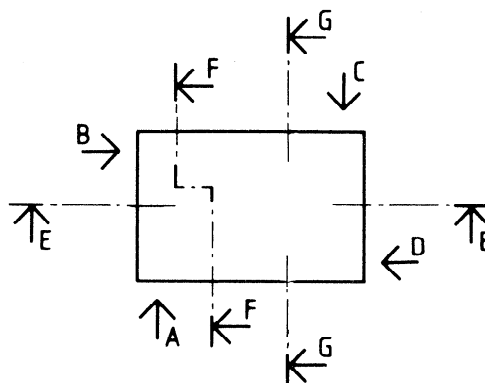

Figure 6

Identical details shall be given the same designation, irrespective of their sight directions in the main figure (see figure 7).

iTeh STANDARD PREVIEW
 (standards.iteh.ai)

Figure 7

5 Position and orientation

Figures shall be placed in their order of designation (see figures 5 and 8). If possible they shall be given the same orientation as the main figures.

Figures of details can also be grouped so that they give a compressed picture of an object or a part of it (see figure 9).

If possible, plans for one and the same project shall be oriented in the same way on all the drawings.

If possible, all other horizontal sections and cuts shall be oriented in the same way as the main plans of the building.

Vertical sections and cuts shall be drawn upright, if possible.

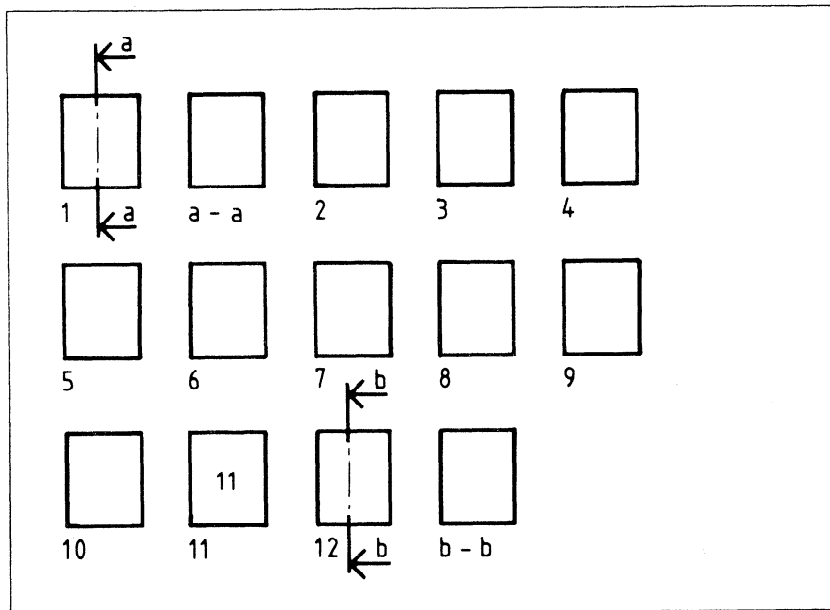

Figure 8

iTeh STANDARD PREVIEW
(standards.iteh.ai)

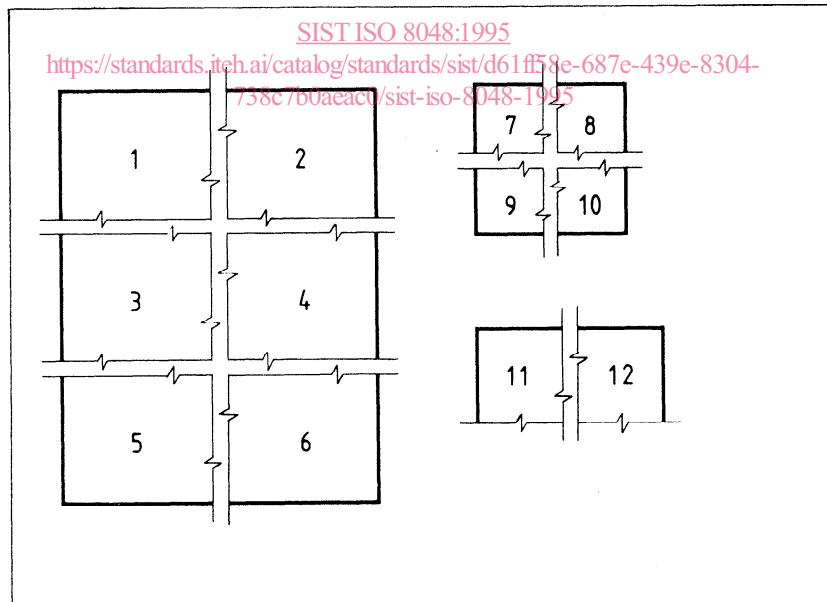

Figure 9

6 Position of text in relation to figures

Text shall be written either below or to the right side of the figure or immediately next to the element to which it refers.

Descriptive text and titles shall be written so that they can be read from below the drawing.

Text in connection with dimension and leader lines shall be written parallel to and slightly (≈ 1 mm) above these lines.

Designation of parts of a building shall normally be written so that they can be read from below the drawing, irrespective of the orientation of the part on the drawing.

ISO 8048-1984 (E)

Titles common to groups of figures shall be placed to the left and above the group of figures (see figure 10).

A title referring to only one figure shall be placed below the figure and with the same edge to the left (see figures 10 and 11).

Designations used for identification and referencing shall be placed separately and clearly identifiable. This can be accomplished, for example, by using bigger or thicker signs, underlining or enclosing in circles.

Text, referring to a figure as a whole shall be placed below the figure title and with the same edge to the left (see figure 10).

COMMON TITLE

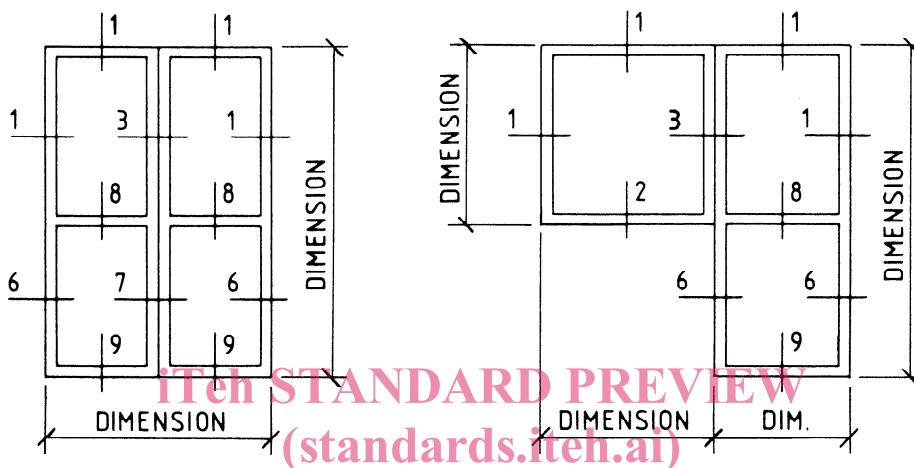

FIGURE TITLE

FIGURE TITLE

TEXT

TEXT

<https://standards.iteh.ai/catalog/standards/sist/d61ff58e-687e-439e-8304-738c7b0aeac0/sist-iso-8048-1995>

Figure 10

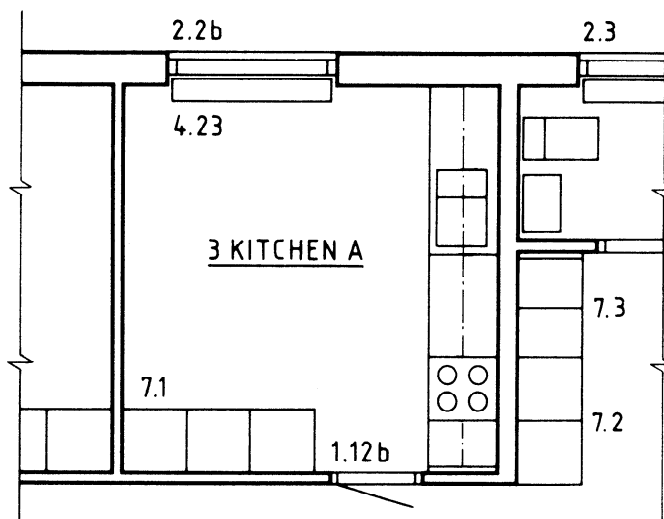

FIGURE TITLE

Figure 11