

---

# International Standard



# 8736

---

INTERNATIONAL ORGANIZATION FOR STANDARDIZATION • МЕЖДУНАРОДНАЯ ОРГАНИЗАЦИЯ ПО СТАНДАРТИЗАЦИИ • ORGANISATION INTERNATIONALE DE NORMALISATION

---

## Taper pins with internal thread, unhardened

*Goupilles de position coniques à trou taraudé, non trempées*

First edition — 1986-11-01

**iTeh STANDARD PREVIEW**  
**(standards.iteh.ai)**

[ISO 8736:1986](#)

<https://standards.iteh.ai/catalog/standards/sist/1958eb8c-7192-409a-932e-24e0319d1fd8/iso-8736-1986>

---

UDC 621.886.115

Ref. No. ISO 8736-1986 (E)

Descriptors : fasteners, pins (mechanics), taper pins, specifications, dimensions, designation.

## Foreword

ISO (the International Organization for Standardization) is a worldwide federation of national standards bodies (ISO member bodies). The work of preparing International Standards is normally carried out through ISO technical committees. Each member body interested in a subject for which a technical committee has been established has the right to be represented on that committee. International organizations, governmental and non-governmental, in liaison with ISO, also take part in the work.

Draft International Standards adopted by the technical committees are circulated to the member bodies for approval before their acceptance as International Standards by the ISO Council. They are approved in accordance with ISO procedures requiring at least 75 % approval by the member bodies voting.

International Standard ISO 8736 was prepared by Technical Committee ISO/TC 2, *Fasteners*.

Users should note that all International Standards undergo revision from time to time and that any reference made herein to any other International Standard implies its latest edition, unless otherwise stated.

iTeh STANDARD PREVIEW  
(standards.iteh.ai)

# Taper pins with internal thread, unhardened

## iTeh STANDARD PREVIEW (standards.iteh.ai)

### 1 Scope and field of application

[ISO 8736:1986](#)

This International Standard specifies the characteristics of unhardened taper pins with internal thread, and metric dimensions and nominal diameters,  $d_1$ , from 6 to 50 mm inclusive. [https://standards.iteh.ai/catalog/standards/iso-8736-1986](#)

### 2 References

ISO 965, *ISO general purpose metric screw threads — Tolerances.*

ISO 2081, *Metallic coatings — Electroplated coatings of zinc on iron or steel.*

ISO 3269, *Fasteners — Acceptance inspection.*

ISO 4520, *Chromate conversion coatings on electroplated zinc and cadmium coatings.*

3 Dimensions

Type A (ground pins) : Surface finish  $R_a = 0,8 \mu\text{m}$

Type B (turned pins) : Surface finish  $R_a = 3,2 \mu\text{m}$

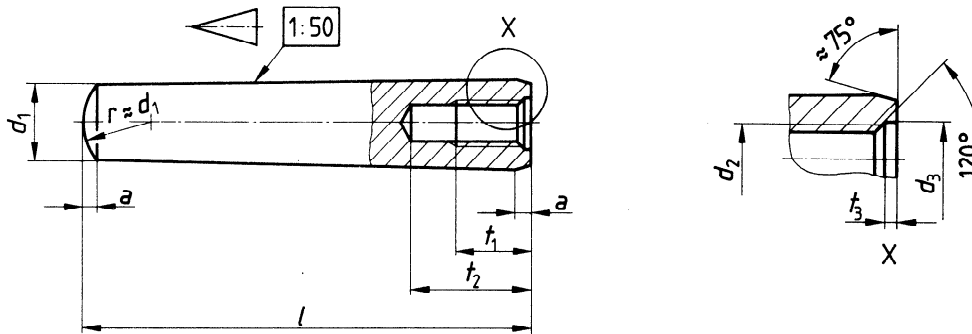

Dimensions in millimetres

| $d_1$    | $h10^{1)}$ | 6  | 8          | 10  | 12   | 16   | 20   | 25  | 30  | 40  | 50  |
|----------|------------|--|------------|-----|------|------|------|-----|-----|-----|-----|
| $a$      | $\approx$  | 0,8  | 1          | 1,2 | 1,6  | 2    | 2,5  | 3   | 4   | 5   | 6,3 |
| $d_2$    |            | M4   | M5         | M6  | M8   | M10  | M12  | M16 | M20 | M20 | M24 |
| $P^{2)}$ |            | 0,7  | 0,8        | 1   | 1,25 | 1,5  | 1,75 | 2   | 2,5 | 2,5 | 3   |
| $d_3$    |            | 4,3  | 5,3        | 6,4 | 8,4  | 10,5 | 13   | 17  | 21  | 21  | 25  |
| $t_1$    |            | 6  | 8          | 10  | 12   | 16   | 18   | 24  | 30  | 30  | 36  |
| $t_2$    | min.       | 10   | 12         | 16  | 20   | 25   | 28   | 35  | 40  | 40  | 50  |
| $t_3$    |            | 1  | 1,2        | 1,2 | 1,2  | 1,5  | 1,5  | 2   | 2   | 2,5 | 2,5 |
| $l^{3)}$ |            | ISO 8736:1986<br><a href="https://standards.iteh.ai/catalog/standards/sist/1958eb8c-7192-409a-932e-24e0319d1fd8/iso-8736-1986">https://standards.iteh.ai/catalog/standards/sist/1958eb8c-7192-409a-932e-24e0319d1fd8/iso-8736-1986</a> |            |     |      |      |      |     |     |     |     |
| nom.     | min.       | max.   |            |     |      |      |      |     |     |     |     |
| 16       | 15,5       | 16,5   |            |     |      |      |      |     |     |     |     |
| 18       | 17,5       | 18,5   |            |     |      |      |      |     |     |     |     |
| 20       | 19,5       | 20,5   |            |     |      |      |      |     |     |     |     |
| 22       | 21,5       | 22,5   |            |     |      |      |      |     |     |     |     |
| 24       | 23,5       | 24,5   |            |     |      |      |      |     |     |     |     |
| 26       | 25,5       | 26,5   |            |     |      |      |      |     |     |     |     |
| 28       | 27,5       | 28,5   | Range      |     |      |      |      |     |     |     |     |
| 30       | 29,5       | 30,5   |            |     |      |      |      |     |     |     |     |
| 32       | 31,5       | 32,5   |            |     |      |      |      |     |     |     |     |
| 35       | 34,5       | 35,5   | of         |     |      |      |      |     |     |     |     |
| 40       | 39,5       | 40,5   |            |     |      |      |      |     |     |     |     |
| 45       | 44,5       | 45,5   |            |     |      |      |      |     |     |     |     |
| 50       | 49,5       | 50,5   | commercial |     |      |      |      |     |     |     |     |
| 55       | 54,25      | 55,75  |            |     |      |      |      |     |     |     |     |
| 60       | 59,25      | 60,75  |            |     |      |      |      |     |     |     |     |
| 65       | 64,25      | 65,75  | lengths    |     |      |      |      |     |     |     |     |
| 70       | 69,25      | 70,75  |            |     |      |      |      |     |     |     |     |
| 75       | 74,25      | 75,75  |            |     |      |      |      |     |     |     |     |
| 80       | 79,25      | 80,75  |            |     |      |      |      |     |     |     |     |
| 85       | 84,25      | 85,75  |            |     |      |      |      |     |     |     |     |
| 90       | 89,25      | 90,75  |            |     |      |      |      |     |     |     |     |
| 95       | 94,25      | 95,75  |            |     |      |      |      |     |     |     |     |
| 100      | 99,25      | 100,75   |            |     |      |      |      |     |     |     |     |
| 120      | 119,25     | 120,75   |            |     |      |      |      |     |     |     |     |
| 140      | 139,25     | 140,75   |            |     |      |      |      |     |     |     |     |
| 160      | 159,25     | 160,75   |            |     |      |      |      |     |     |     |     |
| 180      | 179,25     | 180,75   |            |     |      |      |      |     |     |     |     |
| 200      | 199,25     | 200,75   |            |     |      |      |      |     |     |     |     |

1) Other tolerances, for example a11, c11, f8, as agreed between customer and supplier.

2)  $P$  = thread pitch.

3) For nominal lengths above 200 mm, steps of 20 mm.

#### 4 Specifications and reference International Standards

|                       |   |
|-----------------------|---|
| <b>Screw thread</b>   | Metric screw thread with tolerance 6H to ISO 965.   |
| <b>Material</b>       | St = Free-cutting steel,<br>hardness 125 to 245 HV.<br>Other materials as agreed between customer and supplier.   |
| <b>Surface finish</b> | Plain, i.e. pins to be supplied in natural finish, treated with rust-preventative lubricant, unless otherwise specified by agreement between customer and supplier.<br><br>Preferred coatings are black oxide, phosphate coating or zinc plating with chromate conversion coating (see ISO 2081 and ISO 4520).<br>Other coatings as agreed between customer and supplier.<br>All tolerances shall apply prior to the application of a plating or coating. |
| <b>Workmanship</b>    | Parts shall be uniform in quality and free of irregularities or detrimental defects.<br>No burrs shall appear on any part of the pin.   |
| <b>Taper</b>          | The taper shall be inspected by use of an adequate optical comparator.  |
| <b>Acceptability</b>  | The acceptance procedure is covered in ISO 3269.  |

#### 5 Designation

Example for the designation of an unhardened steel taper pin, type A, with internal thread, nominal diameter  $d_1 = 6$  mm and nominal length  $l = 30$  mm :

Taper pin ISO 8736 - A - 6 × 30 - St

**ITeH STANDARD PREVIEW**  
(standards.iteh.ai)

[ISO 8736:1986](https://standards.iteh.ai/catalog/standards/sist/1958eb8c-7192-409a-932e-24e0319d1fd8/iso-8736-1986)

<https://standards.iteh.ai/catalog/standards/sist/1958eb8c-7192-409a-932e-24e0319d1fd8/iso-8736-1986>

**iTeh STANDARD PREVIEW**  
**(standards.iteh.ai)**

This page intentionally left blank

ISO 8736:1986

<https://standards.iteh.ai/catalog/standards/sist/1958eb8c-7192-409a-932e-24e0319d1fd8/iso-8736-1986>

**iTeh STANDARD PREVIEW**  
**(standards.iteh.ai)**

This page intentionally left blank

ISO 8736:1986

<https://standards.iteh.ai/catalog/standards/sist/1958eb8c-7192-409a-932e-24e0319d1fd8/iso-8736-1986>

**iTeh STANDARD PREVIEW**  
**(standards.iteh.ai)**

This page intentionally left blank

[ISO 8736:1986](#)

<https://standards.iteh.ai/catalog/standards/sist/1958eb8c-7192-409a-932e-24e0319d1fd8/iso-8736-1986>