

INTERNATIONAL STANDARD

**ISO
9312**

First edition
1990-07-15

Resistance welding equipment — Insulated pins for use in electrode back-ups

iTeh STANDARD PREVIEW
*Équipement de soudage par résistance — Fiches isolées utilisées dans les contre-
électrodes*
(standards.iteh.ai)

ISO 9312:1990

<https://standards.iteh.ai/catalog/standards/sist/d445274e-b589-4618-9938-2d50b99a0c33/iso-9312-1990>



Reference number
ISO 9312 : 1990 (E)

Foreword

ISO (the International Organization for Standardization) is a worldwide federation of national standards bodies (ISO member bodies). The work of preparing International Standards is normally carried out through ISO technical committees. Each member body interested in a subject for which a technical committee has been established has the right to be represented on that committee. International organizations, governmental and non-governmental, in liaison with ISO, also take part in the work. ISO collaborates closely with the International Electrotechnical Commission (IEC) on all matters of electrotechnical standardization.

Draft International Standards adopted by the technical committees are circulated to the member bodies for voting. Publication as an International Standard requires approval by at least 75 % of the member bodies casting a vote.

International Standard ISO 9312 was prepared by Technical Committee ISO/TC 44, *Welding and allied processes*.

[ISO 9312:1990](https://standards.iteh.ai/catalog/standards/sist/d445274e-b589-4618-9938-2d50b99a0c33/iso-9312-1990)

<https://standards.iteh.ai/catalog/standards/sist/d445274e-b589-4618-9938-2d50b99a0c33/iso-9312-1990>

Resistance welding equipment — Insulated pins for use in electrode back-ups

iTeh STANDARD PREVIEW (standards.iteh.ai)

1 Scope

This International Standard specifies the requirements for insulated pins used to pin parts in the secondary circuit of resistance welding equipment, or other live equipment, which need to be insulated from each other.

2 Normative references

The following standards contain provisions which, through reference in this text, constitute provisions of this International Standard. At the time of publication, the editions indicated were valid. All standards are subject to revision, and parties to agreements based on this International Standard are encouraged

to investigate the possibility of applying the most recent editions of the standards indicated below. Members of IEC and ISO maintain registers of currently valid International Standards.

ISO 1302:1978, *Technical drawings — Method of indicating surface texture on drawings.*

ISO 1642:1987, *Plastics — Industrial laminated sheets based on thermosetting resins — Specification.*

ISO 2768-1:1989, *General tolerances — Part 1: Tolerances for linear and angular dimensions without individual tolerance indications.*

ISO 5827:1983, *Spot welding — Electrode back-ups and clamps.*

3 Dimensions

The dimensions of the insulated pins shall be as shown in figure 1 and given in table 1.

Details left unspecified shall be designed as appropriate.

Dimensions in millimetres,
surface roughness
values in micrometres

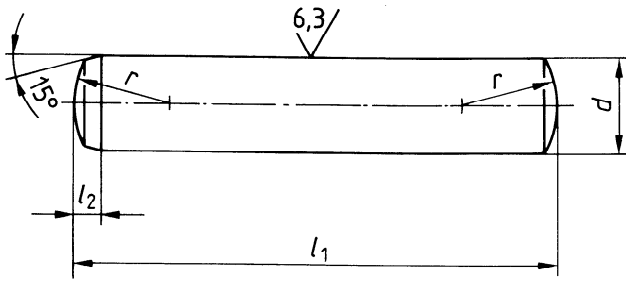

NOTE — See ISO 1302 for indication of surface texture.

Figure 1

Table 1

d	l_1	l_2	r
6	30	2	6
8	40	2,5	8
10	50	3	10
12	60	3,5	12

4 Designation

The designation of insulated pins which comply with this International Standard shall comprise the following information in the order given:

- a description block (i.e. "insulated pin");
- a reference to this International Standard;
- the pin diameter d , in millimetres.

EXAMPLE

An insulated pin with a diameter $d = 8$ mm is designated

Insulated pin ISO 9312-8

5 Material

The material shall be hard fabric, coarse weave PFCC 1, in accordance with ISO 1642.

6 Finish

Permissible deviations for dimensions without tolerance indications shall be: medium ISO 2768-m.

7 Application

A typical application of insulated pins complying with this International Standard is given in ISO 5827.

UDC 621.791.76.03

Descriptors : welding, resistance welding, welding equipment, insulated bushings, pins (mechanics), specifications, dimensions, designation.

Price based on 2 pages