

**SLOVENSKI**  
**PREDSTANDARD**

**SIST EN**  
**13525:2005/oprA1:2005**

maj 2005

---

---

**Gozdarski stroji - Sekalniki - Varnost**

Forestry machinery - Wood chippers - Safety

---

---

ICS 65.060.80

Referenčna številka  
SIST EN 13525:2005/oprA1:2005(en)



ICS

English version

## Forestry machinery - Wood chippers - Safety

Machines forestières - Déchiqueteuses - Sécurité

Forstmaschinen - Buschholzhacker - Sicherheit

This draft amendment is submitted to CEN members for enquiry. It has been drawn up by the Technical Committee CEN/TC 144.

This draft amendment A1, if approved, will modify the European Standard EN 13525:2005. If this draft becomes an amendment, CEN members are bound to comply with the CEN/CENELEC Internal Regulations which stipulate the conditions for inclusion of this amendment into the relevant national standard without any alteration.

This draft amendment was established by CEN in three official versions (English, French, German). A version in any other language made by translation under the responsibility of a CEN member into its own language and notified to the Management Centre has the same status as the official versions.

CEN members are the national standards bodies of Austria, Belgium, Cyprus, Czech Republic, Denmark, Estonia, Finland, France, Germany, Greece, Hungary, Iceland, Ireland, Italy, Latvia, Lithuania, Luxembourg, Malta, Netherlands, Norway, Poland, Portugal, Slovakia, Slovenia, Spain, Sweden, Switzerland and United Kingdom.

**Warning** : This document is not a European Standard. It is distributed for review and comments. It is subject to change without notice and shall not be referred to as a European Standard.



EUROPEAN COMMITTEE FOR STANDARDIZATION  
COMITÉ EUROPÉEN DE NORMALISATION  
EUROPÄISCHES KOMITEE FÜR NORMUNG

**Management Centre: rue de Stassart, 36 B-1050 Brussels**

## **Foreword**

This document (EN 13525:2004/prA1:2005) has been prepared by Technical Committee CEN/TC 144 “Tractors and machinery for agriculture and forestry”, the secretariat of which is held by AFNOR.

This document is currently submitted to the CEN Enquiry.

This document has been prepared under a mandate given to CEN by the European Commission and the European Free Trade Association, and supports essential requirements of EU Directive(s).

## Scope

*2<sup>nd</sup> Paragraph - Add after the 1<sup>st</sup> sentence the following:*

“It also applies to chippers fitted with an integrated feed belt or chain conveyor.”

## 2 Normative references

*Add the following reference:*

“EN 620:2002, *Continuous handling equipment and systems - Safety and EMC requirements for fixed belt conveyors for bulk materials*”

## 3 Definitions

*Amend definition 3.6 to read:*

“belt chain or similar conveyor, either in front ...”

### 4.3.3 Hazards related to infeed components and chipping components

*Replace clause 4.3.3.2 by the following:*

#### “4.3.3.2 Machines with integrated feed conveyor

See Annex C.”

*Renumber the previous clause 4.3.3.2. as follows :*

#### "4.3.3.3 Guarding of chipping components"

## 6.1 Instruction handbook

*2<sup>nd</sup> Paragraph - Add the following two additional indents:*

x) prohibition to modify the original contour of the tooth of the chain conveyor during maintenance and servicing;

y) for wood chippers with integrated feed chain or belt conveyor stop the engine or the power transmission to the machine before clearing blockages.”

*Add the new following Annex C:*

**“Annex C  
(normative)**

**Machines with integrated feed conveyor**

**C.1 When a belt conveyor is used**

The conveyor shall be guarded in accordance with 5.1 of EN 620:2002.

**C.2 When a chain conveyor is used**

When a type A machine is fitted with an infeed mechanism made of a chain conveyor and a top roller the following requirements shall be met.

To reduce the potential for unintentional contact with the running chain conveyor the distance from the outermost lower edge of the infeed chute to the first tooth of the chain conveyor shall be at least 400 mm (see Figure C.1).

Dimensions in millimetres

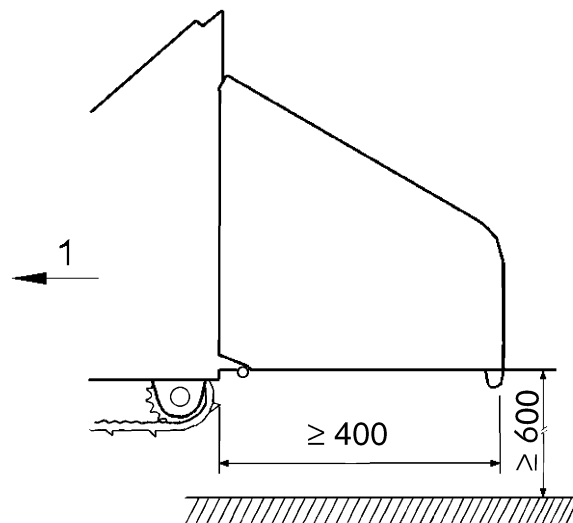

**Key**

1 Direction of infeed

**Figure C.1 Distance from the outermost lower edge of the infeed chute to the first tooth of the chain conveyor**

To reduce the risk of operator being drawn-in by the entanglement of his clothing each tooth profile (a-b and b-c) of the chain conveyor shall be smooth and continuous. In addition the tooth profile shall meet the following requirements (see Figures C.2 and C.3):

- the angle between the front side of the tooth and the horizontal in the infeed direction shall be  $\geq 90^\circ$ ;
- the angle between each side of the tooth and the horizontal shall be  $\leq 90^\circ$ ;
- the maximum height of each tooth shall be  $\leq 30$  mm.

Dimensions in millimetres

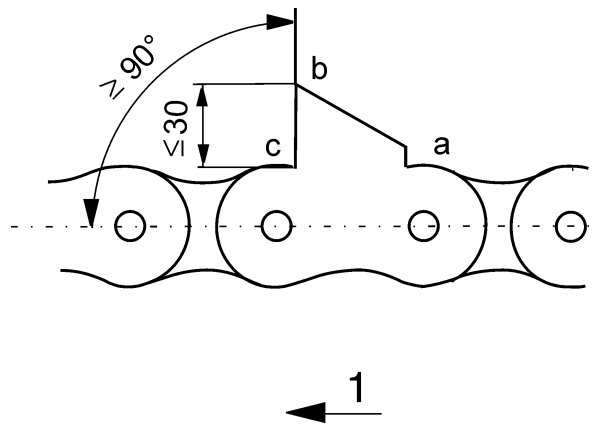

**Key**

1 Direction of infeed

**Figure C.2 — Side view of an acceptable chain tooth profile**

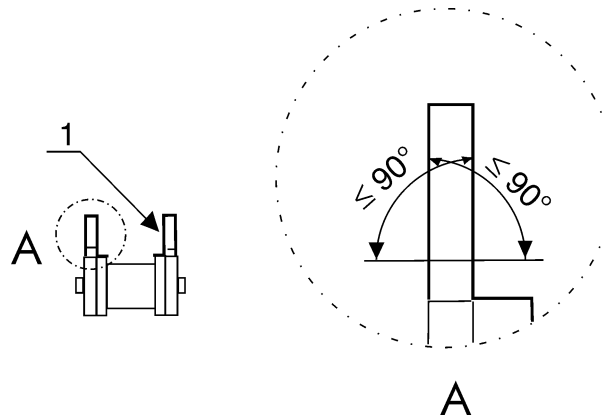

**Key**

1 Tooth  
A Detail

**Figure C.3 — Front view of an acceptable chain tooth profile**

The maximum speed of the chain conveyor shall be 0,3 m/s.

Some examples of unacceptable tooth profiles are given in Figures C.4 and C.5.

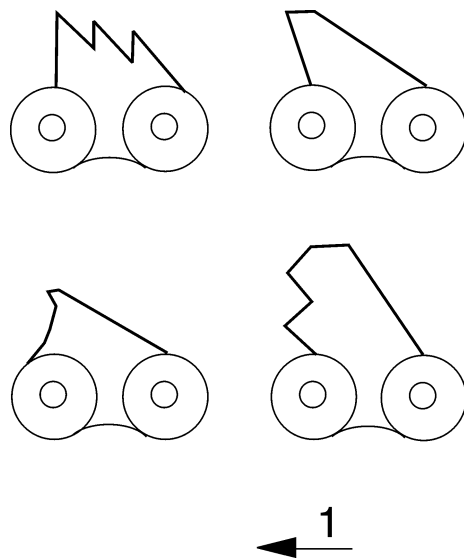

Figure C.4 — Side view of unacceptable tooth profiles

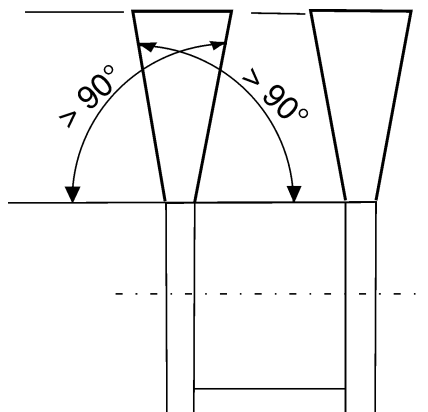

Figure C.5 — Front view of an unacceptable chain tooth profile