

INTERNATIONAL  
STANDARD

**ISO**  
**5611**

Third edition  
1995-09-01

---

---

**Cartridges, type A, for indexable inserts —  
Dimensions**

**iTeh STANDARD PREVIEW**  
*Cartouches du type A, à plaquettes amovibles — Dimensions*  
**(standards.iteh.ai)**

[ISO 5611:1995](https://standards.iteh.ai/catalog/standards/sist/2265477a-8b3b-4b05-a1b1-3919e226a60e/iso-5611-1995)

<https://standards.iteh.ai/catalog/standards/sist/2265477a-8b3b-4b05-a1b1-3919e226a60e/iso-5611-1995>



Reference number  
ISO 5611:1995(E)

## Foreword

ISO (the International Organization for Standardization) is a worldwide federation of national standards bodies (ISO member bodies). The work of preparing International Standards is normally carried out through ISO technical committees. Each member body interested in a subject for which a technical committee has been established has the right to be represented on that committee. International organizations, governmental and non-governmental, in liaison with ISO, also take part in the work. ISO collaborates closely with the International Electrotechnical Commission (IEC) on all matters of electrotechnical standardization.

Draft International Standards adopted by the technical committees are circulated to the member bodies for voting. Publication as an International Standard requires approval by at least 75 % of the member bodies casting a vote.

International Standard ISO 5611 was prepared by Technical Committee ISO/TC 29, *Small tools*, Subcommittee SC 9, *Tools with cutting edges made of hard cutting materials*.

<https://standards.iteh.ai/catalog/standards/sist/2265477a-8b3b-4b05-a1b1-9194e26a8e00/iso-5611-1995>

This third edition cancels and replaces the second edition (ISO 5611:1989), subclause 4.2 of which has been technically revised.

Annex A of this International Standard is for information only.

© ISO 1995

All rights reserved. Unless otherwise specified, no part of this publication may be reproduced or utilized in any form or by any means, electronic or mechanical, including photocopying and microfilm, without permission in writing from the publisher.

International Organization for Standardization  
Case Postale 56 • CH-1211 Genève 20 • Switzerland

Printed in Switzerland

# Cartridges, type A, for indexable inserts — Dimensions

## iTeh STANDARD PREVIEW (standards.iteh.ai)

### 1 Scope

This International Standard specifies the general dimensions of type A cartridges for indexable inserts, and specifies preferred cartridges (see clauses 5 and 6). [ISO 5611:1995](#)

<https://standards.iteh.ai/catalog/standards/sist/2265477a-8b3b-4b05-a1b1-3919e226a60e/iso-5611-1995>

### 2 Normative reference

The following standard contains provisions which, through reference in this text, constitute provisions of this International Standard. At the time of publication, the edition indicated was valid. All standards are subject to revision, and parties to agreements based on this International Standard are encouraged to investigate the possibility of applying the most recent edition of the standard indicated below. Members of IEC and ISO maintain registers of currently valid International Standards.

ISO 3002-1:1982, *Basic quantities in cutting and grinding — Part 1: Geometry of the active part of cutting tools — General terms, reference systems, tool and working angles, chip breakers.*

### 3 Remarks

The designation of cartridges is dealt with in ISO 5608; however, for cartridges, type A, the symbol CA shall be applied in reference (7) of the code of symbolization, and for cartridges with lengths in accordance with this International Standard, the letter symbol identifying tool length is replaced by a dash.

## 4 Dimensions

### 4.1 Shank

The dimensions, in millimetres, given in figure 1 and table 1 apply to shanks of all cartridges styles:

- for cartridges having  
 $h_1 = 6^{1)}$ ,  $8^{2)}$ , 10 and 12

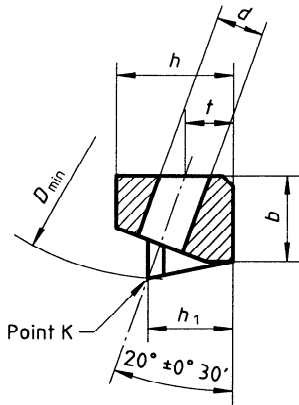

- for cartridges having  
 $h_1 = 6^{1)}$ ,  $8^{2)}$ , 10, 12, 16 and 20

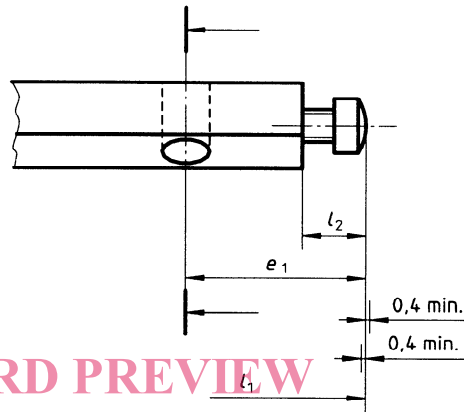

iTeh STANDARD PREVIEW  
(standards.iteh.ai)

- for cartridges having  
 $h_1 = 16, 20$  and 25

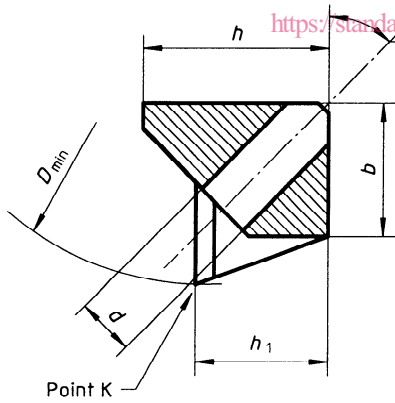

- for cartridges having  
 $h_1 = 25$

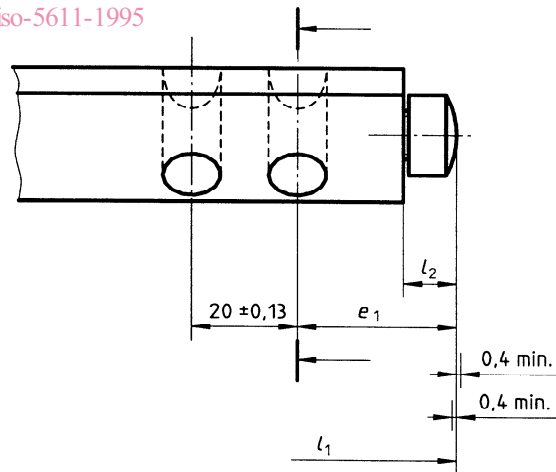

ISO 5611:1995  
<https://standards.iteh.ai/catalog/standards/sist/2265477a-8b3b-4b05-a1b1-3919e226a60e/iso-5611-1995>

- 1) Cartridges designed mainly for indexable inserts in accordance with ISO 6987-2.
- 2) Cartridges designed mainly for indexable inserts in accordance with ISO 6987-1.

Figure 1

Table 1

$h_1$ $\pm 0,08$	$h$ max.	$b$ max.	$e_1$	$l_2$	$f$ $\pm 0,13$	$d$	Fastening screw
6	8,5	6	12	4,5	3,5	4 $\begin{smallmatrix} +0,5 \\ 0 \end{smallmatrix}$	M3,5
8	11	8	17	6	4,5	4,5	M4
10	15	11	20	8	5	7	M6
12	20	16	20	8	6	7	M6
16	25	20	25	8	0	9	M8
20	30	20	30	10	0	9	M8
25	35	25	30	10	0	11	M10

## 4.2 Identification of dimensions $l_1$ , $f$ and $h_1$

**4.2.1** The length dimension  $l_1$  is the distance from the specified point K (see figures 2 to 5) to the end of the shank, including the adjusting screw length  $l_2$  in its mid position.

Dimension  $f$  is the distance between the specified point K and the rear backing surface of the cartridge.

Dimension  $h_1$  is the height to the specified point K.

The values of  $l_1$ ,  $f$  and  $h_1$ , as specified in clause 6, are given for cartridges equipped with master inserts having corner radii in accordance with 4.2.3.

**4.2.2** The specified point K is defined as follows:

Consider plane  $P_f$  (assumed working plane) and  $P_s$  (tool cutting edge plane) according to ISO 3002-1 for a selected point on the major cutting edge (for example point of tangency of major cutting edge with inscribed circle).

- For  $\kappa_r \leq 90^\circ$ , point K is defined as the intersection of plane  $P_s$ , a plane parallel to plane  $P_f$  tangent to the corner radius and a plane containing the tool face  $A_y$  (see figures 2 and 3).
- For  $\kappa_r > 90^\circ$ , point K is defined as the intersection of a plane parallel to plane  $P_f$  tangent to the corner radius, a plane perpendicular to plane  $P_f$  tangent to the corner radius and a plane containing the tool face  $A_y$  (see figures 4 and 5).

**4.2.3** The corner radius  $r_c$  of the master inserts used for the definition of dimensions  $l_1$ ,  $f$  and  $h_1$  is a function of the diameter of the inscribed circle of the insert, as indicated in table 2.

NOTE 1 Dimensions  $l_1$ ,  $f$  and  $h_1$  are based on corner radii  $r_c$  converted from inch values, i.e.  $r_c = 0,397$  mm,  $0,794$  mm and  $1,191$  mm.

Table 2

Dimensions in millimetres

Diameter of the inscribed circle	4,76	5,56	6,35	7,94	9,525	12,7	15,875	19,05
Corner radius $r_c$ (nominal)	0,4			0,8		1,2		

**4.2.4** Cartridges may be equipped with inserts of size in accordance with clause 6 and any corner radius  $r_c$ .

For corner radii  $r_c$  other than those specified in 4.2.3, dimensions  $l_1$  and  $f$  shall be corrected by using the values  $x$  and  $y$  (see figures 2 to 5), which are the distances from the specified point K, as defined in 4.2.2, to the theoretical corner T.

The new dimensions  $l_1$  and  $f$  are found from the differences between  $x$  and  $y$  corresponding to the corner radius according to 4.2.3, and  $x$  and  $y$  corresponding to the real corner radius.

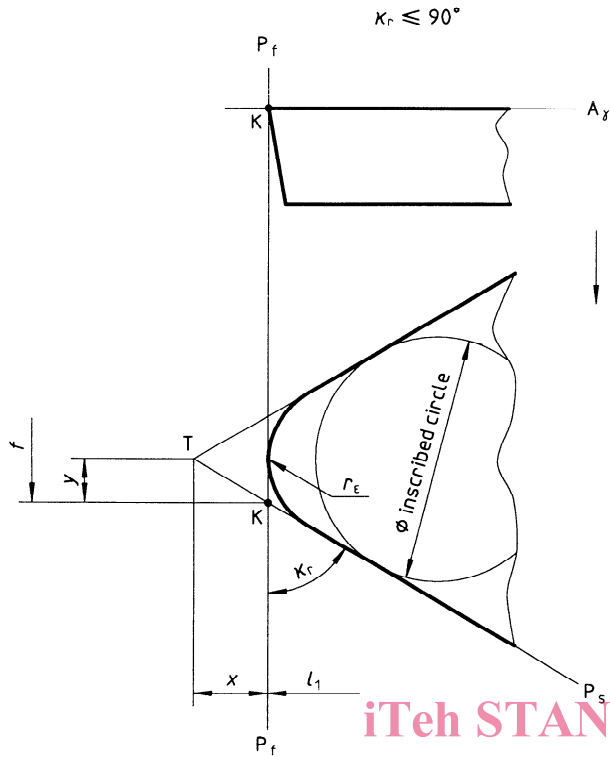

Figure 2

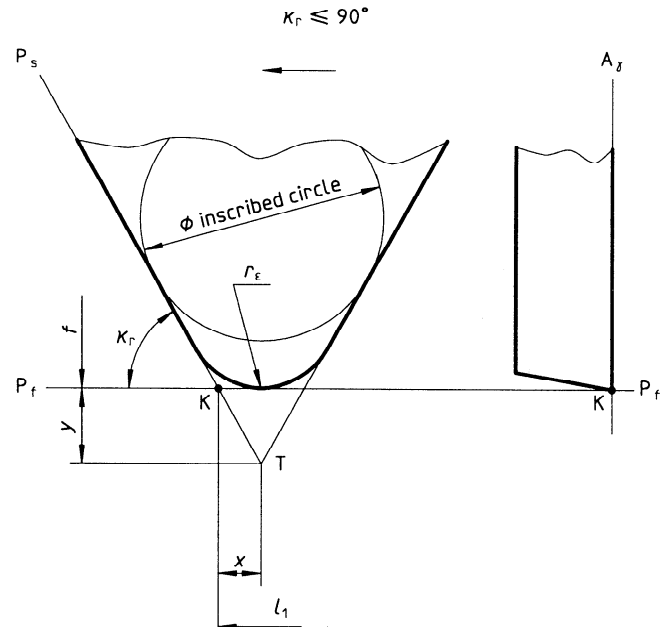

Figure 3

iTeh STANDARD PREVIEW  
(standards.iteh.ai)

ISO 5611:1995

<https://standards.iteh.ai/catalog/standards/sist/2265477a-8b3b-4b05-a1b1-3919e226a60e/iso-5611-1995>

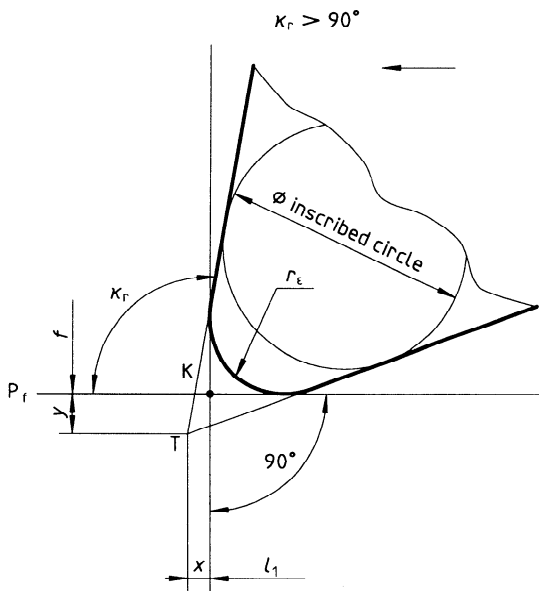

Figure 4

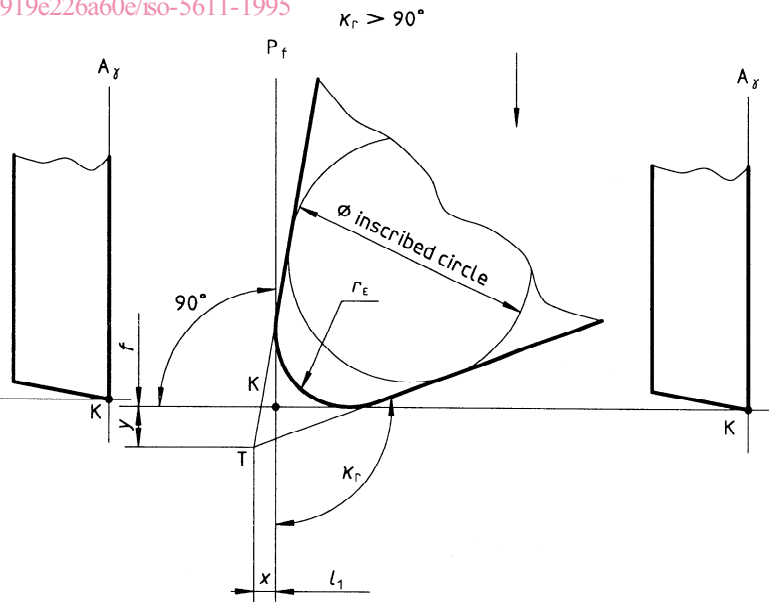

Figure 5

## 5 Preferred cartridge styles

**5.1** Cartridge styles established by this International Standard are the styles shown in figures 6 to 17. In these figures, right-hand cartridges are shown; left-hand cartridges are symmetrical in their layout.

**5.2** The length adjusting screw, as well as the transverse adjusting screw, are at the manufacturer's option; however, dimensions  $f$  and  $l_1$  specified in clause 6 shall be respected.

**5.3** Cartridges are classified into four families in respect of the working major direction and the corner defined. This allows interchangeability of cartridges within a family.

### Family 1

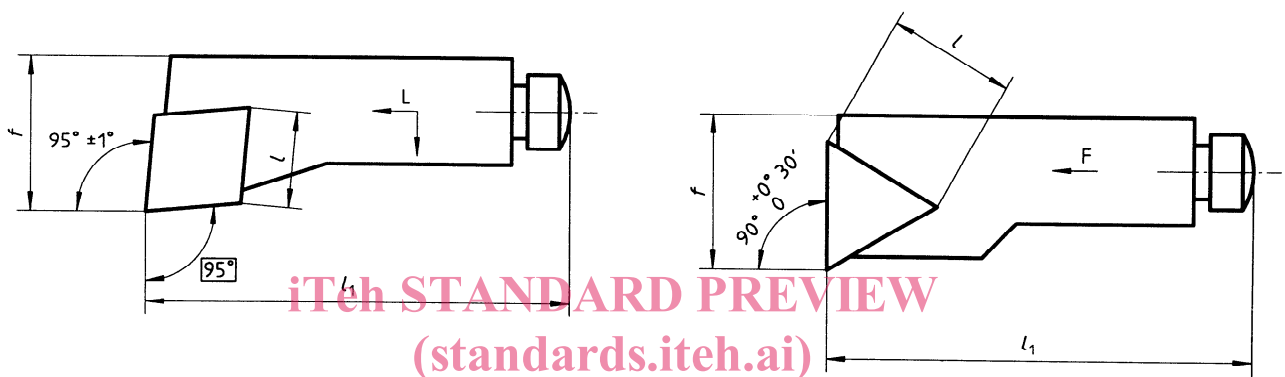

Figure 6

Figure 7

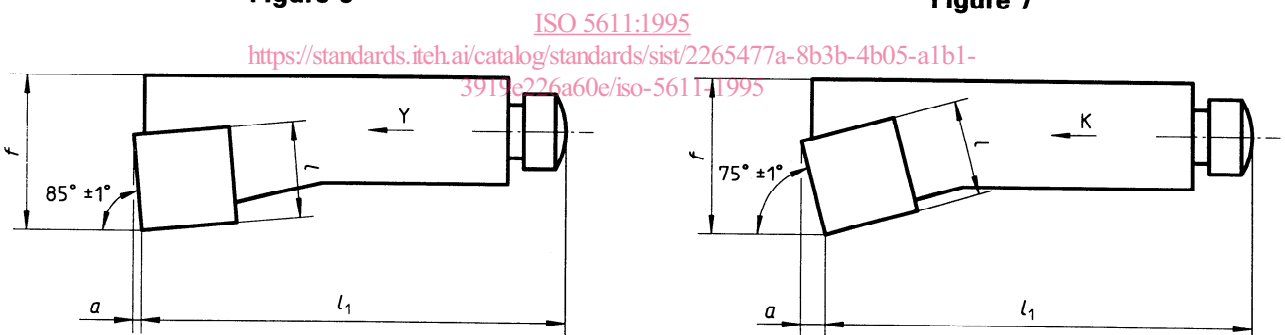

Figure 8

Figure 9

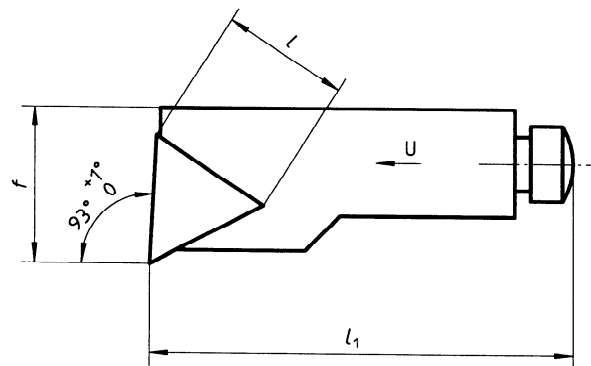

Figure 10

Family 2

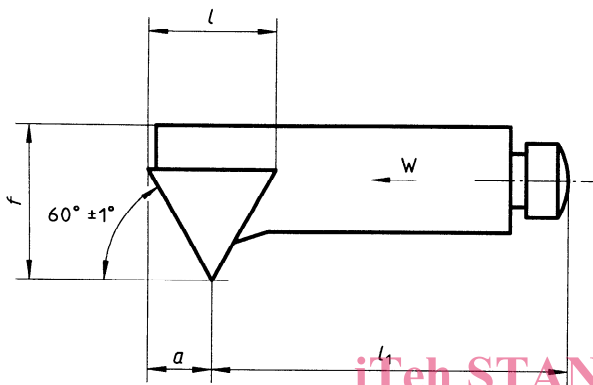

Figure 11

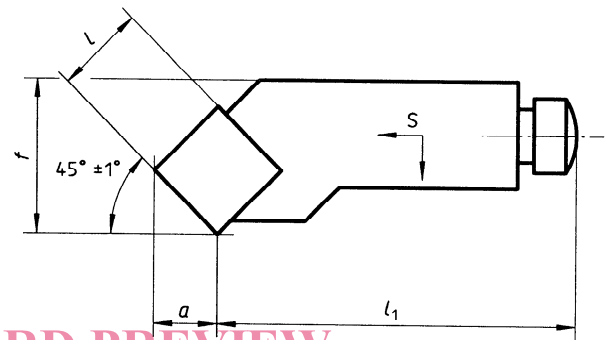

Figure 12

ISO 5611:1995  
<https://standards.iteh.ai/catalog/standards/sist/2265477a-8b3b-4b05-a1b1-3919e226a60e/iso-5611-1995>

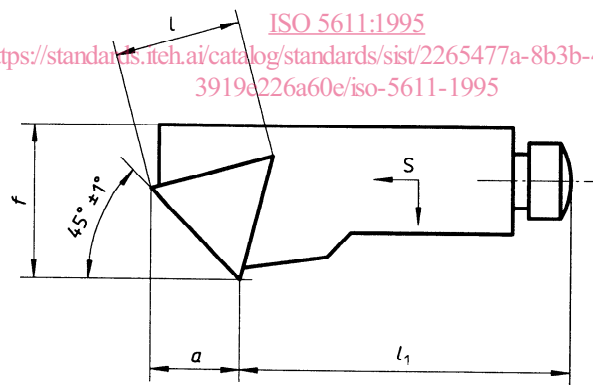
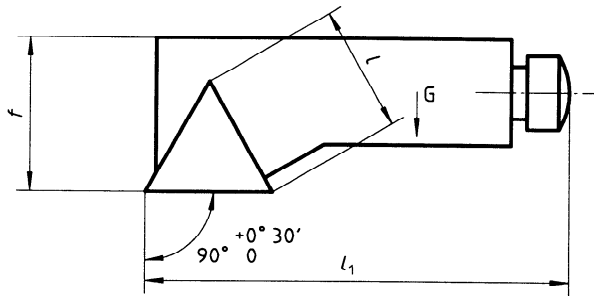

Figure 13



**Family 3**



**Figure 14**

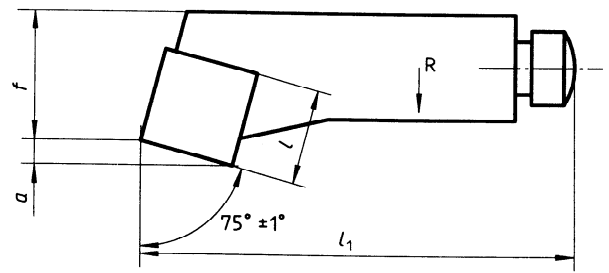

**Figure 15**

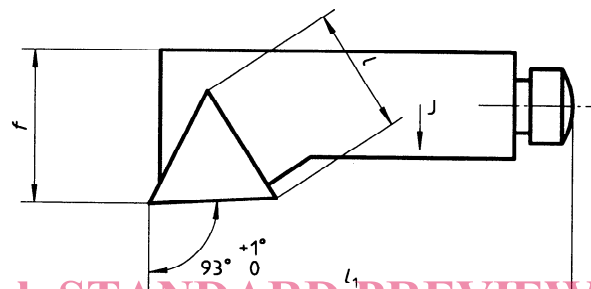

iTeh STANDARD PREVIEW  
Figure 16  
(standards.iteh.ai)

ISO 5611:1995

<https://standards.iteh.ai/catalog/standards/sist/2265477a-8b3b-4b05-a1b1-3919e226a60e/iso-5611-1995>

**Family 4**

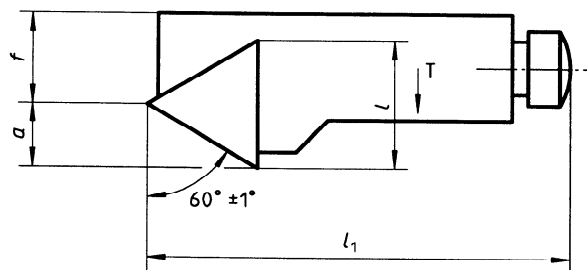

**Figure 17**