



SLOVENSKI STANDARD

SIST EN 14714:2005

01-september-2005

Inland navigation vessels – Connection nozzle for equipment and devices at cargo tanks – Dimensions

Inland navigation vessels - Connection nozzle for equipment and devices at cargo tanks
- Dimensions

Fahrzeuge der Binnenschifffahrt - Anschlussstutzen für Geräte und Einrichtungen an
Ladetanks - Maße

Bateaux de navigation intérieure - Raccord pour l'installation du prélèvement des
échantillons sur navire-citerne - Dimensions

Ta slovenski standard je istoveten z: EN 14714:2005

ICS:

47.020.85	Prostori za tovor	Cargo spaces
47.060	Razporeditev prostora za tovor na ladju	Inland navigation vessels

SIST EN 14714:2005

en

iTeh STANDARD PREVIEW
(standards.iteh.ai)

SIST EN 14714:2005

<https://standards.iteh.ai/catalog/standards/sist/1d665baa-f762-477a-bec0-c4eabed5444a/sist-en-14714-2005>

EUROPEAN STANDARD
NORME EUROPÉENNE
EUROPÄISCHE NORM

EN 14714

April 2005

ICS 47.020.85; 47.060

English version

**Inland navigation vessels - Connection nozzle for equipment and
devices at cargo tanks - Dimensions**

Bateaux de navigation intérieure - Raccord pour
l'installation du prélèvement des échantillons sur navire-
citerne - Dimensions

Fahrzeuge der Binnenschifffahrt - Anschlussstutzen für
Geräte und Einrichtungen an Ladetanks - Maße

This European Standard was approved by CEN on 14 February 2005.

CEN members are bound to comply with the CEN/CENELEC Internal Regulations which stipulate the conditions for giving this European Standard the status of a national standard without any alteration. Up-to-date lists and bibliographical references concerning such national standards may be obtained on application to the Central Secretariat or to any CEN member.

This European Standard exists in three official versions (English, French, German). A version in any other language made by translation under the responsibility of a CEN member into its own language and notified to the Central Secretariat has the same status as the official versions.

CEN members are the national standards bodies of Austria, Belgium, Cyprus, Czech Republic, Denmark, Estonia, Finland, France, Germany, Greece, Hungary, Iceland, Ireland, Italy, Latvia, Lithuania, Luxembourg, Malta, Netherlands, Norway, Poland, Portugal, Slovakia, Slovenia, Spain, Sweden, Switzerland and United Kingdom.

[SIST EN 14714:2005](https://standards.iteh.ai/catalog/standards/sist/1d665baa-f762-477a-bec0-c4eabed5444a/sist-en-14714-2005)

<https://standards.iteh.ai/catalog/standards/sist/1d665baa-f762-477a-bec0-c4eabed5444a/sist-en-14714-2005>



EUROPEAN COMMITTEE FOR STANDARDIZATION
COMITÉ EUROPÉEN DE NORMALISATION
EUROPÄISCHES KOMITEE FÜR NORMUNG

Management Centre: rue de Stassart, 36 B-1050 Brussels

Contents

Page

Foreword	3
1 Scope	4
2 Normative references	4
3 Dimensions, assembly	4
4 Materials	7
5 Designation.....	7
6 Marking	7

iTeh STANDARD PREVIEW
(standards.iteh.ai)

[SIST EN 14714:2005](https://standards.iteh.ai/catalog/standards/sist/1d665baa-f762-477a-bec0-c4eabed5444a/sist-en-14714-2005)

<https://standards.iteh.ai/catalog/standards/sist/1d665baa-f762-477a-bec0-c4eabed5444a/sist-en-14714-2005>

Foreword

This document (EN 14714:2005) has been prepared by Technical Committee CEN/TC 15 "Inland navigation vessels", the secretariat of which is held by DIN.

This European Standard shall be given the status of a national standard, either by publication of an identical text or by endorsement, at the latest by October 2005, and conflicting national standards shall be withdrawn at the latest by October 2005

This document addresses the requirement of the ADN/ADN (European Convention for the Transportation of Dangerous Goods on the Rhine/European Convention for the Transportation of Dangerous Goods on Waterways) with regard to the connection possibilities of an enclosed/partially enclosed sampling device. The connection nozzle may be used both for quality and quantity control of the liquid goods transported and for visual examination of empty cargo tanks.

This standardized interface is intended to facilitate the measures required for inspection and service..

According to the CEN/CENELEC Internal Regulations, the national standards organizations of the following countries are bound to implement this European Standard: Austria, Belgium, Cyprus, Czech Republic, Denmark, Estonia, Finland, France, Germany, Greece, Hungary, Iceland, Ireland, Italy, Latvia, Lithuania, Luxembourg, Malta, Netherlands, Norway, Poland, Portugal, Slovakia, Slovenia, Spain, Sweden, Switzerland and the United Kingdom.

iTeh STANDARD PREVIEW
(standards.iteh.ai)

SIST EN 14714:2005

<https://standards.iteh.ai/catalog/standards/sist/1d665baa-f762-477a-bec0-c4eabed5444a/sist-en-14714-2005>

EN 14714:2005 (E)**1 Scope**

This document specifies requirements for the connection nozzle for equipment and devices at cargo tanks of tankers used in inland navigation and describes the interface of this equipment and these devices with the cargo tank.

2 Normative references

The following referenced documents are indispensable for the application of this document. For dated references, only the edition cited applies. For undated references, the latest edition of the referenced document (including any amendments) applies.

EN 1092-1, *Flanges and their joints — Circular flanges for pipes, valves, fittings and accessories, PN designated — Part 1: Steel flanges*

prEN 1983, *Industrial valves — Steel ball valves*

EN 14420-6, *Hose fittings with clamp units — Part 6: TW tank truck couplings*

EN ISO 228-1:2003, *Pipe threads where pressure-tight joints are not made on the threads — Part 1: Dimensions, tolerances and designation (ISO 228-1:2000).*

ISO 4200, *Plain end steel tubes, welded and seamless — General tables of dimensions and masses per unit length*

3 Dimensions, assembly

The shipside connection nozzle shall be either of

— type A (pipe socket and flange) as shown in Figure 1 or

— type B (flange connected directly to the tank) as shown in Figure 2

The equipment-side connection shall have a coupling as shown in Figure 3.

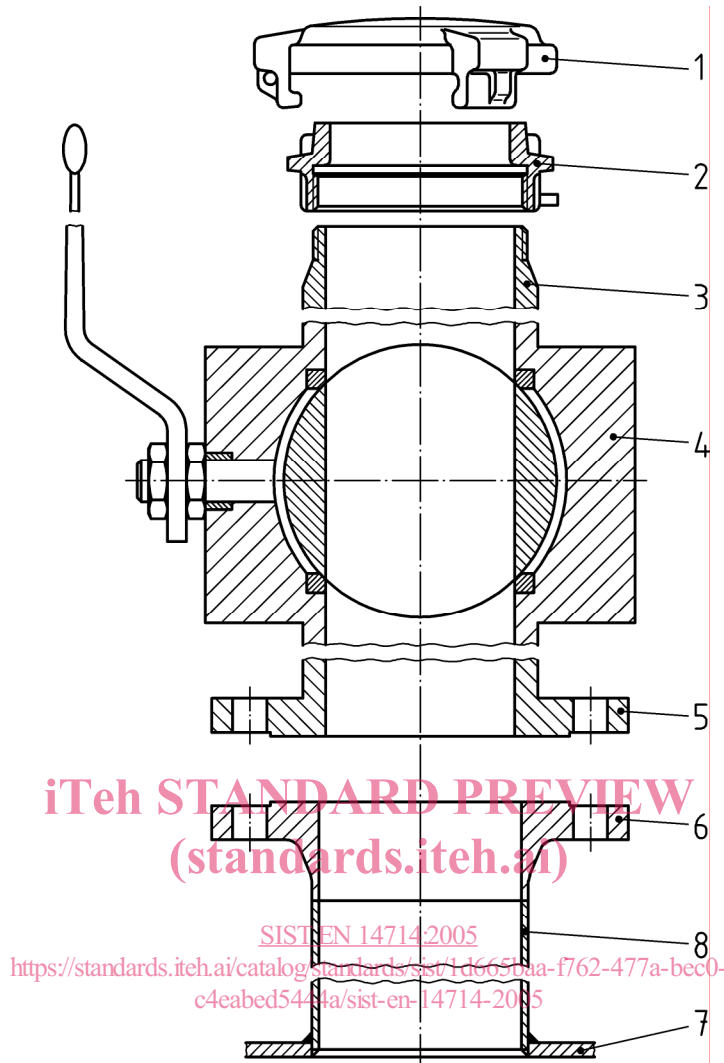

Key

- 1 Dust cap (type MB) DN 100 PN 10 according to EN 14420-6
- 2 Male coupling (type VK) DN 100 PN 10 according to EN 14420-6 with pipe thread EN ISO 228:2003 – G4
- 3 Pipe thread EN ISO 228:2003 – G4A
- 4 Shutoff valve DN 100, PN 16, effective diameter 98 mm e.g. ball valve according to prEN 1983
- 5 Connecting flange DN 100, PN 16 fitting 6
- 6 Weld-neck flange DN 100, PN 16 according to EN 1092-1
- 7 Tank shell
- 8 Pipe 114,3 × 3,6 according to ISO 4200

NOTE For materials, see Clause 4

Figure 1 — Shippside connection nozzle, type A

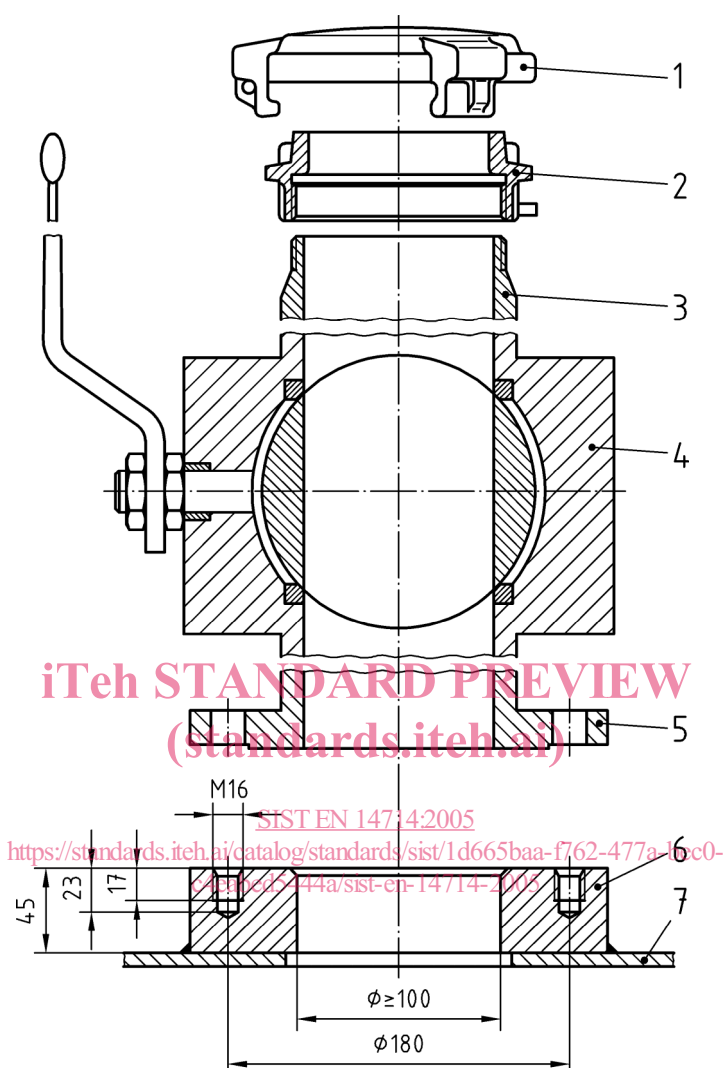

Key

- 1 Dust cap (type MB) DN 100 PN 10 according to EN 14420-6
- 2 Male coupling (type VK) DN 100 PN 10 according to EN 14420-6 with pipe thread EN ISO 228:2003 – G4
- 3 Pipe thread EN ISO 228:2003 – G4A
- 4 Shutoff valve DN 100, PN 16, effective diameter 98 mm e.g. ball valve according to prEN 1983
- 5 Connecting flange DN 100, PN 16 fitting 6
- 6 Weld-on flange DN 100, PN 16, number of bolt holes - 8
- 7 Tank shell

NOTE For materials, see Clause 4

Figure 2 — Shiplside connection nozzle, type B