



SLOVENSKI STANDARD

SIST EN 581-1:2006

01-julij-2006

BUXca Yý U.

SIST EN 581-1:1997

Ni bUbY'dc\ jýh c'! GYXYbc'dc\ jýh c'jb'a]nY'nUXca U c'jb'Uj bc'i dcfUVc'hf
HUVcfYbY!'%'XY.'Gd'cýbY'j UfbcgfbY'nU hýj Y

Outdoor furniture - Seating and tables for camping, domestic and contract use - Part 1:
General safety requirements

Außenmöbel - Sitzmöbel und Tische für den Camping-, Wohn- und Objektbereich - Teil
1: Allgemeine sicherheitstechnische Anforderungen

(standards.iteh.ai)

Mobilier d'extérieur - Sieges et tables a usages domestique, collectif et de camping -
Partie 1 : Exigences générales de sécurité

<https://standards.iteh.ai/catalog/standards/sist/c9ba4c13-323d-4e29-bbfe-0f267de1638d/sist-en-581-1-2006>

Ta slovenski standard je istoveten z: **EN 581-1:2006**

ICS:

97.140

97.200.30

SIST EN 581-1:2006

en

iTeh STANDARD PREVIEW
(standards.iteh.ai)

SIST EN 581-1:2006

<https://standards.iteh.ai/catalog/standards/sist/c9ba4c13-323d-4e29-bbfe-0f267de1638d/sist-en-581-1-2006>

English Version

Outdoor furniture - Seating and tables for camping, domestic and contract use - Part 1: General safety requirements

Mobilier d'extérieur - Sièges et tables à usages domestique, collectif et de camping - Partie 1 : Exigences générales de sécurité

Außenmöbel - Sitzmöbel und Tische für den Camping-, Wohn- und Objektbereich - Teil 1: Allgemeine sicherheitstechnische Anforderungen

This European Standard was approved by CEN on 9 January 2006.

CEN members are bound to comply with the CEN/CENELEC Internal Regulations which stipulate the conditions for giving this European Standard the status of a national standard without any alteration. Up-to-date lists and bibliographical references concerning such national standards may be obtained on application to the Central Secretariat or to any CEN member.

This European Standard exists in three official versions (English, French, German). A version in any other language made by translation under the responsibility of a CEN member into its own language and notified to the Central Secretariat has the same status as the official versions.

CEN members are the national standards bodies of Austria, Belgium, Cyprus, Czech Republic, Denmark, Estonia, Finland, France, Germany, Greece, Hungary, Iceland, Ireland, Italy, Latvia, Lithuania, Luxembourg, Malta, Netherlands, Norway, Poland, Portugal, Romania, Slovakia, Slovenia, Spain, Sweden, Switzerland and United Kingdom.

[SIST EN 581-1:2006](https://standards.iteh.ai/catalog/standards/sist/c9ba4c13-323d-4e29-bbfe-0f267de1638d/sist-en-581-1-2006)

<https://standards.iteh.ai/catalog/standards/sist/c9ba4c13-323d-4e29-bbfe-0f267de1638d/sist-en-581-1-2006>



EUROPEAN COMMITTEE FOR STANDARDIZATION
COMITÉ EUROPÉEN DE NORMALISATION
EUROPÄISCHES KOMITEE FÜR NORMUNG

Management Centre: rue de Stassart, 36 B-1050 Brussels

Contents	Page
Foreword	3
1 Scope	4
2 Normative references	4
3 Terms and definitions	4
4 Test equipment	4
5 Safety requirements	5
6 Test report	6
Annex A (informative) Schematic presentation of requirements and conditions concerning shear and squeeze points	7
Annex B (informative) Terminology	8

iTeh STANDARD PREVIEW
(standards.iteh.ai)

SIST EN 581-1:2006

<https://standards.iteh.ai/catalog/standards/sist/c9ba4c13-323d-4e29-bbfe-0f267de1638d/sist-en-581-1-2006>

Foreword

This European Standard (EN 581-1:2006) has been prepared by Technical Committee CEN/TC 207 "Furniture", the secretariat of which is held by UNI.

This European Standard shall be given the status of a national standard, either by publication of an identical text or by endorsement, at the latest by August 2006, and conflicting national standards shall be withdrawn at the latest by August 2006.

This European Standard supersedes EN 581-1:1997.

According to the CEN/CENELEC Internal Regulations, the national standards organizations of the following countries are bound to implement this European Standard: Austria, Belgium, Cyprus, Czech Republic, Denmark, Estonia, Finland, France, Germany, Greece, Hungary, Iceland, Ireland, Italy, Latvia, Lithuania, Luxembourg, Malta, Netherlands, Norway, Poland, Portugal, Slovakia, Slovenia, Spain, Sweden, Switzerland and United Kingdom.

iTeh STANDARD PREVIEW (standards.iteh.ai)

SIST EN 581-1:2006

<https://standards.iteh.ai/catalog/standards/sist/c9ba4c13-323d-4e29-bbfe-0f267de1638d/sist-en-581-1-2006>

1 Scope

This European Standard specifies the general safety requirements for outdoor seating and tables for camping, domestic and contract use.

It does not apply to removable upholstery, coverings and permanently fixed furniture.

Annex A (informative) is a schematic presentation of requirements and conditions concerning shear and squeeze points.

Annex B (informative) includes a terminology for outdoor furniture.

2 Normative references

The following referenced documents are indispensable for the application of this document. For dated references, only the edition cited applies. For undated references, the latest edition of the referenced document (including any amendments) applies.

ENV 581-2 *Outdoor furniture – Seating and tables for camping, domestic and contract use – Part 2: Mechanical safety requirements and test methods for sampling*

EN 581-3 *Outdoor furniture - Seating and tables for camping, domestic and contract use – Part 3: Mechanical safety requirements and test methods for tables*

3 Terms and definitions

For the purposes of this European Standard, the following terms and definitions apply.

3.1

Parts accessible during use

parts to which access can be easily gained when the furniture is in its intended configuration of use and for which unintentional contact is foreseeable

3.2

Automatic locking mechanism

mechanism which engages without guidance by the user and prevents unintended movement

3.3

Shear and squeeze point

shear and squeeze points exist if the distance between two accessible parts moving relative to each other is less than 18 mm and more than 7 mm in any position during movement

4 Test probe

Probes made of hard, smooth material, see Fig. 1. There shall be 3 probes having diameters of 7 mm, 12 mm and 18 mm with hemispherical end.

Dimensions in millimetres

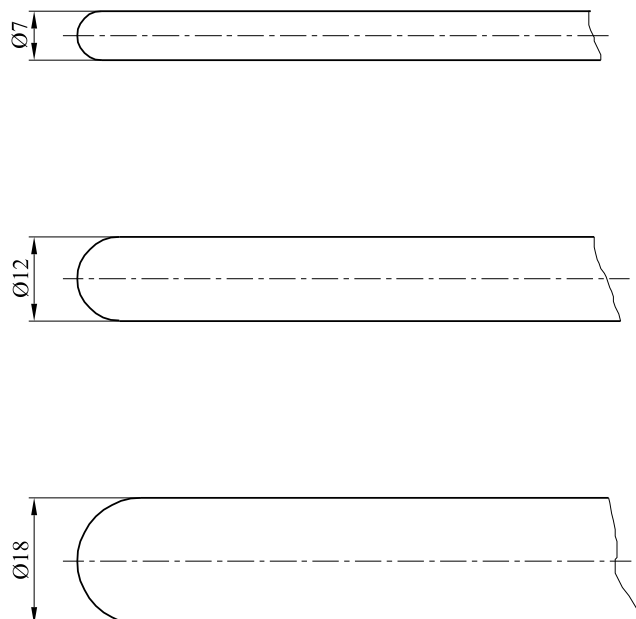

Figure 1 — Test probes
 iTeh STANDARD PREVIEW
 (standards.iteh.ai)

5 Safety requirements

SIST EN 581-1:2006

5.1 Edges and corners

For seating, the edges and corners of the seat, back rest and arm rests which are directly in contact with the user when sitting, lying or reclining shall be rounded or chamfered.

For table tops the edges and corners which are directly in contact with the user shall be rounded or chamfered.

All other edges and corners of seating and tables, accessible during use shall be free from burrs or/and sharp edges.

5.2 Tubular components, holes and gaps accessible during use

Tubular components, holes and gaps accessible during use shall be covered if a 7 mm or 12 mm test probe (Clause 4) can be pushed into them in any direction with a maximum force of 30 N to a depth of more than 10 mm and cannot be pulled out again in the reverse direction by a maximum force of 30 N.

Bottom of tubular legs shall be capped or plugged.

5.3 Shear and squeeze points

5.3.1 Shear and squeeze points when setting up and folding

Unless 5.3.2 or 5.3.3 are applicable, shear and squeeze points that are created only during setting up or folding are acceptable providing the user can be assumed to be in control of his/her movements and to be able to cease applying the force immediately on experiencing pain.

EN 581-1:2006 (E)

The edges of parts moving relative to each other and creating shear and squeeze points shall be as specified in 5.1.

5.3.2 Shear and squeeze points under the influence of powered mechanisms

There shall be no accessible shear and squeeze points created by parts of the furniture operated by powered mechanisms, e.g. mechanical springs, gas lifts.

5.3.3 Shear and squeeze points during use

There shall be no accessible shear and squeeze points created by loads applied during normal use.

For seating, the loads applied during normal use can be found in ENV 581-2, and for tables in EN 581-3.

Shear and squeeze points are not acceptable if a hazard is created by the weight of the user during normal movements and actions, e.g. attempting to move the seating by lifting the seat or by adjusting the backrest.

NOTE This hazard is best prevented by the use of automatic locking mechanisms.

6 Test report

The test report shall include at least the following information:

- a) reference to this European Standard;
- b) furniture tested (relevant data);
- c) test results;
- d) details of any deviations from this European Standard;
- e) name and address of the test facility;
- f) date of test.

STANDARD PREVIEW

(standards.iteh.ai)

SIST EN 581-1:2006

<https://standards.iteh.ai/catalog/standards/sist/c9ba4c13-323d-4e29-bbfe-0f267de1638d/sist-en-581-1-2006>

Annex A (informative)

Schematic presentation of requirements and conditions concerning shear and squeeze points

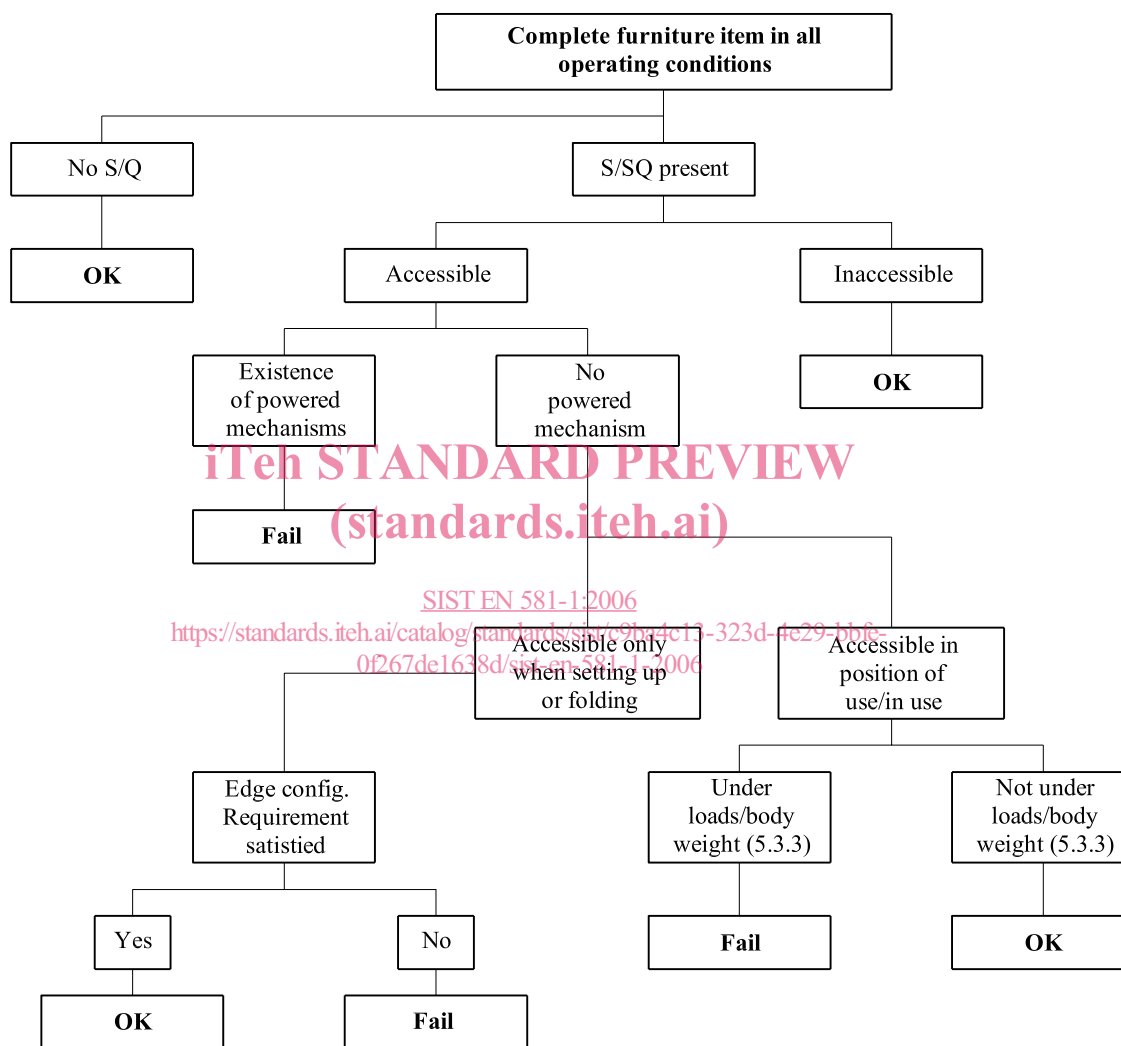

Figure A.1 - Schematic presentation of requirements and conditions concerning shear and squeeze points