



SLOVENSKI STANDARD
SIST EN 14965:2006
01-september-2006

D`cj]`UnUW`]bg_Y`j cXY`E`D`cý Uh`df]j Ynb]_]

Inland navigation vessels - Flat bollards

Fahrzeuge der Binnenschifffahrt - Flachpoller

Bateaux de navigation intérieure - Bittes plates

iTeh STANDARD PREVIEW

Ta slovenski standard je istoveten z: EN 14965:2005

(standards.iteh.ai)

SIST EN 14965:2006

<https://standards.iteh.ai/catalog/standards/sist/f37fa2fc-ab9c-45c7-9431-c1a093485902/sist-en-14965-2006>

ICS:

47.020.50

47.060

SIST EN 14965:2006

en

iTeh STANDARD PREVIEW **(standards.iteh.ai)**

SIST EN 14965:2006

<https://standards.iteh.ai/catalog/standards/sist/f37fa2fc-ab9c-45c7-9431-c1a093485902/sist-en-14965-2006>

ICS 47.020.50; 47.060

English Version

Inland navigation vessels - Flat bollards

Bateaux de navigation intérieure - Bittes plates

Fahrzeuge der Binnenschifffahrt - Flachpoller

This European Standard was approved by CEN on 14 November 2005.

CEN members are bound to comply with the CEN/CENELEC Internal Regulations which stipulate the conditions for giving this European Standard the status of a national standard without any alteration. Up-to-date lists and bibliographical references concerning such national standards may be obtained on application to the Central Secretariat or to any CEN member.

This European Standard exists in three official versions (English, French, German). A version in any other language made by translation under the responsibility of a CEN member into its own language and notified to the Central Secretariat has the same status as the official versions.

CEN members are the national standards bodies of Austria, Belgium, Cyprus, Czech Republic, Denmark, Estonia, Finland, France, Germany, Greece, Hungary, Iceland, Ireland, Italy, Latvia, Lithuania, Luxembourg, Malta, Netherlands, Norway, Poland, Portugal, Slovakia, Slovenia, Spain, Sweden, Switzerland and United Kingdom.

STANDARD PREVIEW
(standards.iteh.ai)
<https://standards.iteh.ai/catalog/standards/sist/f37fa2fc-ab9c-45c7-9431-c1a093485902/sist-en-14965-2006>



EUROPEAN COMMITTEE FOR STANDARDIZATION
COMITÉ EUROPÉEN DE NORMALISATION
EUROPÄISCHES KOMITEE FÜR NORMUNG

Management Centre: rue de Stassart, 36 B-1050 Brussels

Contents

Page

Foreword	3
1 Scope	4
2 Normative references	4
3 Dimensions	4
4 Material	5
5 Design	5
5.1 Type	5
5.2 Machining	5
5.3 Fastening	5
6 Designation	5
7 Marking	5
8 Manufacturer's certificate	6
Annex A (normative) Flat bollards made of cast steel	7
A.1 Material	7
A.2 Heat treatment	7
A.3 Dimensions of the cast steel	7
A.4 Fastening	7
Bibliography	8

[SIST EN 14965:2006](https://standards.iteh.ai/catalog/standards/sist/f37fa2fc-ab9c-45c7-9431-c1a093485902/sist-en-14965-2006)

<https://standards.iteh.ai/catalog/standards/sist/f37fa2fc-ab9c-45c7-9431-c1a093485902/sist-en-14965-2006>

Foreword

This document (EN 14965:2005) has been prepared by Technical Committee CEN/TC 15 “Inland navigation vessels”, the secretariat of which is held by DIN.

This document shall be given the status of a national standard, either by publication of an identical text or by endorsement, at the latest by June 2006, and conflicting national standards shall be withdrawn at the latest by June 2006.

Flat bollards have proven successful in push-towing.

According to the CEN/CENELEC Internal Regulations, the national standards organizations of the following countries are bound to implement this European Standard: Austria, Belgium, Cyprus, Czech Republic, Denmark, Estonia, Finland, France, Germany, Greece, Hungary, Iceland, Ireland, Italy, Latvia, Lithuania, Luxembourg, Malta, Netherlands, Norway, Poland, Portugal, Slovakia, Slovenia, Spain, Sweden, Switzerland and the United Kingdom.

iTeh STANDARD PREVIEW (standards.iteh.ai)

SIST EN 14965:2006

<https://standards.iteh.ai/catalog/standards/sist/f37fa2fc-ab9c-45c7-9431-c1a093485902/sist-en-14965-2006>

1 Scope

This European Standard specifies dimensions, material, design and designation of flat bollards used preferably for pushing vessels and for guiding ropes of coupling devices, e.g. according to EN ISO 6218, on push-tows.

2 Normative references

The following referenced documents are indispensable for the application of this document. For dated references, only the edition cited applies. For undated references, the latest edition of the referenced document (including any amendments) applies.

ISO 2768-1, *General tolerances — Part 1: Tolerances for linear and angular dimensions without individual tolerance indications*

ISO 8062, *Castings — System of dimensional tolerances and machining allowances*

3 Dimensions

For general tolerances for sheet steel, class c of ISO 2768-1 shall apply.

For general tolerances for cast steel, class CT 12 of ISO 8062 shall apply.

The design need not correspond to the design illustrated, compliance is only required with the main dimensions given in Table 1.

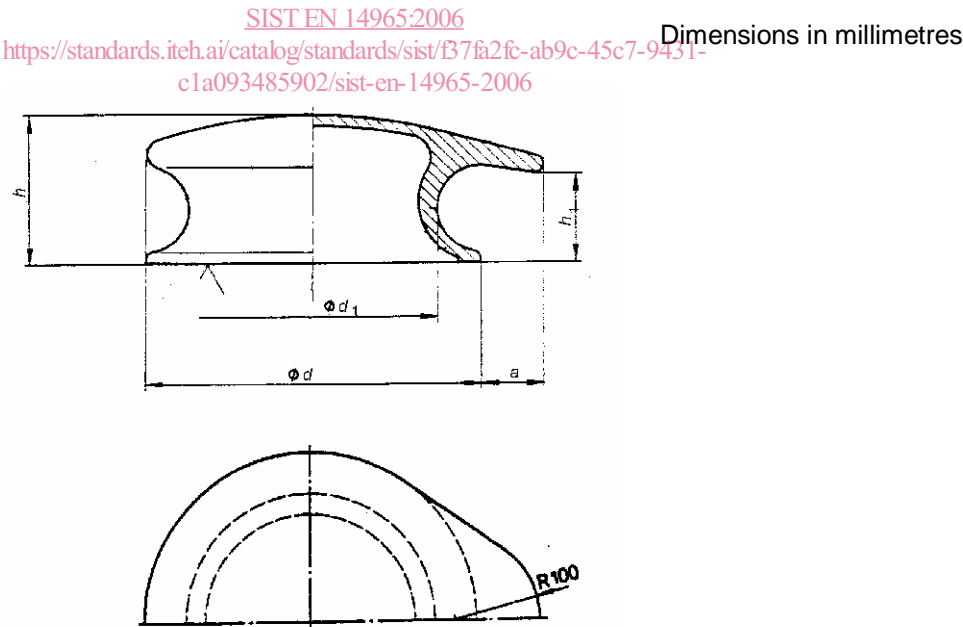

Table 1 — Main dimensions

h	d	a	d_1	h_1
175	400	75	300	115

Figure 1 — Flat bollard

4 Material

Steel with tensile strength of 450 N/mm² and yield point of 230 N/mm².

5 Design

5.1 Type

Flat bollards may be made:

- of cast steel type (G) according to Annex A or
- welded steel sheets, type (W).

5.2 Machining

All edges shall be rounded.

The surface in contact with the ropes (rope groove) shall not have any scratches or ridges.

The top of the bollard shall be of anti-slip design, e.g. welded-on studs.

5.3 Fastening

Bollards shall be welded with a continuous, circumferential fillet weld with a weld thickness of 7 mm.

The manufacturer shall supply a description with the following information on the fastening:

- material to which the flat bollard may be fastened;
- dimensioning of the fastening;
- flat bollards shall be welded to reinforced deck areas;
- position of the nose.

6 Designation

Designation of a flat bollard as specified in this standard of type (G):

Flat bollard EN 14965 – G

7 Marking

7.1 Flat bollards shall be marked with:

- EN 14965;
- name or logo of the manufacturer.

7.2 The marking shall be permanently embossed or raised and be legible after installation of the bollard.

8 Manufacturer's certificate

The manufacturer shall declare that the flat bollards comply with this standard.

iTeh STANDARD PREVIEW
(standards.iteh.ai)

SIST EN 14965:2006

<https://standards.iteh.ai/catalog/standards/sist/f37fa2fc-ab9c-45c7-9431-c1a093485902/sist-en-14965-2006>

Annex A (normative)

Flat bollards made of cast steel

A.1 Material

Cast steel GS-450, material number 1.0446 as specified in EN 10027-2.

A.2 Heat treatment

Normalized as specified in EN 10052.

A.3 Dimensions of the cast steel

See Figure A.1

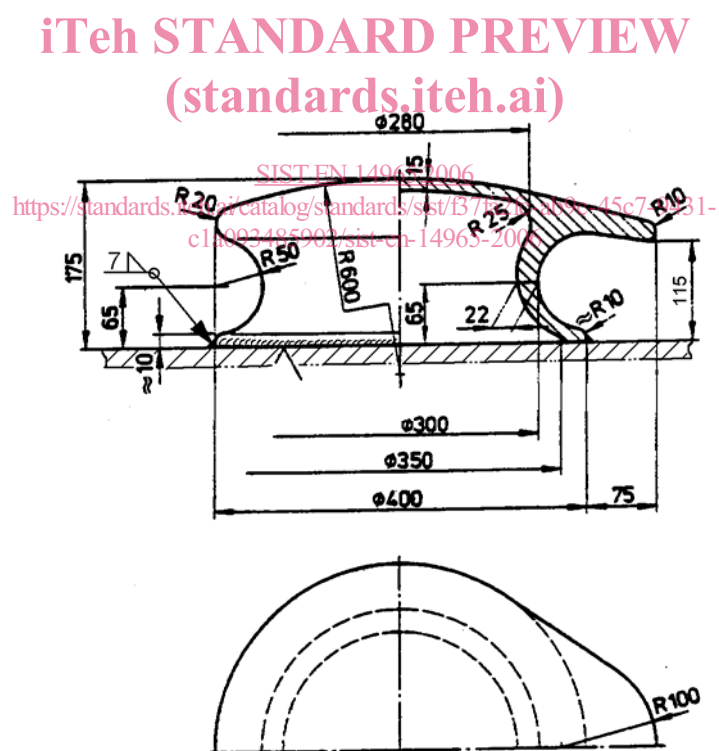

Figure A.1 — Flat bollard made of cast steel

A.4 Fastening

Circumferential fillet weld with a weld thickness of 7 mm.