**Photography — Room-light loading
packages for electronic scanners and
image-setting film and paper rolls —
Dimensions and related requirements**

*Photographie — Emballages de chargement à la lumière artificielle pour
scanners électroniques, et films et rouleaux de papier pour régler l'image —
Dimensions et exigences connexes*

iTeh STANDARD PREVIEW
(standards.iteh.ai)

ISO 14535:2001

<https://standards.iteh.ai/catalog/standards/sist/a24a0173-e6e7-4446-ab0a-e9a332911bd9/iso-14535-2001>



PDF disclaimer

This PDF file may contain embedded typefaces. In accordance with Adobe's licensing policy, this file may be printed or viewed but shall not be edited unless the typefaces which are embedded are licensed to and installed on the computer performing the editing. In downloading this file, parties accept therein the responsibility of not infringing Adobe's licensing policy. The ISO Central Secretariat accepts no liability in this area.

Adobe is a trademark of Adobe Systems Incorporated.

Details of the software products used to create this PDF file can be found in the General Info relative to the file; the PDF-creation parameters were optimized for printing. Every care has been taken to ensure that the file is suitable for use by ISO member bodies. In the unlikely event that a problem relating to it is found, please inform the Central Secretariat at the address given below.

iTeh STANDARD PREVIEW
(standards.iteh.ai)

ISO 14535:2001

<https://standards.iteh.ai/catalog/standards/sist/a24a0173-e6e7-4446-ab0a-e9a332911bd9/iso-14535-2001>

© ISO 2001

All rights reserved. Unless otherwise specified, no part of this publication may be reproduced or utilized in any form or by any means, electronic or mechanical, including photocopying and microfilm, without permission in writing from either ISO at the address below or ISO's member body in the country of the requester.

ISO copyright office
Case postale 56 • CH-1211 Geneva 20
Tel. + 41 22 749 01 11
Fax + 41 22 749 09 47
E-mail copyright@iso.ch
Web www.iso.ch

Printed in Switzerland

Contents

	Page
1 Scope	1
2 Normative references	1
3 Conditions for measurement of dimensions	1
4 Film and paper dimensions	1
5 Winding orientation	1
6 Dimensions of flanges	2
7 Packaging	4
8 Leader	4
9 Package marking	5
10 Compliance	5
Bibliography.....	6

iTeh STANDARD PREVIEW
(standards.iteh.ai)

[ISO 14535:2001](https://standards.iteh.ai/catalog/standards/sist/a24a0173-e6e7-4446-ab0a-e9a332911bd9/iso-14535-2001)

<https://standards.iteh.ai/catalog/standards/sist/a24a0173-e6e7-4446-ab0a-e9a332911bd9/iso-14535-2001>

Foreword

ISO (the International Organization for Standardization) is a worldwide federation of national standards bodies (ISO member bodies). The work of preparing International Standards is normally carried out through ISO technical committees. Each member body interested in a subject for which a technical committee has been established has the right to be represented on that committee. International organizations, governmental and non-governmental, in liaison with ISO, also take part in the work. ISO collaborates closely with the International Electrotechnical Commission (IEC) on all matters of electrotechnical standardization.

International Standards are drafted in accordance with the rules given in the ISO/IEC Directives, Part 3.

Draft International Standards adopted by the technical committees are circulated to the member bodies for voting. Publication as an International Standard requires approval by at least 75 % of the member bodies casting a vote.

Attention is drawn to the possibility that some of the elements of this International Standard may be the subject of patent rights. ISO shall not be held responsible for identifying any or all such patent rights.

International Standard ISO 14535 was prepared by Technical Committee ISO/TC 42, *Photography*.

iTeh STANDARD PREVIEW (standards.iteh.ai)

[ISO 14535:2001](https://standards.iteh.ai/catalog/standards/sist/a24a0173-e6e7-4446-ab0a-e9a332911bd9/iso-14535-2001)

<https://standards.iteh.ai/catalog/standards/sist/a24a0173-e6e7-4446-ab0a-e9a332911bd9/iso-14535-2001>

Introduction

Room-light operation has become increasingly attractive to users of electronic-scanner output equipment and image-setting devices. This equipment requires accurate cassettes and a good sensitized material/equipment interface, especially where accurate registration is an important feature, e.g. in colour work.

This International Standard is required in order to define the room-light loading packages which must interface with the above equipment.

iTeh STANDARD PREVIEW (standards.iteh.ai)

[ISO 14535:2001](https://standards.iteh.ai/catalog/standards/sist/a24a0173-e6e7-4446-ab0a-e9a332911bd9/iso-14535-2001)

<https://standards.iteh.ai/catalog/standards/sist/a24a0173-e6e7-4446-ab0a-e9a332911bd9/iso-14535-2001>

iTeh STANDARD PREVIEW
(standards.iteh.ai)

ISO 14535:2001

<https://standards.iteh.ai/catalog/standards/sist/a24a0173-e6e7-4446-ab0a-e9a332911bd9/iso-14535-2001>

Photography — Room-light loading packages for electronic scanners and image-setting film and paper rolls — Dimensions and related requirements

1 Scope

This International Standard applies to room-light loading packages either containing photographic film or paper rolls for electronic scanners or image-setting devices. It specifies the dimensions of the package and its contents, critical equipment interfacing features, and package marking. The prime aim of this International Standard is to ensure compatibility between room-light loading packages and the equipment in which it is used.

Two types of package are recognized. One type uses a rigid flange into which mandrils on the exposing device are inserted. The other type uses a flexible flange and relies on the exposing equipment design to hold the roll correctly in the machine.

2 Normative references

The following normative documents contain provisions which, through reference in this text, constitute provisions of this International Standard. For dated references, subsequent amendments to, or revisions of, any of these publications do not apply. However, parties to agreements based on this International Standard are encouraged to investigate the possibility of applying the most recent editions of the normative documents indicated below. For undated references, the latest edition of the normative document referred to applies. Members of ISO and IEC maintain registers of currently valid International Standards.

ISO 554:1976, *Standard atmospheres for conditioning and/or testing — Specifications*.

ISO 3772:2000, *Photography — Rolls of sensitized material for the pre-press industry — Dimensions and related requirements*.

3 Conditions for measurement of dimensions

The dimensions and tolerances specified in this International Standard apply at the time of manufacture, measured under atmospheric conditions of (23 ± 2) °C and (50 ± 5) % relative humidity as specified in ISO 554.

All measuring instrument calibrations should be conducted at a temperature of 20 °C, as specified in ISO 1, and a relative humidity of 50 %.

4 Film and paper dimensions

The dimensions of the film or paper and labelling shall comply with the appropriate requirements of ISO 3772.

5 Winding orientation

The winding configuration of the film or paper shall comply with the appropriate requirements of ISO 3772.

6 Dimensions of flanges

6.1 Rigid flange

The aim and tolerance dimensions of the internal diameter of the flange (A), into which the machine cassette mandrel inserts, currently varies in different countries. The aim and tolerance of $65,5_{-0,5}^0$ mm is preferred due to its tighter tolerance. However, $65,5 \text{ mm} \pm 0,5 \text{ mm}$ is recognized because it is the standard in certain countries and functions well in those locations (see Figure 1).

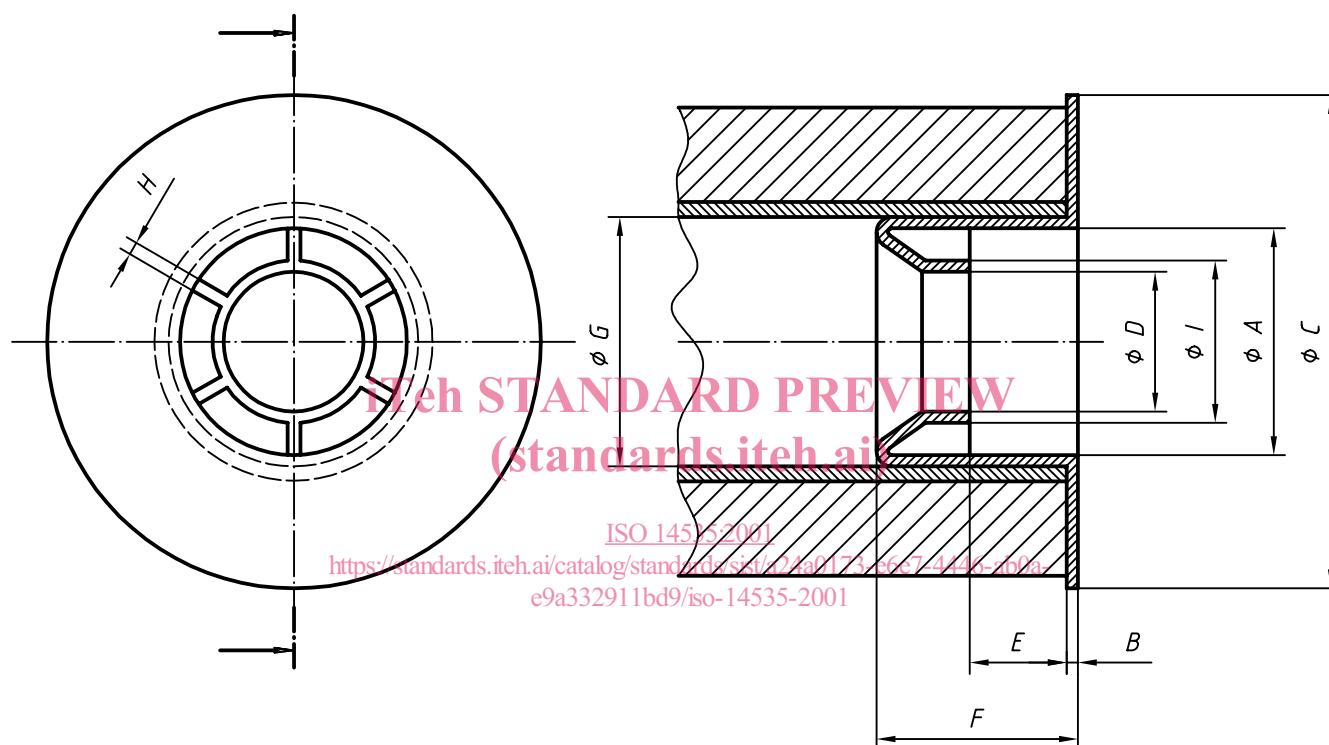

Figure 1 — Rigid flange dimensions

Dimension A applies to the mouth of the flange hole, which may have a slight taper towards the bottom of the hole in order to easily draw a (positive) mould from the plastic flange.

The thickness of the flange rim (B) shall be $3 \text{ mm} \pm 0,3 \text{ mm}$, which contributes to the practical width of the roll.

The external diameter of the rim (C), which contributes to the maximum external dimension of the spooled roll, shall be $130,5_{-4,0}^{+0,5}$ mm such that the dimensions given in clause 7 are not exceeded (see Figure 1).

Dimension D shall be $37 \text{ mm} \pm 0,4 \text{ mm}$.

Dimension E shall be not less than 28,6 mm.

Dimension F shall be $52 \text{ mm} \pm 2 \text{ mm}$.

Rigid flanges should insert fully and securely into the film-roll core such that the flange is flush with the spooled material. Dimension G shall ensure compatibility with the cores specified in ISO 3772. Incorporation of six fins in the flange design is preferred to aid the machine wind and unwind functions.

Dimension H shall be not greater than 3,4 mm.

Dimension I shall be $43 \text{ mm} \pm 0,5 \text{ mm}$

CAUTION — The maximum tolerance for dimension I is critical for proper interchangeability.

6.2 Flexible flange

Flanges are required for each of the preferred core sizes specified in ISO 3772.

The flanges shall be firmly attached to each end of a core which supports the roll of material and shall provide light-tight protection to the roll edges. The flanges shall not impede the winding or the unwinding of the material on the roll.

The internal diameter of the combination of the core plus any portion of the flexible flange shall comply with the minimum dimensions specified in ISO 3772:2000, 5.3.

See Figure 2 for an example of a flexible flange configuration.

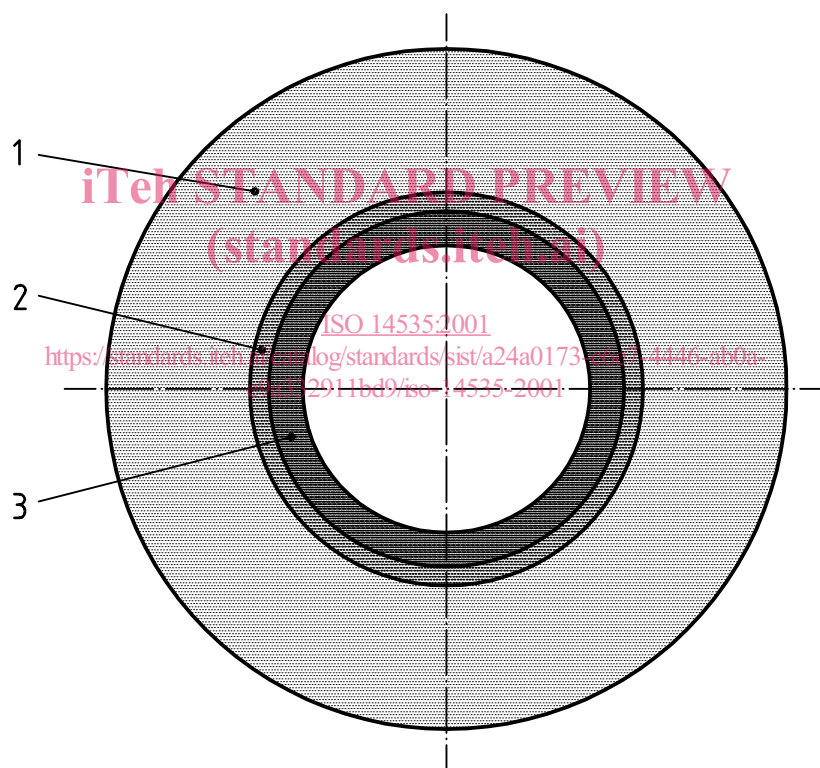

Key

- 1 End flange
- 2 Paper core
- 3 Light-tight seal area of flange

Figure 2 — Example of a flexible flange configuration