



SLOVENSKI STANDARD

SIST EN 15037-2:2009

01-julij-2009

Montažni betonski izdelki - Stropni sistemi iz nosilcev in polnil - 2. del: Polnila

Precast concrete products - Beam-and-block floor systems - Part 2: Concrete blocks

Betonfertigteile - Balkendecken mit Zwischenbauteilen - Teil 2: Zwischenbauteile aus Beton

Produits préfabriqués en béton - Systèmes de planchers à poutrelles et entrevous -
Partie 2: Entrevous en béton (standards.iteh.ai)

Ta slovenski standard je istoveten z: ^{SIST EN 15037-2:2009} EN 15037-2:2009
<https://standards.iteh.ai/catalog/standards/sist/25361906-6660-4fa3-ab7a-d2583358162f/sist-en-15037-2-2009>

ICS:

91.060.30	Stropi. Tla. Stopnice	Ceilings. Floors. Stairs
91.100.30	Beton in betonski izdelki	Concrete and concrete products

SIST EN 15037-2:2009

en

iTeh STANDARD PREVIEW
(standards.iteh.ai)

SIST EN 15037-2:2009

<https://standards.iteh.ai/catalog/standards/sist/233bf906-bbb0-4fa3-ab7a-d2583358162f/sist-en-15037-2-2009>

EUROPEAN STANDARD
NORME EUROPÉENNE
EUROPÄISCHE NORM

EN 15037-2

April 2009

ICS 91.100.30

English Version

Precast concrete products - Beam-and-block floor systems - Part 2: Concrete blocks

Produits préfabriqués en béton - Systèmes de planchers à
poutrelles et entrevous - Partie 2: Entrevous en béton

Betonfertigteile - Balkendecken mit Zwischenbauteilen -
Teil 2: Zwischenbauteile aus Beton

This European Standard was approved by CEN on 25 January 2009.

CEN members are bound to comply with the CEN/CENELEC Internal Regulations which stipulate the conditions for giving this European Standard the status of a national standard without any alteration. Up-to-date lists and bibliographical references concerning such national standards may be obtained on application to the CEN Management Centre or to any CEN member.

This European Standard exists in three official versions (English, French, German). A version in any other language made by translation under the responsibility of a CEN member into its own language and notified to the CEN Management Centre has the same status as the official versions.

CEN members are the national standards bodies of Austria, Belgium, Bulgaria, Cyprus, Czech Republic, Denmark, Estonia, Finland, France, Germany, Greece, Hungary, Iceland, Ireland, Italy, Latvia, Lithuania, Luxembourg, Malta, Netherlands, Norway, Poland, Portugal, Romania, Slovakia, Slovenia, Spain, Sweden, Switzerland and United Kingdom.

[SIST EN 15037-2:2009](https://standards.iteh.ai/catalog/standards/sist/233bf906-bbb0-4fa3-ab7a-d2583358162f/sist-en-15037-2-2009)

<https://standards.iteh.ai/catalog/standards/sist/233bf906-bbb0-4fa3-ab7a-d2583358162f/sist-en-15037-2-2009>



EUROPEAN COMMITTEE FOR STANDARDIZATION
COMITÉ EUROPÉEN DE NORMALISATION
EUROPÄISCHES KOMITEE FÜR NORMUNG

Management Centre: Avenue Marnix 17, B-1000 Brussels

Contents

The numbering of clauses is strictly related to EN 13369:2004 Common rules for precast concrete products, at least for the first three digits. When a clause of EN 13369:2004 is not relevant or included in a more general reference of this standard, its number is omitted and this may result in a gap on numbering.

	Page
Foreword.....	4
Introduction.....	6
1 Scope	7
2 Normative references	7
3 Terms and definitions	7
4 Requirements	10
4.1 Material requirements	10
4.2 Production requirements	11
4.3 Finished product requirements.....	11
4.3.1 Geometrical properties	11
4.3.2 Surface characteristics	13
4.3.3 Mechanical resistance	13
4.3.4 Resistance and reaction to fire	14
4.3.5 Acoustic properties	15
4.3.6 Thermal properties	15
4.3.7 Durability	15
4.3.8 Other requirements.....	15
5 Test methods.....	15
5.1 Measuring of dimensions and surface characteristics	15
5.1.1 Block dimensions	15
5.1.2 Surface characteristics	17
5.2 Mechanical strength	18
5.2.1 Resistance to concentrated loads	18
5.2.2 Bending strength	20
5.2.3 Longitudinal compression test for resisting and semi-resisting concrete blocks.....	21
5.2.4 Transverse testing of resisting and semi-resisting concrete blocks.....	23
5.3 Gross dry density of block	24
5.4 Drying shrinkage of lightweight concrete.....	24
6 Evaluation of conformity.....	24
6.1 General.....	24
6.2 Type testing.....	24
6.3 Factory production control.....	24
7 Marking	25
8 Technical documentation	25
Annex A (normative) Sampling for initial type testing and for independent testing of consignments.....	26
A.1 General.....	26
A.2 Sampling procedure	26
A.2.1 Random sampling.....	26
A.2.2 Representative sampling	26

A.2.3	Dividing the sample.....	27
A.2.4	Number of blocks required per test.....	27
Annex B (normative) Inspection schemes for concrete blocks.....		28
Annex ZA (informative) Clauses of this European Standard addressing the provisions of the EC		
Construction Products Directive		29
ZA.1	Scope and relevant characteristics	29
ZA.2	Procedure for attestation of conformity of concrete blocks for beam-and-block floor systems	31
ZA.2.1	System of attestation of conformity	31
ZA.2.2	EC Certificate and Declaration of conformity.....	31
ZA.3	CE marking and labelling.....	32
ZA.3.1	General	32
ZA.3.2	Simplified label	33
ZA.3.3	Information to be provided with the CE marking	34
Bibliography.....		36

iTeh STANDARD PREVIEW (standards.iteh.ai)

SIST EN 15037-2:2009

<https://standards.iteh.ai/catalog/standards/sist/233bf906-bbb0-4fa3-ab7a-d2583358162f/sist-en-15037-2-2009>

EN 15037-2:2009 (E)**Foreword**

This document (EN 15037-2:2009) has been prepared by Technical Committee CEN/TC 229 "Precast concrete products", the secretariat of which is held by AFNOR. This document was examined by and agreed with a joint working party appointed by the Liaison Group CEN/TC 229 – CEN/TC 250, particularly for its compatibility with structural Eurocodes.

This European Standard shall be given the status of a national standard, either by publication of an identical text or by endorsement, at the latest by October 2009, and conflicting national standards shall be withdrawn at the latest by April 2012.

Attention is drawn to the possibility that some of the elements of this document may be the subject of patent rights. CEN [and/or CENELEC] shall not be held responsible for identifying any or all such patent rights.

This document has been prepared under a mandate given to CEN by the European Commission and the European Free Trade Association, and supports essential requirements of EC Directive(s).

For relationship with EC Directive(s), see informative Annex ZA, which is an integral part of this document.

The European Standard for beam-and-block floor system is made of 5 parts:

- EN 15037-1, *Precast concrete products — Beam-and-block floor systems — Part 1: Beams;*
- EN 15037-2, *Precast concrete products — Beam-and-block floor systems — Part 2: Concrete blocks;*
- EN 15037-3, *Precast concrete products — Beam-and-block floor systems — Part 3: Clay blocks;*
- prEN 15037-4, *Precast concrete products — Beam-and-block floor systems — Part 4: Polystyrene blocks;*
- prEN 15037-5, *Precast concrete products — Beam-and-block floor systems — Part 5: Lightweight blocks.*

This European Standard is one of a series of product standards for precast concrete products.

For common aspects of concrete products, reference is made to EN 13369, from which also the relevant requirements of the EN 206-1 are taken.

The references to EN 13369 by CEN/TC 229 product standards are intended to make them homogeneous and to avoid repetitions of similar requirements.

Eurocodes are taken as a common reference for design aspects. The installation of some structural precast concrete products is dealt with by ENV 13670-1, which has, at the moment, the status of a European prestandard. In all countries it can be accompanied by alternatives for national application and it should not be treated as a European Standard.

The program of standards for structural precast concrete products comprises the following standards, in some cases consisting on several parts:

EN 1168, *Precast concrete products — Hollow core slabs*

EN 12794, *Precast concrete products — Foundation piles*

EN 12843, *Precast concrete products — Masts and poles*

EN 13224, *Precast concrete products — Ribbed floor elements*

EN 13225, *Precast concrete products — Linear structural elements*

EN 13693, *Precast concrete products — Special roof elements*

EN 13747, *Precast concrete products — Floor plates for floor systems*

EN 13978, *Precast concrete products — Precast concrete garages*

EN 14843, *Precast concrete products — Stairs*

EN 14844, *Precast concrete products — Box culverts*

EN 14991, *Precast concrete products — Foundation elements*

EN 14992, *Precast concrete products — Wall elements*

EN 15037-1, *Precast concrete products — Beam-and-block floor systems — Part 1: Beams*

EN 15050, *Precast concrete products — Bridge elements*

EN 15258, *Precast concrete products — Retaining wall elements*

This European Standard defines in Annex ZA the application methods of CE marking to products designed using the relevant EN Eurocodes (EN 1992-1-1:2004 and EN 1992-1-2:2004). Where, in default of applicability conditions of EN Eurocodes to the works of destination, design provisions other than EN Eurocodes are used for mechanical strength and/or fire resistance, the conditions to affix CE marking to the product are described in ZA.3.

According to the CEN/CENELEC Internal Regulations, the national standards organizations of the following countries are bound to implement this European Standard: Austria, Belgium, Bulgaria, Cyprus, Czech Republic, Denmark, Estonia, Finland, France, Germany, Greece, Hungary, Iceland, Ireland, Italy, Latvia, Lithuania, Luxembourg, Malta, Netherlands, Norway, Poland, Portugal, Romania, Slovakia, Slovenia, Spain, Sweden, Switzerland and the United Kingdom.

Introduction

The evaluation of conformity refers to the completed precast elements which are supplied to the market and covers all the production operations carried out in the factory.

For design rules reference is made to EN 1992-1-1:2004. Additional complementary rules are provided where necessary.

iTeh STANDARD PREVIEW (standards.iteh.ai)

SIST EN 15037-2:2009

<https://standards.iteh.ai/catalog/standards/sist/233bf906-bbb0-4fa3-ab7a-d2583358162f/sist-en-15037-2-2009>

1 Scope

This European Standard deals with the requirements and the basic performance criteria for blocks made in normal or lightweight aggregate concrete, used in conjunction with precast concrete beams in compliance with EN 15037-1, with or without cast-in-situ concrete for the construction of beam-and-block floor and roof systems.

Examples of typology of floor and roof systems are given in Annex B of EN 15037-1:2008.

2 Normative references

The following referenced documents are indispensable for the application of this document. For dated references, only the edition cited applies. For undated references, the latest edition of the referenced document (including any amendments) applies.

EN 771-3:2004, *Specification for masonry units — Part 3: Aggregate concrete masonry units (Dense and light-weight aggregates)*

EN 772-13, *Methods of test for masonry units — Part 13: Determination of net and gross dry density of masonry units (except for natural stone)*

EN 772-14, *Methods of test for masonry units — Part 14: Determination of moisture movement of aggregate concrete and manufactured stone masonry units*

EN 1992-1-1:2004, *Eurocode 2: Design of concrete structures — Part 1-1: General rules and rules for buildings*

EN 12390-4:2000, *Testing hardened concrete — Part 4: Compressive strength — Specification for testing machines*

EN 13369:2004, *Common rules for precast concrete products*

EN 15037-1:2008, *Precast concrete products — Beam-and-block floor systems — Part 1: Beams*

3 Terms and definitions

For the purposes of this document, the following terms and definitions apply.

3.1

non-resisting block

block with no mechanical function in the final floor system (designated NR)

NOTE Its only mechanical function is that of formwork during the construction of the floor system. Floor systems built with non-resisting blocks always have a cast-in-situ structural topping.

3.2

semi-resisting block

block participating in the transfer of loads to the beams (designated SR)

NOTE In conjunction with a cast-in-situ concrete, it may contribute to the final strength of the system. However, its top flange alone cannot act as a compression slab in the final floor system.

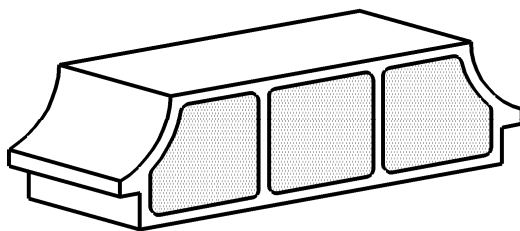

Figure 1 — Example of semi-resisting concrete blocks

3.3 resisting block

block with the same functions as semi-resisting blocks but whose top flange can, under certain conditions, play a role as compression slab in the final floor system (designated RR)

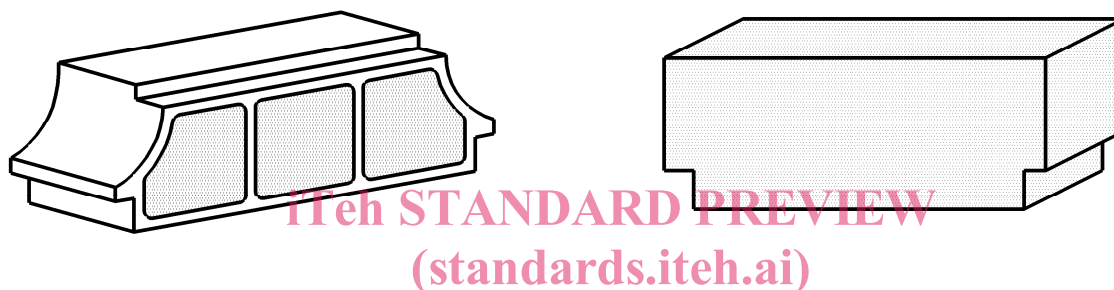

Figure 2 — Examples of resisting concrete blocks

<https://standards.iteh.ai/catalog/standards/sist/233bf906-bbb0-4fa3-ab7a-d2583358162f/sist-en-15037-2-2009>

3.4 nib

shape given to the block so that it will bear on the beam

3.5 longitudinal block

block where the axis of the perforations are parallel to the beam

NOTE An example of a longitudinal block is given in Figure 3.

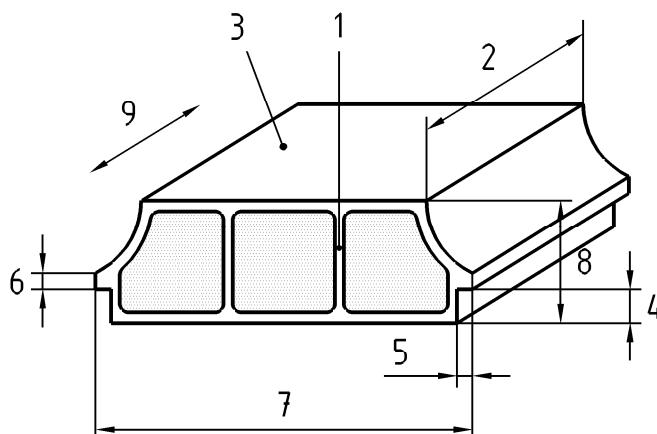

Key

1	web	6	depth of the nib
2	overall length	7	overall width
3	flange (top part of the block)	8	overall height
4	height to nib	9	direction of the beam
5	width of the nib		

Figure 3 — Example of a longitudinal block

iTeh STANDARD PREVIEW
(standards.iteh.ai)

3.6

transverse block

block where the axis of the perforations are perpendicular to the beam

NOTE

An example of a transverse block is given in Figure 4.

SIST EN 15037-2:2009
<https://standards.iteh.ai/catalog/standards/sist/233bf906-bbb0-4fa3-ab7a-d2583358162f/sist-en-15037-2-2009>

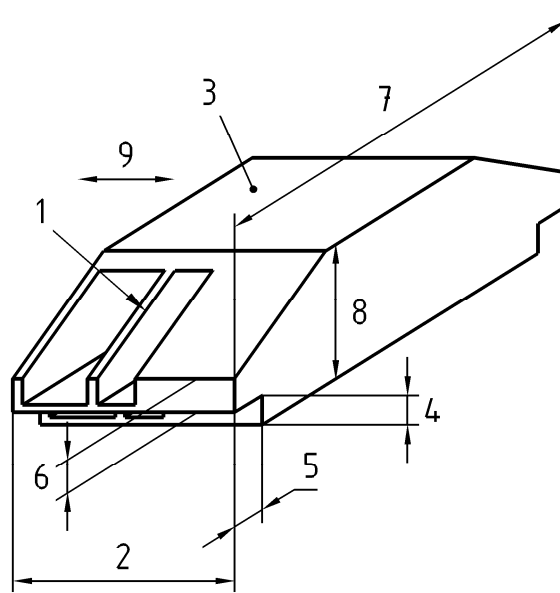
**Key**

- | | | | |
|---|--------------------------------|---|-----------------------|
| 1 | web | 6 | depth of the nib |
| 2 | overall length | 7 | overall width |
| 3 | flange (top part of the block) | 8 | overall height |
| 4 | height to nib | 9 | direction of the beam |
| 5 | width of the nib | | |

iTeh STANDARD PREVIEW
(standards.iteh.ai)

Figure 4 — Example of a transverse block

<https://standards.iteh.ai/catalog/standards/sist/233bf906-bbb0-4fa3-ab7a-d2583358162f/sist-en-15037-2-2009>

3.7**open block**

non-resisting or semi-resisting block without top flange

NOTE An example of an open block is given in Figure 5.

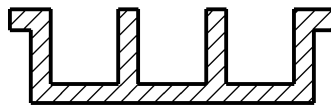

Figure 5 — Example of open block

3.8**gross dry density**

mass per unit gross volume after drying to constant mass

4 Requirements**4.1 Material requirements**

4.1.1 and 4.1.2 of EN 13369:2004 or 4.1 of EN 771-3:2004 shall apply.