INTERNATIONAL STANDARD



4086

INTERNATIONAL ORGANIZATION FOR STANDARDIZATION • МЕЖДУНАРОДНАЯ ОРГАНИЗАЦИЯ ПО СТАНДАРТИЗАЦИИ • ORGANISATION INTERNATIONALE DE NORMALISATION

**Road vehicles — 90 Semi-trailer fifth wheel coupling pin —
Dimensions**

Véhicules routiers — Pivot d'attelage de 90 pour semi-remorque — Dimensions

First edition — 1977-09-15

UDC 629.1.013.5

Ref. No. ISO 4086-1977 (E)

Descriptors : road vehicles, semi-trailers, kingpins, dimensions.

Price based on 1 page

FOREWORD

ISO (the International Organization for Standardization) is a worldwide federation of national standards institutes (ISO member bodies). The work of developing International Standards is carried out through ISO technical committees. Every member body interested in a subject for which a technical committee has been set up has the right to be represented on that committee. International organizations, governmental and non-governmental, in liaison with ISO, also take part in the work.

Draft International Standards adopted by the technical committees are circulated to the member bodies for approval before their acceptance as International Standards by the ISO Council.

International Standard ISO 4086 was developed by Technical Committee ISO/TC 22, *Road vehicles*, and was circulated to the member bodies in September 1976.

It has been approved by the member bodies of the following countries :

Austria	Iran	Romania
Belgium	Italy	South Africa, Rep. of
Brazil	Japan	Spain
Chile	Korea, Rep. of	Sweden
Czechoslovakia	Mexico	United Kingdom
France	Netherlands	U.S.S.R.
Germany	New Zealand	Yugoslavia
Hungary	Philippines	
India	Poland	

The member bodies of the following countries expressed disapproval of the document on technical grounds :

Australia
Switzerland
U.S.A.

Road vehicles – 90 Semi-trailer fifth wheel coupling pin – Dimensions

1 SCOPE AND FIELD OF APPLICATION

This International Standard specifies the dimensions of the 90 [ϕ 89 mm (3.5 in)] fifth wheel coupling pin which is used for coupling extra-heavy-duty vehicles exceeding the limitations of weight generally laid down by official requirements.

NOTE – The 50 semi-trailer fifth wheel coupling pin is the subject of ISO 337.

2 DIMENSIONS

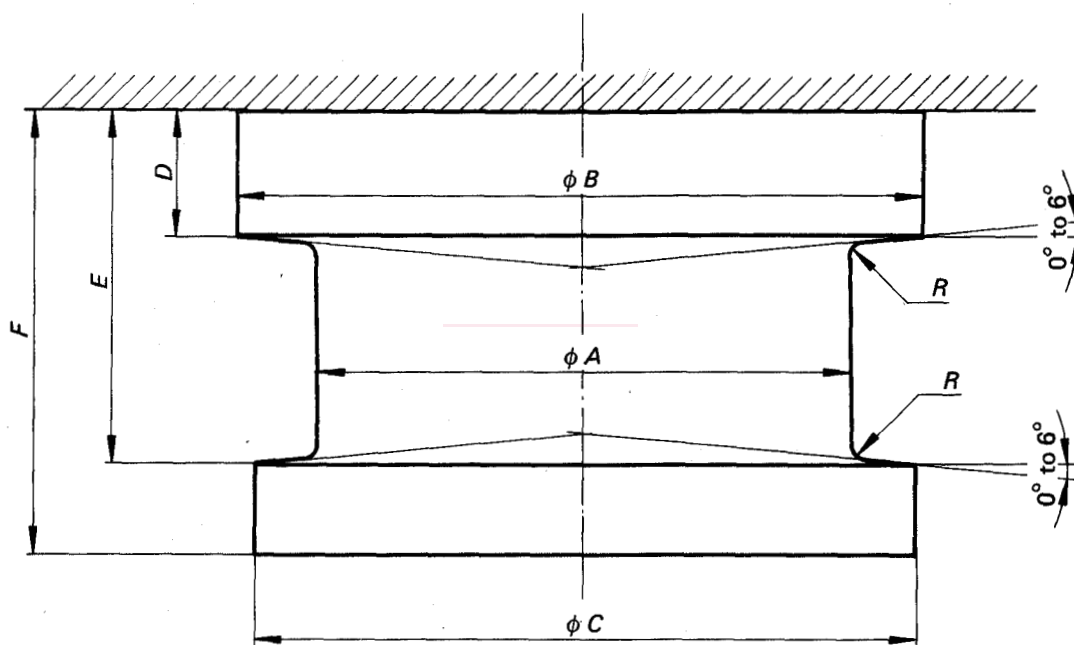

Dimension	mm
A	$89 \pm 0,1$
B	$114 \pm 0,1$
C	$111 \pm 0,4$
D	$21 \begin{smallmatrix} 0 \\ -3 \end{smallmatrix}$
E	$59 \begin{smallmatrix} +1,5 \\ 0 \end{smallmatrix}$
F	$74 \begin{smallmatrix} 0 \\ -2 \end{smallmatrix}$
R	$3 \begin{smallmatrix} +0,5 \\ 0 \end{smallmatrix}$