

INTERNATIONAL
STANDARD

ISO
3338-2

Fourth edition
1996-12-15

Cylindrical shanks for milling cutters —

Part 2:

Dimensional characteristics of flatted
cylindrical shanks

iTeh STANDARD PREVIEW
(standards.iteh.ai)

ISO 3338-2:1996

<https://standards.iteh.ai/catalog/standards/sist/4977-add8-78d6d5e2645c/iso-3338-2-1996>

*Partie 2: Caractéristiques dimensionnelles des queues cylindriques
à méplat*



Reference number
ISO 3338-2:1996(E)

Foreword

ISO (the International Organization for Standardization) is a worldwide federation of national standards bodies (ISO member bodies). The work of preparing International Standards is normally carried out through ISO technical committees. Each member body interested in a subject for which a technical committee has been established has the right to be represented on that committee. International organizations, governmental and non-governmental, in liaison with ISO, also take part in the work. ISO collaborates closely with the International Electrotechnical Commission (IEC) on all matters of electrotechnical standardization.

Draft International Standards adopted by the technical committees are circulated to the member bodies for voting. Publication as an International Standard requires approval by at least 75 % of the member bodies casting a vote.

International Standard ISO 3338-2 was prepared by Technical Committee ISO/TC 29, *Small tools*, Subcommittee SC 2, *Drills, reamers, milling cutters and milling machine accessories*.

This fourth edition cancels and replaces the third edition (ISO 3338-2:1985), which has undergone minor revision.

ISO 3338 consists of the following parts, under the general title *Cylindrical shanks for milling cutters*:

- Part 1: *Dimensional characteristics of plain cylindrical shanks*
- Part 2: *Dimensional characteristics of flatted cylindrical shanks*
- Part 3: *Dimensional characteristics of threaded shanks*

© ISO 1996

All rights reserved. Unless otherwise specified, no part of this publication may be reproduced or utilized in any form or by any means, electronic or mechanical, including photocopying and microfilm, without permission in writing from the publisher.

International Organization for Standardization
Case Postale 56 • CH-1211 Genève 20 • Switzerland

Printed in Switzerland

Cylindrical shanks for milling cutters —

Part 2:

Dimensional characteristics of flatted cylindrical shanks

1 Scope

This part of ISO 3338 specifies the dimensions of flatted cylindrical shanks for milling cutters (of diameters 6 mm to 20 mm for single-flatted shanks and diameters 25 mm to 63 mm for double-flatted shanks). In the case of single-flatted shanks, it is applicable to both single-ended cutters and double-ended cutters, as double-flatted shanks cannot admit single-ended cutters.

The dimensions of plain cylindrical shanks and of threaded shanks are given in ISO 3338-1 and ISO 3338-3 respectively.

The two shank types covered by ISO 3338-1 and this part of ISO 3338 have the same dimensional characteristics (diameters and lengths) but different tolerances on diameters, namely:

- h8 for plain cylindrical shanks, commonly used for tools mounted in collets;
- h6 for flatted cylindrical shanks intended to be mounted in chucks and secured with a clamping screw, and requiring an accuracy adjustment.

2 Dimensions

2.1 Flatted cylindrical shanks with single flat for diameters d_1 of 6 mm to 20 mm

See figure 1 and table 1.

2.2 Flatted cylindrical shanks with double flat for diameters d_1 of 25 mm to 63 mm

See figure 2 and table 1.

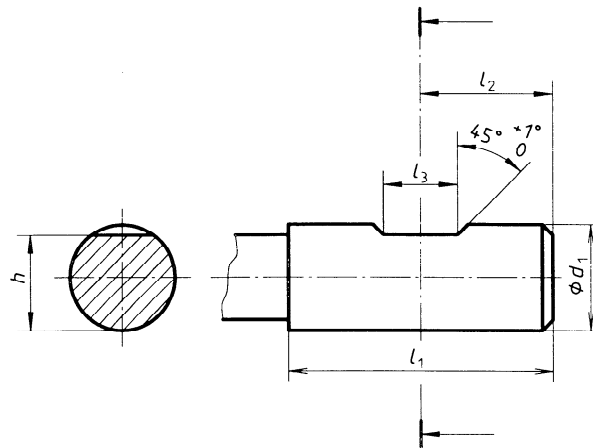

Figure 1

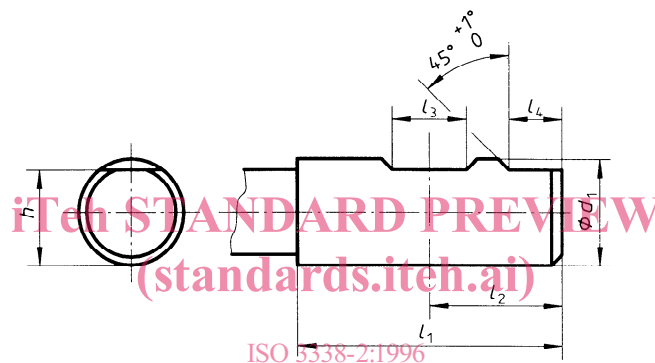

Figure 2

ISO 3338-2:1996
<https://standards.iteh.ai/catalog/standards/sist/1c962a25-e4cc-4077-add8-78d6d5e2645c/iso-3338-2-1996>

Table 1

Dimensions in millimetres

d_1	l_1	l_2	l_3	l_4	h
h6	+2 0	0 -1	+0,05 0	+1 0	0 -0,4
6 ¹⁾	36	18	4,2	—	4,8
8			5,5		6,6
10	40	20	7		8,4
12 ¹⁾	45	22,5	8		10,4
16	48	24	10		14,2
20	50	25	11		18,2
25	56	32	12	17	23
32 ¹⁾	60	36			30
40	70	40			38
50	80	45	18	23	47,8
63	90	50			60,8

1) Not in conformity with ISO 237:1975, *Rotating tools with parallel shanks — Diameters of shanks and sizes of driving squares.*

iTeh STANDARD PREVIEW
This page intentionally left blank
(standards.iteh.ai)

ISO 3338-2:1996

<https://standards.iteh.ai/catalog/standards/sist/1c962a25-e4cc-4077-add8-78d6d5e2645c/iso-3338-2-1996>

iTeh STANDARD PREVIEW
This page intentionally left blank
(standards.iteh.ai)

ISO 3338-2:1996

<https://standards.iteh.ai/catalog/standards/sist/1c962a25-e4cc-4077-add8-78d6d5e2645c/iso-3338-2-1996>

iTeh STANDARD PREVIEW
This page intentionally left blank
(standards.iteh.ai)

ISO 3338-2:1996

<https://standards.iteh.ai/catalog/standards/sist/1c962a25-e4cc-4077-add8-78d6d5e2645c/iso-3338-2-1996>

iTeh STANDARD PREVIEW
(standards.iteh.ai)

ISO 3338-2:1996

<https://standards.iteh.ai/catalog/standards/sist/1c962a25-e4cc-4077-add8-78d6d5e2645c/iso-3338-2-1996>

ICS 25.100.20

Descriptors: tools, cutting tools, milling cutters, shanks, parallel shanks, form specifications, dimensions.

Price based on 2 pages
