Tool holders with cylindrical shank —

Part 2:

Type A, shanks for tool holders of special designs

Porte-outil à queue cylindrique —
Partie 2: Porte-outil de type A de conceptions spéciales
(standards.iteh.ai)

ISO 10889-2:1997

<https://standards.iteh.ai/catalog/standards/sist/af0a8f3d-f537-49b0-a601-6d109bfbfc9/iso-10889-2-1997>



Small tools.

ISO 10889 consists of the following parts, under the general title *Tool holders with cylindrical shank*:

- *Part 1: Cylindrical shank, location bore — Technical delivery conditions*
- *Part 2: Type A, shanks for tool holders of special designs*
- *Part 3: Type B with rectangular radial seat*
- *Part 4: Type C with rectangular axial seat*
- *Part 5: Type D with more than one rectangular seat*
- *Part 6: Type E with cylindrical seat*
- *Part 7: Type F with taper seat*
- *Part 8: Type Z, accessories*

© ISO 1997

All rights reserved. Unless otherwise specified, no part of this publication may be reproduced or utilized in any form or by any means, electronic or mechanical, including photocopying and microfilm, without permission in writing from the publisher.

International Organization for Standardization
Case postale 56 • CH-1211 Genève 20 • Switzerland
Internet central@iso.ch
X.400 c=ch; a=400net; p=iso; o=isocs; s=central

Printed in Switzerland

ISO (the International Organization for Standardization) is a worldwide federation of national standards bodies (ISO member bodies). The work of preparing International Standards is normally carried out through ISO technical committees. Each member body interested in a subject for which a technical committee has been established has the right to be represented on that committee. International

Tool holders with cylindrical shank —

Part 2:

Type A, shanks for tool holders of special designs

1 Scope

ISO 10889 applies to tool holders with cylindrical shank for machine tools with non-rotating tools, preferably for turning machines.

This part of ISO 10889 specifies dimensions, designations and complementary technical delivery conditions for tool holders of type A with cylindrical shank in accordance with ISO 10889-1 for tool holders of special designs.

iTeh STANDARD PREVIEW

2 Normative references [\(standards.iteh.ai\)](https://standards.iteh.ai)

The following standards contain provisions which, through reference in this text, constitute provisions of this part of ISO 10889. At the time of publication, the editions indicated were valid. All standards are subject to revision, and parties to agreements based on this part of ISO 10889 are encouraged to investigate the possibility of applying the most recent editions of the standards indicated below. Members of IEC and ISO maintain registers of currently valid International Standards.

ISO 2768-1:1989, *General tolerances — Part 1: Tolerances for linear and angular dimensions without individual tolerance indications.*

ISO 10889-1:1997, *Tool holders with cylindrical shank — Part 1: Cylindrical shank, location bore — Technical delivery conditions.*

3 Dimensions

See figures 1 and 2 and table 1.

Unspecified details shall be chosen appropriately.

General tolerances: ISO 2768-1 - mB

Surface roughness in micrometres

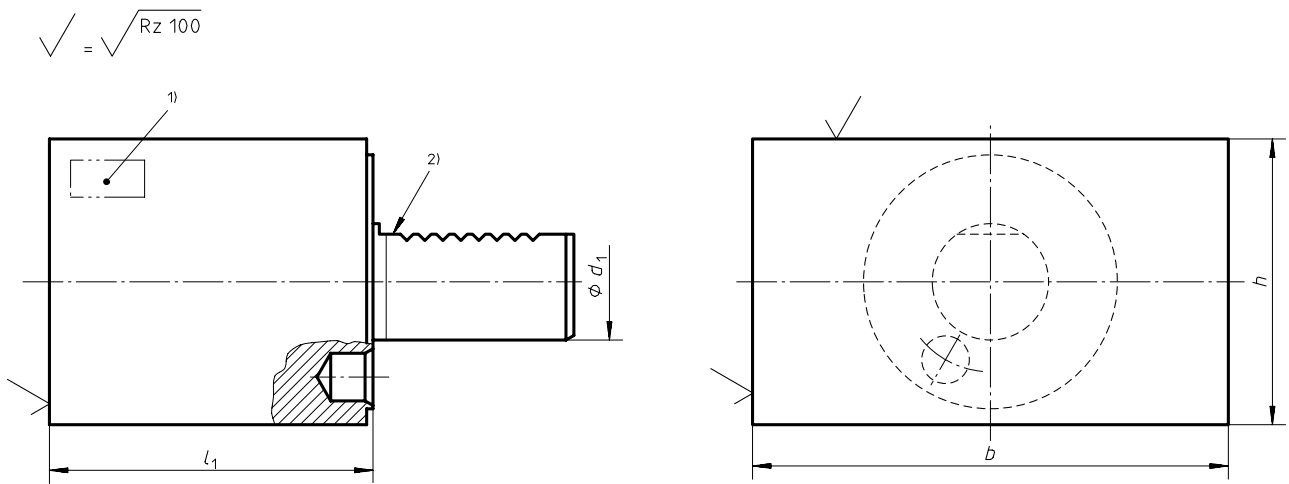

- 1) Field of marking
- 2) Cylindrical shank in accordance with ISO 10889-1

Figure 1 — Type A1 tool holder, rectangular

iTeh STANDARD PREVIEW
(standards.iteh.ai)

Dimensions in millimetres,
surface roughness in micrometres

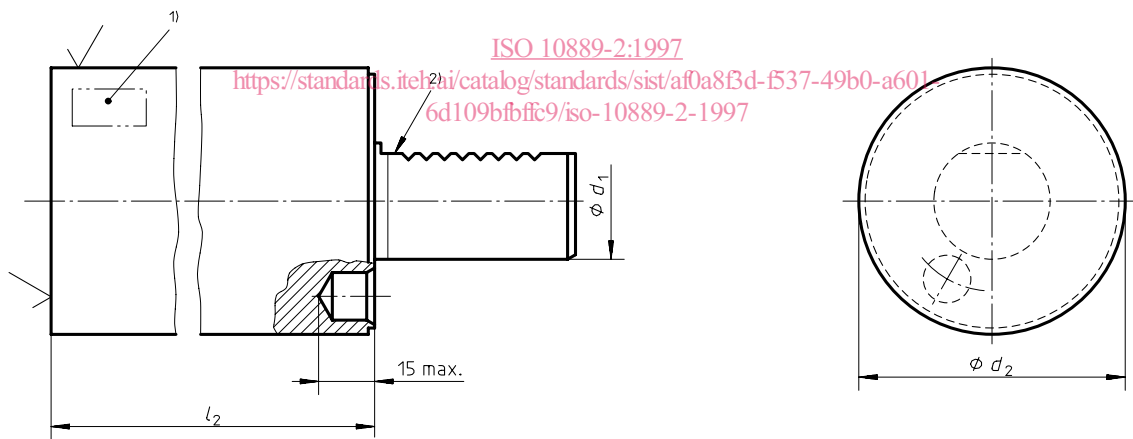

- 1) Field of marking
- 2) Cylindrical shank in accordance with ISO 10889-1

Figure 2 — Type A2 tool holder, round

Table 1

Dimensions in millimetres

d_1	l_1	l_2	d_2	b	h
16	44	60	40	78	44
20	65	70	50	100	60
25	75	80	58	100	60
		200			
30	85	100	58	130	76
		240			
40	100	120	83	151	96
		320			
50	125	135	98	160	120
		400			
60	160	150	123	165	125
		480			
80	200	500	158	220	160

iTeh STANDARD PREVIEW (standards.iteh.ai)

4 Designation

A tool holder in accordance with this part of ISO 10889 shall be designated by

- a) "Tool holder";
- b) reference to this part of ISO 10889, i.e. <https://standards.iteh.ai/catalog/standards/sist/af0a8f3d-f537-49b0-a601-6d109b1bc9/iso-10889-2-1997> ISO 10889-2:1997;
- c) type (A1 or A2);
- d) nominal diameter, d_1 , in millimetres;
- e) nominal length, l_1 or l_2 , in millimetres.

EXAMPLES

A tool holder of type A1, with a nominal diameter $d_1 = 40$ mm and a nominal length $l_1 = 100$ mm is designated as follows:

Tool holder ISO 10889-2 - A1 - 40 × 100

A tool holder of type A2, with a nominal diameter $d_1 = 40$ mm and a nominal length $l_2 = 320$ mm is designated as follows:

Tool holder ISO 10889-2 - A2 - 40 × 320

5 Technical delivery conditions

As a complement to the requirements of ISO 10889-1, the material shall be indicated in the field of marking.

iTeh STANDARD PREVIEW
(standards.iteh.ai)

ISO 10889-2:1997

<https://standards.iteh.ai/catalog/standards/sist/af0a8f3d-f537-49b0-a601-6d109bfbfc9/iso-10889-2-1997>

ICS 25.060.20

Descriptors: tools, tool holders, shanks, parallel shanks, form specifications, dimensions, delivery condition, designation.

Price based on 3 pages
