



# SLOVENSKI STANDARD

## SIST EN 4620:2010

01-maj-2010

---

### Aeronavtika - Vložki, navoj MJ, samozapiralni, s samozagzdnim ključem - Standard za projektiranje

Aerospace series - Inserts, MJ threads, self-locking, with self-broaching keys - Design standard

Luft- und Raumfahrt - Gewindeeinsätze, MJ-Gewinden, selbstsichernd, mit selbsträumenden Stiften - Konstruktionsnorm

Série aérospatiale - Douilles filetées, à filetage MJ, à freinage interne, à clavettes auto-brochantes - Norme de conception

[SIST EN 4620:2010](https://standards.iteh.ai/catalog/standards/sist/07f77cc4-7fa5-4c75-8b40-f0cac125a01a/sist-en-4620-2010)

[https://standards.iteh.ai/catalog/standards/sist/07f77cc4-7fa5-4c75-8b40-](https://standards.iteh.ai/catalog/standards/sist/07f77cc4-7fa5-4c75-8b40-f0cac125a01a/sist-en-4620-2010)

[f0cac125a01a/sist-en-4620-2010](https://standards.iteh.ai/catalog/standards/sist/07f77cc4-7fa5-4c75-8b40-f0cac125a01a/sist-en-4620-2010)

**Ta slovenski standard je istoveten z: EN 4620:2010**

---

#### **ICS:**

49.030.30      Matice      Nuts

**SIST EN 4620:2010**      en

**iTeh STANDARD PREVIEW**  
**(standards.iteh.ai)**

SIST EN 4620:2010

<https://standards.iteh.ai/catalog/standards/sist/07f77cc4-7fa5-4c75-8b40-f0cac125a01a/sist-en-4620-2010>

EUROPEAN STANDARD

**EN 4620**

NORME EUROPÉENNE

EUROPÄISCHE NORM

March 2010

ICS 49.030.30

English Version

**Aerospace series - Inserts, MJ threads, self-locking, with self-broaching keys - Design standard**

Série aérospatiale - Douilles filetées, à filetage MJ, à freinage interne, à clavettes auto-brochantes - Norme de conception

Luft- und Raumfahrt - Gewindeeinsätze, MJ-Gewinden, selbstsichernd, mit selbststräumenden Stiften - Konstruktionsnorm

This European Standard was approved by CEN on 9 January 2010.

CEN members are bound to comply with the CEN/CENELEC Internal Regulations which stipulate the conditions for giving this European Standard the status of a national standard without any alteration. Up-to-date lists and bibliographical references concerning such national standards may be obtained on application to the CEN Management Centre or to any CEN member.

This European Standard exists in three official versions (English, French, German). A version in any other language made by translation under the responsibility of a CEN member into its own language and notified to the CEN Management Centre has the same status as the official versions.

CEN members are the national standards bodies of Austria, Belgium, Bulgaria, Croatia, Cyprus, Czech Republic, Denmark, Estonia, Finland, France, Germany, Greece, Hungary, Iceland, Ireland, Italy, Latvia, Lithuania, Luxembourg, Malta, Netherlands, Norway, Poland, Portugal, Romania, Slovakia, Slovenia, Spain, Sweden, Switzerland and United Kingdom.

[SIST EN 4620:2010](https://standards.iteh.ai/catalog/standards/sist/07f77cc4-7fa5-4c75-8b40-f0cac125a01a/sist-en-4620-2010)

<https://standards.iteh.ai/catalog/standards/sist/07f77cc4-7fa5-4c75-8b40-f0cac125a01a/sist-en-4620-2010>



EUROPEAN COMMITTEE FOR STANDARDIZATION  
COMITÉ EUROPÉEN DE NORMALISATION  
EUROPÄISCHES KOMITEE FÜR NORMUNG

Management Centre: Avenue Marnix 17, B-1000 Brussels

## Contents

Page

Foreword.....	3
1 Scope .....	4
2 Normative references .....	4
3 Design .....	4
4 Use .....	5
4.1 General.....	5
4.2 Performance .....	5
4.3 Installation restrictions .....	6
5 Required characteristics – Installation hole .....	7
6 Installation .....	9
7 Provisions for component salvage .....	9
8 Designation .....	9
9 Indication on drawings.....	9
9.1 Methods of drawing.....	9
9.2 Examples of definition drawing.....	10
9.3 Example of assembly drawing .....	11

SIST EN 4620:2010

<https://standards.iteh.ai/catalog/standards/sist/07f77cc4-7fa5-4c75-8b40-f0cac125a01a/sist-en-4620-2010>

## Foreword

This document (EN 4620:2010) has been prepared by the Aerospace and Defence Industries Association of Europe - Standardization (ASD-STAN).

After enquiries and votes carried out in accordance with the rules of this Association, this Standard has received the approval of the National Associations and the Official Services of the member countries of ASD, prior to its presentation to CEN.

This European Standard shall be given the status of a national standard, either by publication of an identical text or by endorsement, at the latest by September 2010, and conflicting national standards shall be withdrawn at the latest by September 2010.

Attention is drawn to the possibility that some of the elements of this document may be the subject of patent rights. CEN [and/or CENELEC] shall not be held responsible for identifying any or all such patent rights.

According to the CEN/CENELEC Internal Regulations, the national standards organizations of the following countries are bound to implement this European Standard: Austria, Belgium, Bulgaria, Croatia, Cyprus, Czech Republic, Denmark, Estonia, Finland, France, Germany, Greece, Hungary, Iceland, Ireland, Italy, Latvia, Lithuania, Luxembourg, Malta, Netherlands, Norway, Poland, Portugal, Romania, Slovakia, Slovenia, Spain, Sweden, Switzerland and the United Kingdom.

**ITEH STANDARD PREVIEW**  
**(standards.iteh.ai)**

SIST EN 4620:2010

<https://standards.iteh.ai/catalog/standards/sist/07f77cc4-7fa5-4c75-8b40-f0cac125a01a/sist-en-4620-2010>

**EN 4620:2010 (E)****1 Scope**

This standard specifies the applications and installation hole dimensions for EN standard, self-locking, self-broaching key, MJ thread inserts and provisions for component salvage, for aerospace applications.

**2 Normative references**

The following referenced documents are indispensable for the application of this document. For dated references, only the edition cited applies. For undated references, the latest edition of the referenced document (including any amendments) applies.

EN 4619, *Aerospace series — Inserts, MJ threads, self-locking, with self-broaching keys — Installation and removal procedure*

EN 4621, *Aerospace series — Inserts, MJ threads, self-locking, self-broaching keys — Technical specification*

ISO 5855-1, *Aerospace — MJ threads — Part 1: General requirements*

ISO 5855-2, *Aerospace — MJ threads — Part 2: Limit dimensions for bolts and nuts*

**3 Design**

NOTE Typical examples of installed inserts are shown in Figures 1 and 2.

**3.1** The threaded self-locking inserts may be used in tapped blind holes and tapped through holes. The minimum flange thickness dimensions  $K$  given in Tables 3 to 5 are less than the insert length. When using these minimum flange thicknesses, protrusion of the inserts will occur (see Figure 5, footnote <sup>a</sup>). Designers shall therefore ensure that the inserts do not protrude into an abutment face or foul any other adjacent features.

**3.2** The installed insert is compatible with MJ threaded bolts to ISO 5855-2.

**3.3** The minimum selected bolt length shall ensure full thread engagement with the insert (see Figures 1 and 2).

**3.4** These screw thread inserts may be used in aluminium alloys and in harder materials, such as heat resistant steels and titanium alloys.

**3.5** During the design of the fitted flange, overall dimensions of the tools shall be taken into account as specified in EN 4619.

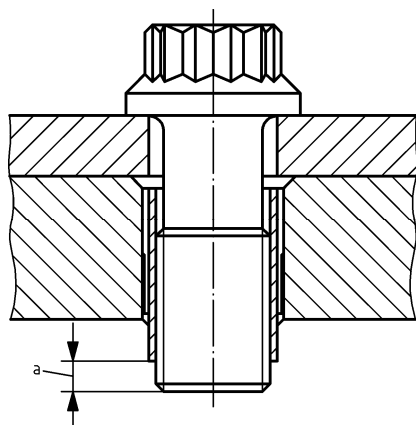
**Key**

a 1,5 pitches minimum

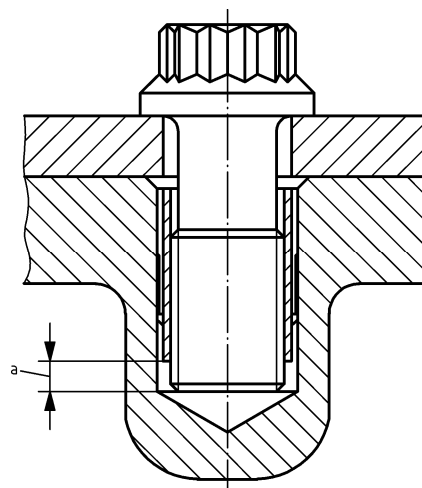
**Figure 1****Key**

a 1,5 pitches minimum

**Figure 2****4 Use****4.1 General**

A self-locking, self-broaching key insert as shown in Figure 3 is a sleeve of metal, which is threaded both, internally and externally, with two or more self-broaching keys.

These inserts are screwed into tapped holes (see 5.1) and are fixed by broaching the keys into the thread of the component (see Figures 1 and 2) thus preventing the insert moving during the installation or removal of a bolt.

The self-locking zone of these inserts is positioned at the opposite side from the key side.

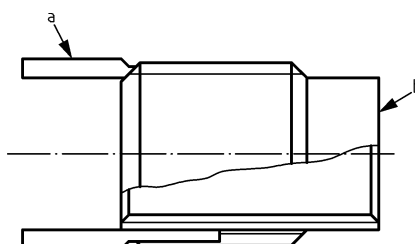
**Key**

- a Keys to be broached into the thread of the parent component
- b Formed out-of-round to achieve self-locking feature

**Figure 3****4.2 Performance**

The inserts according to EN 4621 have a minimum performance of 25 re-uses at ambient temperature and five re-uses after baking at the maximum operating temperature given on the product standard.

The self-locking torque values for the inserts are given in Table 1. These are the values required to achieve the minimum re-usability performance at ambient temperature in accordance with the technical specification of the inserts.

Table 1

Bolt thread diameter	Self-locking torque	
	Nm	
	min.	max.
MJ5×0,8	0,25	2
MJ6×1	0,35	3,2
MJ7×1	0,5	4,6
MJ8×1	0,65	6
MJ10×1,25	1,2	9,5

### 4.3 Installation restrictions

In applications where it is necessary to pass items through the installed insert, care shall be taken to ensure that such items do not foul the locking feature of the insert. The maximum diameter  $X$  that can be passed through the insert is illustrated in Figure 4 and dimensions are given in Table 2.

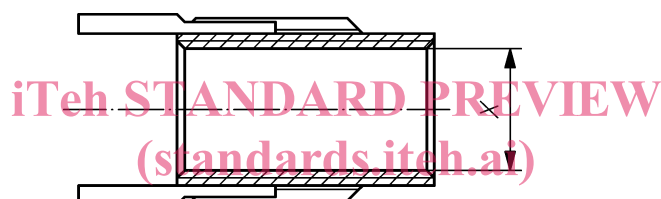

SIST EN 4620:2010

Figure 4

<https://standards.itih.ai/catalog/standards/sist/07f77cc4-7fa5-4c75-8b40-f0cac125a01a/sist-en-4620-2010>

Table 2

Dimensions in millimetres

Bolt thread diameter	Diameter
	$X$ max.
MJ5×0,8	3,2
MJ6×1	3,7
MJ7×1	4,5
MJ8×1	5,3
MJ10×1,25	6,7



## 5 Required characteristics – Installation hole

See Figure 5 and Tables 3 to 6.

Dimensions in millimetres

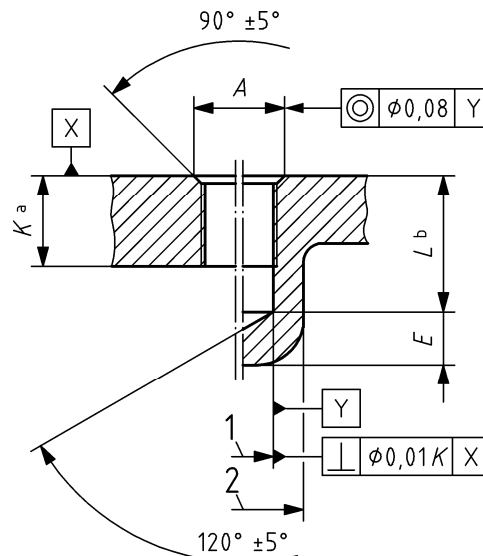

iTeh STANDARD PREVIEW  
(standards.iteh.ai)

### Key

- 1 Pitch diameter
- 2 Boss diameter

<sup>a</sup>  $K$  allows total installation of the threaded part of the insert with 0.75 mm under-flush max. The locking feature of the insert may protrude.

<sup>b</sup>  $L$  min.  $\geq K + 5$  pitches. Allows automatic tapping.

Figure 5

Table 3 — Codified dimensions of holes for normal size inserts

Dimensions in millimetres

Diameter code	Bolt thread diameter <sup>a, b</sup>	Installation hole diameter <sup>a</sup>	$A$ +0,2 0	$K$ min.	$L$ min.
050-0	MJ5×0,8	MJ9×1-4H5H	10	7,5	14
060-0	MJ6×1	MJ10×1-4H5H	11	9	16,5
070-0	MJ7×1	MJ11×1-4H5H	12	10,5	18
080-0	MJ8×1	MJ12×1-4H5H	13	12	20
100-0	MJ10×1,25	MJ14×1-4H5H	15	14,5	23

<sup>a</sup> According to ISO 5855-1.  
<sup>b</sup> According to ISO 5855-2.