**Assembly tools for screws and nuts —
Screwdrivers for slotted-head screws —**

**Part 1:
Tips for hand- and machine-operated
screwdrivers**

iTeh STANDARD PREVIEW

Outils de manœuvre pour vis et écrous — Tournevis pour vis à tête fendue —
(standards.iteh.ai)

Partie 1: Extrémités de tournevis à main et à machine

ISO 2380-1:2004

<https://standards.iteh.ai/catalog/standards/sist/aaa2f0ca-e683-4254-9822-dfabd4eb2a9d/iso-2380-1-2004>



PDF disclaimer

This PDF file may contain embedded typefaces. In accordance with Adobe's licensing policy, this file may be printed or viewed but shall not be edited unless the typefaces which are embedded are licensed to and installed on the computer performing the editing. In downloading this file, parties accept therein the responsibility of not infringing Adobe's licensing policy. The ISO Central Secretariat accepts no liability in this area.

Adobe is a trademark of Adobe Systems Incorporated.

Details of the software products used to create this PDF file can be found in the General Info relative to the file; the PDF-creation parameters were optimized for printing. Every care has been taken to ensure that the file is suitable for use by ISO member bodies. In the unlikely event that a problem relating to it is found, please inform the Central Secretariat at the address given below.

iTeh STANDARD PREVIEW
(standards.iteh.ai)

ISO 2380-1:2004

<https://standards.iteh.ai/catalog/standards/sist/aaa2f0ca-e683-4254-9822-dfabd4eb2a9d/iso-2380-1-2004>

© ISO 2004

All rights reserved. Unless otherwise specified, no part of this publication may be reproduced or utilized in any form or by any means, electronic or mechanical, including photocopying and microfilm, without permission in writing from either ISO at the address below or ISO's member body in the country of the requester.

ISO copyright office
Case postale 56 • CH-1211 Geneva 20
Tel. + 41 22 749 01 11
Fax + 41 22 749 09 47
E-mail copyright@iso.org
Web www.iso.org

Published in Switzerland

Foreword

ISO (the International Organization for Standardization) is a worldwide federation of national standards bodies (ISO member bodies). The work of preparing International Standards is normally carried out through ISO technical committees. Each member body interested in a subject for which a technical committee has been established has the right to be represented on that committee. International organizations, governmental and non-governmental, in liaison with ISO, also take part in the work. ISO collaborates closely with the International Electrotechnical Commission (IEC) on all matters of electrotechnical standardization.

International Standards are drafted in accordance with the rules given in the ISO/IEC Directives, Part 2.

The main task of technical committees is to prepare International Standards. Draft International Standards adopted by the technical committees are circulated to the member bodies for voting. Publication as an International Standard requires approval by at least 75 % of the member bodies casting a vote.

Attention is drawn to the possibility that some of the elements of this document may be the subject of patent rights. ISO shall not be held responsible for identifying any or all such patent rights.

ISO 2380-1 was prepared by Technical Committee ISO/TC 29, *Small tools*, Subcommittee SC 10, *Assembly tools for screws and nuts, pliers and nippers*.

This third edition cancels and replaces the second edition (ISO 2380-1:1997), which has been technically revised.

ISO 2380 consists of the following parts, under the general title *Assembly tools for screws and nuts — Screwdrivers for slotted-head screws*:

- *Part 1: Tips for hand- and machine-operated screwdrivers*
- *Part 2: General requirements, lengths of blades and marking of hand-operated screwdrivers*

iTeh STANDARD PREVIEW
(standards.iteh.ai)

ISO 2380-1:2004

<https://standards.iteh.ai/catalog/standards/sist/aaa2f0ca-e683-4254-9822-dfabd4eb2a9d/iso-2380-1-2004>

Assembly tools for screws and nuts — Screwdrivers for slotted-head screws —

Part 1: Tips for hand- and machine-operated screwdrivers

1 Scope

This part of ISO 2380 specifies the shape/form, dimensions and designation of the tips of hand- and machine-operated screwdrivers for slotted-head screws. It also gives the technical specifications and test conditions for the screw-drivers and, in the case of hand-operated screwdrivers, specifies the test torque which the blade-to-handle connection shall withstand.

2 Normative references

The following referenced documents are indispensable for the application of this document. For dated references, only the edition cited applies. For undated references, the latest edition of the referenced document (including any amendments) applies.

ISO 2380-2:2004, *Assembly tools for screws and nuts — Screwdrivers for slotted-head screws — Part 2: General requirements, lengths of blades and marking of hand-operated screwdrivers*

3 Shape and dimensions of the tips

3.1 Shape

The shape of screwdriver tips is left to the choice of the manufacturer.

3.2 Dimensions

Only the dimensions shown in Figures 1 and 2 and specified in Tables 1 and 2 shall be observed.

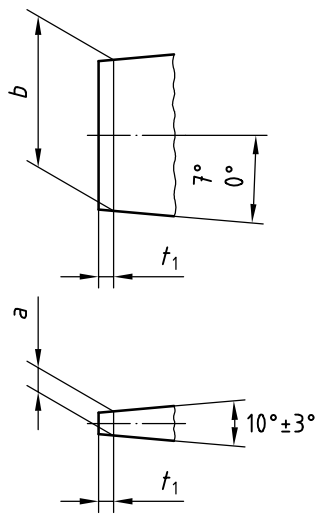

Figure 1 — Form A, for hand-operated screwdrivers only

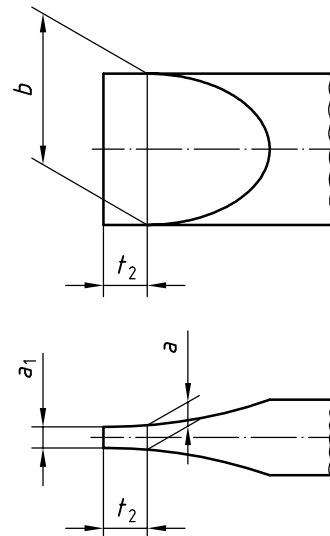

Figure 2 — Form B for hand-operated screwdrivers and form C for machine-operated screwdrivers

Table 1 — Hand-operated screwdriver tips, forms A and B

STANDARD PREVIEW
(standards.iteh.ai)

Dimensions in millimetres

Nominal thickness <i>a</i>	Nominal width <i>b</i>	Tolerances on		t_1^a	a_1^b	t_2^a	Test torque M_{min} N·m
		Forms A and B	Form A				
0,4	2	+0,06 -0,02	0 -0,25	0	0,32	0,7	0,3
	2,5						0,4
0,5	3	+0,06 -0,04	0 -0,3	0	0,48	1,1	0,7
0,6	3						0,9
	0,6	3,5	± 0,06	0 -0,36	0	1,28	2,9
3,5		1,3					
0,8	4	± 0,06	0 -0,36	0	1,6	3,6	2,6
1	4,5						1,8
	1	5,5	± 0,06	0 -0,36	0	1,6	3,6
5,5		5,5					
1,2	6,5	± 0,06	0 -0,36	0	1,6	3,6	9,4
	8						11,5
1,6	8	± 0,06	0 -0,43	0	2	4,5	20,5
	10						25,6
2	12	± 0,06	0 -0,43	0	2	4,5	48
2,5	14						87,5

^a t_1, t_2 are the reference distances without tolerances.

$t_1 = 0,6 \times a$

$t_2 = 1,8 \times a$

^b $a_1 \leq a$ $a_{1, min} = 0,8 \times a$

The profile of dimensions a_1 to a within the reference distances t_2 shall be at least equal (parallel) or continuously ascending.

Table 2 — Machine-operated screwdriver tips, Form C

Dimensions in millimetres

Nominal thickness <i>a</i>	Nominal width <i>b</i>	Tolerances on		a_1^a min.	t_2^b	Test torque $M_{1, \min}$ N·m
		<i>a</i>	<i>b</i>			
0,4	2	+0,04 0	0 -0,06	0,32	0,7	0,35
	2,5					0,45
0,5	3		0 -0,075	0,4	0,9	0,8
	4					1,1
0,6	3		0 -0,06	0,48	1,1	1,2
	3,5					1,4
	4,5					1,8
0,8	4		0 -0,075	0,64	1,4	2,9
	5,5					3,9
1	4,5		0 -0,075	0,8	1,8	5
	5,5	6,2				
	6,0	6,7				
1,2	6,5	0 -0,15	0,96	2,2	10,5	
	8				12,9	
1,6	8	± 0,03	1,28	2,9	22,9	
	10				28,7	
2	12	0 -0,18	1,6	3,6	53,8	
2,5	14		2	4,5	98	

a $a_1 \leq a$ $a_{1, \min} = 0,8 \times a$
The profile of dimensions a_1 to a within the reference distances t_2 shall be at least equal (parallel) or continuously ascending.

b t_2 is the reference distance without tolerance.
 $t_2 = 1,8 \times a$

4 Designation of the tips

The designation of the tips shall include, in the following order:

- “Tip”;
- reference to this part of ISO 2380, i.e. “ISO 2380-1”;
- form;
- nominal thickness, a , in millimetres;
- nominal width, b , in millimetres.

EXAMPLE A tip, form A, of nominal thickness $a = 1,2$ mm and of nominal width $b = 8$ mm is designated as follows:

Tip ISO 2380-1 A 1,2 × 8

5 Technical specifications and test conditions for the screwdrivers

5.1 Hardness

Hand-operated screwdrivers shall have a minimum hardness of 50 HRC over at least the length $3 \times b$ from the tip of the blade, while machine-operated screwdrivers shall have a minimum hardness of 56 HRC along their full length.

5.2 Test conditions for the blades or bits

When tested with the minimum test torques M and M_1 , expressed in newton metres, in accordance with Tables 1 and 2, the screwdriver blades or bits shall not show any cracks or breaks or any permanent deformations which could influence their usability.

NOTE The minimum test torques have been calculated using the following formulae:

$$M = ba^2$$

and

$$M_1 = 1,12 ba^2$$

where

a is the nominal thickness of the tip, expressed in millimetres;

b is the nominal width of the tip, expressed in millimetres.

A torque testing device shall be used which sustains the test specimen against ejecting forces and prevents the occurrence of bending moments, and the test disc used shall be according to Figure 3 or Figure 4, have a hardness of at least 64 HRC and be of such strength that no deformation can occur during testing.

The test disc values a , t_1 and t_2 are according to Table 3.

Dimensions in millimetres

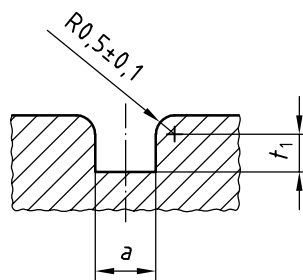

Figure 3 — Test disc for form A

Dimensions in millimetres

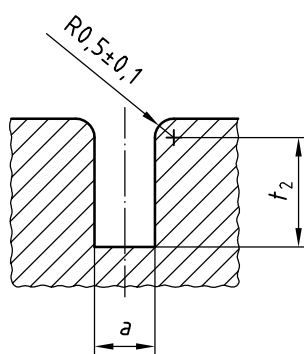

Figure 4 — Test disc for forms B and C

Table 3 — Test disc values

Dimensions in millimetres

a +0,085 +0,060	t_1 +0,040 0	t_2 +0,140 0
0,4	0,2	0,7
0,5	0,3	0,9
0,6	0,4	1,1
0,8	0,5	1,4
1	0,6	1,8
1,2	0,7	2,2
1,6	1	2,9
2	1,2	3,6
2,5	1,5	4,5

5.3 Test torque of the blade-to-handle connection (hand-operated screwdrivers)

The test torque which the blade-to-handle connection shall withstand is related to the test torque of the blade as given in Table 4.

Table 4 — Test torque

Test torque of blade M N·m	Test torque of blade-to-handle connection M' N·m
$M \leq 26$	$M' > M$
$M > 26$	$M' > 30$

The application of the test equipment to the handle should not modify the characteristics of the connection to be tested.