International Standard



93/1

INTERNATIONAL ORGANIZATION FOR STANDARDIZATION • МЕЖДУНАРОДНАЯ ОРГАНИЗАЦИЯ ПО СТАНДАРТИЗАЦИИ • ORGANISATION INTERNATIONALE DE NORMALISATION

Textile machinery and accessories — Cylindrical sliver cans — Part 1 : Main dimensions

Matériel pour l'industrie textile — Pots cylindriques pour rubans — Partie 1 : Dimensions principales

Second edition — 1982-12-01

iTeh STANDARD PREVIEW
(standards.iteh.ai)

ISO 93-1:1982

<https://standards.iteh.ai/catalog/standards/sist/abcd99e0-147f-43e6-a5d2-5bfa8500e1a2/iso-93-1-1982>

UDC 677.052.43

Ref. No. ISO 93/1-1982 (E)

Descriptors : textile machinery, sliver cans, cylindrical shape, dimensions.

Foreword

ISO (the International Organization for Standardization) is a worldwide federation of national standards institutes (ISO member bodies). The work of developing International Standards is carried out through ISO technical committees. Every member body interested in a subject for which a technical committee has been set up has the right to be represented on that committee. International organizations, governmental and non-governmental, in liaison with ISO, also take part in the work.

Draft International Standards adopted by the technical committees are circulated to the member bodies for approval before their acceptance as International Standards by the ISO Council.

International Standard ISO 93/1 was developed by Technical Committee ISO/TC 72, *Textile machinery and allied machinery and accessories*, and was circulated to the member bodies in July 1981.

(standards.iteh.ai)

It has been approved by the member bodies of the following countries :

Australia
Belgium
Brazil
Bulgaria
China
Czechoslovakia
Egypt, Arab Rep. of
France

Germany, F.R.
India
Italy
Japan
Korea, Rep. of
Mexico
Poland
Romania

ISO 93-1:1982

South Africa, Rep. of

Switzerland

Turkey

United Kingdom

USSR

Yugoslavia

No member body expressed disapproval of the document.

This second edition cancels and replaces the first edition (i.e. ISO 93/1-1977).

Textile machinery and accessories — Cylindrical sliver cans — Part 1 : Main dimensions

iTeh STANDARD PREVIEW

1 Scope and field of application (standards.iteh.ai)

This Part of ISO 93 specifies the main dimensions of cylindrical sliver cans.

[ISO 93-1:1982](https://standards.iteh.ai/catalog/standards/sist/abcd99e0-147f-43e6-a5d2-5bfa8500e1a2/iso-93-1-1982)

2 References

<https://standards.iteh.ai/catalog/standards/sist/abcd99e0-147f-43e6-a5d2-5bfa8500e1a2/iso-93-1-1982>

ISO 93/2, *Textile machinery and accessories — Cylindrical sliver cans — Part 2 : Spring bottoms.*

ISO 93/3, *Textile machinery and accessories — Cylindrical sliver cans — Part 3 : Packaging sliver cans (press cans).*

3 Sliver cans without castors

3.2 Main dimensions

3.1 Symbols

- d = inside diameter
- d_1 = outside diameter at base, $d_1 = d + 15$ mm
- d_2 = diameter of recess, $d_2 = d - 15$ mm
- h = overall height
- h_1 = height of recess

Table 1 – Dimensions of sliver cans without castors

Values in millimetres

| d | $h^{1)}$ |
|---------------------|--------------------------------|
| 225 | 900 |
| 250 | 800 900 |
| 300 | 800 900 1 000 |
| 350 | 800 900 1 000 |
| 400 | 800 900 1 000 1 100 |
| (450) ²⁾ | 1 000 |
| 500 | 900 |
| | 1 000 |
| | 1 100 |
| | 1 200 |
| (550) ²⁾ | 1 000 |
| | 900 |
| | 1 000 |
| | 1 200 |
| 600 | 900 1 000 1 100 1 200 |
| 700 | 900 1 000 1 100 1 200 |
| 800 | 900 1 000 1 100 1 200 |
| 900 | 900 1 000 1 100 1 200 |
| 1 000 | 900 1 000 1 100 1 200 |

Dimensions and tolerances in millimetres

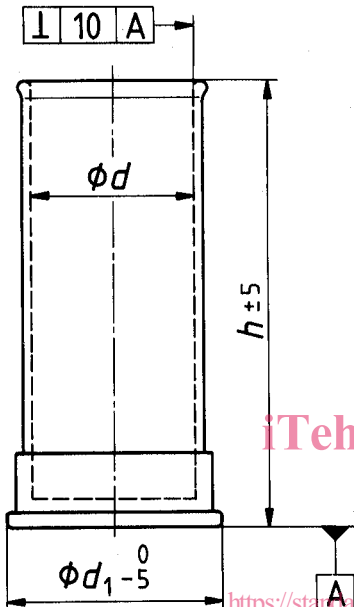

Figure 1 – Flat base can

Dimensions and tolerances in millimetres

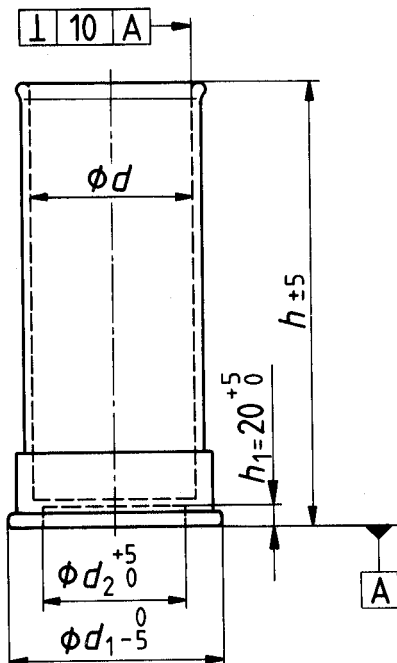

Figure 2 – Inverted base can

1) Heights in excess of 1 200 mm to be in increments of 100 mm.

2) The values shown in brackets should be avoided wherever possible.

4 Sliver cans with castors

4.1 Symbols

- d = inside diameter
- d_1 = outside diameter at base, $d_1 = d + 15$ mm
- d_2 = inside diameter of recess, $d_2 = d - 15$ mm
- d_3 = turning circle of castors
- h = overall height with castors

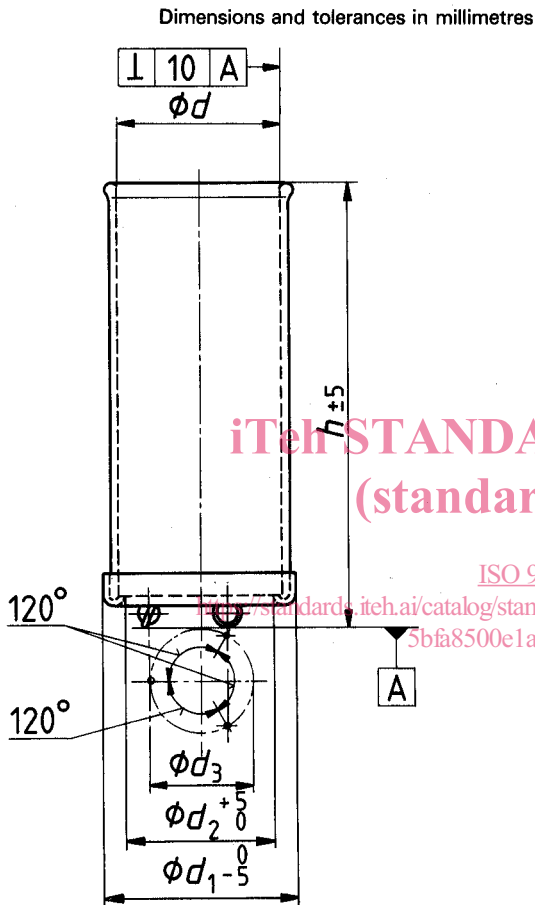

Figure 3 – Sliver can with castors

NOTE – The figure shows a can with three castors, but it possible to produce cans fitted with four castors, particularly for inside diameters above 700 mm.

4.2 Main dimensions

Table 2 – Dimensions of sliver cans with castors

Values in millimetres

| d | $h^{1)}$ | d_3 | |
|---------------------|----------|-----------|-----------|
| 400 | 900 | $d - 120$ | |
| | 1 000 | | |
| (450) ²⁾ | 1 000 | | |
| | 1 100 | | |
| 500 | 1 000 | | |
| | 1 100 | | |
| | 1 200 | | |
| 600 | 900 | | $d - 160$ |
| | 1 000 | | |
| | 1 100 | | |
| 700 | 1 000 | | |
| | 1 100 | | |
| | 1 200 | | |
| 800 | 1 000 | | |
| | 1 100 | | |
| | 1 200 | | |
| 900 | 1 000 | | |
| | 1 100 | | |
| | 1 200 | | |
| 1 000 | 1 100 | | |
| 1 200 | 1 200 | | |
| 1 400 | 1 200 | | |
| 1 600 | 1 200 | | |

- 1) Heights in excess of 1 200 mm to be in increments of 100 mm.
- 2) The value shown in brackets should be avoided wherever possible.

5 Designation

Example of designation of a sliver can without castors, corresponding to figure 2, with inside diameter $d = 600$ mm and overall height $h = 1200$ mm :

Can without castors ISO 93/1, fig. 2 - 600 × 1200

Example of designation of a sliver can with three castors, with inside diameter $d = 600$ mm and overall height $h = 1200$ mm :

Can with 3 castors ISO 93/1 - 600 × 1200

iTeh STANDARD PREVIEW
(standards.iteh.ai)

ISO 93-1:1982

<https://standards.iteh.ai/catalog/standards/sist/abcd99e0-147f-43e6-a5d2-5bfa8500e1a2/iso-93-1-1982>

iTeh STANDARD PREVIEW
(standards.iteh.ai)

ISO 93-1:1982

<https://standards.iteh.ai/catalog/standards/sist/abcd99e0-147f-43e6-a5d2-5bfa8500e1a2/iso-93-1-1982>

iTeh STANDARD PREVIEW
(standards.iteh.ai)

ISO 93-1:1982

<https://standards.iteh.ai/catalog/standards/sist/abcd99e0-147f-43e6-a5d2-5bfa8500e1a2/iso-93-1-1982>