



SLOVENSKI STANDARD
SIST ISO 199:2006
01-julij-2006

Kotalni ležaji – Aksialni ležaji - Tolerance

Rolling bearings - Thrust bearings - Tolerances

iTeh STANDARD PREVIEW

Ta slovenski standard je istoveten z: **(standards.iteh.ai)**

SIST ISO 199:2006

<https://standards.iteh.ai/catalog/standards/sist/68bb1167-194a-4882-bf4b-3d1b85766d7e/sist-iso-199-2006>

ICS:

21.100.20

SIST ISO 199:2006

en

iTeh STANDARD PREVIEW
(standards.iteh.ai)

SIST ISO 199:2006

<https://standards.iteh.ai/catalog/standards/sist/68bb1167-194a-4882-bf4b-3d1b85766d7e/sist-iso-199-2006>

INTERNATIONAL STANDARD

ISO 199

Third edition
2005-10-01

Rolling bearings — Thrust bearings — Tolerances

Roulements — Butées — Tolérances

iTeh STANDARD PREVIEW
(standards.iteh.ai)

[SIST ISO 199:2006](https://standards.iteh.ai/catalog/standards/sist/68bb1167-194a-4882-bf4b-3d1b85766d7e/sist-iso-199-2006)

<https://standards.iteh.ai/catalog/standards/sist/68bb1167-194a-4882-bf4b-3d1b85766d7e/sist-iso-199-2006>



Reference number
ISO 199:2005(E)

© ISO 2005

PDF disclaimer

This PDF file may contain embedded typefaces. In accordance with Adobe's licensing policy, this file may be printed or viewed but shall not be edited unless the typefaces which are embedded are licensed to and installed on the computer performing the editing. In downloading this file, parties accept therein the responsibility of not infringing Adobe's licensing policy. The ISO Central Secretariat accepts no liability in this area.

Adobe is a trademark of Adobe Systems Incorporated.

Details of the software products used to create this PDF file can be found in the General Info relative to the file; the PDF-creation parameters were optimized for printing. Every care has been taken to ensure that the file is suitable for use by ISO member bodies. In the unlikely event that a problem relating to it is found, please inform the Central Secretariat at the address given below.

iTeh STANDARD PREVIEW
(standards.iteh.ai)

SIST ISO 199:2006

<https://standards.iteh.ai/catalog/standards/sist/68bb1167-194a-4882-bf4b-3d1b85766d7e/sist-iso-199-2006>

© ISO 2005

All rights reserved. Unless otherwise specified, no part of this publication may be reproduced or utilized in any form or by any means, electronic or mechanical, including photocopying and microfilm, without permission in writing from either ISO at the address below or ISO's member body in the country of the requester.

ISO copyright office
Case postale 56 • CH-1211 Geneva 20
Tel. + 41 22 749 01 11
Fax + 41 22 749 09 47
E-mail copyright@iso.org
Web www.iso.org

Published in Switzerland

Contents

Page

Foreword	iv
1 Scope	1
2 Normative references	1
3 Terms and definitions	1
4 Symbols	1
5 Tolerances	2
5.1 General	2
5.2 Normal tolerance class	3
5.3 Tolerance class 6	5
5.4 Tolerance class 5	7
5.5 Tolerance class 4	9
6 Measurement and gauging	10

iTeh STANDARD PREVIEW
(standards.iteh.ai)

SIST ISO 199:2006

<https://standards.iteh.ai/catalog/standards/sist/68bb1167-194a-4882-bf4b-3d1b85766d7e/sist-iso-199-2006>

Foreword

ISO (the International Organization for Standardization) is a worldwide federation of national standards bodies (ISO member bodies). The work of preparing International Standards is normally carried out through ISO technical committees. Each member body interested in a subject for which a technical committee has been established has the right to be represented on that committee. International organizations, governmental and non-governmental, in liaison with ISO, also take part in the work. ISO collaborates closely with the International Electrotechnical Commission (IEC) on all matters of electrotechnical standardization.

International Standards are drafted in accordance with the rules given in the ISO/IEC Directives, Part 2.

The main task of technical committees is to prepare International Standards. Draft International Standards adopted by the technical committees are circulated to the member bodies for voting. Publication as an International Standard requires approval by at least 75 % of the member bodies casting a vote.

Attention is drawn to the possibility that some of the elements of this document may be the subject of patent rights. ISO shall not be held responsible for identifying any or all such patent rights.

ISO 199 was prepared by Technical Committee ISO/TC 4, *Rolling bearings*, Subcommittee SC 4, *Tolerances*.

This third edition cancels and replaces the second edition (ISO 199:1997), which has been technically revised.

ITEH STANDARD PREVIEW

(standards.iteh.ai)

SIST ISO 199:2006

<https://standards.iteh.ai/catalog/standards/sist/68bb1167-194a-4882-bf4b-3d1b85766d7e/sist-iso-199-2006>

Rolling bearings — Thrust bearings — Tolerances

1 Scope

This International Standard specifies tolerances for boundary dimensions (except chamfer dimensions) and for the running accuracy of thrust rolling bearings with flat back faces, as specified in ISO 104.

This International Standard is not applicable to certain thrust bearings, e.g. thrust needle roller bearings, or for particular fields of application, e.g. special thrust precision bearings.

Chamfer dimension limits are given in ISO 582.

2 Normative references

The following referenced documents are indispensable for the application of this document. For dated references, only the edition cited applies. For undated references, the latest edition of the referenced document (including any amendments) applies.

ISO 104, *Rolling bearings — Thrust bearings — Boundary dimensions, general plan*

ISO 582, *Rolling bearings — Chamfer dimensions — Maximum values*

ISO 1132-1, *Rolling bearings — Tolerances — Part 1: Terms and definitions*

ISO 1132-2, *Rolling bearings — Tolerances — Part 2: Measuring and gauging principles and methods*

ISO 5593, *Rolling bearings — Vocabulary*

ISO 15241, *Rolling bearings — Symbols for quantities*

3 Terms and definitions

For the purposes of this document, the terms and definitions given in ISO 1132-1 and ISO 5593 apply.

4 Symbols

For the purposes of this document, the symbols given in ISO 15241 and the following apply.

The symbols (except those for tolerances) shown in Figures 1 and 2, and the values given in Tables 1 to 8, denote nominal dimensions unless specified otherwise.

D	outside diameter of housing washer
d	bore diameter of shaft washer, single-direction bearing
d_2	bore diameter of central washer, double-direction bearing

- S_e variation in thickness between housing washer raceway and back face
 NOTE Applies only to thrust ball bearings and thrust cylindrical roller bearings with 90° contact angle.
- S_i variation in thickness between shaft washer raceway and back face
 NOTE Applies only to thrust ball bearings and thrust cylindrical roller bearings with 90° contact angle.
- T bearing height, single-direction bearing
- T_1 bearing height, double-direction bearing
- V_{Dsp} variation of outside diameter in a single plane of housing washer
- V_{dsp} variation of bore diameter in a single plane of shaft washer, single-direction bearing
- V_{d2sp} variation of bore diameter in a single plane of central shaft washer, double-direction bearing
- Δ_{Dmp} deviation of mean outside diameter in a single plane of housing washer
- Δ_{dmp} deviation of mean bore diameter in a single plane of shaft washer, single-direction bearing
- Δ_{d2mp} deviation of mean bore diameter in a single plane of central shaft washer, double-direction bearing
- Δ_{T_s} deviation of the actual bearing height, single-direction bearing
- $\Delta_{T_{1s}}$ deviation of the actual bearing height, double-direction bearing

iTech STANDARD PREVIEW
(standards.iteh.ai)

SIST ISO 199:2006
<https://standards.iteh.ai/catalog/standards/sist/68bb1167-194a-4882-04b-3d1b85766d7e/sist-iso-199-2006>

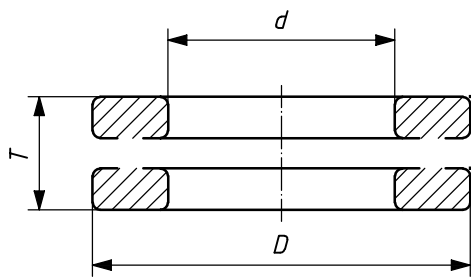

Figure 1 — Single-direction bearings

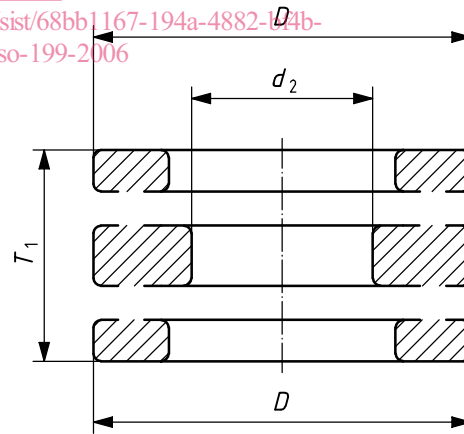

Figure 2 — Double-direction bearings

5 Tolerances

5.1 General

Tolerances for single-direction and double-direction thrust bearings are given in Tables 1 to 8.

5.2 Normal tolerance class

See Tables 1 and 2.

Table 1 — Shaft washer, central shaft washer and bearing height

Tolerance values in micrometres

d and d_2 mm		$\Delta_{dmp}, \Delta_{d2mp}$		V_{dsp}, V_{d2sp}	S_i	Δ_{Ts}		Δ_{T1s}	
>	≤	high	low	max.	max.	high	low	high	low
—	18	0	-8	6	10	+20	-250	+150	-400
18	30	0	-10	8	10	+20	-250	+150	-400
30	50	0	-12	9	10	+20	-250	+150	-400
50	80	0	-15	11	10	+20	-300	+150	-500
80	120	0	-20	15	15	+25	-300	+200	-500
120	180	0	-25	19	15	+25	-400	+200	-600
180	250	0	-30	23	20	+30	-400	+250	-600
250	315	0	-35	26	25	+40	-400	—	—
315	400	0	-40	30	30	+40	-500	—	—
400	500	0	-45	34	30	+50	-500	—	—
500	630	0	-50	38	35	+60	-600	—	—
630	800	0	-75	55	40	+70	-750	—	—
800	1 000	0	-100	75	45	+80	-1 000	—	—
1 000	1 250	0	-125	95	50	+100	-1 400	—	—
1 250	1 600	0	-160	120	60	+120	-1 600	—	—
1 600	2 000	0	-200	150	75	+140	-1 900	—	—
2 000	2 500	0	-250	190	90	+160	-2 300	—	—

NOTE For double-direction bearings, the values apply only up to and including $d_2 = 190$ mm.