



SLOVENSKI STANDARD
SIST ISO 12648:2006
01-september-2006

; fUz bUHM bc`c[]UE`J UfbcgfbY`nU hYj Y`nUg]ghYa Y`hg_Ufg_]`ghfc`Yj

Graphic technology - Safety requirements for printing press systems

iTeh STANDARD PREVIEW

Ta slovenski standard je istoveten z: standards.iteh.ai

[SIST ISO 12648:2006](https://standards.iteh.ai/catalog/standards/sist/dc96b7e6-206b-451e-8b39-0a63c740160c/sist-iso-12648-2006)

<https://standards.iteh.ai/catalog/standards/sist/dc96b7e6-206b-451e-8b39-0a63c740160c/sist-iso-12648-2006>

ICS:

37.100.10 Reprodukcijska oprema Reproduction equipment

SIST ISO 12648:2006

en

iTeh STANDARD PREVIEW
(standards.iteh.ai)

SIST ISO 12648:2006

<https://standards.iteh.ai/catalog/standards/sist/dc96b7e6-206b-451e-8b39-0a63c740160c/sist-iso-12648-2006>

**Graphic technology — Safety
requirements for printing press systems**

*Technologie graphique — Exigences de sécurité pour systèmes de
presses à imprimer*

iTeh STANDARD PREVIEW
(standards.iteh.ai)

[SIST ISO 12648:2006](https://standards.iteh.ai/catalog/standards/sist/dc96b7e6-206b-451e-8b39-0a63c740160c/sist-iso-12648-2006)

[https://standards.iteh.ai/catalog/standards/sist/dc96b7e6-206b-451e-8b39-
0a63c740160c/sist-iso-12648-2006](https://standards.iteh.ai/catalog/standards/sist/dc96b7e6-206b-451e-8b39-0a63c740160c/sist-iso-12648-2006)



PDF disclaimer

This PDF file may contain embedded typefaces. In accordance with Adobe's licensing policy, this file may be printed or viewed but shall not be edited unless the typefaces which are embedded are licensed to and installed on the computer performing the editing. In downloading this file, parties accept therein the responsibility of not infringing Adobe's licensing policy. The ISO Central Secretariat accepts no liability in this area.

Adobe is a trademark of Adobe Systems Incorporated.

Details of the software products used to create this PDF file can be found in the General Info relative to the file; the PDF-creation parameters were optimized for printing. Every care has been taken to ensure that the file is suitable for use by ISO member bodies. In the unlikely event that a problem relating to it is found, please inform the Central Secretariat at the address given below.

iTeh STANDARD PREVIEW
(standards.iteh.ai)

[SIST ISO 12648:2006](https://standards.iteh.ai/catalog/standards/sist/dc96b7e6-206b-451e-8b39-0a63c740160c/sist-iso-12648-2006)

<https://standards.iteh.ai/catalog/standards/sist/dc96b7e6-206b-451e-8b39-0a63c740160c/sist-iso-12648-2006>

© ISO 2006

All rights reserved. Unless otherwise specified, no part of this publication may be reproduced or utilized in any form or by any means, electronic or mechanical, including photocopying and microfilm, without permission in writing from either ISO at the address below or ISO's member body in the country of the requester.

ISO copyright office
Case postale 56 • CH-1211 Geneva 20
Tel. + 41 22 749 01 11
Fax + 41 22 749 09 47
E-mail copyright@iso.org
Web www.iso.org

Published in Switzerland

Contents

Page

Foreword.....	v
Introduction	vi
1 Scope	1
2 Normative references	1
3 Terms and definitions.....	4
4 Classification of machines covered by this International Standard	13
4.1 Machines for producing printing by various processes.....	13
4.2 Auxiliary equipment.....	13
5 Guarding against significant hazards.....	14
5.1 General.....	14
5.2 Guards	14
5.3 In-running (in-going) nips	17
5.4 Guarding in-running nips.....	17
5.5 Interlocks	21
5.6 Hold-to-run controls.....	23
5.7 Automatic format setting operations.....	24
5.8 Other safeguarding measures.....	25
5.9 Guarding of machine devices and components.....	26
6 Requirements for protection against other hazards	47
6.1 General.....	47
6.2 Fire and explosion.....	47
6.3 Spillage from washing devices	51
6.4 Electrical equipment.....	51
6.5 Working platforms, access stairs, passageways and raised workplaces	52
6.6 Stability.....	56
6.7 High contact temperatures	57
6.8 Noise	57
6.9 Electrostatic toner dust.....	57
6.10 Radiation hazards	58
6.11 Stationary knives	59
6.12 Rotary tools	59
6.13 Transport and storage of hazardous tools.....	59
6.14 Protruding machine parts	59
6.15 Handwheels and cranks	59
6.16 Washing equipment for printing formes, rollers and doctor blades	59
6.17 Alcohol dosing devices.....	60
6.18 Refrigerating devices in ink and dampening units	61
6.19 Powder spraying devices.....	61
6.20 Routine handling of heavy machine parts	61
6.21 Oxidizers, incinerators or thermal cleaning plants	61
7 Release from a hazardous situation	61
8 Control zones	62
9 Controls	63
9.1 General.....	63
9.2 Manual control devices	63
9.3 Initiating machine motion	71
9.4 Hold-to-run controls	72

9.5	Two-hand controls	72
9.6	Electro-sensitive protective devices	73
9.7	Pressure-sensitive mats, pressure-sensitive bumpers, trip devices	73
9.8	Braking devices and clutches.....	74
10	Control stations.....	75
10.1	Motion-control stations	75
10.2	Remote access	76
11	Control systems	79
11.1	General requirements	79
11.2	Additional requirements for hand-fed machines where the operator's hands enter the point of operation.....	80
11.3	Control systems for screen printing presses	81
12	Ergonomics and labelling of indicators and actuators.....	81
13	Signals and warning devices	81
13.1	General	81
13.2	Audible warning system.....	82
13.3	Area-light warning system	86
14	Warning signs and labels.....	86
15	Information for use	87
15.1	Minimum requirements for machine markings	87
15.2	Contents of instruction handbook	88
Annex A	(informative) Hazards associated with printing press systems.....	93
Annex B	(informative) Explosion-protection zones	96
Annex C	(informative) Risk analysis relating to the pitch angle of access stairs	99
Annex D	(informative) Example layout of instruction handbooks.....	101
Annex E	(normative) Area-light warning system.....	103
Bibliography	105

iteh STANDARD PREVIEW
 (standards.iteh.ai)
 SIST ISO 12648:2006
<https://standards.iteh.ai/catalog/standards/sist/dc96b7e6-206b-451e-8b39-0a63c740160c/sist-iso-12648-2006>

Foreword

ISO (the International Organization for Standardization) is a worldwide federation of national standards bodies (ISO member bodies). The work of preparing International Standards is normally carried out through ISO technical committees. Each member body interested in a subject for which a technical committee has been established has the right to be represented on that committee. International organizations, governmental and non-governmental, in liaison with ISO, also take part in the work. ISO collaborates closely with the International Electrotechnical Commission (IEC) on all matters of electrotechnical standardization.

International Standards are drafted in accordance with the rules given in the ISO/IEC Directives, Part 2.

The main task of technical committees is to prepare International Standards. Draft International Standards adopted by the technical committees are circulated to the member bodies for voting. Publication as an International Standard requires approval by at least 75 % of the member bodies casting a vote.

Attention is drawn to the possibility that some of the elements of this document may be the subject of patent rights. ISO shall not be held responsible for identifying any or all such patent rights.

ISO 12648 was prepared by Technical Committee ISO/TC 130, *Graphic technology*.

This second edition cancels and replaces the first edition (ISO 12648:2003), the following subclauses of which have been technically revised.

- 5.1: A requirement has been added to enable needed observation and adjustment with guards closed.
- 5.2.2.1: The use of risk assessment has been added to requirements, as appropriate.
- 5.5.6.3: A requirement to protect against malfunction of the interlock circuit as a result of short circuits has been added.
- 5.9.2.11: The exception to the requirements for protection of hazard zones on the unwinding unit of automatic reel-loading systems has been removed.
- 5.9.7 – 5.9.9: Requirements relating to guarding of the gripper area have been added.
- 6.5.2.4: For access platforms, a maximum handle diameter has been added.
- 9.2: A requirement for the use of symbology defined in ISO 15847 has been added.
- 9.2.3: A requirement for the colour of manual control devices in accordance with IEC 60204-1 has been added.
- 9.2.4.1.2: The location of emergency control devices has been clarified.
- 13.2.2: The timing of the audible alarm during the warning period has been changed.
- 13.2.6: Requirements for optional personnel warning lights for auxiliary equipment having armed status have been added.
- 15.2: Additional requirements for the contents of the instruction handbook have been defined.

Introduction

During the development of this International Standard, existing relevant standards of other countries were taken into consideration. An effort has been made to harmonize the requirements of all countries, recognizing that national standards or laws may dictate national requirements. In cases where it was known that there is a national requirement that differs from this International Standard, that has been noted.

This International Standard has taken into consideration material contained in ANSI B65.1-1995 [55] , EN 1010-1 [11] and EN 1010-2 [12].

The International Organization for Standardization (ISO) draws attention to the fact that it is claimed that compliance with this document may involve the use of one or more patents concerning the use of ESPDs in the delivery area. The patents identified are:

- German Patent DE 103 10 236 B3
- PCT patent application WO 2004/078626 A1

ISO takes no position concerning the evidence, validity and scope of this patent right.

The holders of this patent right have provided ISO with the following statement:

The companies Koenig & Bauer AG, Friedrich-Koenig-Strasse 4, 97080 Würzburg (D), Heidelberger Druckmaschinen AG, Kurfürsten-Anlage 52-60, 69115 Heidelberg (D) and MAN Roland Druckmaschinen AG, Mühlheimer Strasse 341, 63075 Offenbach (D) ("Patent Owners") as the exclusive owners of the German Patent DE 103 10 236 B3 and the PCT patent application WO 2004/078626 A1 ("Patents") herewith declare not to enforce any rights resulting from the German Patent DE 103 10 236 B3 and the PCT patent application WO 2004/078626 A1 against any third parties in any countries that intend to comply with the ISO/TC 130, CEN/TC 198, ANSI B65 standards, or any other local or regional standards that use the ISO/TC 130 standards or the relevant parts thereof or any derivative standards thereof. This declaration is legally binding for all current owners of the above-mentioned patent and patent application and their future legal successors.

Information may be obtained from:

Heidelberger Druckmaschinen AG
Intellectual Property R3
Kurfürsten-Anlage 52-60
D-69115 Heidelberg
Germany
Tel: +49-6221/92-3027
Fax: +49-6221/92-3099

Attention is drawn to the possibility that some of the elements of this document may be the subject of patent rights other than those identified above. ISO shall not be held responsible for identifying any or all such patent rights.

Graphic technology — Safety requirements for printing press systems

1 Scope

This International Standard provides safety requirements for the design and construction of machines used in printing press systems, including auxiliary equipment and finishing machines, in which all the machine actuators (e.g. drives) of the equipment in the system are controlled by the same control system.

It is applicable only to systems in which a printing press is part of the system. In cases where a binding/finishing system is not integrated with a printing press, ISO 12649^[32] will apply.

It addresses recognized hazards specific to printing press systems in the following areas:

— mechanical;

— electrical;

— slipping, tripping, falling;

— ergonomics;

— noise;

— radiation;

— fire and explosion;

— thermal;

— emissions.

iTeh STANDARD PREVIEW
(standards.iteh.ai)

[SIST ISO 12648:2006](https://standards.iteh.ai/catalog/standards/sist/dc96b7e6-206b-451e-8b39-0a63c740160c/sist-iso-12648-2006)

<https://standards.iteh.ai/catalog/standards/sist/dc96b7e6-206b-451e-8b39-0a63c740160c/sist-iso-12648-2006>

Equipment covered by this International Standard may be used in a stand-alone configuration, or in combination with other machines affected by an integrated control system. These may include, but are not limited to, the combinations of the machines noted in Clause 4.

This International Standard applies to machines manufactured one year or more after the date of publication of this International Standard.

2 Normative references

The following referenced documents are indispensable for the application of this document. For dated references, only the edition cited applies. For undated references, the latest edition of the referenced document (including any amendments) applies.

ISO 8031, *Rubber and plastics hoses and hose assemblies — Determination of electrical resistance*

ISO 11553:1996, *Safety of machinery — Laser processing machines — Safety requirements*

ISO 12648:2006(E)

ISO/TR 11688-1, *Acoustics — Recommended practice for the design of low-noise machinery and equipment — Part 1: Planning*

ISO 12100-1:2003, *Safety of machinery — Basic concepts, general principles for design — Part 1: Basic terminology, methodology*

ISO 12100-2:2003, *Safety of machinery — Basic concepts, general principles for design — Part 2: Technical principles*

ISO 13849-1:1999, *Safety of machinery — Safety-related parts of control systems — Part 1: General principles for design*

ISO 13850, *Safety of machinery — Emergency stop — Principles for design*

ISO 13851:2002, *Safety of machinery — Two-hand control devices — Functional aspects and design principles*

ISO 13852:1996, *Safety of machinery — Safety distances to prevent danger zones being reached by the upper limbs*

ISO 13854, *Safety of machinery — Minimum gaps to avoid crushing of parts of the human body*

ISO 13855, *Safety of machinery — Positioning of protective equipment with respect to the approach speeds of parts of the human body*

ISO 13856-1, *Safety of machinery — Pressure-sensitive protective devices — Part 1: General principles for design and testing of pressure-sensitive mats and pressure-sensitive floors*

ISO 14119:1998, *Safety of machinery — Interlocking devices associated with guards — Principles for design and selection*

ISO 14120, *Safety of machinery — Guards — General requirements for the design and construction of fixed and movable guards*

ISO 14122-1, *Safety of machinery — Permanent means of access to machinery — Part 1: Choice of a fixed means of access between two levels*

ISO 14122-2, *Safety of machinery — Permanent means of access to machinery — Part 2: Working platforms and walkways*

ISO 14122-3, *Safety of machinery — Permanent means of access to machinery — Part 3: Stairs, stepladders and guard-rails*

ISO 15847:—¹⁾, *Graphic technology — Graphical symbols for printing press systems and finishing systems, including related auxiliary equipment*

IEC 60079-1, *Electrical apparatus for explosive gas atmospheres — Part 1: Flameproof enclosures “d”*

IEC 60079-2, *Electrical apparatus for explosive gas atmospheres — Part 2: Pressurized enclosures “p”*

IEC 60079-5, *Electrical apparatus for explosive gas atmospheres — Part 5: Powder filling “q”*

IEC 60079-6, *Electrical apparatus for explosive gas atmospheres — Part 6: Oil-immersion “o”*

IEC 60079-7, *Electrical apparatus for explosive gas atmospheres — Part 7: Increased safety “e”*

1) To be published.

- IEC 60079-11, *Electrical apparatus for explosive gas atmospheres — Part 11: Intrinsic safety “I”*
- IEC 60079-14, *Electrical apparatus for explosive gas atmospheres — Part 14: Electrical installations in hazardous areas (other than mines)*
- IEC 60079-18, *Electrical apparatus for explosive gas atmospheres — Part 18: Construction, test and marking of type of protection encapsulation ‘m’ electrical apparatus*
- IEC 60204-1:2000, *Safety of machinery — Electrical equipment of machines — Part 1: General requirements*
- IEC 60825-1, *Safety of laser products — Part 1: Equipment classification, requirements and user’s guide*
- IEC 60947-5-1, *Low-voltage switchgear and controlgear — Part 5-1: Control circuit devices and switching elements — Electromechanical control circuit devices*
- IEC 61010-1, *Safety requirements for electrical equipment for measurement, control, and laboratory use — Part 1: General requirements*
- IEC 61310-1, *Safety of machinery — Indication, marking and actuation — Part 1: Requirements for visual, auditory and tactile signals*
- IEC 61310-2, *Safety of machinery — Indication, marking and actuation — Part 2: Requirements for marking*
- IEC 61496-1:2004, *Safety of machinery — Electro-sensitive protective equipment — Part 1: General requirements and tests*
- IEC 61496-2, *Safety of machinery — Electro-sensitive protective equipment — Part 2: Particular requirements for equipment using active opto-electronic protective devices (AOPDs)*
- EN 378-1, *Refrigerating systems and heat pumps. Safety and environmental requirements — Part 1: Basic requirements, definitions, classification and selection criteria*
- EN 563, *Safety of machinery — Temperatures of touchable surfaces — Ergonomics data to establish temperature limit values for hot surfaces*
- EN 1127-1, *Explosive atmospheres — Explosion prevention and protection — Part 1: Basic concepts and methodology*
- EN 1539, *Dryers and ovens, in which flammable substances are released — Safety requirements*
- EN 1760-2, *Safety of machinery — Pressure sensitive protective devices — Part 2: General principles for the design and testing of pressure sensitive edges and pressure sensitive bars*
- EN 12198-1:2000, *Safety of machinery — Assessment and reduction of risks arising from radiation emitted by machinery — Part 1: General principles*
- EN 13023, *Noise measurement methods for printing, paper converting, paper making machines and auxiliary equipment — Accuracy grades 2 and 3*
- NFPA 86, *Ovens and furnaces*. Available from Internet <<http://www.nfpa.org/>>

3 Terms and definitions

For the purposes of this document, the terms and definitions given in ISO 13849-1 and the following apply.

3.1 access height in the sheet-fed press delivery zone
dimension of the maximum opening into the area below the sheet gripper, measured between the access level (floor, fixed platform or footboard) and the lower edge of fixed machine parts (e.g. fixed guard, fixed cover, fixed parts such as a sheet stop) (see Figure 18)

3.2 actuator
part of the actuating system to which an external actuating force is applied

[IEV 441-15-22]^[54]

NOTE 1 The actuator can take the form of a handle, knob, pushbutton, roller, plunger, etc.

NOTE 2 There are some actuating means that do not require an external actuating force but only an action.

NOTE 3 See also **machine actuator** (3.39).

3.3 alcohol dosing equipment
device(s) used to regulate the amount of alcohol in the dampening water of offset printing presses

3.4 armed condition
machine status in which machine motion can be automatically initiated

NOTE **Zero speed** (3.92) can be considered an armed condition.
<https://standards.iteh.ai/catalog/standards/sist/dc96b7e6-206b-451e-8b39-0a63c740160c/sist-iso-12648-2006>

3.5 audible alarm
horn, bell or other distinctive audible warning device that sounds to indicate impending machine motion

3.6 authorized person
person identified by plant management as having special training or designated to act in specified situations

NOTE The specified situations can include special tasks to be performed; the function of the adjustments in the work zone; proper operation of adjustments and controls; all types of hazards in the area where the task is to be performed; the application of equivalent, alternative protection to perform the task; improper actions that can cause injury; the consequences of those improper actions.

3.7 automatic plate clamping device
mechanism used to secure a printing plate during the automatic or semi-automatic changing of the plates

3.8 auxiliary devices for printing presses
mechanisms or machines, either built-in or attached, used for the production process

3.9 barrier guard
guard (3.32) that reduces or prevents access to a hazard zone by closing off access to an area containing one or more hazards

3.10**bypass function
bypass sequence**

temporary, time-limited suppression of one or more safety functions through the use of safety-relevant parts of a control system

3.11**category 0 stop
uncontrolled stop**

stopping by immediate removal of power to the **machine actuators** (3.39)

[IEC 60204-1:2000]

3.12**category 1 stop**

controlled stop with power available to the **machine actuators** (3.39) to achieve the stop and then removal of power when the stop is achieved

[IEC 60204-1:2000]

3.13**category 2 stop**

controlled stop with power to the **machine actuators** (3.39) being maintained

[IEC 60204-1:2000]

iTeh STANDARD PREVIEW
(standards.iteh.ai)

3.14**coating unit
coater**

machine that applies a predetermined thickness of a liquid substance (e.g. glue, varnish, ink, etc.) on substrates made of paper or a similar material

NOTE The thickness of the layer is determined by a doctor blade (scraper) or by the gap between two rollers (metering gap).

3.15**continuous-flow drying and curing device**

mechanism built into printing presses to dry and cure inks and coatings that have been applied to substrates after the printing process (e.g. by hot air, IR or UV radiation)

3.16**continuous run**

machine motion at a steady speed initiated by a momentary contact control

3.17**control station**

defined location containing one or more controls

3.18**control zone**

control configuration of single or multiple machine motions using the same control devices (see Clause 8)

3.19**crawl speed**

continuous movement at a steady slow speed, and initiated by a momentary contact control

**3.20
cylinder
smooth roller**

elongated solid body with a circular cross-section having a smooth surface; i.e. with grooves or elevations no more than 4 mm deep and with circumferential slots no more than 8 mm wide with no sharp or cutting edges (see Figure 1)

Dimensions in millimetres

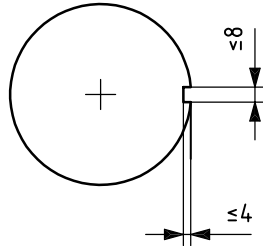

Figure 1 — Smooth roller/cylinder

**3.21
cylinder screen printing press**

sheet-fed machine in which the substrate (sheet) to be printed is guided along the screen by a printing cylinder (3.20)

iTeh STANDARD PREVIEW
(standards.iteh.ai)

**3.22
digital printing press**

machine in which the printed image is produced from data stored in digital form (e.g. exposing a photo-sensitive drum or film in the machine)

[SIST ISO 12648:2006](https://standards.iteh.ai/catalog/standards/sist/dc96b7e6-206b-451e-8b39-0a63c740160c/sist-iso-12648-2006)

<https://standards.iteh.ai/catalog/standards/sist/dc96b7e6-206b-451e-8b39-0a63c740160c/sist-iso-12648-2006>

**3.23
electrical hazard**

source of potential injury or death from electric shock or burn

**3.24
electro-sensitive protective device
ESPD**

apparatus that detects the presence of a person or part of a person or object in a defined area, using any detection means including, but not limited to, photoelectric, light screen, ultrasonic, etc.

**3.25
emergency stop device**

manually actuated control used to initiate an **emergency stop function** (3.26)

[ISO 13850:1996]

**3.26
emergency stop function**

mechanism initiated by a single human motion and intended to halt machine activity in order to avoid injury to persons, damage to machinery or damage to work in progress

**3.27
enabling device**

mechanism that must be in a specified state or condition in order for a second actuator or device to start a machine under **hold-to-run control** (3.34), and which will stop machine movement as soon as one of the hold-to-run controls is released or the status of the mechanism changes

3.28**exposing devices**

machinery used for creating images by exposing photo-sensitive material such as printing plates or printing formes

3.29**fixed guard**

guard (3.32) that is securely affixed by fasteners that require a tool(s) to gain access to an area with a significant hazard

3.30**forms printing press****leporello printing press**

machine for the production of continuous forms where paper webs printed with one or more colours are accordian-folded or wound on to a reel

NOTE In addition to the printing section, the machine consists of devices for punching, remainers (sprocket punching), cross perforation, longitudinal perforation and leporello (zig-zag) folding.

3.31**gravure press**

machine consisting of a printing cylinder, an inking system in which ink is applied to the printing cylinder by an ink roll or spray and the excess is removed by a doctor blade and an impression cylinder covered with a rubber composition, which presses the substrate into contact with the ink in the cells of the printing cylinder

3.32**guard**

physical barrier that restricts access to a **significant hazard** (3.80)

3.33**hazard zone**

any area within and/or around machinery in which a person is exposed to risk of injury or damage to health

[adapted from ISO 12100-1:2003]

3.34**hold-to-run control**

control that starts and maintains machine motion only as long as the control is activated

3.35**inch****jog**

(operation of machinery) machine motion requiring maintained activation engagement of a **hold-to-run control** (3.34) and which will continue until the control is released or until a pre-determined displacement (limited inch) has been reached

3.36**inch speed**

how fast the press is operating while in **inch** (3.35) mode

3.37**infrequently used workplace**

area in which an activity is carried out, such as observation, make-ready, jam clearing, minor servicing, crossing inserting hoppers or conveyer belts, etc., that is routine, repetitive, integral to (but not necessarily during) production, and done only on an occasional basis