



SLOVENSKI STANDARD
oSIST prEN 12331:2013
01-november-2013

Stroji za predelavo hrane - Stroji za mletje mesa - Varnostne in higienske zahteve

Food processing machinery - Mincing machines - Safety and hygiene requirements

Nahrungsmittelmaschinen - Wölfe - Sicherheits- und Hygieneanforderungen

Machines pour les produits alimentaires - Hachoirs - Prescriptions relatives à la sécurité et à l'hygiène

Ta slovenski standard je istoveten z: prEN 12331

ICS:

67.260

Tovarne in oprema za
živilsko industrijo

Plants and equipment for the
food industry

oSIST prEN 12331:2013

en,fr,de

EUROPEAN STANDARD
NORME EUROPÉENNE
EUROPÄISCHE NORM

DRAFT
prEN 12331

August 2013

ICS 67.260

Will supersede EN 12331:2003+A2:2010

English Version

**Food processing machinery - Mincing machines - Safety and
hygiene requirements**

Machines pour les produits alimentaires - Hachoirs -
Prescriptions relatives à la sécurité et à l'hygiène

Nahrungsmittelmaschinen - Wölfe - Sicherheits- und
Hygieneanforderungen

This draft European Standard is submitted to CEN members for enquiry. It has been drawn up by the Technical Committee CEN/TC 153.

If this draft becomes a European Standard, CEN members are bound to comply with the CEN/CENELEC Internal Regulations which stipulate the conditions for giving this European Standard the status of a national standard without any alteration.

This draft European Standard was established by CEN in three official versions (English, French, German). A version in any other language made by translation under the responsibility of a CEN member into its own language and notified to the CEN-CENELEC Management Centre has the same status as the official versions.

CEN members are the national standards bodies of Austria, Belgium, Bulgaria, Croatia, Cyprus, Czech Republic, Denmark, Estonia, Finland, Former Yugoslav Republic of Macedonia, France, Germany, Greece, Hungary, Iceland, Ireland, Italy, Latvia, Lithuania, Luxembourg, Malta, Netherlands, Norway, Poland, Portugal, Romania, Slovakia, Slovenia, Spain, Sweden, Switzerland, Turkey and United Kingdom.

Recipients of this draft are invited to submit, with their comments, notification of any relevant patent rights of which they are aware and to provide supporting documentation.

Warning : This document is not a European Standard. It is distributed for review and comments. It is subject to change without notice and shall not be referred to as a European Standard.



EUROPEAN COMMITTEE FOR STANDARDIZATION
COMITÉ EUROPÉEN DE NORMALISATION
EUROPÄISCHES KOMITEE FÜR NORMUNG

Management Centre: Avenue Marnix 17, B-1000 Brussels

Contents

	Page
Foreword.....	4
Introduction	5
1 Scope	6
2 Normative references	8
3 Terms and definitions	9
4 List of hazards.....	11
4.1 General.....	11
4.2 Mechanical hazards	11
4.2.1 Mincing machines with feed intake and worm	11
4.2.2 Mincing machines with feed intake hopper and screw conveyor/mixing screw	11
4.2.3 Discharge outlet on mincing machines.....	11
4.2.4 Installation and removal of worm and set of cutting tools.....	12
4.2.5 Drive mechanism	12
4.2.6 Machine components e.g. cover over hopper edge.....	12
4.2.7 Loading device on mincing machines (see Figure 2b).....	13
4.3 Electrical hazards	13
4.3.1 Direct or indirect contact with live parts	13
4.3.2 Electrical components with insufficient safety level	13
4.4 Hazard from loss of stability.....	13
4.5 Noise hazard.....	13
4.6 Hazards from use of gases and direct steam	14
4.7 Hazards from non-compliance with ergonomic principles	14
4.8 Hazards from non-compliance with hygiene principles	14
5 Safety requirements and/or measures	14
5.1 General.....	14
5.2 Mechanical safety	15
5.2.1 General.....	15
5.2.2 Measures at mincing machines with feed intake and worm	15
5.2.3 Measures at mincing machines with feed intake hopper and screw conveyor	17
5.2.4 Discharge outlet on mincing machines.....	21
5.2.5 Installation and removal of worm and set of cutting tools.....	22
5.2.6 Drive system.....	23
5.2.7 Machine components e.g. cover over hopper edge.....	23
5.2.8 Mincing machines with loading devices	23
5.3 Electrical hazards	25
5.3.1 General.....	25
5.3.2 Stopping function of switching devices.....	25
5.3.3 Emergency stop-device	25
5.3.4 Protection against water ingress	26
5.3.5 ON and OFF-switch.....	27
5.3.6 Safety requirements related to electromagnetic phenomena	27
5.4 Hazards from loss of stability.....	27
5.5 Noise reduction.....	27
5.6 Hazards from use of gases (N ₂ , CO ₂ and steam)	27
5.7 Ergonomic requirements	28

5.8	Hygiene and cleaning.....	29
5.8.1	General	29
5.8.2	Food area.....	29
5.8.3	Splash area	30
5.8.4	Non-food area	30
5.8.5	Surface conditions	30
5.8.6	Cleaning.....	30
6	Verification of safety requirements and/or measures	30
7	Information for use	32
7.1	General	32
7.2	Operating instruction	32
7.3	Operator training	34
8	Marking.....	34
Annex A	(normative) Noise test code for mincing machines (grade 2).....	35
A.1	Emission sound pressure level determination	35
A.2	Installation and mounting conditions	35
A.3	Operating conditions	35
A.4	Measurement	35
A.5	Information to be recorded.....	35
A.6	Information to be reported.....	35
A.7	Declaration and verification of the noise emission values	36
Annex B	(normative) Design principles to ensure cleanability of mincing machines	37
B.1	Definition	37
B.2	Materials	38
B.2.1	General	38
B.2.2	Type of materials	38
B.3	Design.....	38
B.3.1	General	38
B.3.2	Food area.....	38
B.3.3	Splash area	40
B.3.4	Non-food area	41
Annex C	(normative) Common hazards for food processing machines and reduction requirements applicable to mincing machines	42
C.1	Hazards of material being processed.....	42
C.2	Risks from cleaning	42
C.3	External influences on electrical equipment	42
C.4	Restoration of energy supply after an interruption	42
C.5	Hazards from neglecting use of PPE.....	43
Annex ZA	(informative) Relationship between this European Standard and the Essential Requirements of EU Directive 2006/42/EC	44
Bibliography	45

Foreword

This document (prEN 12331:2013) has been prepared by Technical Committee CEN/TC 153 “Machinery intended for use with foodstuffs and feed”, the secretariat of which is held by DIN.

This document is currently submitted to the CEN Enquiry.

This document will supersede EN 12331:2003+A2:2010.

This document has been prepared under a mandate given to CEN by the European Commission and the European Free Trade Association, and supports essential requirements of EU Directive(s).

For relationship with EU Directive(s), see informative Annex ZA, which is an integral part of this document.

iTeh STANDARD PREVIEW
(standards.iteh.ai)

SIST EN 12331:2015

<https://standards.iteh.ai/catalog/standards/sist/6a3caba2-c391-4479-84e9-4368567a7b46/sist-en-12331-2015>

Introduction

This document is a type C standard as stated in EN ISO 12100.

The machinery concerned and the extent to which hazards, hazardous situations and hazardous events are covered are indicated in the scope of this document.

When provisions of this type C standard are different from those which are stated in type A or B standards, the provisions of this type C standard take precedence over the provisions of the other standards, for machines that have been designed and built according to the provisions of this type C standard.

iTeh STANDARD PREVIEW
(standards.iteh.ai)

SIST EN 12331:2015

<https://standards.iteh.ai/catalog/standards/sist/6a3caba2-c391-4479-84e9-4368567a7b46/sist-en-12331-2015>

1 Scope

1.1 This European Standard specifies requirements for the design and manufacture of mincing machines (see Figures 1a and 1b) used in a stationary position.

The machines covered by this European Standard are used for size reduction of fresh or frozen meat, meat products and fish by cutting in a set of cutting tools.

Mincing machines for domestic uses are not included in this European Standard. Filling mincers are covered by EN 12463 "Food processing machinery - Filling machines and auxiliary machines - Safety and hygiene requirements".

This European Standard applies only to machines that are manufactured after the date of issue of this European Standard.

Mincing machines in connection with using a hold to run foot switch are not covered by this European Standard.

This European Standard covers:

- mincing machines used in shops and preparation rooms;
- mincing machines used in kitchens where sausages are prepared;
- mincing machines used industrially;
- accessories.

The extent to which hazards are covered, is indicated in this European Standard. For other hazards which are not covered by this European Standard, machinery should comply with EN ISO 12100 where applicable.

This European Standard is not dealing with specific requirements for the control of mincing machines with foot switch.

1.2 This European Standard covers the following types:

- Mincing machine with tray, feed intake and pusher, diameter ≤ 52 mm on feed intake (see Figure 3)
- Mincing machine with tray, feed intake, restrictor plate and pusher, diameter > 52 mm on feed intake (see Figure 4)
- Mincing machine with feed intake hopper and cover, screw conveyor, with ¹⁾ or without mixing screw in feed intake hopper (see Figure 5)
- Mincing machine with feed intake hopper, with or without cover, screw conveyor, with ¹⁾ or without mixing screw in feed intake hopper, with loading device (continuously or discontinuously)

Mincing machines comprise a machine base, a worm casing with a worm, a feed intake tray or hopper, a screw conveyor (and sometimes an additional mixing screw in the feed intake hopper), a set of cutting tools, a lock nut, a loading device, a drive motor and, depending on machine type, electrical, hydraulic and pneumatic components. They will also have various safeguarding devices as examples in Clause 5.

1) In this case, EN 13570 should be taken into consideration.

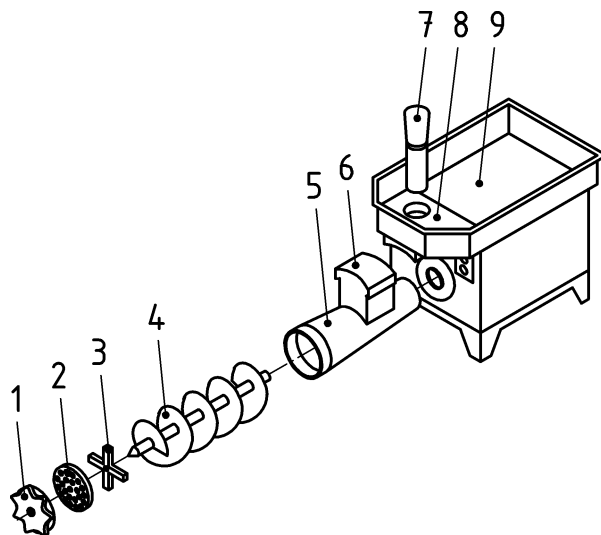

a) Mincing machine with tray and restrictor plate

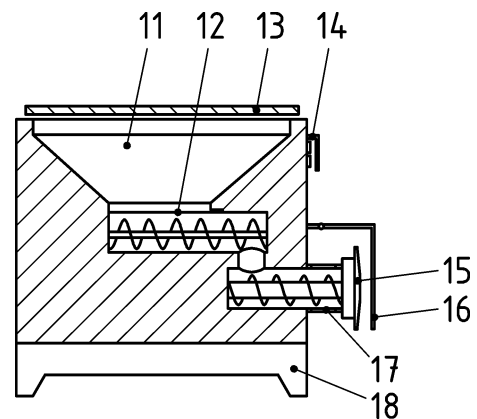

b) Mincing machine with feed intake hopper, cover and screw conveyor

Key

1	LOCK NUT	6	FEED INTAKE	11	FEED INTAKE	15	LOCK NUT
2	HOLE PLATE	7	PUSHER	12	HOPPER	16	PROTECTIVE
3	BLADE	8	RESTRICTOR PLATE	13	SCREW CONVEYOR	17	HOOD
4	WORM	9	TRAY	14	COVER	18	WORM
5	WORM CASING	10	ON/OFF SWITCH		ON/OFF SWITCH		MACHINE RACK
			PROTECTIVE HOOD		PROTECTIVE HOOD		

Figure 1 — Arrangement of a mincing machine

Mincing machines may be equipped e.g. with

- an extraction claw,
- an ejector or extractor,
- a protective hood over the discharge outlet,
- a cover over the inlet opening of the feed intake hopper,
- a transport carriage for the lock nut, the set of cutting tools, the worm and the screw conveyor,
- a lifting device for the lock nut, the set of cutting tools, the worm and the screw conveyor,
- a loading device.

1.3 Intended use

The fresh or frozen meat, meat product or the fish is fed manually or by means of the loading device into the mincing machine. The product is fed to the worm either by means of a pusher or a screw conveyor and size reduced in the set of cutting tools.

It is not intended that mincing machines are cleaned with pressurized water. However, it is to be foreseen that it is difficult to guarantee that this method will never be used in practice. In order to deal with this eventuality, the requirements of 5.3.3.2 should apply.

prEN 12331:2013 (E)

This European Standard specifies all significant hazards, hazardous situations and events relevant to mincing machines, when they are used as intended and under conditions of misuse which are reasonably foreseeable by the manufacturer (see Clause 4).

This European Standard specifies the hazards which can arise during commissioning, operation, cleaning, use, maintenance and decommissioning of the machine.

2 Normative references

The following documents, in whole or in part, are normatively referenced in this document and are indispensable for its application. For dated references, only the edition cited applies. For undated references, the latest edition of the referenced document (including any amendments) applies.

EN 349, *Safety of machinery — Minimum gaps to avoid crushing of parts of the human body*

EN 614-1, *Safety of machinery — Ergonomic design principles — Part 1: Terminology and general principles*

EN 953:1997+A1:2009, *Safety of machinery — Guards — General requirements for the design and construction of fixed and movable guards*

EN 1005-1, *Safety of machinery — Human physical performance — Part 1: Terms and definitions*

EN 1005-2, *Safety of machinery — Human physical performance — Part 2: Manual handling of machinery and component parts of machinery*

EN 1005-3, *Safety of machinery — Human physical performance — Part 3: Recommended force limits for machinery operation*

EN 1088:1995+A2:2008, *Safety of machinery — Interlocking devices associated with guards — Principles for design and selection*

EN 1672-2:2005+A1:2009, *Food processing machinery — Basic concepts — Part 2: Hygiene requirements*

EN 60204-1:2006, *Safety of machinery — Electrical equipment of machines — Part 1: General requirements (IEC 60204-1:2005, modified)*

EN 60529, *Degrees of protection provided by enclosures (IP Code) (IEC 60529)*

EN 61496-1:2004+A1:2008, *Safety of machinery — Electro-sensitive protective equipment — Part 1: General requirements and tests (IEC 61496-1:2004, modified)*

EN ISO 4287, *Geometrical product specifications (GPS) — Surface texture: Profile method — Terms, definitions and surface texture parameters (ISO 4287)*

EN ISO 4871, *Acoustics — Declaration and verification of noise emission values of machinery and equipment (ISO 4871)*

EN ISO 11204:2010, *Acoustics — Noise emitted by machinery and equipment — Measurement of emission sound pressure levels at a work station and at other specified positions — Method requiring environmental corrections (ISO 11204:1995)*

EN ISO 11688-1, *Acoustics — Recommended practice for the design of low-noise machinery and equipment — Part 1: Planning (ISO/TR 11688-1)*

EN ISO 12100:2010, *Safety of machinery — General principles for design — Risk assessment and risk reduction (ISO 12100:2010)*

EN ISO 13849-1:2008, *Safety of machinery — Safety-related parts of control systems — Part 1: General principles for design (ISO 13849-1:2006)*

EN ISO 13857:2008, *Safety of machinery — Safety distance to prevent danger zones being reached by the upper limbs (ISO 13857:2008)*

3 Terms and definitions

For the purposes of this document, the terms and definitions given in EN ISO 12100-1:2003 and the following apply.

3.1

platform

accessible standing area

3.2

worm

rotating screw-shaped component in the worm casing for meat transport to the set of cutting tools

3.3

step

interlocked standing area

3.4

ejector/extractor

device for detaching the set of cutting tools and the worm

3.5

extraction claw

tool for detaching the set of cutting tools and the worm

3.6

loading device

lift tilt device for the lifting and tilting of transport cars and containers

3.7

container

device for holding products to be processed

3.8

cover

movable device with safety function

3.9

feed intake

housing between the tray and the worm casing

3.10

feed intake hopper

container for holding the products to be processed with safety function

3.11

locking device

device for locking the trolley or container in the load bearing device

3.12

trolley

movable device for holding the products to be processed

prEN 12331:2013 (E)

3.13**design dimension**

sum of dimensions measured from the floor, in the case of steps, intermediate steps or platforms from the standing place to the hopper edge and from the hopper edge to the first danger point in the feed intake hopper (see Figures 6 and 7)

3.14**cooling mincer**

machine with a cooling device for the feed intake and the worm casing

3.15**light barrier/light curtain**

optical-electrical safety component

3.16**hole plate**

fixed plate with bores

3.17**mixing screw**

rotating screw-shaped component in the feed intake hopper above the screw conveyor for mixing the product

3.18**blade**

cutting tool with one or several blades

3.19**tray**

container for holding the product to be processed

3.20**mechanical bar**

movable device with safety function

3.21**worm casing**

casing for holding the worm and the set of cutting tools

3.22**cutting chamber**

chamber inside the worm casing for holding the set of cutting tools

3.23**set of cutting tools**

rough-cutter, blade and hole plate for size reduction of product

3.24**protective grid**

movable device on the feed intake hopper mouth

3.25**protective hood**

movable device on the discharge outlet

3.26**restrictor plate**

stationary non detachable device above the feed intake

3.27**pusher**

device used to push the product further in the feed intake

3.28**screw conveyor**

rotating screw-shaped component in the feed intake hopper for meat transport to the worm

3.29**transport carriage**

movable device for holding the lock nut, set of cutting tools, worm and screw conveyor

3.30**lock nut**

device for locking the set of cutting tools in the cutting chamber

3.31**preparation room**

room for preparation of sale products

4 List of hazards**4.1 General**

This clause and Annex C contain the hazards and hazardous situations which may arise during operation of mincing machines as far as they are dealt with in this European Standard, identified by a risk assessment significant for this type of machinery and which require action identified to eliminate or reduce risk.

Before using this European Standard it is important to carry out a risk assessment of the mincing machine to check that it has the hazards identified in this clause.

4.2 Mechanical hazards**4.2.1 Mincing machines with feed intake and worm**

— Zone 1

Rotating screw conveyor at the end of the feed intake (see Figure 2a).

Hazards of entanglement, shearing or severing of fingers or hand.

4.2.2 Mincing machines with feed intake hopper and screw conveyor/mixing screw

— Zone 2

Rotating screw conveyor or mixing screw in the feed intake hopper (see Figure 2b).

Hazards of entanglement, shearing or severing of fingers, hand or forearm.

4.2.3 Discharge outlet on mincing machines

— Zone 3

Rotating blade behind the hole plate at the discharge outlet (see Figure 2b).

Hazards of shearing of fingers.