

**SLOVENSKI STANDARD**  
**oSIST prEN 12965:2018**  
**01-september-2018**

---

**Traktorji ter kmetijski in gozdarski stroji - Priključne gredi in njihova zaščita - Varnost**

Tractors and machinery for agriculture and forestry - Power take-off (PTO) drive shafts and their guards - Safety

Traktoren und Maschinen für die Land- und Forstwirtschaft - Gelenkwellen und ihre Schutzeinrichtungen - Sicherheit

Tracteurs et matériels agricoles et forestiers - Arbres de transmission à cardans de prise de force et leurs protecteurs - Sécurité

**Ta slovenski standard je istoveten z: prEN 12965**

---

**ICS:**

65.060.01	Kmetijski stroji in oprema na splošno	Agricultural machines and equipment in general
-----------	---------------------------------------	--

**oSIST prEN 12965:2018**

**en,fr,de**



EUROPEAN STANDARD  
NORME EUROPÉENNE  
EUROPÄISCHE NORM

**DRAFT**  
**prEN 12965**

July 2018

ICS 65.060.01

Will supersede EN 12965:2003+A2:2009

English Version

**Tractors and machinery for agriculture and forestry -  
Power take-off (PTO) drive shafts and their guards - Safety**

Tracteurs et matériels agricoles et forestiers - Arbres  
de transmission à cardans de prise de force et leurs  
protecteurs - Sécurité

Traktoren und Maschinen für die Land- und  
Forstwirtschaft - Gelenkwellen und ihre  
Schutzeinrichtungen - Sicherheit

This draft European Standard is submitted to CEN members for second enquiry. It has been drawn up by the Technical Committee CEN/TC 144.

If this draft becomes a European Standard, CEN members are bound to comply with the CEN/CENELEC Internal Regulations which stipulate the conditions for giving this European Standard the status of a national standard without any alteration.

This draft European Standard was established by CEN in three official versions (English, French, German). A version in any other language made by translation under the responsibility of a CEN member into its own language and notified to the CEN-CENELEC Management Centre has the same status as the official versions.

CEN members are the national standards bodies of Austria, Belgium, Bulgaria, Croatia, Cyprus, Czech Republic, Denmark, Estonia, Finland, Former Yugoslav Republic of Macedonia, France, Germany, Greece, Hungary, Iceland, Ireland, Italy, Latvia, Lithuania, Luxembourg, Malta, Netherlands, Norway, Poland, Portugal, Romania, Serbia, Slovakia, Slovenia, Spain, Sweden, Switzerland, Turkey and United Kingdom.

Recipients of this draft are invited to submit, with their comments, notification of any relevant patent rights of which they are aware and to provide supporting documentation.

**Warning :** This document is not a European Standard. It is distributed for review and comments. It is subject to change without notice and shall not be referred to as a European Standard.



EUROPEAN COMMITTEE FOR STANDARDIZATION  
COMITÉ EUROPÉEN DE NORMALISATION  
EUROPÄISCHES KOMITEE FÜR NORMUNG

**CEN-CENELEC Management Centre: Rue de la Science 23, B-1040 Brussels**

<b>Contents</b>	<b>Page</b>
European foreword.....	3
Introduction .....	4
1 Scope .....	5
2 Normative references .....	5
3 Terms and definitions .....	6
4 Safety requirements and/or measures .....	9
4.1 General requirements .....	9
4.2 Overlap on PTO side.....	10
4.2.1 Universal joint.....	10
4.2.2 Wide-angle universal joint .....	11
4.3 Wide-angle guard cone requirements.....	12
4.4 PTO drive shaft guard.....	13
4.4.1 General.....	13
4.4.2 Restraining system.....	14
4.5 Service and maintenance .....	14
4.5.1 Lubrication requirements.....	14
4.5.2 Maintenance requirements.....	14
4.6 Locking system on PTO yoke and PIC yoke.....	14
4.6.1 General.....	14
4.6.2 Locking system on PTO yoke.....	15
4.6.3 Locking system on PIC yoke .....	15
5 Verification of safety requirements and/or measures.....	15
5.1 General.....	15
5.2 Test for guarding the universal joints including wide-angle .....	15
5.3 Entanglement test.....	17
5.3.1 General.....	17
5.3.2 Test conditions.....	17
5.3.3 Test sample .....	19
5.3.4 Test procedure.....	20
5.3.5 Acceptance criteria.....	22
5.3.6 Test report.....	22
6 Information for use .....	23
6.1 Operator's manual .....	23
6.2 Marking.....	24
6.2.1 General.....	24
6.2.2 Instructional signs .....	24
6.2.3 Safety signs .....	25
Annex A (informative) List of significant hazards.....	27
Annex ZA (informative) Relationship between this European Standard and the Essential Requirements of EU Directive 2006/42/EC amended by Directive 2009/127/EC aimed to be covered .....	30
Bibliography.....	32

## European foreword

This document (prEN 12965:2018) has been prepared by Technical Committee CEN/TC 144 “Tractors and machinery for agriculture and forestry”, the secretariat of which is held by AFNOR.

This document is currently submitted to the second CEN Enquiry.

This document will supersede EN 12965:2003+A2:2009.

This document has been prepared under a mandate given to CEN by the European Commission and the European Free Trade Association, and supports essential requirements of EU Directive(s).

For relationship with EU Directive(s), see informative Annex ZA, which is an integral part of this document.

iTeh STANDARD PREVIEW  
(standards.iteh.ai)

SIST EN 12965:2020

<https://standards.iteh.ai/catalog/standards/sist/07161da4-8a90-4258-9e2c-fc03bd7f3c9f/sist-en-12965-2020>

## Introduction

This European Standard is a type C standard as defined in EN ISO 12100:2010.

The machinery concerned and the extent to which hazards, hazardous situations and events are covered are indicated in the scope of this document.

When provisions of this type C standard are different from those which are stated in type A or B standards, the provisions of this type C standard take precedence over the provisions of the other standards, for machines that have been designed and built according to the provisions of this type C standard.

The hazards that are common to agricultural machines (self-propelled, mounted, semi-mounted and trailed) are dealt with in EN ISO 4254-1:2015.

This document is of relevance, in particular, for the following stakeholder groups representing the market players with regard to machinery safety:

- machine manufacturers (small, medium and large enterprises);
- health and safety bodies (regulators, accident prevention organizations, market surveillance, etc.).

Others can be affected by the level of machinery safety achieved with the means of the document by the above-mentioned stakeholder groups:

- machine users/employers (small, medium and large enterprises);
- machine users/employees (e.g. trade unions, organizations for people with special needs);
- service providers, e.g. for maintenance (small, medium and large enterprises);
- consumers (in case of machinery intended for use by consumers).

The above-mentioned stakeholder groups have been given the possibility to participate at the drafting process of this document.

## 1 Scope

This document specifies safety requirements and their verification for the design and construction of power take-off (PTO) drive shafts and their guards linking a tractor or self-propelled machinery to the first fixed bearing of recipient machinery. It describes methods for the elimination or reduction of risks which need specific requirements including such risks arising from misuse, reasonably foreseeable by the manufacturer. It is applicable only to those PTO drive shafts and guards mechanically linked to the shaft by at least two bearings.

In addition, it specifies the type of information on safe working practices to be provided by the manufacturer.

This document does not deal with:

- the guards totally covering, but not mechanically linked to, the PTO drive shaft;
- the mechanical characteristics of PTO drive shafts, overrun devices and torque limiters;
- general hazards which are dealt with in EN ISO 4254-1:2015 (see introduction).

Environmental aspects have not been considered in this document.

This document is not applicable to PTO drive shafts and their guards which are manufactured before the date of publication of this document by CEN.

## 2 Normative references

The following documents are referred to in the text in such a way that some or all of their content constitutes requirements of this document. For dated references, only the edition cited applies. For undated references, the latest edition of the referenced document (including any amendments) applies.

EN 15811, *Agricultural machinery — Fixed guards and interlocked guards with or without guard locking for moving transmission parts (ISO/TS 28923:2012 modified)*

EN ISO 4254-1:2015, *Agricultural machinery — Safety — Part 1: General requirements (ISO 4254-1:2013)*

EN ISO 5674, *Tractors and machinery for agriculture and forestry — Guards for power take-off (PTO) drive-shafts — Strength and wear tests and acceptance criteria (ISO 5674:2004, corrected version 2005-07-01)*

EN ISO 12100:2010, *Safety of machinery — General principles for design — Risk assessment and risk reduction (ISO 12100:2010)*

EN ISO 13857:2008, *Safety of machinery — Safety distances to prevent hazard zones being reached by upper and lower limbs (ISO 13857:2008)*

ISO 500-3, *Agricultural tractors — Rear-mounted power take-off types 1, 2, 3 and 4 — Part 3: Main PTO dimensions and spline dimensions, location of PTO*

ISO 11684:1995, *Tractors, machinery for agriculture and forestry, powered lawn and garden equipment — Safety signs and hazard pictorials — General principles*

ISO 1140:2012, *Fibre ropes — Polyamide — 3-, 4-, 8- and 12-strand ropes*

### 3 Terms and definitions

For the purposes of this document, the following terms and definitions apply.

ISO and IEC maintain terminological databases for use in standardization at the following addresses:

- IEC Electropedia: available at <http://www.electropedia.org/>
- ISO Online browsing platform: available at <http://www.iso.org/obp>

#### 3.1

##### **power take-off (PTO) drive shaft**

assembly consisting of two joints, telescopic members and a guard which is mechanically linked to the shaft by at least two bearings used to transmit rotational power from the PTO of a tractor or self-propelled machine to the PIC of an implement

Note to entry 1: See Figure 1 - only shown as an example

#### 3.2

##### **restraining system**

part of the PTO drive shaft guard which prevents rotation of the guard when the PTO drive shaft rotates

Note to entry 1: See Figure 1, key 28 - only shown as an example

#### 3.3

##### **universal joint**

mechanical device which can transmit torque and/or rotational motion

Note to entry 1: See Figure 1, key 12 - only shown as an example

#### 3.4

##### **wide-angle universal joint**

mechanical device which can transmit torque and/or rotational motion at a constant velocity at fixed or varying angles, generally equal or higher than 50°

Note to entry 1: See Figure 1, key 16 - only shown as an example

#### 3.5

##### **overrun device**

device that permits the transmission of motion only in one direction (from the tractor towards the recipient machinery)

Note to entry 1: It is normally used with recipient machine having high value inertia

#### 3.6

##### **torque limiter**

device that cuts or limits the transmission of motion between tractor and recipient machinery, when the torque reaches a prefixed value

#### 3.7

##### **locking system**

device on the PTO yoke and PIC yoke which allows locking of the PTO drive shaft mechanically to the tractor's PTO and to the PIC of the recipient machinery

Note to entry 1: See Figure 1, key 27 - only shown as an example



**3.8****guard cone**

guard of the inner yokes of the PTO drive shaft, integrally fixed to the guard tubes of the inner and outer telescopic members of the PTO drive shaft

Note to entry 1: See Figure 1, key 19 - only shown as an example

**3.9****wide-angle guard cone**

guard of the wide-angle universal joint of the PTO drive shaft

Note to entry 1: See Figure 1, key 20 – only shown as an example

**3.10****fully enclosed guard cone**

guard on PIC side of the PTO drive shaft covering the universal or wide-angle universal joint, including its locking system and the PIC of the recipient machinery, and which also includes other devices, if any (e.g. torque limiter, overrun device)

Note to entry 1: See Figure 2, key 4 – only shown as an example

**3.11****PTO drive shaft guard**

guard attached to the PTO drive shaft by bearings, designed to be able to be held stationary by a restraining system while the shaft is rotating

Note to entry 1: See Figure 1, keys 24 and 25 – only shown as an example.

SIST EN 12965:2020

<https://standards.itech.ai/catalog/standards/sist/07161da4-8a90-4258-9e2c-fc03bd7f3c9f/sist-en-12965-2020>

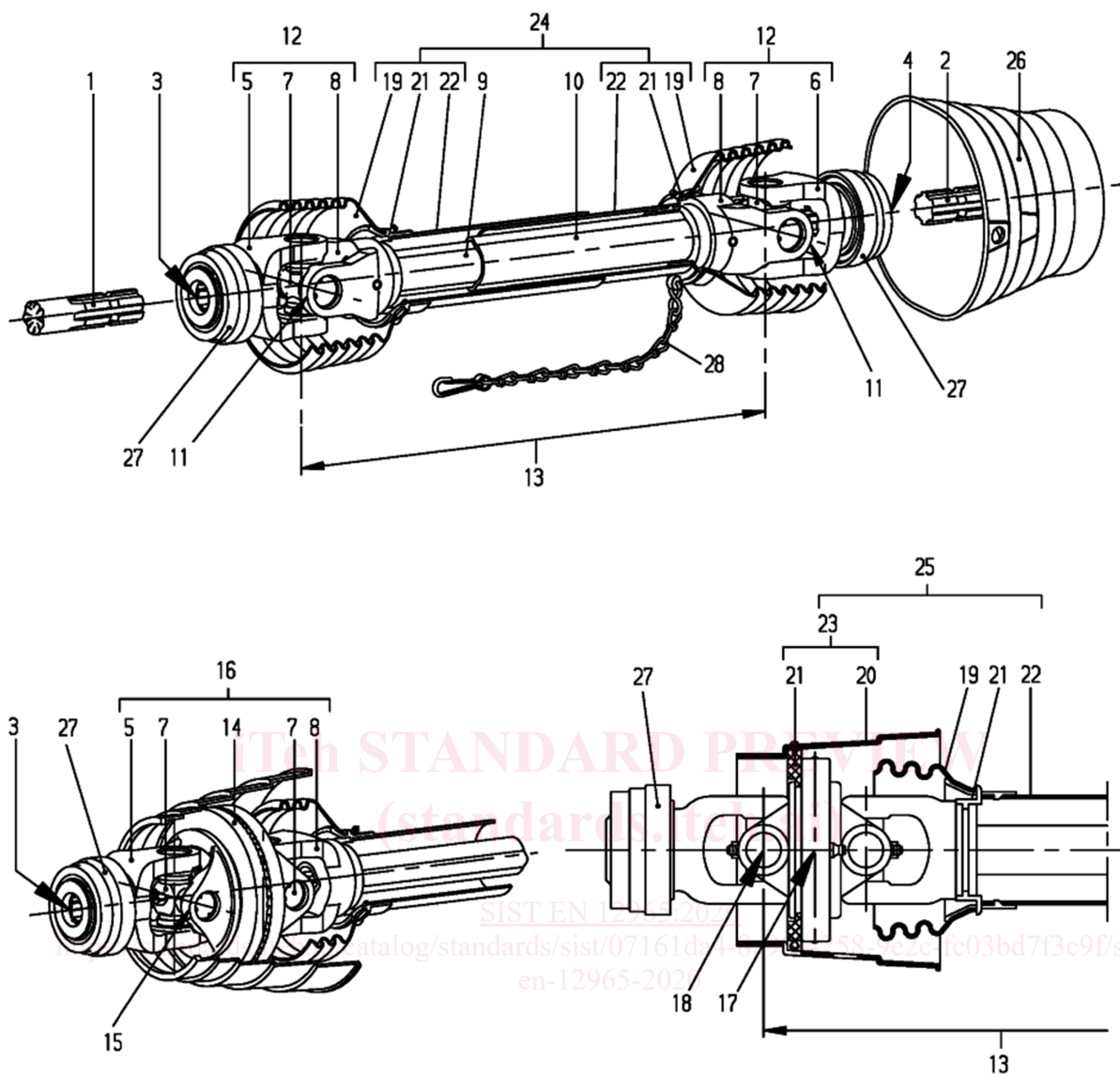

### Key

1	power take off shaft (PTO)	15	end of double yoke of outer joint
2	power-input connection (PIC)	16	wide-angle universal joint
3	PTO yoke bore	17	centre of articulation of wide-angle universal joint
4	PIC yoke bore	18	centre of outer joint
5	PTO yoke	19	guard cone
6	PIC yoke	20	wide angle guard cone
7	journal cross-assembly	21	guard bearing
8	inner yoke	22	guard tube
9	inner telescopic member	23	separate guard of wide angle universal joint
10	outer telescopic member	24	PTO drive shaft guard
11	end of inner yoke of universal joint	25	PTO drive shaft guard (in case of wide-angle PTO drive shaft)
12	universal joint	26	PIC guard
13	PTO drive shaft, closed and extended length	27	locking system
14	double yoke	28	restraining system (as an example)

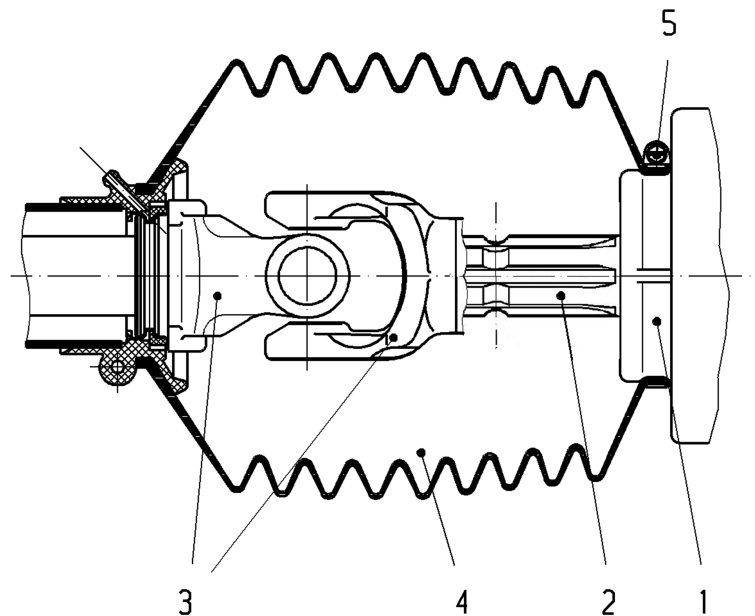
**Figure 1 — Example of PTO drive shaft and guard****Key**

- |                   |                                |
|-------------------|--------------------------------|
| 1 implement       | 4 fully enclosed guard cone    |
| 2 PIC             | 5 clamping device on implement |
| 3 universal joint |                                |

**Figure 2 — Example of fully enclosed guard cone**

## 4 Safety requirements and/or measures

### 4.1 General requirements

The PTO drive shafts and their guards shall comply with the safety requirements and/or protective measures of this clause. In addition, the PTO drive shafts and their guards shall be designed according to the principles of EN ISO 12100:2010 for hazards relevant but not significant, which are not dealt with by this standard (e.g. thermal hazards).

Concerning the guards between the outer ends of the guard cones, unless otherwise specified in this standard, all the apertures and safety distances shall comply with the requirements given in EN ISO 13857:2008, Table 4.

The list of significant hazards dealt with in this standard is given in Annex A.

PTO drive shaft guards, together with PTO master shield (referred in ISO 500-1) and PIC guard, shall be designed to prevent contact with the moving components of the PTO drive shaft when the PTO drive shaft is operated in accordance with the operator's manual and the PTO drive shaft is connected in the appropriate way between a tractor or self-propelled machine and a recipient machine.

The outside parts of the guard shall not turn with the transmission shaft.

If there is a torque limiter and/or an overrun device on the PTO drive shaft it shall be positioned only on the PIC side of the PTO drive shaft. Relevant marking shall be provided (see 6.2).

If guards have movable parts (e.g. hinged) they shall comply with EN 15811.

## prEN 12965:2018 (E)

In the operator's manual (see 6.1), the manufacturer shall provide recommendations for proper application and any information limiting the use of the PTO drive shaft and its guards (see 6.1, d)), including operating data and warnings against misuse. Information about requirements of the support (e.g. form, type, position etc.) for the PTO drive shaft (see 6.1, f)) and the restraining system (see 6.1, j)), shall also be provided. A safety sign illustrating the need to read the operator's manual shall be provided on the PTO drive shaft guard (see 6.2).

Information on how to modify the PTO drive shaft length shall be included in the operator's manual (see 6.1 b)).

## 4.2 Overlap on PTO side

Note For overlap of the PTO drive shaft guard with the power input connection (PIC) guard see EN ISO 4254-1:2015, 6.4.1.

### 4.2.1 Universal joint

The PTO drive shaft guard cone shall cover the PTO drive shaft at least up to the end of the inner yoke of the universal joint in order to ensure sufficient overlap between tractor master shield and PTO drive shaft guard (Figure 1). For this purpose the values for dimension  $c$ , distance between axis of locking system and end of guard cone as shown in Figure 3, as given in Table 1 shall be met.

The dimension,  $c$ , shall be measured in straight line position of the PTO drive shaft.

**Table 1 — Dimension  $c$  for PTO drive shaft**

Dimensions in millimetres

PTO type according to ISO 500-3	$c_{\text{max.}}$
1	80
2	80
3	90
4	110

NOTE The overlap of minimum 50 mm of the PTO drive shaft guard with the PTO master shield results from ISO 500-1 and ISO 500-3.