



SLOVENSKI STANDARD
kSIST FprEN 14296:2015
01-marec-2015

Sanitarna oprema - Skupinska umivalna korita

Sanitary appliances - Communal washing troughs

Sanitärausstattungsgegenstände - Reihenwaschanlagen

Appareils sanitaires - Lavabos collectifs

Ta slovenski standard je istoveten z: FprEN 14296

ICS:

91.140.70 Sanitarne naprave Sanitary installations

kSIST FprEN 14296:2015 **en,fr,de**

EUROPEAN STANDARD
NORME EUROPÉENNE
EUROPÄISCHE NORM

FINAL DRAFT
FprEN 14296

November 2014

ICS 91.140.70

Will supersede EN 14296:2005

English Version

Sanitary appliances - Communal washing troughs

Appareils sanitaires - Lavabos collectifs

SanitärAusstattungsgegenstände - Reihenwaschanlagen

This draft European Standard is submitted to CEN members for unique acceptance procedure. It has been drawn up by the Technical Committee CEN/TC 163.

If this draft becomes a European Standard, CEN members are bound to comply with the CEN/CENELEC Internal Regulations which stipulate the conditions for giving this European Standard the status of a national standard without any alteration.

This draft European Standard was established by CEN in three official versions (English, French, German). A version in any other language made by translation under the responsibility of a CEN member into its own language and notified to the CEN-CENELEC Management Centre has the same status as the official versions.

CEN members are the national standards bodies of Austria, Belgium, Bulgaria, Croatia, Cyprus, Czech Republic, Denmark, Estonia, Finland, Former Yugoslav Republic of Macedonia, France, Germany, Greece, Hungary, Iceland, Ireland, Italy, Latvia, Lithuania, Luxembourg, Malta, Netherlands, Norway, Poland, Portugal, Romania, Slovakia, Slovenia, Spain, Sweden, Switzerland, Turkey and United Kingdom.

Recipients of this draft are invited to submit, with their comments, notification of any relevant patent rights of which they are aware and to provide supporting documentation.

Warning : This document is not a European Standard. It is distributed for review and comments. It is subject to change without notice and shall not be referred to as a European Standard.



EUROPEAN COMMITTEE FOR STANDARDIZATION
COMITÉ EUROPÉEN DE NORMALISATION
EUROPÄISCHES KOMITEE FÜR NORMUNG

CEN-CENELEC Management Centre: Avenue Marnix 17, B-1000 Brussels

Contents

	Page
Foreword.....	3
1 Scope	4
2 Normative references	4
3 Terms and definitions	4
4 Requirements	4
4.1 General.....	4
4.2 Cleanability.....	4
4.3 Load resistance.....	5
4.4 Durability	5
5 Test methods.....	5
5.1 Cleanability.....	5
5.2 Determination of load resistance	5
5.2.1 General.....	5
5.2.2 Load evenly distributed on the rim	6
5.2.3 Localized load on the rim.....	7
5.2.4 Test on the bottom.....	8
6 Dangerous substances	9
7 Marking	9
8 Assessment and verification of constancy of performance – AVCP	10
8.1 General.....	10
8.2 Type testing.....	10
8.2.1 General.....	10
8.2.2 Test samples, testing and compliance criteria.....	11
8.3 Factory production control (FPC)	11
8.3.1 General.....	11
8.3.2 Equipment	12
8.3.3 Raw materials and components.....	12
8.3.4 Product testing and assessment	12
8.3.5 Non-complying products	12
8.3.6 Corrective action.....	12
Annex ZA (informative) Clauses of this European Standard addressing the provisions of the EU Construction Products Regulation	13
ZA.1 Scope and relevant characteristics	13
ZA.2 Procedure for assessment and verification of constancy of performance (AVCP) of communal washing troughs	13
ZA.2.1 System of AVCP.....	13
ZA.2.2 Declaration of performance (DoP)	14
ZA.3 CE marking and labelling.....	19
Bibliography	21

Foreword

This document (FprEN 14296:2014) has been prepared by Technical Committee CEN/TC 163 “Sanitary appliances”, the secretariat of which is held by UNI.

This document is currently submitted to the Unique Acceptance Procedure.

This document will supersede EN 14296:2005.

This document has been prepared under a mandate given to CEN by the European Commission and the European Free Trade Association, and supports essential requirements of the EU Construction Products Regulation.

For relationship with EU Construction Products Regulation, see informative Annex ZA, which is an integral part of this document.

Since the latest edition of EN 14296, the most significant technical changes are the following:

- a) introduction of the term “product type”;
- b) introduction of the clause “Dangerous substances”;
- c) modification of the marking of products;
- d) replacement of the clause “Evaluation of conformity” by “Assessment and verification of constancy of performance – AVCP” and replacement of Annex ZA by a new one in accordance with provisions of Regulation 305/2011.

FprEN 14296:2014 (E)

1 Scope

This document specifies requirements for the cleanability, load resistance and durability of communal washing troughs used for domestic purposes.

NOTE For the purposes of this document, the term “domestic purposes” includes use in factory changing-rooms, sportsclubs, accommodation for students, hospitals and similar buildings, except when special medical provisions are required.

2 Normative references

The following documents, in whole or in part, are normatively referenced in this document and are indispensable for its application. For dated references, only the edition cited applies. For undated references, the latest edition of the referenced document (including any amendments) applies.

EN 695, *Kitchen sinks — Connecting dimensions*

3 Terms and definitions

For the purposes of this document, the following terms and definitions apply.

3.1 communal washing trough
single bowl sanitary appliance at which more than one person can wash at the same time, which is designed to be installed with (a) permanently open waste fitting(s) capable of accepting the flow from more than one tap and which can be installed standing alone (free standing (pedestal)) or wall mounted

3.2 cleanability
characteristics which allow surfaces intended to come into contact with water to be visibly smooth, non-absorbent and free from unacceptable internal corners, such that they can be kept visibly free from dirt and/or stains when subject to a regular maintenance routine, which may include, when appropriate, the specific instructions for use and care as specified by the manufacturer

3.3 product type
construction product with a set of representative performance levels or classes in relation to its Essential Characteristics, produced using a given combination of raw materials or other elements in a specific production process

4 Requirements

4.1 General

The manufacturer shall supply instructions on installation, use and care.

The waste outlet hole shall comply with the dimensions as specified in EN 695, unless the manufacturer provides the waste fitting. with the washing trough.

4.2 Cleanability

When tested as described in 5.1, communal washing troughs shall have smooth and readily cleansed non-absorbent functional surfaces which are free from acute internal corners, i.e. surfaces intended to or likely to come into contact with water during use.

Experience has shown that communal washing troughs manufactured from plastics, enamelled steel/cast iron, stainless steel, glazed ceramics, glass and anodized aluminium, designed and constructed without acute internal corners, satisfy these requirements.

4.3 Load resistance

Communal washing troughs shall not crack, collapse or show permanent distortion which prevents water from draining through the waste hole when tested as specified in 5.2.2 and 5.2.4.

Communal washing troughs shall not crack, or collapse when tested as specified in 5.2.3.

4.4 Durability

Communal washing troughs shall be manufactured from materials that will satisfy the requirements of 4.2 and 4.3.

5 Test methods

5.1 Cleanability

Visually examine the functional surface of the communal washing trough using a suitable light source. Record the material of construction and any failure to comply with the requirements of 4.2.

Imperfections that do not affect the functionality of the surface shall not constitute a failure.

5.2 Determination of load resistance

5.2.1 General

Install the communal washing trough to be tested according to the manufacturer's installation instructions.

FprEN 14296:2014 (E)

5.2.2 Load evenly distributed on the rim

Apply an evenly distributed load of $25^{+0,5}_0$ kg every 50 cm on the rim, as shown in Figures 1 a), 1 b), 1 c) and 1 d). Reinforced cloth bags filled with lead shot, iron shot or sand shall be used. The load shall remain in position for a minimum period of 1 h.

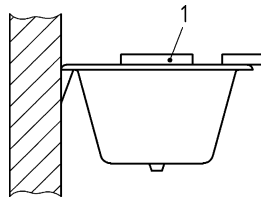

a) Wall mounted trough, viewed from the side

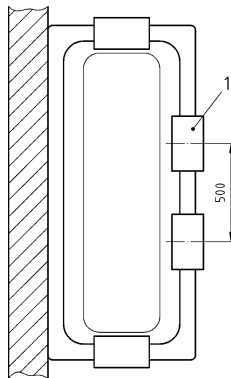

b) Wall mounted trough, viewed from above

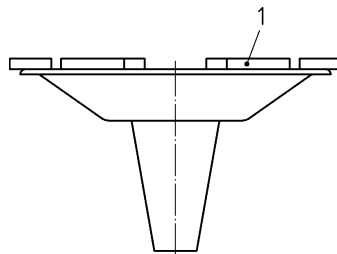

c) Free standing trough, viewed from the side

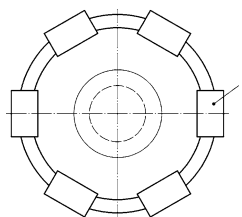

d) Free standing trough, viewed from above

Key

1 one bag of $25^{+0,5}_0$ kg or two bags of $12,5^{+0,25}_0$ kg

Figure 1 — Installation for load test - Test on the rim

Note any crack, collapse or permanent distortion preventing water from draining through the waste hole.