

Second edition
2007-02-01

Corrected version
2007-03-15

**Tools for moulding — Guide pillars,
straight and shouldered, and locating
guide pillars, shouldered**

*Outils de moulage — Colonnes de guidage, droites et épaulées,
et épaulées avec plot de centrage*

iTeh STANDARD PREVIEW
(standards.iteh.ai)

[ISO 8017:2007](#)

<https://standards.iteh.ai/catalog/standards/sist/7a488605-c43f-4672-83fe-6ee6664554dc/iso-8017-2007>



Reference number
ISO 8017:2007(E)

© ISO 2007

PDF disclaimer

This PDF file may contain embedded typefaces. In accordance with Adobe's licensing policy, this file may be printed or viewed but shall not be edited unless the typefaces which are embedded are licensed to and installed on the computer performing the editing. In downloading this file, parties accept therein the responsibility of not infringing Adobe's licensing policy. The ISO Central Secretariat accepts no liability in this area.

Adobe is a trademark of Adobe Systems Incorporated.

Details of the software products used to create this PDF file can be found in the General Info relative to the file; the PDF-creation parameters were optimized for printing. Every care has been taken to ensure that the file is suitable for use by ISO member bodies. In the unlikely event that a problem relating to it is found, please inform the Central Secretariat at the address given below.

iTeh STANDARD PREVIEW
(standards.iteh.ai)

[ISO 8017:2007](#)

<https://standards.iteh.ai/catalog/standards/sist/7a488605-c43f-4672-83fe-6ee6664554dc/iso-8017-2007>

© ISO 2007

All rights reserved. Unless otherwise specified, no part of this publication may be reproduced or utilized in any form or by any means, electronic or mechanical, including photocopying and microfilm, without permission in writing from either ISO at the address below or ISO's member body in the country of the requester.

ISO copyright office
Case postale 56 • CH-1211 Geneva 20
Tel. + 41 22 749 01 11
Fax + 41 22 749 09 47
E-mail copyright@iso.org
Web www.iso.org

Published in Switzerland

Foreword

ISO (the International Organization for Standardization) is a worldwide federation of national standards bodies (ISO member bodies). The work of preparing International Standards is normally carried out through ISO technical committees. Each member body interested in a subject for which a technical committee has been established has the right to be represented on that committee. International organizations, governmental and non-governmental, in liaison with ISO, also take part in the work. ISO collaborates closely with the International Electrotechnical Commission (IEC) on all matters of electrotechnical standardization.

International Standards are drafted in accordance with the rules given in the ISO/IEC Directives, Part 2.

The main task of technical committees is to prepare International Standards. Draft International Standards adopted by the technical committees are circulated to the member bodies for voting. Publication as an International Standard requires approval by at least 75 % of the member bodies casting a vote.

Attention is drawn to the possibility that some of the elements of this document may be the subject of patent rights. ISO shall not be held responsible for identifying any or all such patent rights.

ISO 8017 was prepared by Technical Committee ISO/TC 29, *Small tools*, Subcommittee SC 8, *Tools for pressing and moulding*.

This second edition cancels and replaces the first edition (ISO 8017:1985), of which it constitutes a minor revision. In particular, the references given in Clause 2, which are not mentioned in the text, have been listed in a Bibliography, and the indication of surface textures has been updated in accordance with ISO 1302:2002.

This corrected version incorporates the following correction:

- It corrects an error of reproduction in Figure 3, whereby the subscript became separated from the main symbol in dimension L_1 .

iTeh STANDARD PREVIEW
(standards.iteh.ai)

ISO 8017:2007

<https://standards.iteh.ai/catalog/standards/sist/7a488605-c43f-4672-83fe-6ee6664554dc/iso-8017-2007>

Tools for moulding — Guide pillars, straight and shouldered, and locating guide pillars, shouldered

1 Scope

This International Standard specifies the dimensions and tolerances, in millimetres, for headed, straight and shouldered guide pillars and shouldered locating guide pillars intended for use in moulds.

2 Dimensions

2.1 Guide pillars, straight — Type A

The dimensions of straight guide pillars of type A shall conform to the indications of Figure 1 and Table 1.

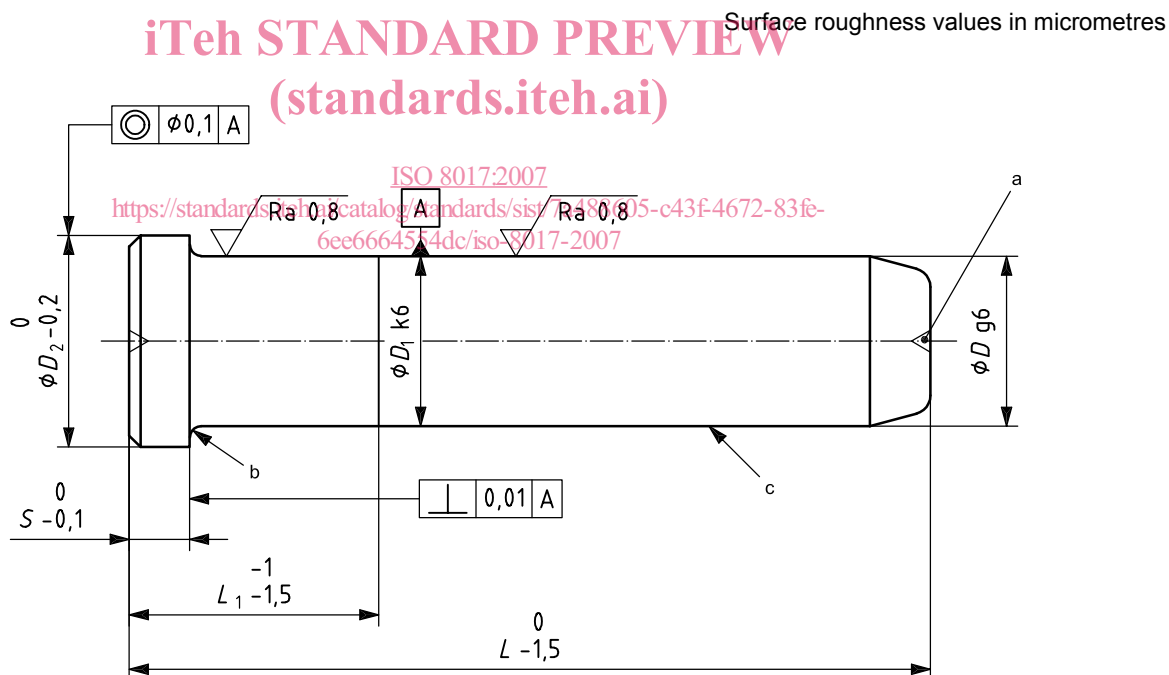

NOTE The sketch is an example only.

Key

- a Optional centre holes.
- b Blending radius or a recess.
- c Recess if required.

Figure 1 — Guide pillars, straight — Type A

Table 1 — Dimensions of guide pillars, straight — Type A

D^a	12		16		20			25			32		40		50							
D_1^a	16		20		25			32			40		48		56							
S	4		6		6			6			8		8		8							
L	L_1																					
	20	25	32	25	32	40	25	32	40	50	25	32	40	50	40	50	50	63	80	63	80	100
40	x																					
50	x			x			x				x											
63	x			x			x				x											
80		x		x			x				x											
90		x		x			x					x			x							
100		x		x			x					x			x							
125			x		x			x					x		x							
160			x		x				x				x			x	x				x	
200						x			x				x		x	x					x	
250										x				x		x		x			x	
315																		x			x	
400																			x			x

ISO 8017:2007

^a For use in exceptional cases, for instance, to prevent incorrect assembly of the upper and lower plates of the mould in relation to each other, the following additional values for diameters D and D_1 are recommended: 11, 15, 19, 24, 30, 38 and 48.

2.2 Guide pillars, shouldered – Type B

The dimensions of shouldered guide pillars of type B shall conform to the indications of Figure 2 and Table 2.

Surface roughness values in micrometres

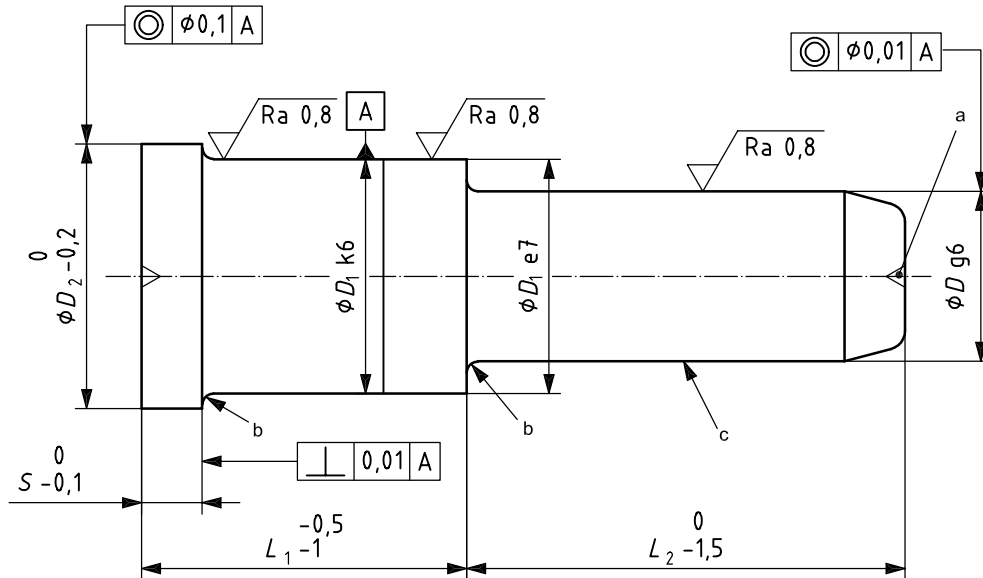

NOTE The sketch is an example only.

iTeh STANDARD PREVIEW
(standards.iteh.ai)

Key

- a Optional centre holes.
- b Blending radius or a recess.
- c Recess if required.

ISO 8017:2007

<https://standards.iteh.ai/catalog/standards/sist/7a488605-c43f-4672-83fe-6ee6664554dc/iso-8017-2007>

Figure 2 — Guide pillars, shouldered — Type B

Table 2 — Dimensions of guide pillars, shouldered — Type B

D^a	12					16					20					25									
D_1	18					22					28					32									
D_2	22					26					32					36									
S	4					6					6					6									
L_2	L_1																								
	16	20	25	32	40	50	25	32	40	50	63	80	32	40	50	63	80	100	32	40	50	63	80	100	125
25	x	x	x																						
32	x	x	x	x	x	x																			
40	x	x	x	x	x	x	x	x	x	x	x	x	x	x	x				x	x	x				
50	x	x	x	x	x	x	x	x	x	x	x	x	x	x	x	x			x	x	x	x			
63	x	x	x	x	x	x	x	x	x	x	x	x	x	x	x	x	x	x	x	x	x	x	x	x	
80							x	x	x	x	x	x	x	x	x	x	x	x	x	x	x	x	x	x	x
100										x	x	x	x	x	x	x	x	x	x	x	x	x	x	x	x
125																		x	x			x	x	x	x
160																									
200																									

iTeh STANDARD PREVIEW
(standards.itech.ai)

D^a	32								40								50							
D_1	40								50								63							
D_2	45								56								71							
S	8								8								8							
L_2	L_1																							
	40	50	63	80	100	125	160	63	80	100	125	160	80	100	125	160	200							
25																								
32																								
40																								
50																								
63	x	x	x	x	x				x	x														
80	x	x	x	x	x	x			x	x								x						
100	x	x	x	x	x	x	x	x	x	x	x	x	x	x	x	x	x	x	x	x	x	x	x	x
125		x	x	x	x	x	x	x	x	x	x	x	x	x	x	x	x	x	x	x	x	x	x	x
160		x	x	x	x	x	x	x	x	x	x	x	x	x	x	x	x	x	x	x	x	x	x	x
200																		x	x	x	x	x	x	x

^a For use in exceptional cases, for instance, to prevent incorrect assembly of the upper and lower plates of the mould in relation to each other, the following additional values for diameter D are recommended: 11, 15, 19, 24, 30, 38 and 48.

2.3 Guide pillars, shouldered locating — Type C

The dimensions of shouldered locating guide pillars of type C, shall conform to the indications of Figure 3 and Table 3.

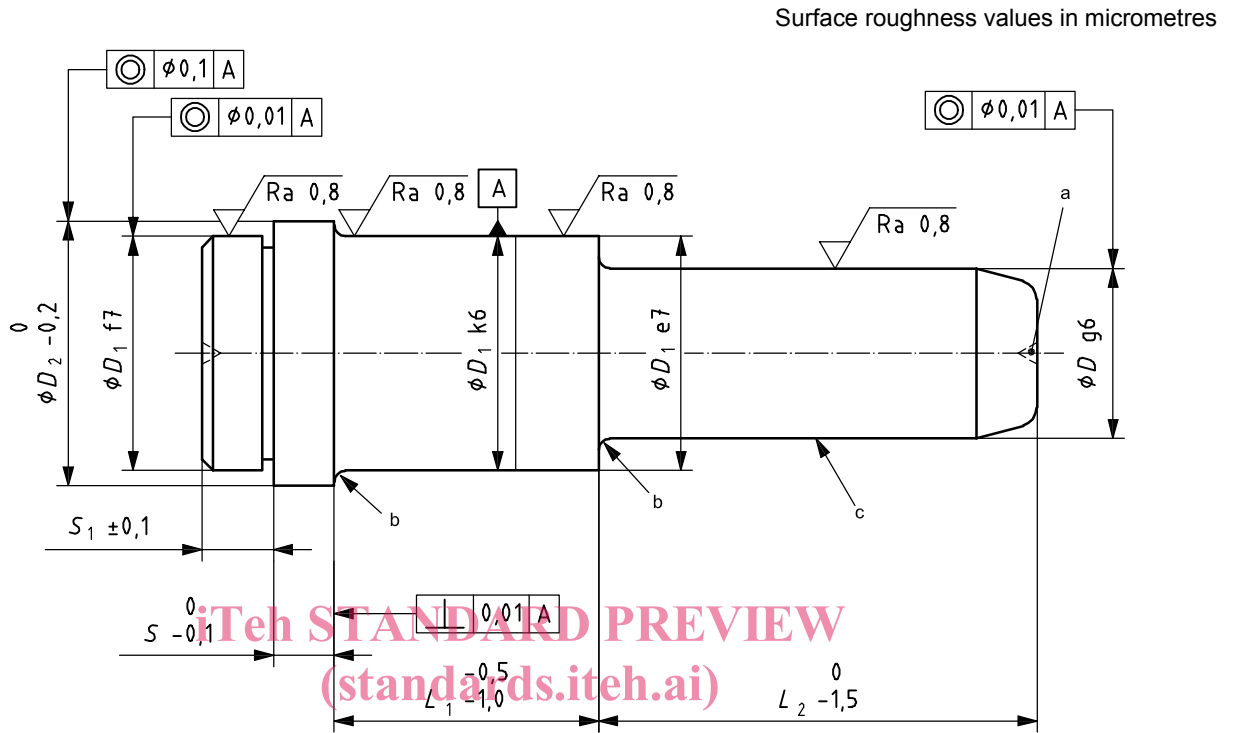

NOTE The sketch is an example only. <https://standards.iteh.ai/catalog/standards/sist/7a488605-c43f-4672-83fe-6ee6664554dc/iso-8017-2007>

Key

- a Optional centre holes.
- b Blending radius or a recess.
- c Recess if required.

Figure 3 — Guide pillars, shouldered locating — Type C