**Rubber — Determination of adhesion to
rigid materials using conical shaped
parts**

*Caoutchouc — Détermination de l'adhérence aux matériaux rigides au
moyen de pièces coniques*

iTeh STANDARD PREVIEW
(standards.iteh.ai)

[ISO 5600:2007](https://standards.iteh.ai/catalog/standards/sist/d168f4a9-74b5-439a-90d7-5815010d1fc0/iso-5600-2007)

<https://standards.iteh.ai/catalog/standards/sist/d168f4a9-74b5-439a-90d7-5815010d1fc0/iso-5600-2007>



PDF disclaimer

This PDF file may contain embedded typefaces. In accordance with Adobe's licensing policy, this file may be printed or viewed but shall not be edited unless the typefaces which are embedded are licensed to and installed on the computer performing the editing. In downloading this file, parties accept therein the responsibility of not infringing Adobe's licensing policy. The ISO Central Secretariat accepts no liability in this area.

Adobe is a trademark of Adobe Systems Incorporated.

Details of the software products used to create this PDF file can be found in the General Info relative to the file; the PDF-creation parameters were optimized for printing. Every care has been taken to ensure that the file is suitable for use by ISO member bodies. In the unlikely event that a problem relating to it is found, please inform the Central Secretariat at the address given below.

iTeh STANDARD PREVIEW
(standards.iteh.ai)

[ISO 5600:2007](#)

<https://standards.iteh.ai/catalog/standards/sist/d168f4a9-74b5-439a-90d7-5815010d1fc0/iso-5600-2007>



COPYRIGHT PROTECTED DOCUMENT

© ISO 2007

All rights reserved. Unless otherwise specified, no part of this publication may be reproduced or utilized in any form or by any means, electronic or mechanical, including photocopying and microfilm, without permission in writing from either ISO at the address below or ISO's member body in the country of the requester.

ISO copyright office
Case postale 56 • CH-1211 Geneva 20
Tel. + 41 22 749 01 11
Fax + 41 22 749 09 47
E-mail copyright@iso.org
Web www.iso.org

Published in Switzerland

Foreword

ISO (the International Organization for Standardization) is a worldwide federation of national standards bodies (ISO member bodies). The work of preparing International Standards is normally carried out through ISO technical committees. Each member body interested in a subject for which a technical committee has been established has the right to be represented on that committee. International organizations, governmental and non-governmental, in liaison with ISO, also take part in the work. ISO collaborates closely with the International Electrotechnical Commission (IEC) on all matters of electrotechnical standardization.

International Standards are drafted in accordance with the rules given in the ISO/IEC Directives, Part 2.

The main task of technical committees is to prepare International Standards. Draft International Standards adopted by the technical committees are circulated to the member bodies for voting. Publication as an International Standard requires approval by at least 75 % of the member bodies casting a vote.

Attention is drawn to the possibility that some of the elements of this document may be the subject of patent rights. ISO shall not be held responsible for identifying any or all such patent rights.

ISO 5600 was prepared by Technical Committee ISO/TC 45, *Rubber and rubber products*, Subcommittee SC 2, *Testing and analysis*.

This third edition cancels and replaces the second edition (ISO 5600:1986), which has been revised to update the normative references (ISO 471, ISO 1826 and ISO 4648 have been replaced by ISO 23529). In addition, Subclause 5.5 (test piece conditioning) has been simplified and a number of minor editorial improvements made.

[ISO 5600:2007](https://standards.iteh.ai/catalog/standards/sist/d168f4a9-74b5-439a-90d7-5815010d1fc0/iso-5600-2007)

<https://standards.iteh.ai/catalog/standards/sist/d168f4a9-74b5-439a-90d7-5815010d1fc0/iso-5600-2007>

iTeh STANDARD PREVIEW
(standards.iteh.ai)

ISO 5600:2007

<https://standards.iteh.ai/catalog/standards/sist/d168f4a9-74b5-439a-90d7-5815010d1fc0/iso-5600-2007>

Rubber — Determination of adhesion to rigid materials using conical shaped parts

WARNING — Persons using this International Standard should be familiar with normal laboratory practice. This standard does not purport to address all of the safety problems, if any, associated with its use. It is the responsibility of the user to establish appropriate safety and health practices and to ensure compliance with any national regulatory conditions.

CAUTION — Certain procedures specified in this International Standard may involve the use or generation of substances, or the generation of waste, that could constitute a local environmental hazard. Reference should be made to appropriate documentation on safe handling and disposal after use.

1 Scope

1.1 This International Standard specifies a method for the determination of the static vulcanized adhesion strength of rubber compounds to rigid materials. The test piece is composed of two conical ends of the rigid material, joined by a cylinder of rubber.

1.2 The adhesion is obtained by a bonding system which can include not only the rigid material and the rubber compound, but other elements such as thin alloy coatings or chemical treatments of rigid parts and either a single cement or both primer and cover cements. The bonding system for preparing the test pieces should be adequately specified by the user, but provision is made in this International Standard for the evaluation of different types of failure related to a complex bonding system.

1.3 The method is designed primarily for test pieces prepared in the laboratory under standard conditions in order to provide data for development and control of bonding systems and their components, such as cements or special rubber compounds, and of methods of manufacture. While intended to be applied where the rubber is bonded to rigid supporting pieces, it might not cover such cases where the support, although of high-modulus material, has a low rigidity due to small transverse dimensions, as in the case of rubber bonded to metal wires, cords or thin sheets.

2 Normative references

The following referenced documents are indispensable for the application of this document. For dated references, only the edition cited applies. For undated references, the latest edition of the referenced document (including any amendments) applies.

ISO 5893:2002, *Rubber and plastics test equipment — Tensile, flexural and compression types (constant rate of traverse) — Specification*

ISO 23529, *Rubber — General procedures for preparing and conditioning test pieces for physical test methods*

3 Principle

3.1 The test consists in measuring the force required to cause the rupture of a test piece of standard dimensions, comprising a cylinder of rubber bonded to two rigid conical parts.

3.2 The particular geometry of the test piece produces in most cases an interfacial failure between the cylinder of rubber and the conical parts because of a stress concentration at the tip of the cones.

4 Apparatus

4.1 **Tensile-testing machine**, complying with the requirements of ISO 5893:2002, class 2, and with a rate of traverse of the moving grip of (50 ± 5) mm/min.

NOTE Inertia (pendulum) type dynamometers have a tendency to give results which differ because of inertial effects. A low-inertia type dynamometer (for example, using an electronic or optical transducer) gives results which are free from this effect, and is therefore to be preferred.

4.2 **Fixtures**, for holding the test pieces in the test machine, which permit accurate centring of the applied load during the test.

5 Test piece

5.1 Form and dimensions

The standard test piece (see Figure 1) is formed by two rigid cylindrical parts terminated by opposite conical ends, and a cylinder of rubber bonded to the conical ends. The determination of the dimensions of the test piece shall be in accordance with ISO 23529.

The diameter of this cylinder and of the cylindrical portion of the rigid parts shall be $(25 \pm 0,5)$ mm. The distance between the tips of the conical ends shall be (12 ± 1) mm. The half-angle of the cone vertex shall be $45^\circ \pm 1^\circ$ and the tip shall be rounded to a radius not greater than 0,8 mm.

The cylindrical portion of each rigid part shall be not less than 5 mm in length and shall be terminated so as to match with the holding jaws (4.2) of the test machine (4.1).

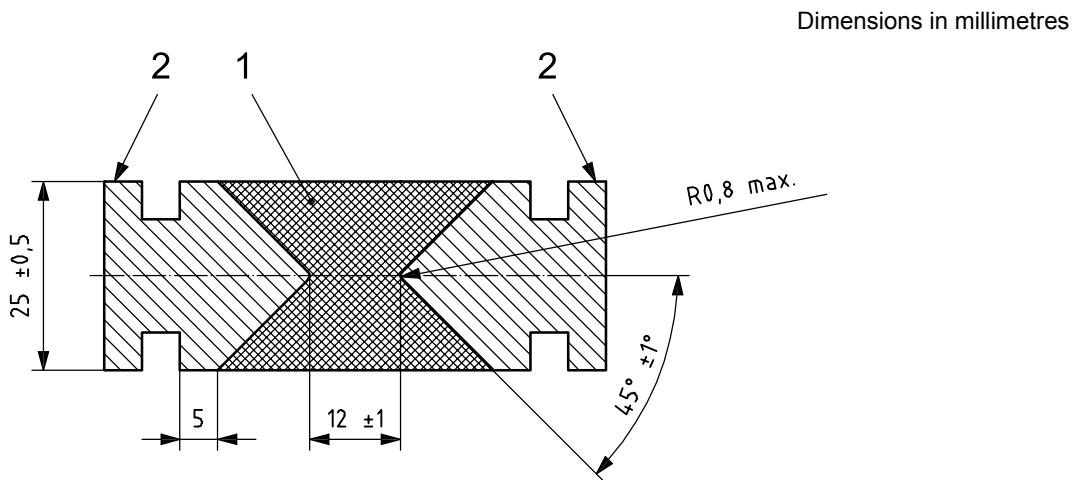

Key

- 1 rubber cylinder
- 2 rigid conical parts

Figure 1 — Standard test piece

5.2 Materials

The materials used shall conform to the specifications for the bonding system to be investigated. If no specification is given for the material of the rigid parts, they shall be made from low-carbon steel bars and their conical ends shall be grit-blasted.

5.3 Preparation

5.3.1 Clean the surfaces of the conical ends or treat in accordance with the bonding system under investigation and, if so specified, coat with primer and/or cover cement. Spread the adhesive coating over the conical area only.

5.3.2 During the preparation of the test pieces, take great care when handling the materials to keep the bonding interfaces between the rubber and the rigid parts free from dust, moisture and foreign matter. Do not touch the treated conical surfaces with the hands during assembly.

5.3.3 Vulcanize the test pieces in a suitable transfer mould, properly insulated and provided with heaters and compression devices. Place the rigid parts and the rubber compound in the preheated mould for vulcanization. Use sufficient unvulcanized compound to fill the pot and provide some excess after filling the mould cavities.

NOTE The mould design should take account of the fact that machining the rigid parts for reuse will gradually reduce their size.

5.3.4 Carry out the vulcanization under the specified conditions of time, temperature and pressure.

5.3.5 At the conclusion of the cure, take great care when removing the test pieces from the mould to avoid subjecting the bonded surfaces to undue stress before the test pieces have cooled.

5.4 Number of test pieces

[ISO 5600:2007](https://standards.iteh.ai/catalog/standards/sist/d168f4a9-74b5-439a-90d7-581581011fc0/iso-5600-2007)

[https://standards.iteh.ai/catalog/standards/sist/d168f4a9-74b5-439a-90d7-](https://standards.iteh.ai/catalog/standards/sist/d168f4a9-74b5-439a-90d7-581581011fc0/iso-5600-2007)

Prepare and test a minimum of three test pieces.

5.5 Conditioning of test pieces

Condition the test pieces in accordance with the requirements of ISO 23529 for at least 16 h at a standard laboratory temperature of $(23 \pm 2) ^\circ\text{C}$ or $(27 \pm 2) ^\circ\text{C}$. Use the same temperature throughout the test and throughout a series of tests intended to be comparable.

6 Procedure

6.1 Mount a test piece in the fixtures (4.2) of the tensile-testing machine (4.1). Take extreme care in centring and adjusting the test piece so that the tension is symmetrically distributed over the cross-section of the test piece during the test.

6.2 Apply the tension by separating the jaws at a constant rate of (50 ± 5) mm/min until the test piece breaks. Record the maximum force.

6.3 Recover the broken pieces and examine the failure surfaces.

6.4 Repeat for the remaining test pieces.

7 Expression of results

7.1 Adhesion value

Express the adhesion value, in newtons, required to produce failure. In cases where the failure is in the rubber bulk, the adhesion value is recognized as being higher than that recorded.

7.2 Type of adhesion failure

Express the type of adhesion failure, as determined by examination of the broken test pieces, by one or more of the following symbols:

- R failure in the rubber bulk;
- RC failure at the rubber/cover cement interface;
- CP failure at the cover cement/primer cement interface;
- M failure at the metal/primer cement interface.

Each symbol shall be followed by the percentage of the conical surface involved in that type of failure, estimated to the nearest 5 %.

NOTE The estimated percentage of the various types of failure can be expressed as in the following examples:

R-50, RC-50 means that roughly 50 % of the failure was in the rubber and the other 50 % at the rubber/cover cement interface.

R-25, RC-25, M-50 means three types of failure were present, with the M indicating that 50 % of the failure was at the metal/primer cement interface.

<https://standards.iteh.ai/catalog/standards/sist/d168f4a9-74b5-439a-90d7-5815010d1fc0/iso-5600-2007>

8 Salvaging of bonded metal parts

Bonded metal parts can be salvaged by the usual burning or chemical stripping techniques. Mechanical or chemical surface treatments can be used to re-establish a clean bonding surface.

The sharpness of the conical tip can be reduced during salvaging; this affects the reproducibility of the test results, and care shall be taken to re-establish the sharpness of the cone to a radius of 0,8 mm or less.

9 Test report

The test report shall include the following information:

- a) sample details:
 - 1) a description of the bonding system used, including materials, treatments and rubber cure (if the materials are of undisclosed composition, sufficient information shall be given to identify them),
 - 2) the date of vulcanization,
 - 3) the time and temperature of vulcanization;
- b) a reference to this International Standard;

- c) test details:
 - 1) the temperature of test,
 - 2) the type of dynamometer used,
 - 3) details of any operation not included in this International Standard or in the International Standards to which reference is made, as well as any operation regarded as optional;
- d) test results:
 - 1) the adhesion values for each test piece, in newtons,
 - 2) a description of the types of failure for each test piece, expressed in accordance with 7.2,
 - 3) any unusual features noted during the determination;
- e) the date of the test.

An example of a form for reporting adhesion test results is given in Table 1.

Table 1 — Form for reporting adhesion test results

Test piece No.	Compound designation	Cure temperature	Cure time	Substrate treatment	Date of vulcanization test	Adhesion value	Type of break				Test temperature	Test equipment	Bonding system	Comments
		°C	min				R	RC	CP	M				