

ISO/TC 195

Secretariat: DIN

Voting begins on:
2012-09-19

Voting terminates on:
2012-11-19

Road construction and maintenance equipment — Road milling machinery — Terminology and commercial specifications

AMENDMENT 1

*Équipement pour la construction et l'entretien des routes —
Fraiseuses — Terminologie et spécifications commerciales*

AMENDEMENT 1

RECIPIENTS OF THIS DRAFT ARE INVITED TO SUBMIT, WITH THEIR COMMENTS, NOTIFICATION OF ANY RELEVANT PATENT RIGHTS OF WHICH THEY ARE AWARE AND TO PROVIDE SUPPORTING DOCUMENTATION.

IN ADDITION TO THEIR EVALUATION AS BEING ACCEPTABLE FOR INDUSTRIAL, TECHNOLOGICAL, COMMERCIAL AND USER PURPOSES, DRAFT INTERNATIONAL STANDARDS MAY ON OCCASION HAVE TO BE CONSIDERED IN THE LIGHT OF THEIR POTENTIAL TO BECOME STANDARDS TO WHICH REFERENCE MAY BE MADE IN NATIONAL REGULATIONS.



Reference number
ISO 15645:2002/FDAM 1:2012(E)

iTeh STANDARD PREVIEW
(standards.iteh.ai)

Full standard:
<https://standards.iteh.ai/catalog/standards/sist/f1856bac-2e06-4e04-a816-73ca6cb77f21/iso-15645-2002-amd-1-2013>

Copyright notice

This ISO document is a Draft International Standard and is copyright-protected by ISO. Except as permitted under the applicable laws of the user's country, neither this ISO draft nor any extract from it may be reproduced, stored in a retrieval system or transmitted in any form or by any means, electronic, photocopying, recording or otherwise, without prior written permission being secured.

Requests for permission to reproduce should be addressed to either ISO at the address below or ISO's member body in the country of the requester.

ISO copyright office
Case postale 56 • CH-1211 Geneva 20
Tel. + 41 22 749 01 11
Fax + 41 22 749 09 47
E-mail copyright@iso.org
Web www.iso.org

Reproduction may be subject to royalty payments or a licensing agreement.

Violators may be prosecuted.

Foreword

ISO (the International Organization for Standardization) is a worldwide federation of national standards bodies (ISO member bodies). The work of preparing International Standards is normally carried out through ISO technical committees. Each member body interested in a subject for which a technical committee has been established has the right to be represented on that committee. International organizations, governmental and non-governmental, in liaison with ISO, also take part in the work. ISO collaborates closely with the International Electrotechnical Commission (IEC) on all matters of electrotechnical standardization.

International Standards are drafted in accordance with the rules given in the ISO/IEC Directives, Part 2.

The main task of technical committees is to prepare International Standards. Draft International Standards adopted by the technical committees are circulated to the member bodies for voting. Publication as an International Standard requires approval by at least 75 % of the member bodies casting a vote.

Attention is drawn to the possibility that some of the elements of this document may be the subject of patent rights. ISO shall not be held responsible for identifying any or all such patent rights.

Amendment 1 to ISO 15645:2002 was prepared by Technical Committee ISO/TC 195, *Building construction machinery and equipment*.

ITeH STANDARD PREVIEW
(standards.iteh.ai)
Full standard:
<https://standards.iteh.ai/catalog/standards/sist/f18566ac-2e06-4e04-a816-73ca6cb77f21/iso-15645-2002-amd-1>
2013

iTeh STANDARD PREVIEW
(standards.iteh.ai)

Full standard:
<https://standards.iteh.ai/catalog/standards/sist/f1856bac-2e06-4e04-a816-73ca6cb77f21/iso-15645-2002-amd-1-2013>

Road construction and maintenance equipment — Road milling machinery — Terminology and commercial specifications

AMENDMENT 1

Page 1, term 2.1

In the definition, replace the word “mill” by “remove” and add the phrase “by a milling action” at the definition’s end.

Page 1, term 2.5

In the term itself, replace the phrase “make a cordon” by the word “windrow”.

In the Note attached to the definition, replace “cordon” by “windrow”.

Page 2, 3.1, General

In the fourth list item, replace “cordon” by “windrow”.

Page 2, 3.2.1, Traction and transport system

Replace the reference to “Figures 1 and 2” by “Figures A.1 and A.2”.

Page 2, 3.2.2, Cutting and milling system

Replace the reference to “Figure 3” by “Figure A.3”.

Page 2, 3.2.4, Layout of tools

Following the word “rotor”, insert the phrase “is application-specific and”.

Replace the reference to “Figure 2” by “Figure A.2”.

Page 2, 3.2.6, System to remove or cordon aggregate materials

In the title of the subclause, replace “cordon” by “windrow”.

Page 3, Clause 4, Commercial specifications

In 4.1.1, replace the reference in the first line to “Figure 1” by “Figure A.1”.

In 4.1.3, add the cross-reference “(see 2.6 for conditions)” at the end of the second list item.

In 4.1.4, in the second list item, insert the word “rated” immediately before, and the reference “(see ISO 14396)” immediately after, “power (kW)”.

In 4.1.5, in the first list item, replace “axles” by “tracks or wheels”.

In 4.1.6, transfer the word “or” from the end of first list item to the end of the second list item; add a third list item, “both”.

4.1.7, delete the word “or” from the first list item.

Page 4, 4.2, Cutting and milling system characteristics

Replace the reference in the first line to “Figures 2 and 3” by “Figures A.2 and A.3”.

Page 5, 4.3, Drum sprinkler device

In the first list item, replace “(m³/min)” by “(l/min)”.

Page 5, 4.4, System to remove or cordon aggregate materials

In the title of the subclause, replace “cordon” by “windrow”.

Page 6, Annex A

Insert an entirely new annex following 4.4, transferring Figures 1 to 3 to it and modifying them, as follows:

- Renumber Figure 1 as Figure A.1 and replace it as shown.

Annex A (informative)

Examples of road milling machine designs and their assemblies

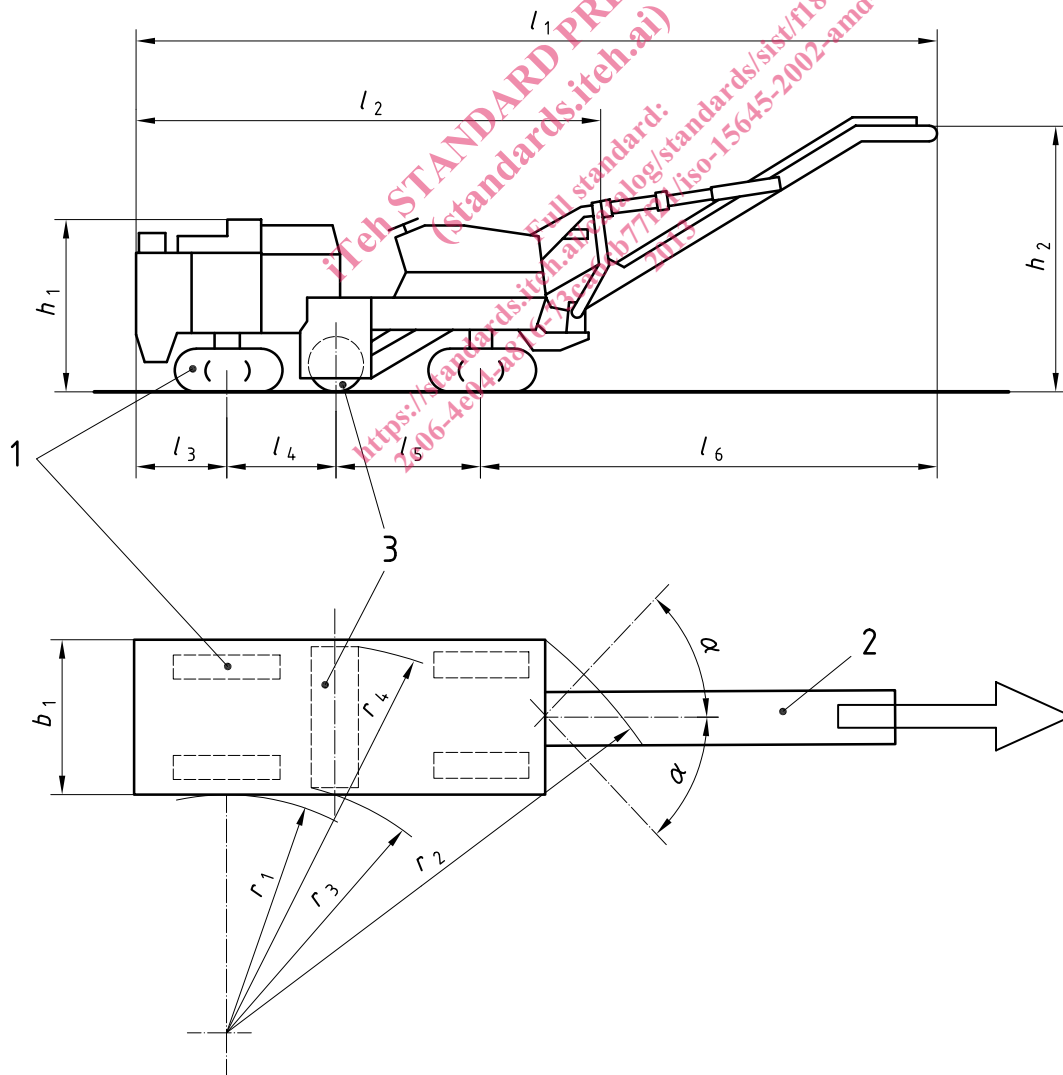

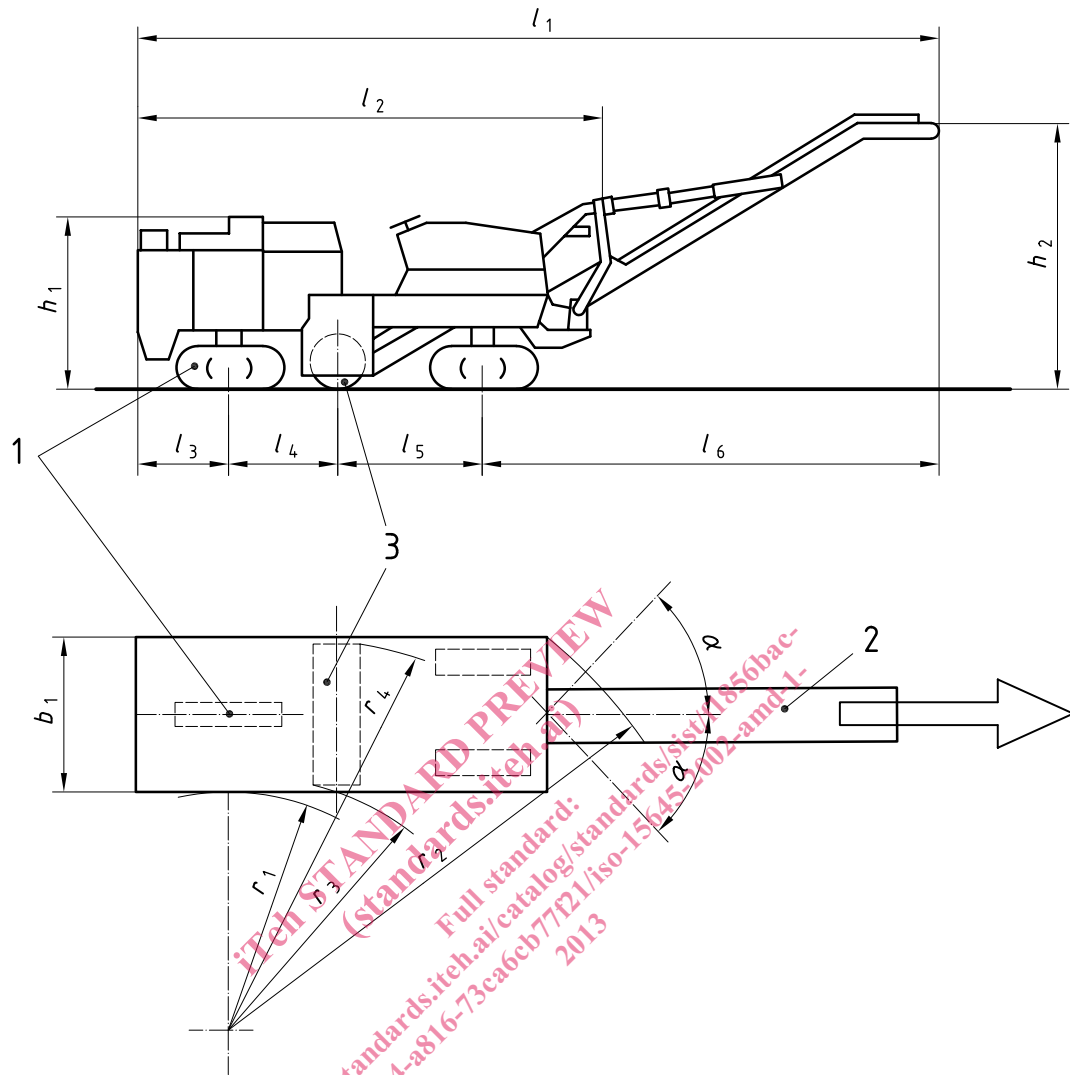

Key

- | | | | |
|-------|--|----------|---|
| 1 | tracks | h_1 | overall height (without removal system) |
| 2 | removal system | h_2 | maximum loading height |
| 3 | rotor | b_1 | overall width (without removal system) |
| l_1 | overall length (with removal system) | r_1 | inside turning radius |
| l_2 | overall length (without removal system) | r_2 | outside turning radius |
| l_3 | rear overhang | r_3 | inside slewing radius of rotor |
| l_4 | distance between rotor axis and rear wheels/tracks axis | r_4 | outside slewing radius of rotor |
| l_5 | distance between rotor axis and front wheels/tracks axis | α | slewing angle of removal system |
| l_6 | maximum front overhang (with removal system) | | |

Figure A.1 — Dimensional characteristics of road milling machines (3 or 4 tracks) with removal system

- Renumber Figure 2 as Figure A.2.
- Renumber Figure 3 as Figure A.3 and change its title to

Figure A.3 — Example of rotor chamber and drum sprinkler device

iTeh STANDARD PREVIEW
(standards.iteh.ai)
Full standard:
<https://standards.iteh.ai/catalog/standards/sist/f1856bac-2e06-4e04-a816-73ca6cb77f21/iso-15645-2002-amd-1-2013>

iTeh STANDARD PREVIEW
(standards.iteh.ai)

Full standard:
<https://standards.iteh.ai/catalog/standards/sist/f1856bac-2e06-4e04-a816-73ca6cb77f21/iso-15645-2002-amd-1-2013>