Dentistry — Coupling dimensions for handpiece connectors

*Médecine bucco-dentaire — Dimensions d'accouplement pour pièces
à main dentaires*

iTeh STANDARD PREVIEW
(standards.iteh.ai)

[ISO 3964:2016](https://standards.iteh.ai/catalog/standards/sist/3f24face-64da-40b5-a35b-e66b8e6e5b7c/iso-3964-2016)

[https://standards.iteh.ai/catalog/standards/sist/3f24face-64da-40b5-a35b-
e66b8e6e5b7c/iso-3964-2016](https://standards.iteh.ai/catalog/standards/sist/3f24face-64da-40b5-a35b-e66b8e6e5b7c/iso-3964-2016)



iTeh STANDARD PREVIEW
(standards.iteh.ai)

ISO 3964:2016

<https://standards.iteh.ai/catalog/standards/sist/3f24face-64da-40b5-a35b-e66b8e6e5b7c/iso-3964-2016>



COPYRIGHT PROTECTED DOCUMENT

© ISO 2016, Published in Switzerland

All rights reserved. Unless otherwise specified, no part of this publication may be reproduced or utilized otherwise in any form or by any means, electronic or mechanical, including photocopying, or posting on the internet or an intranet, without prior written permission. Permission can be requested from either ISO at the address below or ISO's member body in the country of the requester.

ISO copyright office
Ch. de Blandonnet 8 • CP 401
CH-1214 Vernier, Geneva, Switzerland
Tel. +41 22 749 01 11
Fax +41 22 749 09 47
copyright@iso.org
www.iso.org

Contents

Page

Foreword	iv
1 Scope	1
2 Normative references	1
3 Terms and definitions	1
4 Classification	1
5 Requirements	2
5.1 General	2
5.2 Dimensions	2
5.3 Coupling force	10
6 Sampling	10
7 Test methods	10
7.1 Dimensions	10
7.2 Coupling force	11

iTeh STANDARD PREVIEW (standards.iteh.ai)

[ISO 3964:2016](https://standards.iteh.ai/catalog/standards/sist/3f24face-64da-40b5-a35b-e66b8e6e5b7c/iso-3964-2016)

<https://standards.iteh.ai/catalog/standards/sist/3f24face-64da-40b5-a35b-e66b8e6e5b7c/iso-3964-2016>

Foreword

ISO (the International Organization for Standardization) is a worldwide federation of national standards bodies (ISO member bodies). The work of preparing International Standards is normally carried out through ISO technical committees. Each member body interested in a subject for which a technical committee has been established has the right to be represented on that committee. International organizations, governmental and non-governmental, in liaison with ISO, also take part in the work. ISO collaborates closely with the International Electrotechnical Commission (IEC) on all matters of electrotechnical standardization.

The procedures used to develop this document and those intended for its further maintenance are described in the ISO/IEC Directives, Part 1. In particular the different approval criteria needed for the different types of ISO documents should be noted. This document was drafted in accordance with the editorial rules of the ISO/IEC Directives, Part 2 (see www.iso.org/directives).

Attention is drawn to the possibility that some of the elements of this document may be the subject of patent rights. ISO shall not be held responsible for identifying any or all such patent rights. Details of any patent rights identified during the development of the document will be in the Introduction and/or on the ISO list of patent declarations received (see www.iso.org/patents).

Any trade name used in this document is information given for the convenience of users and does not constitute an endorsement.

For an explanation on the meaning of ISO specific terms and expressions related to conformity assessment, as well as information about ISO's adherence to the WTO principles in the Technical Barriers to Trade (TBT) see the following URL: [Foreword - Supplementary information](#).

The committee responsible for this document is ISO/TC 106 *Dentistry*, Subcommittee SC 4 *Dental instruments*.

This third edition cancels and replaces the second edition (ISO 3964:1982), which has been technically revised with the following changes:

- a) addition of definitions for “coupling dimension” and “coupling systems”;
- b) addition of four types for “classification”;
- c) additional types of coupling systems:
 - with and without light supply;
 - with internal and external supply of air and water (spray);
- d) improved technical drawings.

Dentistry — Coupling dimensions for handpiece connectors

1 Scope

This International Standard specifies the coupling between handpieces and motors connected to dental units.

This International Standard specifies the nominal dimensions, tolerances and the extraction force of coupling systems for use between handpiece and motor which supply the handpiece with water, air and light and rotation energy.

2 Normative references

The following documents, in whole or in part, are normatively referenced in this document and are indispensable for its application. For dated references, only the edition cited applies. For undated references, the latest edition of the referenced document (including any amendments) applies.

ISO 1942, *Dentistry — Vocabulary*

ISO 2768-1, *General tolerances — Part 1: Tolerances for linear and angular dimensions without individual tolerance indications*

ISO 2768-2, *General tolerances — Part 2: Geometrical tolerances for features without individual tolerance indications*

ISO 14457, *Dentistry — Handpieces and motors*

3 Terms and definitions

For the purposes of this document, the terms and definitions given in ISO 1942, ISO 14457 and the following apply.

3.1

coupling dimension

description of the dimensions of connectors between air- and electrical motors and straight and angled handpieces, used to connect and supply the handpiece system

3.2

coupling system

combination of connector parts between air- and electrical motors and straight and angled handpieces, used to connect and supply the handpiece system

4 Classification

For the purpose of this International Standard, coupling systems are classified into the following types:

- Type 1: coupling system for straight and angle handpieces and motors without internal spray supply and without light supply;
- Type 2: coupling system for straight and angle handpieces and motors with internal spray supply and without light supply;

- Type 3: coupling system for straight and angle handpieces and motors with internal spray supply and with light supply;
- Type 4: coupling system for straight and angle handpieces and motors without internal spray supply and with light supply.

5 Requirements

5.1 General

Types of the coupling for handpieces and for motors are specific parts of dental handpieces.

Requirements for dental handpieces are specified in ISO 14457.

5.2 Dimensions

The dimensions and the configuration of handpiece-sides and motor-sides shall be as specified in [Figure 1](#), [Figure 2](#), [Figure 3](#), [Figure 4](#), [Figure 5](#), [Figure 6](#), [Figure 7](#) and [Figure 8](#) with coupling dimensions X_1 and X_2 as specified in [Table 1](#).

Table 1 — Coupling dimensions X_1 and X_2

Coupling	Dimension	Long	Middle	Short	Extra short
Motor	X_1	max. 31,8 mm	max. 24,8 mm	max. 22,8 mm	max. 18,8 mm
Handpiece	X_2	min. 32 mm	min. 25 mm	min. 23 mm	min. 19 mm

Dimensions without tolerances shall be in accordance with ISO 2768-1 and ISO 2768-2.

Alternative designs of the coupling lock system are permitted.

The type of handpiece length shall be indicated in the manufacturer's instructions for use.

Testing shall be carried out in accordance with [7.1](#).

Dimensions in millimetres

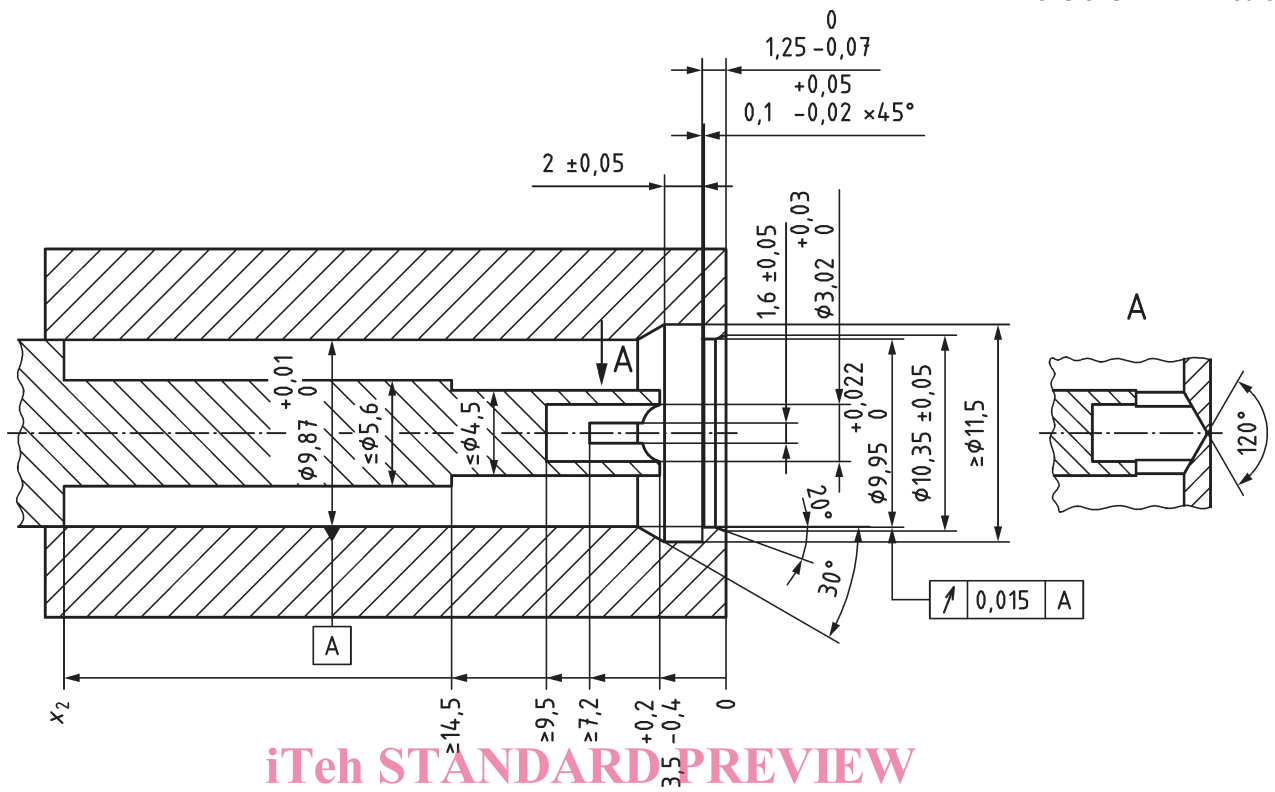

iTeh STANDARD PREVIEW
(standards.iteh.ai)

Edges shall be burr-free or round.

ISO 3964:2016

<https://standards.iteh.ai/en/standards/iso-3964-2016/445445-48b5-a35b-e66b8e6e5b7c/iso-3964-2016>
Figure 1 — Type 1 — Handpiece

Dimensions in millimetres

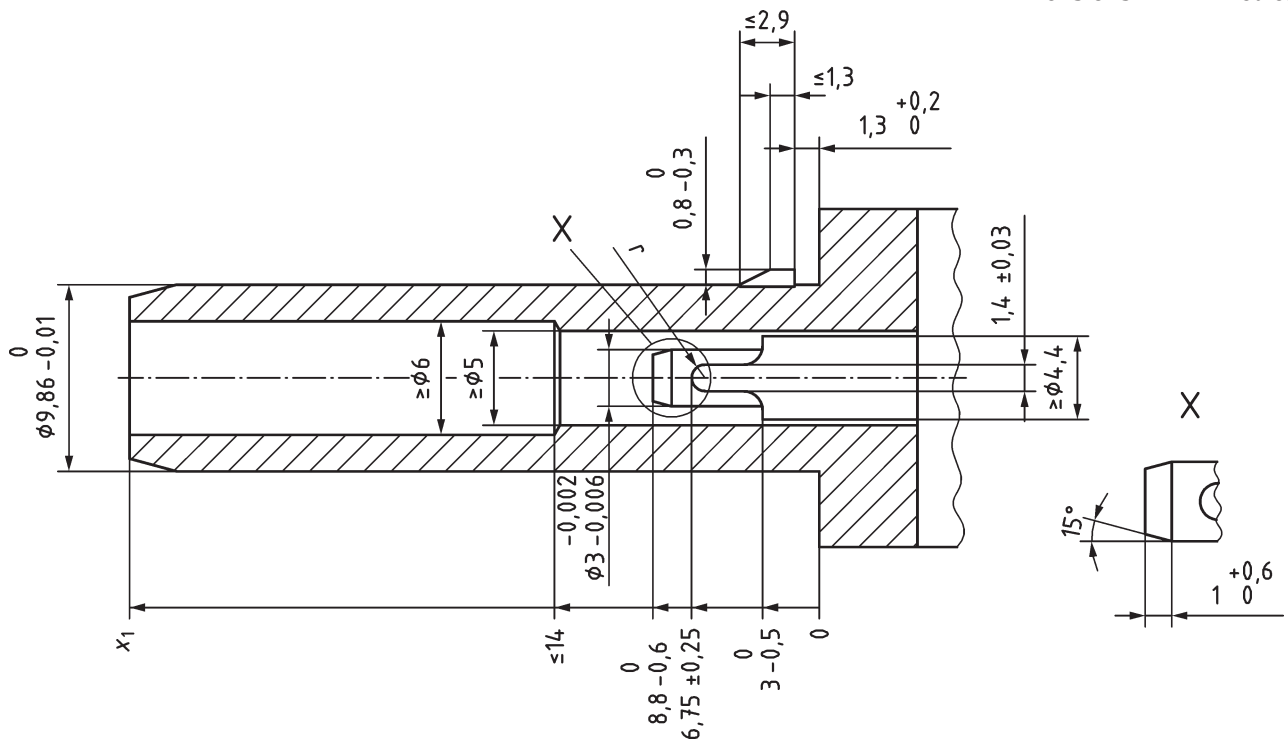

Key

r can either be a radius or a cone shape with the point angle of $\leq 120^\circ$

Edges shall be burr-free or round.

iTeh STANDARD PREVIEW

(standards.iteh.ai)

ISO 3964:2016

Figure 2 — Type 1 — Motor

<https://standards.iteh.ai/catalog/standards/sist/64da-40b5-a35b-e66b8e6e5b7c/iso-3964-2016>

Dimensions in millimetres

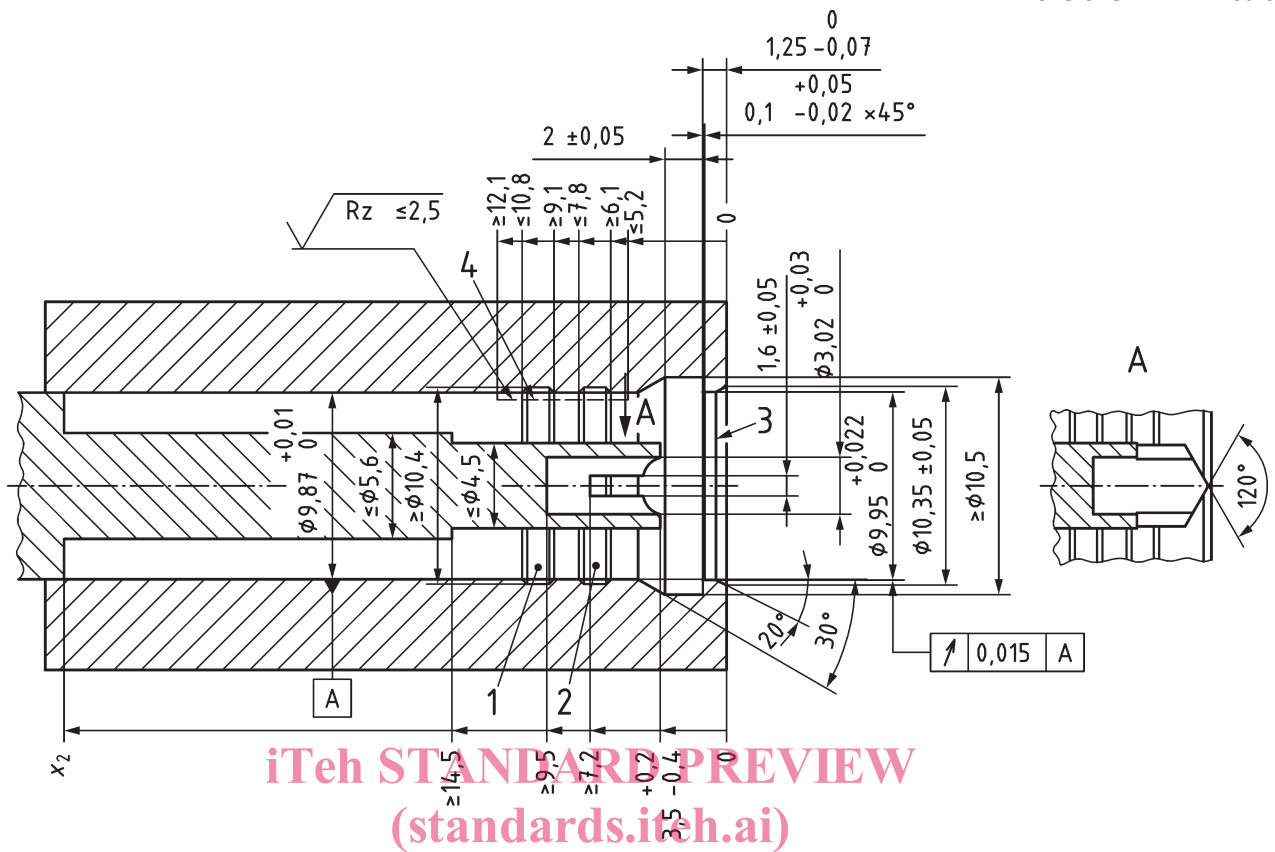

Key

- 1 air
- 2 water
- 3 grooves and geometry for sealing rings given by the manufacturer
- 4 - - - - sealing surface

Edges shall be burr-free or round.

Figure 3 — Type 2 — Handpiece