

ISO/TC 149

Secretariat: DIN

Voting begins on:
2015-09-07

Voting terminates on:
2015-11-07

Cycles — Pedal axle and crank assembly with square end fitting — Assembly dimensions

*Cycles — Axe de pédalier et manivelle à emmanchement carré —
Dimensions d'assemblage*

iTeh STANDARD PREVIEW
(standards.iteh.ai)
Full standard:
<https://standards.iteh.ai/catalog/standards/sist/7661c100-2e44-4564-ba35-aa1138410613/iso-6695-2015>

RECIPIENTS OF THIS DRAFT ARE INVITED TO SUBMIT, WITH THEIR COMMENTS, NOTIFICATION OF ANY RELEVANT PATENT RIGHTS OF WHICH THEY ARE AWARE AND TO PROVIDE SUPPORTING DOCUMENTATION.

IN ADDITION TO THEIR EVALUATION AS BEING ACCEPTABLE FOR INDUSTRIAL, TECHNOLOGICAL, COMMERCIAL AND USER PURPOSES, DRAFT INTERNATIONAL STANDARDS MAY ON OCCASION HAVE TO BE CONSIDERED IN THE LIGHT OF THEIR POTENTIAL TO BECOME STANDARDS TO WHICH REFERENCE MAY BE MADE IN NATIONAL REGULATIONS.



Reference number
ISO/FDIS 6695:2015(E)

iTeh STANDARD PREVIEW
(standards.iteh.ai)
Full standard:
<https://standards.iteh.ai/catalog/standards/sist/7661c1bb-2e44-4564-ba35-aa1138410613/iso-6695-2015>



COPYRIGHT PROTECTED DOCUMENT

© ISO 2015, Published in Switzerland

All rights reserved. Unless otherwise specified, no part of this publication may be reproduced or utilized otherwise in any form or by any means, electronic or mechanical, including photocopying, or posting on the internet or an intranet, without prior written permission. Permission can be requested from either ISO at the address below or ISO's member body in the country of the requester.

ISO copyright office
Ch. de Blandonnet 8 • CP 401
CH-1214 Vernier, Geneva, Switzerland
Tel. +41 22 749 01 11
Fax +41 22 749 09 47
copyright@iso.org
www.iso.org

Contents

	Page
Foreword.....	iv
1 Scope.....	1
2 Dimensions.....	1

iTeh STANDARD PREVIEW
(standards.iteh.ai)
Full standard:
<https://standards.iteh.ai/catalog/standards/sist/7661c1bb-2e44-4564-ba35-aa1138410613/iso-6695-2015>

Foreword

ISO (the International Organization for Standardization) is a worldwide federation of national standards bodies (ISO member bodies). The work of preparing International Standards is normally carried out through ISO technical committees. Each member body interested in a subject for which a technical committee has been established has the right to be represented on that committee. International organizations, governmental and non-governmental, in liaison with ISO, also take part in the work. ISO collaborates closely with the International Electrotechnical Commission (IEC) on all matters of electrotechnical standardization.

The procedures used to develop this document and those intended for its further maintenance are described in the ISO/IEC Directives, Part 1. In particular the different approval criteria needed for the different types of ISO documents should be noted. This document was drafted in accordance with the editorial rules of the ISO/IEC Directives, Part 2 (see www.iso.org/directives).

Attention is drawn to the possibility that some of the elements of this document may be the subject of patent rights. ISO shall not be held responsible for identifying any or all such patent rights. Details of any patent rights identified during the development of the document will be in the Introduction and/or on the ISO list of patent declarations received (see www.iso.org/patents).

Any trade name used in this document is information given for the convenience of users and does not constitute an endorsement.

For an explanation on the meaning of ISO specific terms and expressions related to conformity assessment, as well as information about ISO's adherence to the WTO principles in the Technical Barriers to Trade (TBT) see the following URL: [Foreword - Supplementary information](#).

The committee responsible for this document is ISO/TC 149, *Cycles*.

This second edition cancels and replaces the first edition (ISO 6695:1991), which has been technically revised.

Cycles — Pedal axle and crank assembly with square end fitting — Assembly dimensions

1 Scope

This International Standard specifies the dimensions for the assembly of cranks on bottom bracket spindles with square end fittings.

2 Dimensions

Dimensions for the assembly of cranks on bottom bracket spindles with square end fittings shall be as given in [Figure 1](#) and [Table 1](#).

iTeh STANDARD PREVIEW
(standards.iteh.ai)
Full standard:
<https://standards.iteh.ai/catalog/standards/sist/7661c1bb-2e44-4564-ba35-aa1138410613/iso-6695-2015>

Dimensions in millimetres

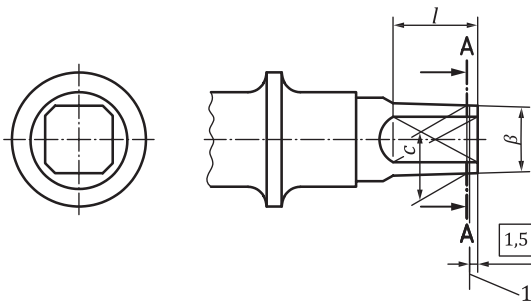

a) Bottom bracket spindle – Square end dimensions

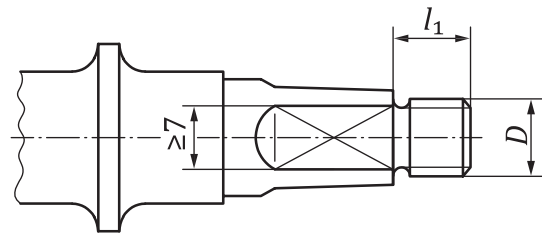

b) Bottom bracket spindle with external thread

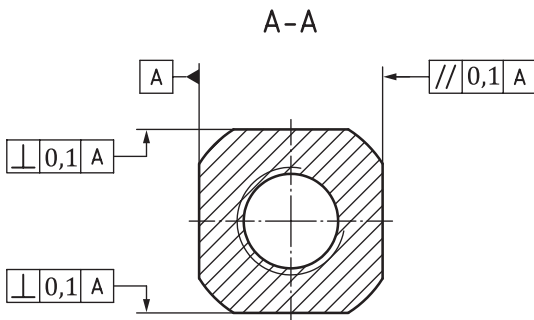

c) Bottom bracket spindle – Cross section A-A

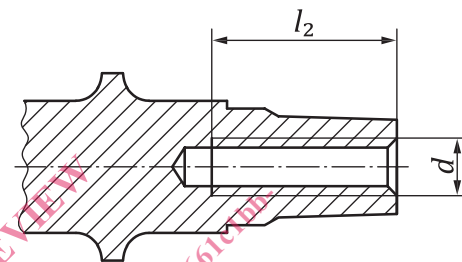

d) Bottom bracket spindle with internal thread

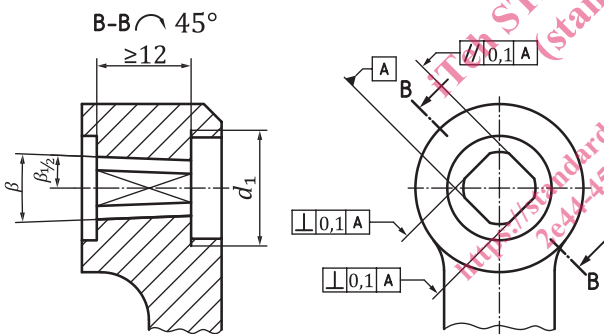

e) Crank

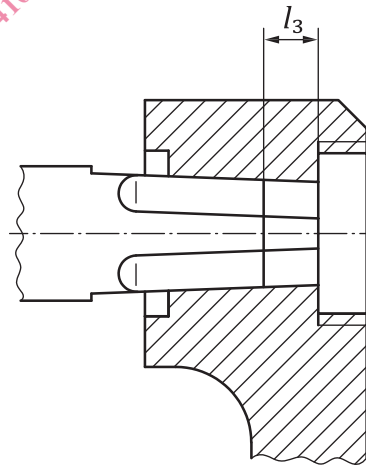

f) Assembly

Key

1 reference plane (section plane)

Figure 1 — Dimensions for the assembly of cranks on bottom bracket spindles with square end fittings

Table 1 — Dimensions and tolerances

Dimensions in millimetres

Spindle									Crank	Assem- bly
<i>l</i>		β	$\beta_{1/2}$	<i>c</i>	<i>D</i>	<i>l</i> ₁	<i>d</i>	<i>l</i> ₂	<i>d</i> ₁	<i>l</i> ₃ ^a
Right side	Left side									
$18,0^{+2}_0$	$18,0^{+2}_0$	$4^{\circ+10}_0$	$2^{\circ+5}_0$	$12,73^{+0,020}_{-0,050}$	M10 × 1,25 -6H/6g	$10^0_{-0,5}$	M8 × 1 -6H/6g	20,0 min.	M22 × 1 -6H/6g	$1,5^{2,0}_0$

^a After tightening once to the supplier's recommended tightening torque.

iTeh STANDARD PREVIEW
 (standards.iteh.ai)
 Full standard:
<https://standards.iteh.ai/catalog/standards/sist/7661c1bb-2e44-4564-ba35-aa1138410613/iso-6695-2015>

iTeh STANDARD PREVIEW
(standards.iteh.ai)

Full standard:
<https://standards.iteh.ai/catalog/standards/sist/7661c1bb-2e44-4564-ba35-aa1138410613/iso-6695-2015>