**Ships and marine technology —
Fire resistance of non-metallic
hose assemblies and non-metallic
compensators — Test methods**

*Navires et technologie maritime — Résistance au feu des flexibles et
des compensateurs non métalliques — Méthodes d'essais*

iTeh STANDARD PREVIEW
(standards.iteh.ai)

[ISO 15540:2016](https://standards.iteh.ai/catalog/standards/sist/531acfaa-0f40-4a9c-a644-f5e9a40f85c8/iso-15540-2016)

[https://standards.iteh.ai/catalog/standards/sist/531acfaa-0f40-4a9c-a644-
f5e9a40f85c8/iso-15540-2016](https://standards.iteh.ai/catalog/standards/sist/531acfaa-0f40-4a9c-a644-f5e9a40f85c8/iso-15540-2016)



iTeh STANDARD PREVIEW
(standards.iteh.ai)

ISO 15540:2016

<https://standards.iteh.ai/catalog/standards/sist/531acfaa-0f40-4a9c-a644-f5e9a40f85c8/iso-15540-2016>



COPYRIGHT PROTECTED DOCUMENT

© ISO 2016, Published in Switzerland

All rights reserved. Unless otherwise specified, no part of this publication may be reproduced or utilized otherwise in any form or by any means, electronic or mechanical, including photocopying, or posting on the internet or an intranet, without prior written permission. Permission can be requested from either ISO at the address below or ISO's member body in the country of the requester.

ISO copyright office
Ch. de Blandonnet 8 • CP 401
CH-1214 Vernier, Geneva, Switzerland
Tel. +41 22 749 01 11
Fax +41 22 749 09 47
copyright@iso.org
www.iso.org

Contents

	Page
Foreword.....	iv
Introduction.....	v
1 Scope.....	1
2 Normative references.....	1
3 Terms and definitions.....	1
4 Designation.....	1
5 Test specimen and specimen preparation.....	2
6 Number of test specimen.....	2
7 Test bench.....	2
8 Test performance.....	2
8.1 Installation of test specimen.....	2
8.2 Burner width.....	3
8.3 Preparation.....	3
8.4 Measured values and measuring points.....	3
8.5 Temperature during flame application.....	4
8.6 Pressure during flame application.....	4
8.7 Duration of test.....	4
8.8 Proof pressure application.....	5
9 Assessment.....	5
10 Type test certificate.....	5
Annex A (normative) Type test certificate.....	6

iTech STANDARD PREVIEW
(standards.iteh.ai)
ISO 15540:2016
<https://standards.iteh.ai/catalog/standards/sist/531acfaa-0f40-4a9c-a644-f5e9a40f85c8/iso-15540-2016>

Foreword

ISO (the International Organization for Standardization) is a worldwide federation of national standards bodies (ISO member bodies). The work of preparing International Standards is normally carried out through ISO technical committees. Each member body interested in a subject for which a technical committee has been established has the right to be represented on that committee. International organizations, governmental and non-governmental, in liaison with ISO, also take part in the work. ISO collaborates closely with the International Electrotechnical Commission (IEC) on all matters of electrotechnical standardization.

The procedures used to develop this document and those intended for its further maintenance are described in the ISO/IEC Directives, Part 1. In particular the different approval criteria needed for the different types of ISO documents should be noted. This document was drafted in accordance with the editorial rules of the ISO/IEC Directives, Part 2 (see www.iso.org/directives).

Attention is drawn to the possibility that some of the elements of this document may be the subject of patent rights. ISO shall not be held responsible for identifying any or all such patent rights. Details of any patent rights identified during the development of the document will be in the Introduction and/or on the ISO list of patent declarations received (see www.iso.org/patents).

Any trade name used in this document is information given for the convenience of users and does not constitute an endorsement.

For an explanation on the meaning of ISO specific terms and expressions related to conformity assessment, as well as information about ISO's adherence to the World Trade Organization (WTO) principles in the Technical Barriers to Trade (TBT) see the following URL: www.iso.org/iso/foreword.html.

The committee responsible for this document is ISO/TC 8, *Ships and marine technology*, Subcommittee SC 3, *Piping and machinery*.

This second edition cancels and replaces the first edition (ISO 15540:1999), which has been technically revised. It also incorporates the Technical Corrigendum ISO 15540:1999/Cor 1:1999.

The most significant change in this second edition is the inclusion of non-metallic compensators to the fire test procedures outlined in this document. The first edition of this document applied primarily to non-metallic hose assemblies. Because the compensators are used in common piping systems and may have similar materials to hose assemblies, the applicability of the test procedures was expanded to include compensators.

Introduction

The main objective of the test using the test bench described in this document is to determine whether and for a safety period a non-metallic hose (made of rubber) assembly or non-metallic compensator (bellow made of rubber) can be exposed to fire without becoming inoperable when subjected to the design working pressure. Although the attacking fire is simulated such that it corresponds to a fire occurring in practice, it cannot be assumed that the duration of fire resistance as recorded during that test will also occur in the event of an actual fire, as the installation conditions, which greatly affect to the duration of fire resistance, may vary from case to case.

When carried out using the test bench specified in ISO 15541, the test procedure according to this document is intended to lead to results capable of being reproduced by testing the same size and type.

A specimen test certificate is specified in [Annex A](#).

iTeh STANDARD PREVIEW (standards.iteh.ai)

[ISO 15540:2016](#)

<https://standards.iteh.ai/catalog/standards/sist/531acfaa-0f40-4a9c-a644-f5e9a40f85c8/iso-15540-2016>

iTeh STANDARD PREVIEW
(standards.iteh.ai)

ISO 15540:2016

<https://standards.iteh.ai/catalog/standards/sist/531acfaa-0f40-4a9c-a644-f5e9a40f85c8/iso-15540-2016>

Ships and marine technology — Fire resistance of non-metallic hose assemblies and non-metallic compensators — Test methods

1 Scope

This document specifies a test procedure for determining the fire resistance of non-metallic hose assemblies and non-metallic compensators with nominal diameter of up to 150 mm. It may be used for larger sizes provided proper test bench conditions are obtained.

It serves for proving whether, after the period of fire effect on the test bench specified in ISO 15541, hose assemblies and non-metallic compensators continue to be tight, even when subjected to proof pressure.

Only water is permitted as a test medium. With a view to ensuring maximum safety for both the operating personnel and the test bench in the event of damage to the hose or non-metallic compensator during the test, the use of combustible test media is excluded.

2 Normative references

The following documents are referred to in the text in such a way that some or all of their content constitutes requirements of this document. For dated references, only the edition cited applies. For undated references, the latest edition of the referenced document (including any amendments) applies.

ISO 15541:2016, *Ships and marine technology — Fire resistance of non-metallic hose assemblies and non-metallic compensators — Requirements for the test bench*

3 Terms and definitions

No terms and definitions are listed in this document.

ISO and IEC maintain terminological databases for use in standardization at the following addresses:

- IEC Electropedia: available at <http://www.electropedia.org/>
- ISO Online browsing platform: available at <https://www.iso.org/obp/>

4 Designation

The designation of the test for determining the fire resistance is composed of the elements quoted in the example below:

Test ISO 15540-30-0-5-400-F

In this designation the elements have the following meaning:

- Test: designation
ISO 15540: number of this document
30: test duration in minutes

- 5: working pressure during flame application, in bar
- 400: proof pressure following flame application, in bar
- F: test specimen with fire sleeve

5 Test specimen and specimen preparation

Non-metallic hose assemblies with a hose length of at least 500 mm shall be used as test specimen.

Each series of non-metallic compensators which have the same shape and identical construction shall be tested in their standard configuration.

The purchaser and operator of the test bench shall agree which fitting types shall be used for the test.

The test specimen may be tested either with or without fire sleeves subject to agreement; identification letter B for test without fire sleeves, identification letter F for tests with fire sleeves. If fire sleeves are used, then all specimens qualifying a series of non-metallic hose or non-metallic compensator shall be tested with fire sleeves.

Prior to the test, the test specimen shall be stored at ambient temperature for 24 h.

6 Number of test specimen

The type tests shall be carried out on a minimum of three non-metallic hose assemblies or non-metallic compensators with different nominal diameters of up to 150 mm but of identical hose or compensator construction. The smallest, the middle and the largest nominal diameter of each series shall be tested.

For an approval of non-metallic compensators with size range above 150 mm one additional test with half of the biggest size shall be tested.

7 Test bench

The test shall be carried out on a test bench according to ISO 15541.

8 Test performance

8.1 Installation of test specimen

The test specimen shall be installed on the test bench such that the burner end extends beyond one hose end fitting by at least 20 mm such that the fitting and hose is completely enclosed by the flames (see [Figure 1](#)).

In case of non-metallic compensators, the specimen shall be arranged such that the bellow (or other compensator design shape) and both end fittings or flanges are parallel to the surface of the burner and are completely enclosed by the flames.

The test specimen shall be centred above the burner surface (see [Figure 1](#)) in order to provide a flame appearance according to ISO 15541:2016, Annex A, Figures A.1 and A.2.

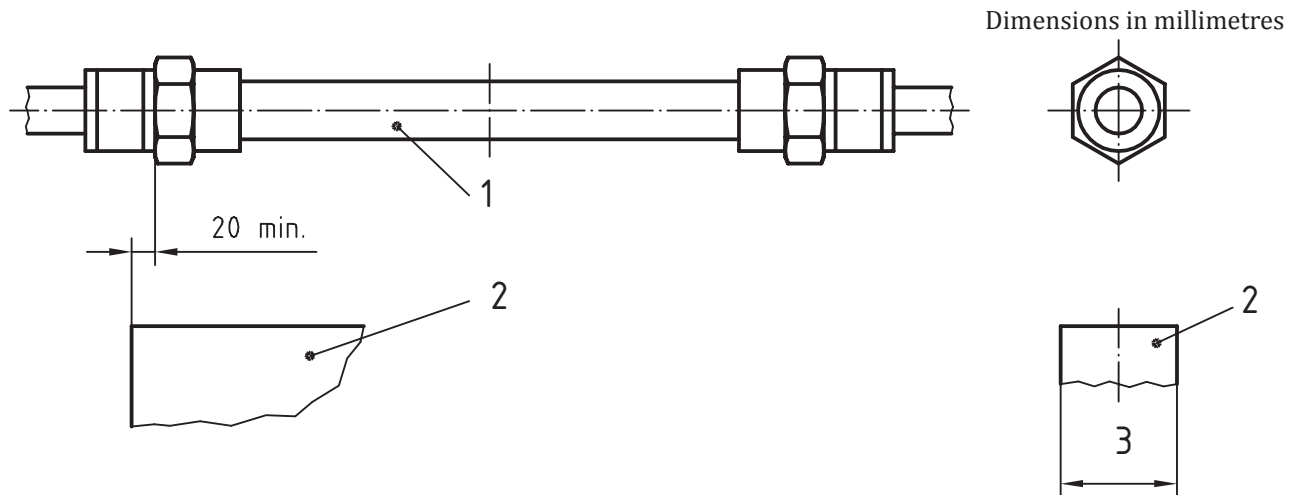

Key

- 1 test specimen
- 2 burner
- 3 burner width

Figure 1 — Test specimen arrangement (hose assembly)

iTeh STANDARD PREVIEW
(standards.iteh.ai)

8.2 Burner width

In order to ensure that the flames reliably enclose the test specimen, the minimum burner widths shown in [Table 1](#) shall be observed.

ISO 15540:2016

<https://standards.iteh.ai/catalog/standards/sist/531acfaa-0f40-4a9c-a644-15e9106c1500/iso-15540-2016>

Table 1 — Burner width

Dimensions in millimetres

Minimum width of burner	Outside diameter of test specimens	
50	up to 25	up to 100 ^a
100	over 25 up to 75	
150	over 75 up to 125	
200	over 125 up to 150 ^a	
250	over 150 up to 200	

^a Up to 150 the flames shall fully enclose the test specimen.

8.3 Preparation

Following installation, the test specimen shall be rinsed with the test medium water for at least 1 min in order to evacuate as far as possible the air contained in the test specimen.

8.4 Measured values and measuring points

The following measured values shall be determined at the measuring points indicated in [Figure 2](#):

- water temperature at measuring points 1 and 2;
- flame temperature at measuring points 3 and 4;
- flow rate of water;
- pressure inside test specimen during the flame application.