



SLOVENSKI STANDARD

SIST EN 695:1998

01-december-1998

Kuhinjsko pomivalno korito - Priključne mere

Kitchen sinks - Connecting dimensions

Küchenspülen - Anschlußmaße

Eviers de cuisine - Cotes de raccordement

Ta slovenski standard je istoveten z: EN 695:1997

<https://standards.iteh.ai/catalog/standards/sist/4d488620-cbfl-4234-bf26-dafd1253d755/sist-en-695-1998>

ICS:

91.140.70	Sanitarne naprave	Sanitary installations
-----------	-------------------	------------------------

SIST EN 695:1998

en

iTeh STANDARD PREVIEW **(standards.iteh.ai)**

SIST EN 695:1998

<https://standards.iteh.ai/catalog/standards/sist/4d488620-ebf1-4234-bf26-dafd1253d755/sist-en-695-1998>

EUROPEAN STANDARD

EN 695

NORME EUROPÉENNE

EUROPÄISCHE NORM

August 1997

ICS 97.040.10

Descriptors: kitchen equipment, sanitary appliances, sinks plumbing fixtures, dimensions, overall dimensions

English version

Kitchen sinks - Connecting dimensions

Eviers de cuisine - Cotes de raccordement Küchenspülen - Anschlußmaße

ITEH STANDARD PREVIEW
(standards.iteh.ai)

SIST EN 695:1998

<https://standards.iteh.ai/catalog/standards/sist/4d488620-cb1f-4234-bf26-daf11253d755/sist-en-695-1998>

This European Standard was approved by CEN on 1997-07-19. CEN members are bound to comply with the CEN/CENELEC Internal Regulations which stipulate the conditions for giving this European Standard the status of a national standard without any alteration.

Up-to-date lists and bibliographical references concerning such national standards may be obtained on application to the Central Secretariat or to any CEN member.

The European Standards exist in three official versions (English, French, German). A version in any other language made by translation under the responsibility of a CEN member into its own language and notified to the Central Secretariat has the same status as the official versions.

CEN members are the national standards bodies of Austria, Belgium, Czech Republic, Denmark, Finland, France, Germany, Greece, Iceland, Ireland, Italy, Luxembourg, Netherlands, Norway, Portugal, Spain, Sweden, Switzerland and United Kingdom.

CENEuropean Committee for Standardization
Comité Européen de Normalisation
Europäisches Komitee für Normung

Central Secretariat: rue de Stassart, 36 B-1050 Brussels

© 1997 CEN - All rights of exploitation in any form and by any means reserved worldwide for CEN national Members.

Ref. No. EN 695:1997 E

Contents

Foreword

1	Scope	3
2	Definitions	4
2.1	Kitchen sink	4
2.2	Integrated overflow	4
3	Waste holes	4
4	Fitting area for tap holes	6
5	Overflow holes	7

iTeh STANDARD PREVIEW
(standards.iteh.ai)

<https://standards.iteh.ai/catalog/standards/sist/4d488620-3511-4234-bf26-da6d1253d755/sist-en-695-1998>



Foreword

This European Standard has been prepared by Technical Committee CEN/TC 163 "Sanitary appliances", the secretariat of which is held by UNI.

This European Standard shall be given the status of a national standard, either by publication of an identical text or by endorsement, at the latest by February 1998, and conflicting national standards shall be withdrawn at the latest by February 1998.

According to the CEN/CENELEC Internal Regulations, the national standards organizations of the following countries are bound to implement this European Standard: Austria, Belgium, Czech Republic, Denmark, Finland, France, Germany, Greece, Iceland, Ireland, Italy, Luxembourg, Netherlands, Norway, Portugal, Spain, Sweden, Switzerland and the United Kingdom.

This European Standard complements the existing standards on tap and waste fittings (EN 200 and EN 411) in terms of their dimensional and functional requirements.

iTeh STANDARD PREVIEW
(standards.iteh.ai)

SIST EN 695:1998

<https://standards.iteh.ai/catalog/standards/sist/4d488620-ebf1-4234-bf26-dafd1253d755/sist-en-695-1998>

1 Scope

This standard specifies the requirements for the connecting dimensions for domestic kitchen sinks.

This standard is applicable to kitchen sinks for use in residential (domestic) houses, guest houses and similar premises. It does not apply to industrial kitchen sinks and to kitchen sinks with two-hole taps.

NOTE: The figures are given by way of example; other designs are possible.

2 Definitions

For the purpose of this standard, the following definitions apply:

2.1 kitchen sink: A bowl or group of bowls with waste hole(s) and, if applicable, tap hole(s) and overflow(s), with or without draining areas, standing alone, integrated with or assembled with a worktop or assembled into a purpose-built kitchen intended for the preparation of food, the washing of dishes and the discharge of domestic waste water.

2.2 integrated overflow: An overflow arrangement which is a part of the product formed during its manufacture.

3 Waste holes

The connecting dimensions for waste holes shall comply with the requirements given in table 1.

Table 1: Connecting dimensions for waste holes (see figures 1 and 2)

Symbols	Dimensions mm	Remarks
D_2	52 $+3/-2$ 60 $+1/0$ 62 $+3/-2$ 90 $+3/-2$	Diameter of waste hole or punched grill
D_3	70	Contact diameter for waste fitting with dimension $D_2 = 60$ mm and 52 mm
	85	Contact diameter for waste fitting with dimension $D_2 = 62$ mm and 52 mm (i.e. for kitchen sinks made of ceramic materials)
	115	Contact diameter for waste fitting with dimension $D_2 = 90$ mm
h_2	2 to 25	Distance between the contact diameter of the waste fitting and the underside of the waste hole
	45 to 65	Distance between the contact diameter of the waste fitting and the underside of the waste hole for kitchen sinks made of ceramic materials with an integrated overflow
e	min. 2	Distance between the bottom of the bowl and the contact diameter of the waste fitting
S_1	min. 3	Dimension of the sealing surface of the waste fitting

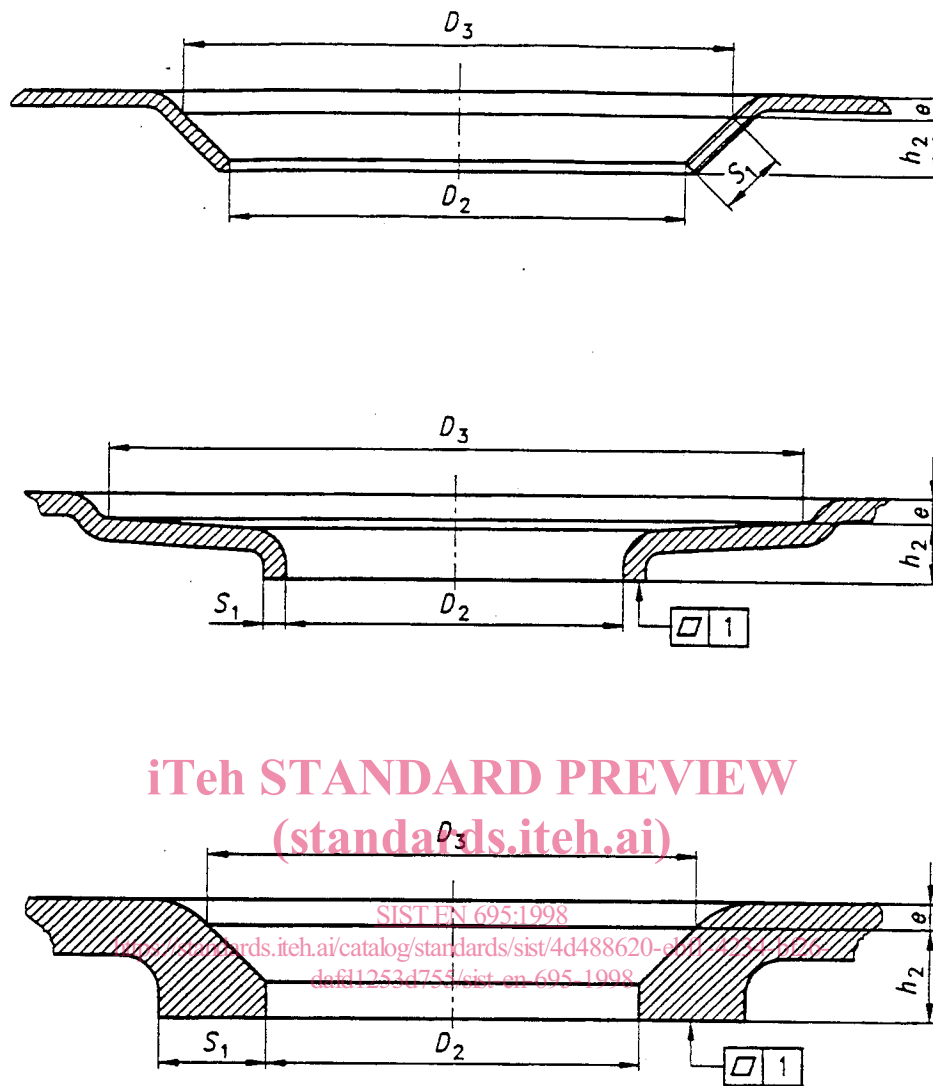

Figure 1: Outlet shapes for waste holes

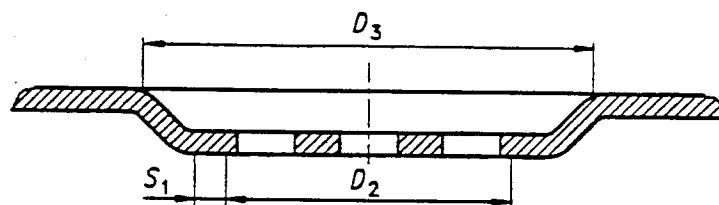

Figure 2: Punched grill

4 Fitting area for tap holes

The fitting area for the tap hole shall comply with the requirements given in table 2.

Table 2: Dimensions for the fitting area for tap holes (see figure 3)

Symbols	Dimensions mm	Remarks
d_2	35 $+2/-1$	Diameter of tap hole
g_4	min. 32	Clearance for the tap pedestal
s	max. 18	Thickness of material in the area of tap hole
r	min. 25 ¹⁾	Radius for the tap fastening nut
r_1	min. 30 ¹⁾	Radius of surface for tightening of fastening nut with the work tool
g_1	Shall be stated by the manufacturer	Distance between the centre of the tap hole and the nearest edge of the bowl for choice of the tap.

¹⁾ The difference between dimensions r_1 and r shall not be less than 5 mm.

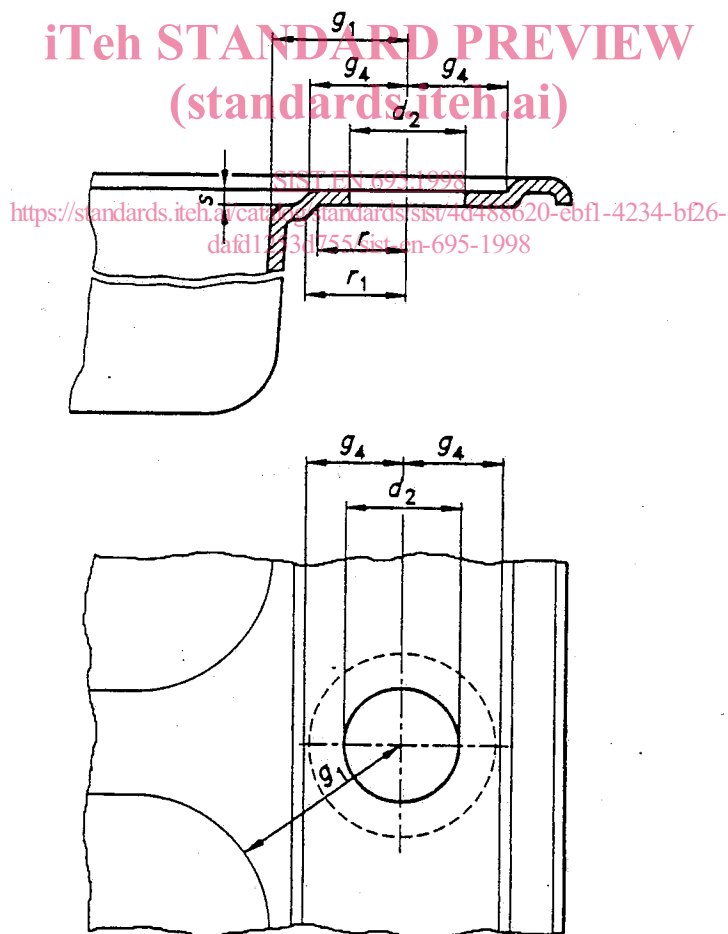

Figure 3: Fitting area for the tap hole

5 Overflow holes

Overflow holes, if provided, shall meet the requirements of table 3 except when the overflow equipment is supplied together with the kitchen sink.

Table 3: Dimensions for the overflow holes (see figures 4, 5 and 6)

Symbols	Dimensions mm	Remarks
a	max. 120	Distance from the centre of the waste hole to the vertical drawn from the centre of the overflow hole
H_1	110 to 180	Distance from the horizontal drawn through the centre of the overflow hole and the underside of the waste hole
H_2	25 $0/-5$	Depth of the overflow hole
B_1	53 $0/-5$	Width of the overflow hole
B_2	min. 58	Width of the clearance of the overflow hole
H_3	min. 30	Depth of the clearance of the overflow hole
H_4	min. 15	Distance between top of bowl and top of overflow hole
D_1	32 $+2/-1$	Diameter of the overflow hole
D_4	min. 36	Clearance in the area of overflow hole
X	max. 400	Distance between centre lines of waste holes

(standards.iteh.ai)

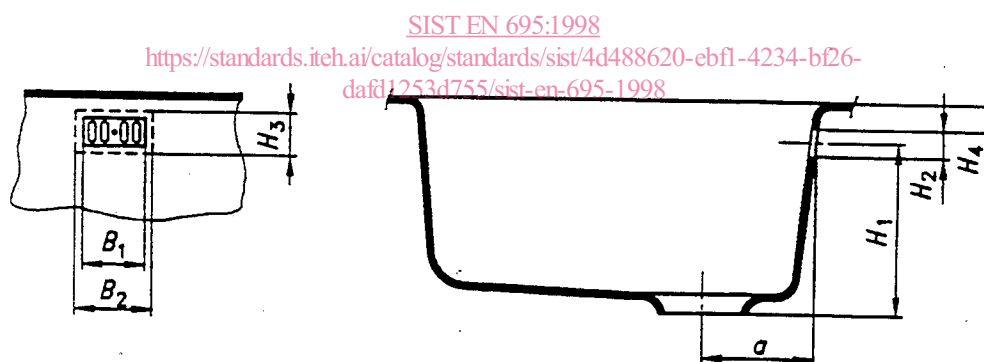

Figure 4: Overflow hole, rectangular