Površinsko nameščeni piezoelektrični elementi za krmiljenje in izbiranje (filtriranje) frekvenc - Standardne mere in priključni kontakti - 2. del: Keramični okrovi - Dopolnilo A1 (IEC 61837-2:2018/A1:2020)

Surface mounted piezoelectric devices for frequency control and selection - Standard outlines and terminal lead connections - Part 2: Ceramic enclosures (IEC 61837-2:2018/A1:2020)

Oberflächenmontierbare piezoelektrische Bauteile zur Frequenzstabilisierung und -selektion - Norm-Gehäusemaße (und Anschlüsse) - Teil 2: Keramikgehäuse (IEC 61837-2:2018/A1:2020)

Dispositifs piézoélectriques à montage en surface pour la commande et le choix de la fréquence - Encombrements normalisés et connexions des sorties - Partie 2: Enveloppes en céramique (IEC 61837-2:2018/A1:2020)

Ta slovenski standard je istoveten z: EN IEC 61837-2:2018/A1:2020

ICS:

31.140 Piezoelektrične naprave Piezoelectric devices

SIST EN IEC 61837-2:2018/A1:2021 en

iTeh STANDARD PREVIEW
(standards.iteh.ai)

[SIST EN IEC 61837-2:2018/A1:2021](https://standards.iteh.ai/catalog/standards/sist/ff10e19d-0157-4283-b0af-4a37e59d7d6d/sist-en-iec-61837-2-2018-a1-2021)

<https://standards.iteh.ai/catalog/standards/sist/ff10e19d-0157-4283-b0af-4a37e59d7d6d/sist-en-iec-61837-2-2018-a1-2021>

EUROPEAN STANDARD

EN IEC 61837-2:2018/A1

NORME EUROPÉENNE

EUROPÄISCHE NORM

November 2020

ICS 31.140

English Version

Surface mounted piezoelectric devices for frequency control and selection - Standard outlines and terminal lead connections -
Part 2: Ceramic enclosures
(IEC 61837-2:2018/A1:2020)

Dispositifs piézoélectriques à montage en surface pour la commande et le choix de la fréquence - Encombrements normalisés et connexions des sorties - Partie 2: Enveloppes en céramique
(IEC 61837-2:2018/A1:2020)

Oberflächenmontierbare piezoelektrische Bauteile zur Frequenzstabilisierung und -selektion - Norm-Gehäusemaße und Anschlüsse - Teil 2: Keramikgehäuse
(IEC 61837-2:2018/A1:2020)

This amendment A1 modifies the European Standard EN IEC 61837-2:2018; it was approved by CENELEC on 2020-10-29. CENELEC members are bound to comply with the CEN/CENELEC Internal Regulations which stipulate the conditions for giving this amendment the status of a national standard without any alteration.

Up-to-date lists and bibliographical references concerning such national standards may be obtained on application to the CEN-CENELEC Management Centre or to any CENELEC member.

This amendment exists in three official versions (English, French, German). A version in any other language made by translation under the responsibility of a CENELEC member into its own language and notified to the CEN-CENELEC Management Centre has the same status as the official versions.

CENELEC members are the national electrotechnical committees of Austria, Belgium, Bulgaria, Croatia, Cyprus, the Czech Republic, Denmark, Estonia, Finland, France, Germany, Greece, Hungary, Iceland, Ireland, Italy, Latvia, Lithuania, Luxembourg, Malta, the Netherlands, Norway, Poland, Portugal, Republic of North Macedonia, Romania, Serbia, Slovakia, Slovenia, Spain, Sweden, Switzerland, Turkey and the United Kingdom.



European Committee for Electrotechnical Standardization
Comité Européen de Normalisation Electrotechnique
Europäisches Komitee für Elektrotechnische Normung

CEN-CENELEC Management Centre: Rue de la Science 23, B-1040 Brussels

EN IEC 61837-2:2018/A1:2020 (E)**European foreword**

The text of document 49/1338/CDV, future IEC 61837-2/A1, prepared by IEC/TC 49 "Piezoelectric, dielectric and electrostatic devices and associated materials for frequency control, selection and detection" was submitted to the IEC-CENELEC parallel vote and approved by CENELEC as EN IEC 61837-2:2018/A1:2020.

The following dates are fixed:

- latest date by which the document has to be implemented at national level by publication of an identical national standard or by endorsement (dop) 2021-07-29
- latest date by which the national standards conflicting with the document have to be withdrawn (dow) 2023-10-29

Attention is drawn to the possibility that some of the elements of this document may be the subject of patent rights. CENELEC shall not be held responsible for identifying any or all such patent rights.

Endorsement notice

The text of the International Standard IEC 61837-2:2018/A1:2020 was approved by CENELEC as a European Standard without any modification.

(standards.iteh.ai)

[SIST EN IEC 61837-2:2018/A1:2021](https://standards.iteh.ai/catalog/standards/sist/f10e19d-0157-4283-b0af-4a37e59d7d6d/sist-en-iec-61837-2-2018-a1-2021)

<https://standards.iteh.ai/catalog/standards/sist/f10e19d-0157-4283-b0af-4a37e59d7d6d/sist-en-iec-61837-2-2018-a1-2021>



IEC 61837-2

Edition 3.0 2020-09

INTERNATIONAL STANDARD

AMENDMENT 1

**Surface mounted piezoelectric devices for frequency control and selection –
Standard outlines and terminal lead connections –
Part 2: Ceramic enclosures**

[SIST EN IEC 61837-2:2018/A1:2021](https://standards.iteh.ai/catalog/standards/sist/ff10e19d-0157-4283-b0af-4a37e59d7d6d/sist-en-iec-61837-2-2018-a1-2021)

<https://standards.iteh.ai/catalog/standards/sist/ff10e19d-0157-4283-b0af-4a37e59d7d6d/sist-en-iec-61837-2-2018-a1-2021>

INTERNATIONAL
ELECTROTECHNICAL
COMMISSION

ICS 31.140

ISBN 978-2-8322-8838-2

Warning! Make sure that you obtained this publication from an authorized distributor.

FOREWORD

This amendment has been prepared by IEC technical committee 49: Piezoelectric, dielectric and electrostatic devices and associated materials for frequency control, selection and detection.

The text of this amendment is based on the following documents:

FDIS	Report on voting
49/1338/CDV	49/1347/RVC

Full information on the voting for the approval of this amendment can be found in the report on voting indicated in the above table.

The committee has decided that the contents of this amendment and the base publication will remain unchanged until the stability date indicated on the IEC website under "<http://webstore.iec.ch>" in the data related to the specific publication. At this date, the publication will be

- reconfirmed,
- withdrawn,
- replaced by a revised edition, or
- amended.

ITEH STANDARD PREVIEW
(standards.iteh.ai)

[SIST EN IEC 61837-2:2018/A1:2021](https://standards.iteh.ai/catalog/standards/sist/f10e19d-0157-4283-b0af-4a37e59d7d6d/sist-en-iec-61837-2-2018-a1-2021)

<https://standards.iteh.ai/catalog/standards/sist/f10e19d-0157-4283-b0af-4a37e59d7d6d/sist-en-iec-61837-2-2018-a1-2021>

8 Designation of ceramic enclosures

Replace Table 1 with the following:

Table 1 – Designation of ceramic enclosures

No.	Type	Old type	Sheet No.	Description
1	QCC-18/1809A	QCC-18/01	Sheet 1	Ceramic, welded, eighteen leadless SMD outline
2	QCC-12/1407A		Sheet 2	Ceramic, welded, twelve leadless SMD outline
3	DCC-4/1206A	DCC-4/01	Sheet 3	Ceramic, four leadless SMD outline
4	DCC-2/1206A		Sheet 4	Ceramic, two leadless SMD outline
5	QCC-10/9272A		Sheet 5	Ceramic, welded, ten leadless SMD outline
6	DCC-4/9070A		Sheet 6	Ceramic, welded, four leadless SMD outline
7	DCC-4/8045B	DCC-04/02, 03	Sheet 7	Ceramic, welded, four leadless SMD outline
8	DCC-2/8045B		Sheet 8	Ceramic, welded, two leadless SMD outline
9	DCC-6/7834B		Sheet 9	Ceramic, welded, six leadless SMD outline
10	DCC-6/7050A		Sheet 10	Ceramic, welded, six leadless SMD outline
11	DCC-4/7050A	DCC-4/08	Sheet 11	Ceramic, welded, four leadless SMD outline
12	DCC-4/7050B	DCC-4/04, 05	Sheet 12	Ceramic, welded, four leadless SMD outline
13	QCC-10/7050A		Sheet 13	Ceramic, welded, ten leadless SMD outline
14	QCC-6/7050A	QCC-6/01, 02	Sheet 14	Ceramic, welded, six leadless SMD outline
15	DCC-6/6035A	DCC-4/06, 07	Sheet 15	Ceramic, welded, six leadless SMD outline
16	DCC-4/6035C		Sheet 16	Ceramic, welded, four leadless SMD outline
17	DCC-2/6035C		Sheet 17	Ceramic, welded, two leadless SMD outline
18	QCC-8/5050A	QCC-8/02	Sheet 18	Ceramic, welded, eight leadless SMD outline
19	QCC-12/5045A	QCC-12/02	Sheet 19	Ceramic, welded, twelve leadless SMD outline
20	QCC-8/5045A		Sheet 20	Ceramic, welded, eight leadless SMD outline
21	DCC-6/5032A		Sheet 21	Ceramic, welded, six leadless SMD outline
22	DCC-4/5032A		Sheet 22	Ceramic, welded, four leadless SMD outline
23	DCC-4/5032C		Sheet 23	Ceramic, welded, four leadless SMD outline
24	DCC-2/5032B	DCC-2/01	Sheet 24	Ceramic, welded, two leadless SMD outline
25	DCC-2/4818C		Sheet 25	Ceramic, welded, two leadless SMD outline
26	DCC-2/4115C		Sheet 26	Ceramic, welded, two leadless SMD outline
27	DCC-4/4025C	DCC-6/01	Sheet 27	Ceramic, welded, four leadless SMD outline
28	QCC-8/3838A		Sheet 28	Ceramic, welded, eight leadless SMD outline
29	DCC-6/3838A		Sheet 29	Ceramic, welded, six leadless SMD outline
30	DCC-6/3225A		Sheet 30	Ceramic, welded, six leadless SMD outline
31	DCC-4/3225C		Sheet 31	Ceramic, welded, four leadless SMD outline
32	DCC-4/3215C		Sheet 32	Ceramic, welded, four leadless SMD outline
33	DCC-2/3215C		Sheet 33	Ceramic, welded, two leadless SMD outline
34	QCC-8/3030B		Sheet 34	Ceramic, welded, eight leadless SMD outline
35	DCC-6/3030A		Sheet 35	Ceramic, welded, six leadless SMD outline
36	DCC-6/2520A		Sheet 36	Ceramic, welded, six leadless SMD outline
37	DCC-4/2520C/01,02,03		Sheet 37	Ceramic, welded, four leadless SMD outline
38	DCC-4/2020C		Sheet 38	Ceramic, welded, six leadless SMD outline
39	DCC-6/2016A		Sheet 39	Ceramic, welded, six leadless SMD outline
40	DCC-4/2016C/01,02,03		Sheet 40	Ceramic, welded, four leadless SMD outline
41	DCC-2/2012C		Sheet 41	Ceramic, welded, two leadless SMD outline
42	DCC-4/1612C/01,02		Sheet 42	Ceramic, welded, four leadless SMD outline
43	DCC-2/1612C		Sheet 43	Ceramic, welded, two leadless SMD outline
44	DCC-2/1610C		Sheet 44	Ceramic, welded, two leadless SMD outline
45	DCC-4/1210C		Sheet 45	Ceramic, welded, four leadless SMD outline

No.	Type	Old type	Sheet No.	Description
46	DCC-8/3225A		Sheet 46	Ceramic, welded, eight leadless SMD outline
47	DCC-4/1008C/0,1,02		Sheet 47	Ceramic, welded, four leadless SMD outline

Add two sheets, Type DCC-8/3225A and Type DCC-4/1008C:

iTeh STANDARD PREVIEW (standards.iteh.ai)

[SIST EN IEC 61837-2:2018/A1:2021](https://standards.iteh.ai/catalog/standards/sist/ff10e19d-0157-4283-b0af-4a37e59d7d6d/sist-en-iec-61837-2-2018-a1-2021)

<https://standards.iteh.ai/catalog/standards/sist/ff10e19d-0157-4283-b0af-4a37e59d7d6d/sist-en-iec-61837-2-2018-a1-2021>

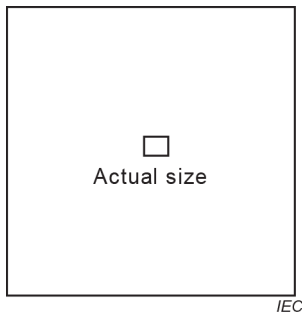

Ref.	Dimensions (mm)			Notes
	Min.	Nom.	Max.	
A	—	(3,2)	3,40	
B	—	(2,5)	2,70	
G	—	—	1,00	
K_1	0,30	—	0,70	
K_2	0,35	—	0,75	
L_{B1}	0,50	—	0,90	
L_{B2}	0,15	—	0,55	
e_1	—	0,95	—	
e_2	—	2,70	—	
e_3	—	1,80	—	
y	—	—	0,10	

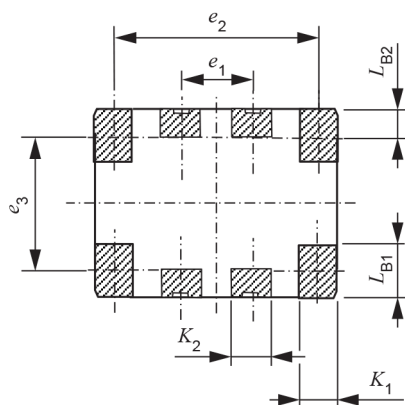
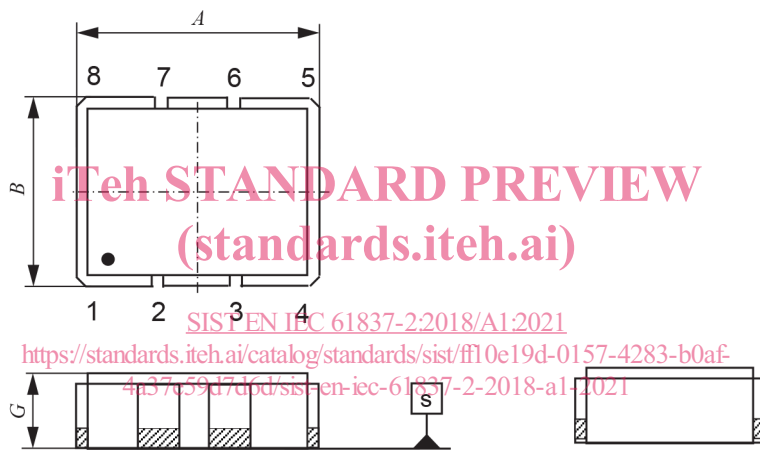

IEC

Ceramic, welded, eight leadless SMD outline-
Type DCC-8/3225A

Scale
10: 1

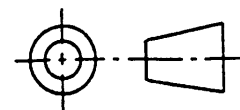

Sheet 46

Terminal land connections of Type DCC-8/3225A

No.	Crystal unit	Crystal oscillator	Crystal filter	SAW devices
1		Output Enable		
2		INT		
3		NC		
4		Output		
5		Ground		
6		SCL		
7		SDA		
8		DC supply		

STANDARD PREVIEW
 iTeh (standards.iteh.ai)

[SIST EN IEC 61837-2:2018/A1:2021](https://standards.iteh.ai/catalog/standards/sist/f10e19d-0157-4283-b0af-4a37e59d7d6d/sist-en-iec-61837-2-2018-a1-2021)

<https://standards.iteh.ai/catalog/standards/sist/f10e19d-0157-4283-b0af-4a37e59d7d6d/sist-en-iec-61837-2-2018-a1-2021>

Actual size omitted

Ref.	Dimensions (mm)			Notes
	Min.	Nom.	Max.	
A	—	(1,0)	1,2	
B	—	(0,8)	1,0	
G_1	—	—	0,13	/01
G_2	—	—	0,30	/02
K	0,20	—	0,60	
L_B	0,10	—	0,50	
e_1	—	0,60	—	
e_2	—	0,50	—	
y	—	—	0,1	

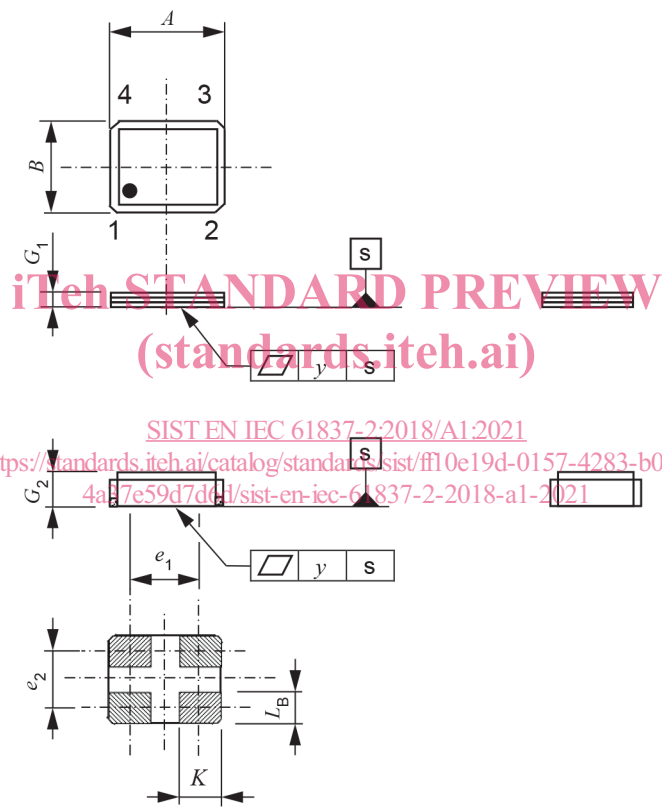

IEC

Ceramic, welded, four leadless SMD outline-
Type DCC-4/1008C/01,02

Scale
15: 1

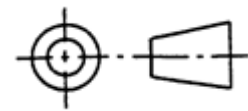

Sheet 47