

---

---

**Flexible cellular polymeric  
materials — Determination of tear  
strength**

*Matériaux polymères alvéolaires souples — Détermination de la  
résistance au déchirement*

**iTeh STANDARD PREVIEW**  
**(standards.iteh.ai)**

[ISO 8067:2018](https://standards.iteh.ai/catalog/standards/sist/dbda3060-3c97-40ad-8846-2a521308b19b/iso-8067-2018)

[https://standards.iteh.ai/catalog/standards/sist/dbda3060-3c97-40ad-8846-  
2a521308b19b/iso-8067-2018](https://standards.iteh.ai/catalog/standards/sist/dbda3060-3c97-40ad-8846-2a521308b19b/iso-8067-2018)



**iTeh STANDARD PREVIEW**  
**(standards.iteh.ai)**

ISO 8067:2018

<https://standards.iteh.ai/catalog/standards/sist/dbda3060-3c97-40ad-8846-2a521308b19b/iso-8067-2018>



**COPYRIGHT PROTECTED DOCUMENT**

© ISO 2018

All rights reserved. Unless otherwise specified, or required in the context of its implementation, no part of this publication may be reproduced or utilized otherwise in any form or by any means, electronic or mechanical, including photocopying, or posting on the internet or an intranet, without prior written permission. Permission can be requested from either ISO at the address below or ISO's member body in the country of the requester.

ISO copyright office  
CP 401 • Ch. de Blandonnet 8  
CH-1214 Vernier, Geneva  
Phone: +41 22 749 01 11  
Fax: +41 22 749 09 47  
Email: [copyright@iso.org](mailto:copyright@iso.org)  
Website: [www.iso.org](http://www.iso.org)

Published in Switzerland

# Contents

	Page
Foreword .....	iv
<b>1 Scope</b> .....	<b>1</b>
<b>2 Normative references</b> .....	<b>1</b>
<b>3 Terms and definitions</b> .....	<b>1</b>
<b>4 Apparatus</b> .....	<b>1</b>
<b>5 Test pieces</b> .....	<b>1</b>
5.1 General .....	1
5.2 Trouser test piece for method A .....	2
5.3 Angle test piece for method B .....	2
<b>6 Number of test pieces</b> .....	<b>3</b>
<b>7 Conditioning</b> .....	<b>4</b>
<b>8 Procedure</b> .....	<b>4</b>
8.1 General .....	4
8.2 Method A .....	4
8.3 Method B .....	5
<b>9 Expression of results</b> .....	<b>6</b>
<b>10 Test report</b> .....	<b>6</b>
<b>Annex A (informative) Precision comparison for the two types of test piece</b> .....	<b>7</b>
<b>Bibliography</b> .....	<b>9</b>

iTeh STANDARD PREVIEW  
<https://standards.iteh.ai/catalog/standards/sist/dbda3060-3c97-40ad-8846-2a521308b19b/iso-8067-2018>  
 (standards.iteh.ai)

## Foreword

ISO (the International Organization for Standardization) is a worldwide federation of national standards bodies (ISO member bodies). The work of preparing International Standards is normally carried out through ISO technical committees. Each member body interested in a subject for which a technical committee has been established has the right to be represented on that committee. International organizations, governmental and non-governmental, in liaison with ISO, also take part in the work. ISO collaborates closely with the International Electrotechnical Commission (IEC) on all matters of electrotechnical standardization.

The procedures used to develop this document and those intended for its further maintenance are described in the ISO/IEC Directives, Part 1. In particular, the different approval criteria needed for the different types of ISO documents should be noted. This document was drafted in accordance with the editorial rules of the ISO/IEC Directives, Part 2 (see [www.iso.org/directives](http://www.iso.org/directives)).

Attention is drawn to the possibility that some of the elements of this document may be the subject of patent rights. ISO shall not be held responsible for identifying any or all such patent rights. Details of any patent rights identified during the development of the document will be in the Introduction and/or on the ISO list of patent declarations received (see [www.iso.org/patents](http://www.iso.org/patents)).

Any trade name used in this document is information given for the convenience of users and does not constitute an endorsement.

For an explanation of the voluntary nature of standards, the meaning of ISO specific terms and expressions related to conformity assessment, as well as information about ISO's adherence to the World Trade Organization (WTO) principles in the Technical Barriers to Trade (TBT) see [www.iso.org/iso/foreword.html](http://www.iso.org/iso/foreword.html).

This document was prepared by Technical Committee ISO/TC 45, *Rubber and rubber products*, Subcommittee SC 4, *Products (other than hoses)*. [ISO 8067:2018](https://standards.iteh.ai/catalog/standards/sist/dbda3060-3c97-40ad-8846-3c521308b4d7/iso-8067-2018)  
<https://standards.iteh.ai/catalog/standards/sist/dbda3060-3c97-40ad-8846-3c521308b4d7/iso-8067-2018>

This third edition cancels and replaces the second edition (ISO 8067:2008), which has been technically revised.

The main changes compared to the previous edition are as follows:

- test pieces with skin has been added in [5.1](#)

Any feedback or questions on this document should be directed to the user's national standards body. A complete listing of these bodies can be found at [www.iso.org/members.html](http://www.iso.org/members.html).

# Flexible cellular polymeric materials — Determination of tear strength

## 1 Scope

This document specifies two methods for the determination of the tear strength of flexible cellular polymeric materials:

- method A, using a trouser test piece;
- method B, using an angle test piece without a nick.

## 2 Normative references

The following documents are referred to in the text in such a way that some or all of their content constitutes requirements of this document. For dated references, only the edition cited applies. For undated references, the latest edition of the referenced document (including any amendments) applies.

ISO 1923, *Cellular plastics and rubbers — Determination of linear dimensions*

ISO 7500-1, *Metallic materials — Calibration and verification of static uniaxial testing machines — Part 1: Tension/compression testing machines — Calibration and verification of the force-measuring system*

## 3 Terms and definitions

ISO 8067:2018

For the purposes of this document, the following terms and definitions apply.

ISO and IEC maintain terminological databases for use in standardization at the following addresses:

- ISO Online browsing platform: available at <https://www.iso.org/obp>
- IEC Electropedia: available at <http://www.electropedia.org/>

### 3.1

#### tear strength

*R*

maximum force per unit thickness observed when stretching a test piece to rupture

## 4 Apparatus

The tear strength shall be measured on a tensile-testing machine which will indicate the force at which rupture of the test piece takes place. An automatic machine should preferably be used which draws the actual curve, or a stylus or scale should be used having an indicator that remains at the point of maximum force after rupture of the test piece.

The accuracy of the test machine shall be class 2 or better as defined in ISO 7500-1.

## 5 Test pieces

### 5.1 General

The test pieces shall be free of voids and flow lines. Test pieces can be selected either with or without skin. If the material exhibits a predominant direction of cellular structure (orientation of the cells), the

trouser test piece shall be taken in such a way that the plane of the cut subsequently made in the test piece (see [Figure 1](#)) is parallel to, and the long dimension of the cut perpendicular to, the predominant foam-rise direction and the angle test piece shall be taken in such a way that the plane of the V-shaped side of the test piece (see [Figure 3](#)) is parallel to, and the long dimension of the test piece perpendicular to, the predominant foam-rise direction. If this is not possible, the orientation of the long dimension of the cut or the V-shaped side of the test piece with respect to the predominant foam-rise direction shall be stated in the test report. See [Annex A](#) for the difference of test results and the precision for each type of test pieces.

### 5.2 Trouser test piece for method A

The trouser test piece shall be a rectangular parallelepiped cut from a sheet of material with a band knife or a cutting die. Each test piece shall have the dimensions given in [Figure 1](#) and a 45 mm to 55 mm cut shall be made at one end. The required tear length (25 mm) shall be marked on the test piece. The predominant foam-rise direction for the trouser test piece is indicated by an arrow in [Figure 1](#).

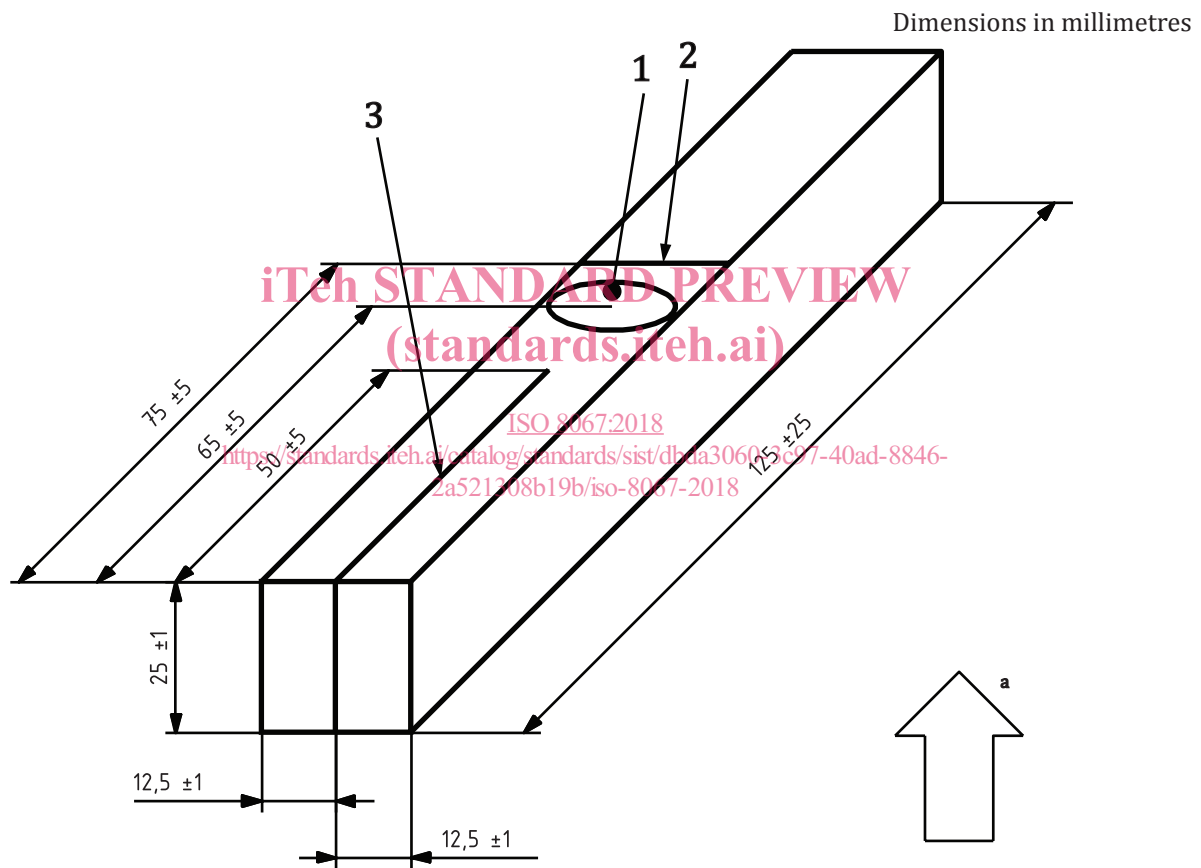

#### Key

- 1 location of thickness measurement
- 2 mark indicating required tear length
- 3 cut made in test piece
- a Predominant foam-rise direction.

Figure 1 — Trouser test piece

### 5.3 Angle test piece for method B

The test piece shall be cut from a sheet of material of thickness 10 mm to 15 mm with a die having the dimensions and shape shown in [Figure 2](#). The predominant foam-rise direction for the angle test piece is indicated in [Figure 3](#).

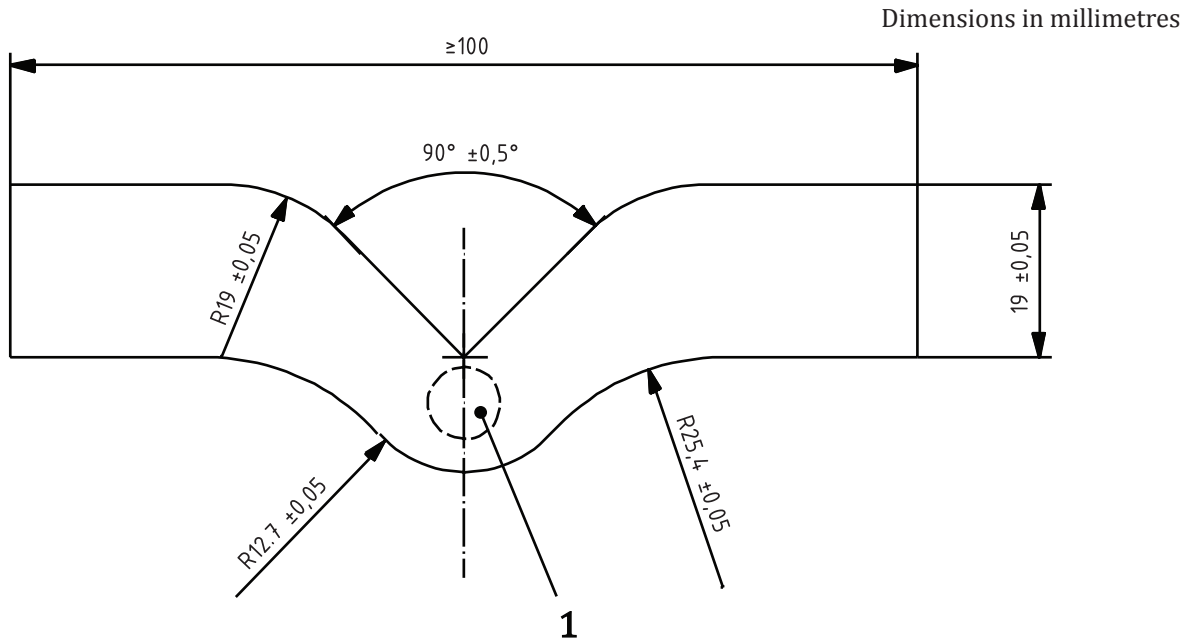

**Key**

- 1 location of thickness measurement of test piece cut out using die

**Figure 2 — Angle test piece die**  
*(standards.iteh.ai)*

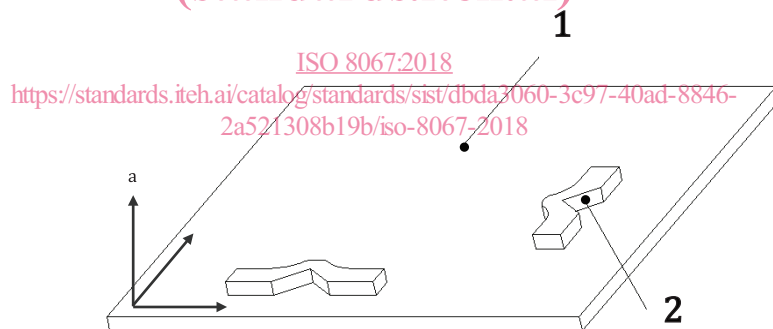

**Key**

- 1 sheet of material
- 2 v-shaped side of test piece
- a Predominant foam-rise direction.

**Figure 3 — Predominant foam-rise direction for angle test piece**

**6 Number of test pieces**

Three test pieces shall be tested.

Additional test pieces may be required if the spread of results is too great (see [Clause 9](#)) or to compensate for deviation in the progress of the tear (see [8.2](#)).

## 7 Conditioning

Materials shall not be tested less than 72 h after manufacture, unless it can be demonstrated that the mean results obtained at either 16 h or 48 h after manufacture do not differ by more than  $\pm 10\%$  from those obtained after 72 h, in which case testing is permitted at either 16 h or 48 h, respectively. Prior to the test, the test pieces or the material from which the test pieces are to be cut shall be conditioned for at least 16 h in one of the following atmospheres, unless otherwise specified:

- $(23 \pm 2)^\circ\text{C}$ ,  $(50 \pm 5)\%$  relative humidity;
- $(27 \pm 2)^\circ\text{C}$ ,  $(65 \pm 5)\%$  relative humidity.

This conditioning period may form the final part of, or in the case of testing 16 h after manufacture, the whole of the period following manufacture.

In the case of quality-control tests, test pieces may be taken a shorter time (down to a minimum of 12 h) after manufacture and testing carried out after conditioning for a shorter period (down to a minimum of 6 h) in one of the atmospheres specified above.

It is recommended that, for referee purposes, the test is performed 7 days or more after the cellular material has been manufactured.

## 8 Procedure

### 8.1 General

After conditioning as specified in [Clause 7](#), measure, in accordance with ISO 1923, the thickness of the test piece at the location shown in [Figure 1](#) or [Figure 2](#).

### 8.2 Method A

**iTeh STANDARD PREVIEW**  
(standards.iteh.ai)  
[ISO 8067:2018  
https://standards.iteh.ai/catalog/standards/sist/dbda3060-3c97-40ad-8846-2a521308b19b/iso-8067-2018](https://standards.iteh.ai/catalog/standards/sist/dbda3060-3c97-40ad-8846-2a521308b19b/iso-8067-2018)

**8.2.1** Clamp the test piece in the jaws of the test machine, taking care that the jaws grip the test piece properly. Spread the ends of the test piece so that the force is applied in the direction shown in [Figure 4](#). Start the test machine with a jaw speed of 50 mm/min to 500 mm/min.

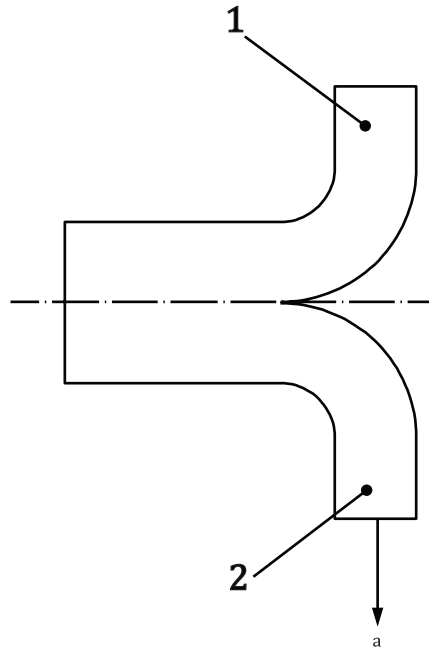

**Key**

- 1 held in fixed clamp
- 2 held in moving clamp
- a Direction of applied force.

STANDARD PREVIEW  
(standards.iteh.ai)

**Figure 4 — Schematic test arrangement**

ISO 8067:2018

**8.2.2** Where necessary in order to keep the cut in the centre of the test piece while tearing, aid it with light application of a sharp blade, for example a single-edged razor blade.

Cutting should be the exception and should be avoided because it could influence the result.

Care should be taken when using blades.

**8.2.3** When the tear has travelled  $(25 \pm 5)$  mm along the test piece, record the maximum force on the dial or scale. If rupture occurs before a length of 20 mm is torn, reject the test piece and take a fresh one.

**8.2.4** For referee purposes, a jaw speed of  $(50 \pm 5)$  mm/min shall be used.

### 8.3 Method B

**8.3.1** Clamp the test piece in the jaws of the test machine, taking care to adjust it so that it is symmetrical, in order that the tension will be distributed uniformly over the cross-section.

**8.3.2** Start the test machine with a jaw speed of 50 mm/min to 500 mm/min and record the maximum force.

**8.3.3** For referee purposes, a jaw speed of  $(500 \pm 50)$  mm/min shall be used.