INTERNATIONAL STANDARD



2584

INTERNATIONAL ORGANIZATION FOR STANDARDIZATION • МЕЖДУНАРОДНАЯ ОРГАНИЗАЦИЯ ПО СТАНДАРТИЗАЦИИ • ORGANISATION INTERNATIONALE DE NORMALISATION

Cylindrical cutters with plain bore and key drive — Metric series

iTeh STANDARD PREVIEW

First edition — 1972-12-01

(standards.iteh.ai)

[ISO 2584:1972](#)

<https://standards.iteh.ai/catalog/standards/sist/d0b0fc71-2b60-46e3-a3fe-bc2ebb77c590/iso-2584-1972>



UDC 621.914.28

Ref. No. ISO 2584-1972 (E)

Descripteurs : tools, cutting tools, milling cutters, dimensions.

Price based on 1 page

FOREWORD

ISO (the International Organization for Standardization) is a worldwide federation of national standards institutes (ISO Member Bodies). The work of developing International Standards is carried out through ISO Technical Committees. Every Member Body interested in a subject for which a Technical Committee has been set up has the right to be represented on that Committee. International organizations, governmental and non-governmental, in liaison with ISO, also take part in the work.

Draft International Standards adopted by the Technical Committees are circulated to the Member Bodies for approval before their acceptance as International Standards by the ISO Council.

International Standard ISO 2584 was drawn up by Technical Committee ISO/TC 29, *Small tools*.

STANDARD PREVIEW
(standards.iteh.ai)

It was approved in February 1972 by the Member Bodies of the following countries :

[ISO 2584:1972](#)

<https://standards.iteh.ai/catalog/standards/sist/d0b0fc71-2b60-46e3-a3fe-bc2ebb7c990/iso-2584-1972>

Austria	Italy	Sweden
Belgium	Japan	Switzerland
Egypt, Arab Rep. of	Netherlands	Thailand
France	Poland	Turkey
Hungary	Romania	United Kingdom
India	South Africa, Rep. of	U.S.A.
Israel	Spain	U.S.S.R.

The Member Body of the following country expressed disapproval of the document on technical grounds :

Czechoslovakia

Cylindrical cutters with plain bore and key drive – Metric series

1 SCOPE AND FIELD OF APPLICATION

This International Standard specifies the dimensions of metric series cylindrical cutters with plain bore and key drive, intended for fitting to cutter arbors.

It is applicable to solid cutters and also to interlocking cutters.

Solid cutters are made either with straight teeth or with helicoidal teeth angled to the right or left; interlocking cutters are always made with straight or helicoidal teeth angled to the left and right alternately.

The range of outside diameters of these cutters is taken from ISO/R 523, *Recommended range of outside diameters for milling cutters*.

2 REFERENCE

ISO/R 240, *Interchangeability dimensions for milling cutters and cutter arbors or cutter mandrels – Metric series and inch series*.

iTeh STANDARD PREVIEW
(standards.iteh.ai)

3 DIMENSIONS

ISO 2584:1972

<https://standards.iteh.ai/catalog/standards/sist/d0b0fc71-2b60-46e3-a3fe-bc2ebb77c590/iso-2584-1972>

3.1 Solid cutters

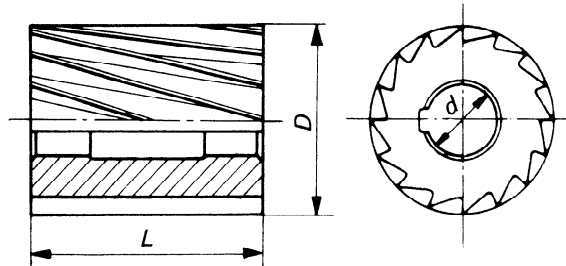

FIGURE 1 – Solid cutter

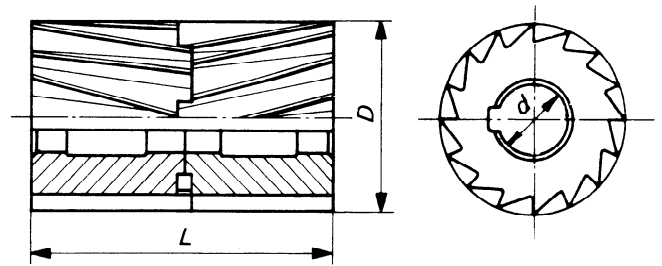

FIGURE 2 – Interlocking cutter

TABLE 1

TABLE 2

Dimensions in millimetres

D	d*	L						
		40	50	63	70	80	100	125
50	22	X		X		X		
63	27		X		X			
80	32			X			X	
100	40				X			X

Dimensions in millimetres

D	d*	L					
		80	100	125	160	200	250
80	32	X		X			
100	40		X		X		
125	50			X		X	
160	60				X		X

* The bore and keyway dimensions shall be in accordance with the metric series of ISO/R 240.

iTeh STANDARD PREVIEW
(standards.iteh.ai)

This page intentionally left blank

[ISO 2584:1972](#)

<https://standards.iteh.ai/catalog/standards/sist/d0b0fc71-2b60-46e3-a3fe-bc2ebb77c590/iso-2584-1972>