

**ISO**

transcription

INTERNATIONAL ORGANIZATION FOR STANDARDIZATION

**ISO RECOMMENDATION  
R 43**

**AIRCRAFT JACKING PADS**

**1<sup>st</sup> EDITION**

**July 1957**

**COPYRIGHT RESERVED**

The copyright of ISO Recommendations and ISO Standards belongs to ISO Member Bodies. Reproduction of these documents, in any country, may be authorized therefore only by the national standards organization of that country, being a member of ISO.

For each individual country the only valid standard is the national standard of that country.

Printed in Switzerland

Also issued in French and Russian. Copies to be obtained through the national standards organizations.

## AIRCRAFT JACKING PADS

1. The shape and size of standard aircraft jacking pads are limited to the four designs shown in the figures hereunder.
2. The jacking pads should, wherever possible, be permanently attached to aircraft strong points, but where this is not practicable and the pads are detachable, provision should be made for their carriage on the aircraft.

### Type 1. Aircraft jacking pads for reactions less than 10 000 lb (4 536 kg)

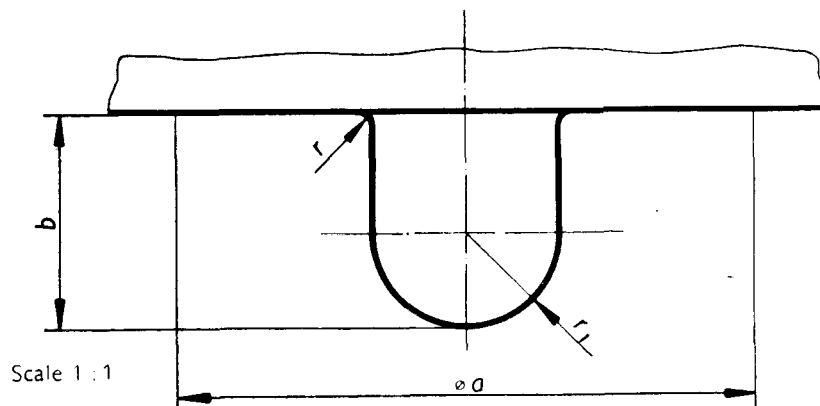

Dimensions	Inches	Millimetres	Notes
$a$	3	76.2	Minimum clear space
$b$	1 1/8	28.6	
$r$	1/16	1.6	Spherical radius
$r_1$	1/2	12.7	

### Type 2. Aircraft jacking pads for reactions of 10 000 lb (4 536 kg) to 112 000 lb (50 800 kg)

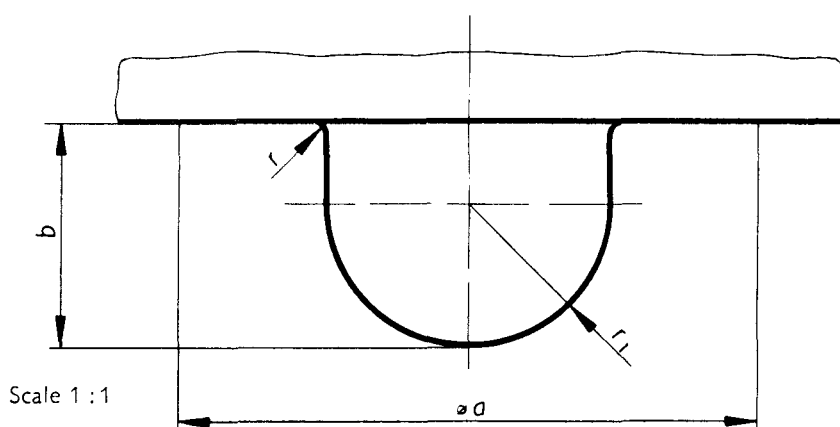

Dimensions	Inches	Millimetres	Notes
$a$	3	76.2	Minimum clear space
$b$	1 3/16	30.2	
$r$	1/16	1.6	Spherical radius
$r_1$	3/4	19.1	

**Type 3. Axle jacking pads for reactions less than 10 000 lb (4 536 kg)**

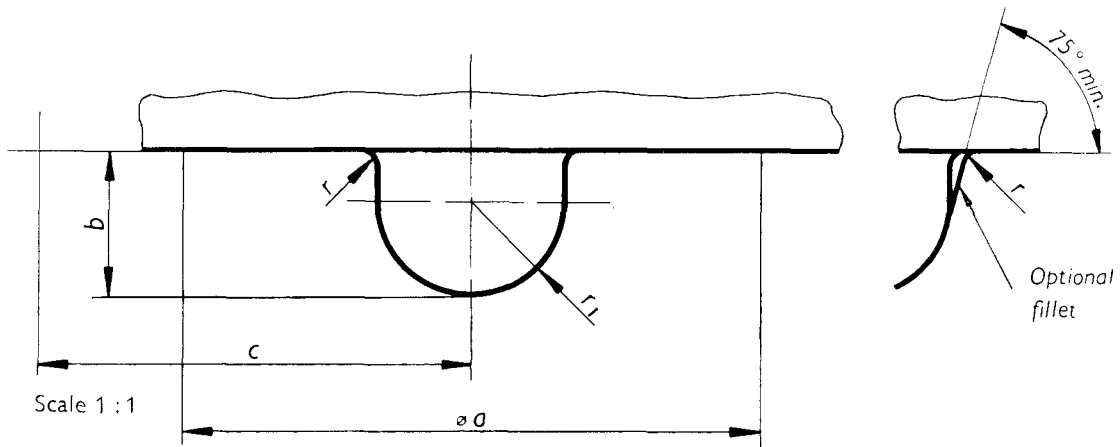

Dimensions	Inches	Millimetres	Notes
<i>a</i>	3	76.2	Minimum clear space
<i>b</i>	3/4	19.1	
<i>c</i>	2 1/4 min.	57.2 min.	Wheel or tyre clearance
<i>r</i>	1/16	1.6	
<i>r<sub>1</sub></i>	1/2	12.7	Spherical radius

**Type 4. Axle jacking pads for reactions of 10 000 lb (4 536 kg) to 112 000 lb (50 800 kg)**

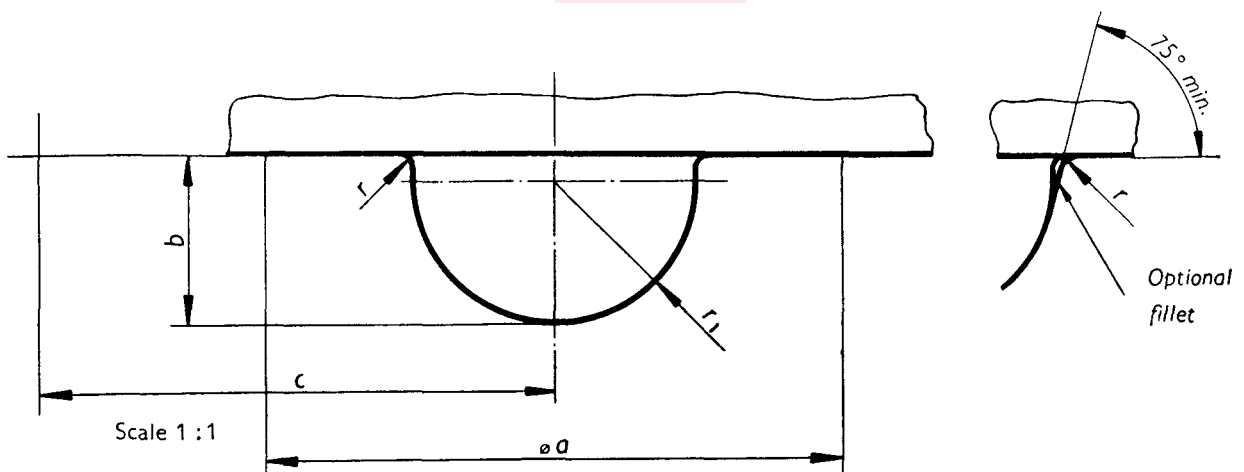

Dimensions	Inches	Millimetres	Notes
<i>a</i>	3	76.2	Minimum clear space
<i>b</i>	7/8	22.2	
<i>c</i>	3 1/2 min.	88.9 min.	Wheel or tyre clearance
<i>r</i>	1/16	1.6	
<i>r<sub>1</sub></i>	3/4	19.1	Spherical radius