**Izdelki za otroke – Hojce – Varnostne zahteve in preskusne metode
(vključno z dopolnilom A1)**

Child care articles – Baby walking frames – Safety requirements and test methods

Articles de puériculture – Trotteurs – Exigences de sécurité et méthodes d'essai

Artikel für Säuglinge und Kleinkinder – Kinderlaufhilfen – Sicherheitstechnische Anforderungen und Prüfverfahren

<https://standards.iteh.ai>
Document Preview

[SIST EN 1273:2021+A1:2024](https://standards.iteh.ai/catalog/standards/sist/0d7be79b-01b7-47ff-a609-c1aaa740f80d/sist-en-1273-2021a1-2024)

<https://standards.iteh.ai/catalog/standards/sist/0d7be79b-01b7-47ff-a609-c1aaa740f80d/sist-en-1273-2021a1-2024>

ICS 97.190

Referenčna oznaka
SIST EN 1273:2021+A1:2024 ((sl)en)

Nadaljevanje na straneh od II do III in od 1 do 64

NACIONALNI UVOD

Standard SIST EN 1273:2021+A1 ((sl)en), Izdelki za otroke – Hojce – Varnostne zahteve in preskusne metode (vključno z dopolnilom A1), 2024, ima status slovenskega standarda in je po metodi ponatisa izvirnika z nacionalnim dodatkom privzet evropski standard EN 1273:2020+A1 (en), Child care articles – Baby walking frames – Safety requirements and test methods, 2023.

Ta slovenski standard nadomešča SIST EN 1273:2021.

NACIONALNI PREDGOVOR

Evropski standard EN 1273:2020+A1:2023 je pripravil tehnični odbor Evropskega komiteja za standardizacijo CEN/TC 252 "Izdelki za otroke", katerega sekretariat vodi AFNOR.

Ta dokument je bil pripravljen na podlagi mandata M/264, ki sta ga Evropska komisija in Evropsko združenje za prosto trgovino dodelila CEN.

Odločitev za izdajo tega standarda je 9. maja 2024 sprejel tehnični odbor SIST/TC OTR Izdelki za otroke.

NACIONALNI DODATEK

Dodatek C

(informativni)

Opozorila

K preglednici C.1, ki navaja prevode opozoril, navedenih v točki 9, se doda slovenski prevod:

Preglednica C.1: Prevodi opozoril

Slovenian	
9.2	[1] OPOZORILO!
	[2] Preprečite otroku dostop do stopnišč, stopnic in neravnih površin.
	[3] Nikoli ne puščajte otroka brez nadzora.
9.3	[1] OPOZORILO!
	[2] Nikoli ne puščajte otroka brez nadzora.
	[3] Preprečite otroku dostop do stopnišč, stopnic in neravnih površin.
9.4	POMEMBNO! POZORNO PREBERITE NAVODILA IN JIH SHRANITE KOT NAPOTEK ZA V PRIHODNJE.
	[1] OPOZORILO!
	[2] Nikoli ne puščajte otroka brez nadzora.
	[3] S hojco se otrok lahko premika hitreje in tako pride dlje.
	[4] Preprečite otroku dostop do stopnišč, stopnic in neravnih površin.
	[5] Zavarujte dostop do ognja, grelnih in kuhalnih naprav.
	[6] Odstranite vroče tekočine, električne kable in druge možne nevarnosti iz dosega otroka.
	[7] Preprečite, da bi otrok trčil v steklo v vratih, oknih in pohištvu.

ZVEZA Z NACIONALNIMI STANDARDI

S privzemom tega evropskega standarda veljajo za omejeni namen referenčnih standardov vsi standardi, navedeni v izvirniku, razen standardov, ki so že sprejeti v nacionalno standardizacijo:

SIST EN 71-2:2021

Varnost igrač – 2. del: Vnetljivost

SIST EN 71-3:2019+A1:2021	Varnost igrač – 3. del: Migracija določenih elementov (vključno z dopolnilom A1)
SIST EN 71-10:2006	Varnost igrač – 10. del: Organske kemijske spojine – Priprava vzorcev in ekstrakcija
SIST EN 71-11:2006	Varnost igrač – 11. del: Organske kemijske spojine – Analizne metode
SIST EN 622-1:2004	Vlaknene plošče – Specifikacije – 1. del Splošne zahteve
SIST EN 717-1:2005	Lesne plošče – Ugotavljanje sproščanja formaldehida – 1. del: Sproščanje formaldehida po komorni metodi
SIST EN ISO 105-A03:2019	Tekstilije – Preskušanje barvne obstojnosti – Del A03: Siva skala za ocenjevanje prehoda obarvanja spremljajočih tkanin (ISO 105-A03:2019)
SIST EN ISO 14184-1:2011	Tekstilije – Določevanje formaldehida – 1. del: Prosti in hidrolizirani formaldehid (vodna ekstrakcija) (ISO 14184-1:2011)
SIST EN ISO 14362-1:2017	Tekstilije – Metode za določevanje nekaterih aromatskih aminov, izvirajočih iz azo barvil – 1. del: Zaznavanje prisotnosti določenih azo barvil, dostopnih z ekstrahiranjem vlaken in brez njega (ISO 24362-1:2017)
SIST EN ISO 2813:2015	Barve in laki – Ugotavljanje vrednosti sijaja pod koti 20, 60 in 85 stopinj (ISO 2813:2014)
SIST EN ISO 2439:2009	Penjeni polimerni materiali – Mehke pene – Ugotavljanje trdote (odpornost proti vtiskovanju) (ISO 2439:2008)

OSNOVA ZA IZDAJO

- privzem standarda EN 1273:2020+A1:2023

PREDHODNE IZDAJE

- SIST EN 1273:2021
- SIST EN 1273:2005
- SIST EN 1273:2002

OPOMBE

- Powsod, kjer se v besedilu standarda uporablja izraz “evropski standard”, v SIST EN 1273:2021+A1:2024 to pomeni “slovenski standard”.
- Ta nacionalni dokument je istoveten EN 1273:2020+A1:2023 in je objavljen z dovoljenjem

Upravni center
CEN-CENELEC
Rue de la Science 23
B-1040 Bruselj

This national document is identical with EN 1273:2020+A1:2023 and is published with the permission of

CEN-CENELEC
Management Centre
Rue de la Science 23
B-1040 Brussels

EUROPEAN STANDARD

EN 1273:2020+A1

NORME EUROPÉENNE

EUROPÄISCHE NORM

December 2023

ICS 97.190

Supersedes EN 1273:2020

English Version

Child care articles - Baby walking frames - Safety requirements and test methods

Articles de puériculture - Trotteurs - Exigences de sécurité et méthodes d'essai

Artikel für Säuglinge und Kleinkinder - Kinderlaufhilfen - Sicherheitstechnische Anforderungen und Prüfverfahren

This European Standard was approved by CEN on 24 May 2020 and includes Amendment approved by CEN on 20 November 2023.

CEN members are bound to comply with the CEN/CENELEC Internal Regulations which stipulate the conditions for giving this European Standard the status of a national standard without any alteration. Up-to-date lists and bibliographical references concerning such national standards may be obtained on application to the CEN-CENELEC Management Centre or to any CEN member.

This European Standard exists in three official versions (English, French, German). A version in any other language made by translation under the responsibility of a CEN member into its own language and notified to the CEN-CENELEC Management Centre has the same status as the official versions.

CEN members are the national standards bodies of Austria, Belgium, Bulgaria, Croatia, Cyprus, Czech Republic, Denmark, Estonia, Finland, France, Germany, Greece, Hungary, Iceland, Ireland, Italy, Latvia, Lithuania, Luxembourg, Malta, Netherlands, Norway, Poland, Portugal, Republic of North Macedonia, Romania, Serbia, Slovakia, Slovenia, Spain, Sweden, Switzerland, Türkiye and United Kingdom.

[SIST EN 1273:2021+A1:2024](https://standards.iteh.ai/catalog/standards/sist/0d7be79b-01b7-47ff-a609-c1aaa740f80d/sist-en-1273-2021a1-2024)

<https://standards.iteh.ai/catalog/standards/sist/0d7be79b-01b7-47ff-a609-c1aaa740f80d/sist-en-1273-2021a1-2024>



EUROPEAN COMMITTEE FOR STANDARDIZATION
COMITÉ EUROPÉEN DE NORMALISATION
EUROPÄISCHES KOMITEE FÜR NORMUNG

CEN-CENELEC Management Centre: Rue de la Science 23, B-1040 Brussels

Contents

Page

European foreword.....	5
Introduction	6
1 Scope.....	7
2 Normative references.....	7
3 Terms and definitions	7
4 Test equipment.....	8
4.1 Test masses	8
4.1.1 Test mass A.....	8
4.1.2 Test mass B.....	8
4.1.3 Test mass C.....	8
4.1.4 Test mass D.....	9
4.2 Small parts cylinder	10
4.3 Feeler gauge	10
4.4 Test probes for finger entrapment	11
4.4.1 Test probes with hemispherical end.....	11
4.4.2 Shape assessment probe	12
4.5 Test platform for stability test	12
4.6 Test equipment for dynamic stability	13
4.6.1 Test platform	13
4.6.2 Spacer	13
4.7 Test equipment for prevention of fall down steps test	13
4.7.1 Test platform	13
4.7.2 Steel cable	14
4.7.3 Pulley.....	14
4.7.4 Aluminium angle	14
4.7.5 Rigid plate.....	14
4.7.6 Structural characteristics for the test equipment.....	14
4.8 Foam.....	15
5 General requirements and test conditions.....	15
5.1 Product conditioning.....	15
5.2 Test conditions.....	15
5.3 Application of forces	15
5.4 Tolerances	16
5.5 Order of tests	16
6 Chemical hazards (see A.2).....	16
6.1 General.....	16
6.2 Migration of certain elements (see A.2).....	16
6.3 Formaldehyde (see A.2).....	17
6.4 Colourants (see A.2)	17
6.5 Aniline (see A.2).....	17
7 Thermal hazards (see A.3).....	18
7.1 Requirement.....	18
7.2 Test method	18

8	Mechanical hazards (see A.4)	18
8.1	Entrapment hazards (see A.4.1)	18
8.1.1	Requirements	18
8.1.2	Test methods	19
8.2	Hazards due to moving parts (see A.4.2)	19
8.2.1	General	19
8.2.2	Requirements for compression points	19
8.2.3	Requirements for shear points	19
8.3	Protective function of the seat	19
8.3.1	General	19
8.3.2	Crotch strap	19
8.3.3	Removable seats	19
8.3.4	Seat height	20
8.4	Hazards due to height adjustment and folding of the product	20
8.4.1	Requirements	20
8.4.2	Test methods for height adjustment and folding mechanisms	21
8.5	Strangulation hazards due to cords, ribbons and similar parts (see A.4.3)	21
8.5.1	Requirements	21
8.5.2	Test method	22
8.6	Choking and ingestion hazard (see A.4.4)	22
8.6.1	Requirements	22
8.6.2	Test methods	22
8.7	Suffocation hazards from plastic packaging (see A.4.5)	23
8.7.1	Plastic packaging	23
8.7.2	Plastic decals	24
8.8	Hazards from edges, corners and protruding parts (see A.4.6)	24
8.9	Hazards from inadequate structural integrity (see A.4.7)	24
8.9.1	Static strength	24
8.9.2	Dynamic strength	25
8.10	Hazards from inadequate stability (see A.4.8)	25
8.10.1	Static stability	25
8.10.2	Dynamic stability	25
8.11	Hazards due to falling down stairs (see A.4.9)	26
8.11.1	Requirements	26
8.11.2	Test method	26
8.11.3	Tip over test	30
8.12	Parking devices	31
8.12.1	Requirements	31
8.12.2	Test method	31
9	Product information	32
9.1	General	32
9.2	Marking of the product	33
9.3	Purchase information	33
9.4	Instructions for use	34
Annex A (informative) Rationales		36
A.1	Introduction	36
A.2	Chemical hazards (see Clause 6)	36
A.3	Thermal hazards (see Clause 7)	36
A.4	Mechanical hazards (see Clause 8)	36
A.4.1	Entrapment hazards (see 8.1)	36

EN 1273:2020+A1:2023 (E)

A.4.2 Hazards due to moving parts (see 8.2).....	37
A.4.3 Strangulation hazards (see 8.5).....	37
A.4.4 Choking and ingestion hazards (see 8.6).....	37
A.4.5 Suffocation hazards (see 8.7).....	37
A.4.6 Hazardous edges, corners and protruding parts (see 8.8).....	37
A.4.7 Hazards from inadequate structural integrity (see 8.9).....	37
A.4.8 Hazards from inadequate stability (see 8.10)	37
A.4.9 Hazards due to falling down stairs (see 8.11).....	37
Annex B (normative) Test platform for tip over test.....	38
Annex C (A1) Informative (A1) Warnings.....	39
Annex D (informative) A-deviations.....	60
Annex ZA (A1) (Informative) Relationship between this European Standard and the safety requirements of Directive 2001/95/EC aimed to be covered	61

iTeh Standards
(<https://standards.itih.ai>)
Document Preview

[SIST EN 1273:2021+A1:2024](https://standards.itih.ai/catalog/standards/sist/0d7be79b-01b7-47ff-a609-c1aaa740f80d/sist-en-1273-2021a1-2024)

<https://standards.itih.ai/catalog/standards/sist/0d7be79b-01b7-47ff-a609-c1aaa740f80d/sist-en-1273-2021a1-2024>

European foreword

This document (EN 1273:2020+A1:2023) has been prepared by Technical Committee CEN/TC 252 “Child care articles”, the secretariat of which is held by AFNOR.

This European standard shall be given the status of a national standard, either by publication of an identical text or by endorsement, at the latest by June 2024, and conflicting national standards shall be withdrawn at the latest by June 2024.

Attention is drawn to the possibility that some of the elements of this document may be the subject of patent rights. CEN shall not be held responsible for identifying any or all such patent rights.

This document supersedes A1 EN 1273:2020 A1.

This document includes Amendment 1 approved by CEN on 20 November 2023.

The start and finish of text introduced or altered by amendment is indicated in the text by tags A1 A1.

In comparison with the previous edition EN 1273:2005, the following major technical modifications have been made:

- general redraft in hazard based format;
- addition of new chemical requirements based on CEN/TR 13387-2;
- general update of some mechanical requirements and test methods to the state of the art of CEN/TR 13387-3;
- improvement of the requirements and test methods for static and dynamic strength;
- modification of the test method for prevention of falls down stairs to improve reproducibility of results;
- update of product information section and addition of a new symbol from CEN/TR 13387-5.

A1 This document has been prepared under mandate M/264 given to CEN by the European Commission and the European Free Trade Association, and supports the basic requirements of Directive 2001/95/EC. For relationship with EU Regulation(s) / Directive(s), see informative Annex ZA which is an integral part of this document. A1

According to the CEN-CENELEC Internal Regulations, the national standards organisations of the following countries are bound to implement this European standard: Austria, Belgium, Bulgaria, Croatia, Cyprus, Czech Republic, Denmark, Estonia, Finland, France, Germany, Greece, Hungary, Iceland, Ireland, Italy, Latvia, Lithuania, Luxembourg, Malta, Netherlands, Norway, Poland, Portugal, Republic of North Macedonia, Romania, Serbia, Slovakia, Slovenia, Spain, Sweden, Switzerland, Turkey and the United Kingdom.

EN 1273:2020+A1:2023 (E)**Introduction**

The purpose of this document is to reduce the risk of accidents.

It is stressed that this document cannot eliminate all possible risks to children using such a product and that carer control is of paramount importance. Accidents are mainly due to carer(s) not anticipating the extra reach and speed that children can achieve in the baby walking frame.

It is essential that all warnings and instructions specified in this standard are clearly given by the manufacturer, to ensure that the baby walking frame can be used safely and correctly.

iTeh Standards
(<https://standards.iteh.ai>)
Document Preview

[SIST EN 1273:2021+A1:2024](https://standards.iteh.ai/catalog/standards/sist/0d7be79b-01b7-47ff-a609-c1aaa740f80d/sist-en-1273-2021a1-2024)

<https://standards.iteh.ai/catalog/standards/sist/0d7be79b-01b7-47ff-a609-c1aaa740f80d/sist-en-1273-2021a1-2024>

1 Scope

This document specifies safety requirements and test methods for baby walking frames into which a child is placed, and intended to be used from when the child is able to sit up by itself until the child is able to walk by itself.

This document does not apply to baby walking frames for therapeutic and curative purposes and to those baby walking frames relying on inflatable parts to support the child.

Toys (e.g. ride on toys, push-along toys, usually intended for children able to walk unaided) are not covered by this document.

If a baby walking frame has several functions or can be converted into another function, the relevant European standards apply to it.

2 Normative references

The following documents are referred to in the text in such a way that some or all of their content constitutes requirements of this document. For dated references, only the edition cited applies. For undated references, the latest edition of the referenced document (including any amendments) applies.

EN 71-2:2020, *Safety of toys - Part 2: Flammability*

EN 71-3:2019+A1:2021, *Safety of toys - Part 3: Migration of certain elements*

EN 71-10:2005, *Safety of toys - Part 10: Organic chemical compounds - Sample preparation and extraction*

EN 71-11:2005, *Safety of toys - Part 11: Organic chemical compounds - Methods of analysis*

EN 622-1:2003, *Fibreboards - Specifications - Part 1: General requirements*

EN 717-1:2004, *Wood-based panels - Determination of formaldehyde release - Part 1: Formaldehyde emission by the chamber method*

EN ISO 105-A03:2019, *Textiles - Tests for colour fastness - Part A03: Grey scale for assessing staining*

EN ISO 14184-1:2011, *Textiles - Determination of formaldehyde - Part 1: Free and hydrolysed formaldehyde (water extraction method)*

EN ISO 14362-1:2017, *Textiles - Methods for determination of certain aromatic amines derived from azo colorants - Part 1: Detection of the use of certain azo colorants accessible with and without extracting the fibres*

EN ISO 2813:2014, *Paints and varnishes - Determination of gloss value at 20°, 60° and 85°*

EN ISO 2439:2008, *Flexible cellular polymeric materials - Determination of hardness (indentation technique)* ^(A1)

3 Terms and definitions

For the purposes of this document, the following terms and definitions apply.

ISO and IEC maintain terminological databases for use in standardization at the following addresses:

- IEC Electropedia: available at <http://www.electropedia.org/>
- ISO Online browsing platform: available at <https://www.iso.org/obp>

3.1

baby walking frame

structure with a seat in which a child is placed in a sitting or standing position, which allows a child to move around with the aid of the support offered by the frame

EN 1273:2020+A1:2023 (E)

3.2

crotch strap

device which passes between the child's legs to prevent the child slipping out of the seat

3.3

base

lower part of the frame where castors or wheels may be attached

3.4

parking device

device to maintain the baby walking frame in a stationary position

4 Test equipment

4.1 Test masses

4.1.1 Test mass A

Test mass A is a rigid cylinder (160 ± 5) mm in diameter and (280 ± 5) mm in height, having a mass of $12_0^{+0,1}$ kg and with its centre of gravity in the centre of the cylinder. All edges shall have a radius of (20 ± 1) mm. See Figure 1.

4.1.2 Test mass B

Test mass B is a rigid cylinder (160 ± 5) mm in diameter and (280 ± 5) mm in height, having a mass of $7,65_0^{+0,1}$ kg and with its centre of gravity in the centre of the cylinder. All edges shall have a radius of (20 ± 1) mm. See Figure 1.

4.1.3 Test mass C

Test mass C is a rigid cylinder (160 ± 5) mm in diameter and (280 ± 5) mm in height, having a mass of $12,6_0^{+0,1}$ kg and with its centre of gravity in the centre of the cylinder. All edges shall have a radius of (20 ± 1) mm. See Figure 1.

Dimensions in millimetres

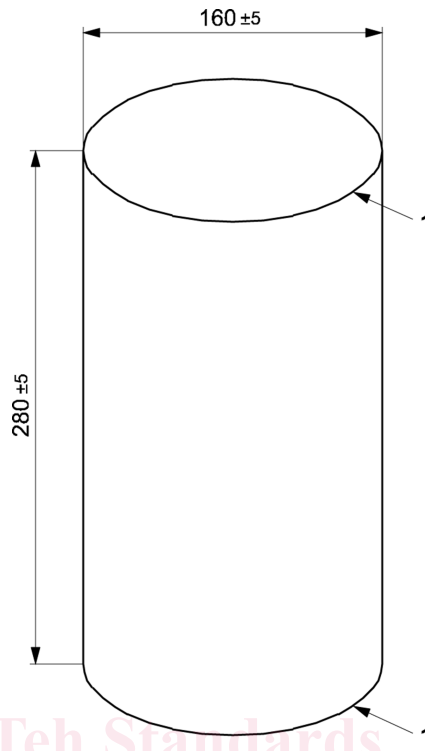
**Key**

1

Radius: (20 ± 1) mm

Test Mass A	Mass $12_0^{+0,1}$ kg
Test Mass B	Mass $7,65_0^{+0,1}$ kg
Test Mass C	Mass $12,6_0^{+0,1}$ kg

Figure 1 — Test mass A, B and C**4.1.4 Test mass D**

Test mass D is a mass of $3,6_0^{+0,1}$ kg with a flat circular bottom surface. See Figure 2.

EN 1273:2020+A1:2023 (E)

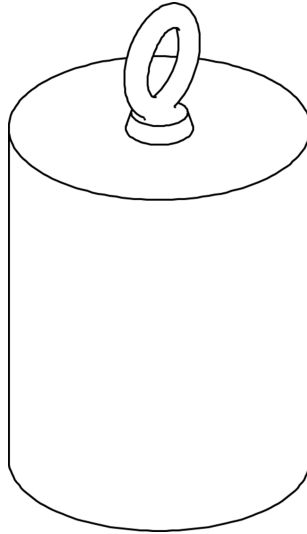

Figure 2 — Test mass D

4.2 Small parts cylinder

Small parts cylinder for the assessment of small components, having dimensions in accordance with Figure 3.

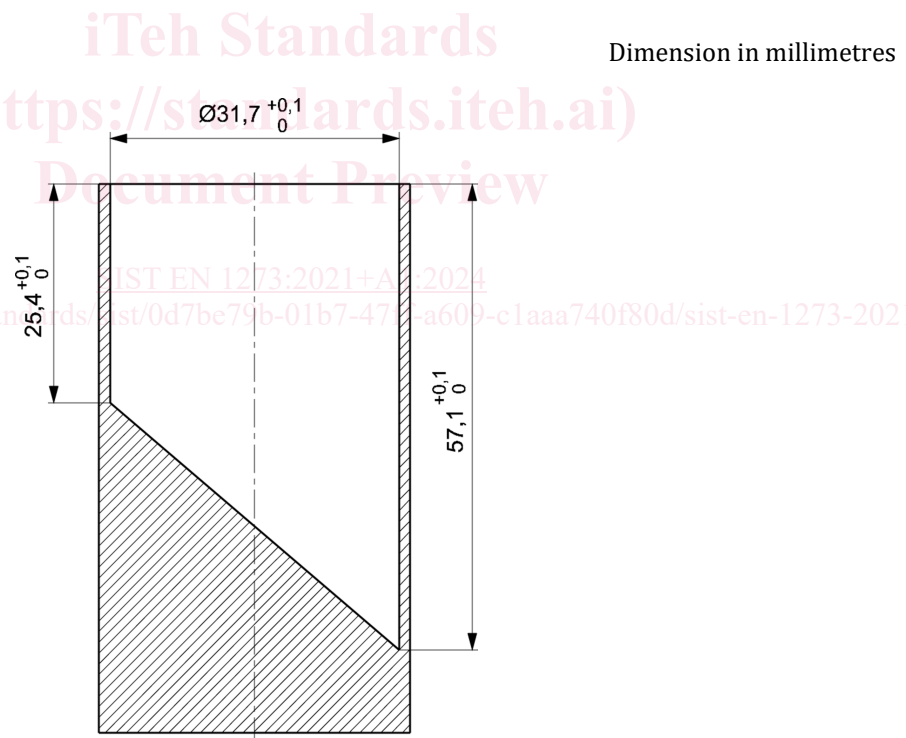

Figure 3 — Small parts cylinder

4.3 Feeler gauge

Gauge with a thickness of $(0,4 \pm 0,02)$ mm and an insertion edge radius of $(3 \pm 0,5)$ mm (see Figure 4).