



SLOVENSKI STANDARD

SIST EN 840-6:2000

01-december-2000

Mobilni zbiralniki odpadkov - 6. del: Varnostne in zdravstvene zahteve

Mobile waste containers - Part 6: Safety and health requirements

Fahrbare Abfallsammelbehälter - Teil 6: Sicherheits- und Gesundheitsanforderungen

Conteneurs roulants a déchets - Partie 6: Exigences d'hygiene et de sécurité

Ta slovenski standard je istoveten z: **EN 840-6:1997**

[SIST EN 840-6:2000](https://standards.iteh.ai/catalog/standards/sist/08e88021-e990-423b-81f9-194ea1064115/sist-en-840-6-2000)

<https://standards.iteh.ai/catalog/standards/sist/08e88021-e990-423b-81f9-194ea1064115/sist-en-840-6-2000>

ICS:

13.030.40	Naprave in oprema za odstranjevanje in obdelavo odpadkov	Installations and equipment for waste disposal and treatment
-----------	--	--

SIST EN 840-6:2000

en

iTeh STANDARD PREVIEW
(standards.iteh.ai)

SIST EN 840-6:2000

<https://standards.iteh.ai/catalog/standards/sist/08e88021-e990-423b-81f9-194ea1064115/sist-en-840-6-2000>

EUROPEAN STANDARD

EN 840-6

NORME EUROPÉENNE

EUROPÄISCHE NORM

January 1997

ICS 13.030

Descriptors: handling equipment, travelling containers, freight containers, collecting, wastes, solids, specifications, safety, hygiene, utilization, technical notices

English version

Mobile waste containers - Part 6: Safety and health requirements

Conteneurs roulants à déchets - Partie 6: Mobile waste containers - Part 6: Fahrbare Abfallsammelbehälter - Teil 6: Exigences d'hygiène et de sécurité Sicherheits- und Gesundheitsanforderungen

(standards.iteh.ai)

[SIST EN 840-6:2000](https://standards.iteh.ai/catalog/standards/sist/08e88021-e990-423b-81f9-194ea1064115/sist-en-840-6-2000)

<https://standards.iteh.ai/catalog/standards/sist/08e88021-e990-423b-81f9-194ea1064115/sist-en-840-6-2000>

This European Standard was approved by CEN on 1996-12-19. CEN members are bound to comply with the CEN/CENELEC Internal Regulations which stipulate the conditions for giving this European Standard the status of a national standard without any alteration.

Up-to-date lists and bibliographical references concerning such national standards may be obtained on application to the Central Secretariat or to any CEN member.

The European Standards exist in three official versions (English, French, German). A version in any other language made by translation under the responsibility of a CEN member into its own language and notified to the Central Secretariat has the same status as the official versions.

CEN members are the national standards bodies of Austria, Belgium, Denmark, Finland, France, Germany, Greece, Iceland, Ireland, Italy, Luxembourg, Netherlands, Norway, Portugal, Spain, Sweden, Switzerland and United Kingdom.

CEN

European Committee for Standardization
Comité Européen de Normalisation
Europäisches Komitee für Normung

Central Secretariat: rue de Stassart, 36 B-1050 Brussels

Contents

	Page
Foreword	3
1 Scope	3
2 Normative references	3
3 General requirements of construction	4
4 Handles	4
5 Wheels	6
6 Direction block	6
7 Brakes	6
8 Edges	6
9 Lids	6
10 Cleaning	6
11 Instructions for use	6
Annex A (informative) Bibliography	7
Annex B (informative) A-Deviations	8

iTeh STANDARD PREVIEW
(standards.iteh.ai)

SIST EN 840-6:2000

<https://standards.iteh.ai/catalog/standards/sist/08e88021-e990-423b-819-194ea1064113/sist-en-840-6-2000>



Foreword

This European Standard has been prepared by Technical Committee CEN/TC 183 "Waste management", the secretariat of which is held by DIN.

This European Standard shall be given the status of a national standard, either by publication of an identical text or by endorsement, at the latest by July 1997, and conflicting national standards shall be withdrawn at the latest by July 1997.

This part of EN 840 is not prepared to be a standard in the sense of fulfilling the council directive 89/492/EEC (machine directive) or associated EU or EFTA regulations.

This European Standard is one part of the series of standards of EN 840 about "Mobile waste containers" comprising the following parts:

- Part 1: Mobile waste containers - Part 1: Containers with 2 wheels with a capacity from 80 l to 390 l for comb lifting devices, dimensions and design
- Part 2: Mobile waste containers - Part 2: Containers with 4 wheels with a capacity from 500 l to 1200 l with flat lid(s), for trunnion and/or lifting devices, dimensions and design
- Part 3: Mobile waste containers - Part 3: Containers with 4 wheels with a capacity from 770 l to 1300 l with dome lid(s), for trunnion and/or comb lifting devices, dimensions and design
- Part 4: Mobile waste containers - Part 4: Containers with 4 wheels with a capacity from 750 l to 1700 l with flat lid(s), for wide trunnion or BG and/or wide comb lifting devices, dimensions and design
- Part 5: Mobile waste containers - Part 5: Performance requirements and test methods
- Part 6: Mobile waste containers - Part 6: Safety and health requirements

This standard considers the possibility of further using the existing lifting devices of the collection vehicles. It does not deal with special containers for hazardous waste.

To help in the understanding of the requirements they are not split into separate safety, ergonomic and health sections but are divided into chapters dealing with constructional units.

According to the CEN/CENELEC Internal Regulations, the national standards organizations of the following countries are bound to implement this European Standard: Austria, Belgium, Denmark, Finland, France, Germany, Greece, Iceland, Ireland, Italy, Luxembourg, Netherlands, Norway, Portugal, Spain, Sweden, Switzerland and the United Kingdom.

1 Scope

This part of EN 840 provides the most essential safety and health requirements for mobile waste containers, not including hazardous wastes containers.

2 Normative references

This European Standard incorporates by dated or undated references, provisions from other publications. These normative references are cited at the appropriate places in the text and the publications are listed hereafter. For dated references, subsequent amendments to or revisions of any of these publications apply to this European Standard only when incorporated in it by amendment or revision. For undated references the latest edition of the publication referred to applies.

- EN 840-1 Mobile waste containers - Part 1: Containers with 2 wheels, with a capacity from 80 l to 390 l for comb lifting devices, dimensions and design
- EN 840-2 Mobile waste containers - Part 2: Containers with 4 wheels, with a capacity from 500 l to 1200 l with flat lids for trunnion and/or lifting, dimensions and design
- EN 840-3 Mobile waste containers - Part 3: Containers with 4 wheels, with a capacity from 770 l to 1300 l with dome lids, for trunnions and/or comb lifting devices, dimensions and design
- EN 840-4 Mobile waste containers - Part 4: Containers with 4 wheels, with a capacity from 750 l to 1700 l with flat lid, wide trunnions or BG-lifting device and/or wide comb lifting device, dimensions and design
- EN 840-5:1997 Mobile waste containers - Part 5: Requirements and test methods

3 General requirements of construction

3.1 The container shall be constructed so that when it is unloaded or loaded with a nominal load, it has a good fit on an approved compatible lifting device and must be automatically locked safely into the lifting device during the tilting and emptying operation.

3.2 It has to be ensured that the container can be safely fitted to the lifting device of the vehicle without being carried or lifted manually.

3.3 Wheeled containers shall be constructed so that under test conditions according to EN 840-5 the pushing and pulling forces to keep the container moving shall not exceed the values given in 4.9 of EN 840-5:1997. Pushing and pulling forces shall be declared in the instructions for use (see clause 11).

3.4 During construction of containers the following factors influencing measurable handling force shall be optimized:

- design of container as regards form, size and position of centre of gravity in relation to positioning of wheels and handles
- even distribution of loads on wheels
- low rolling resistance.

4 Handles

4.1 Two wheeled containers shall have handles for pulling, pushing and manoeuvring the container that enables the operator to grip safely with two hands.

Four wheeled containers shall have handles for pushing, pulling, manoeuvring and lifting the container.

4.2 Handles for pulling, pushing and manoeuvring the container shall have one of the external form as shown in figure 1 (based on the external form of figure 1 ring form section and U-shaped form section are permitted). A minimum length of 120 mm and a minimum clearance of 36 mm around the handle is required (see figure 2).

4.3 Handles for pulling, pushing and manoeuvring the container have to be positioned at a height of $(900 \pm_{25}^{200})$ mm above the ground. On two wheeled containers these handles shall have a minimum height of 800 mm in a tilted position (centre of gravity above the wheel axle). On four wheeled containers vertical handles are optional. If they are fitted they shall be a minimum of 450 mm apart and shall cover a height range from 780 mm to 1050 mm.

4.4 Handles for lifting containers over kerbstones shall have a height from the ground of between 700 and 850 mm.

4.5 If handles are positioned above the trunnion they shall have a safety guard according to figure 3.

Outer dimensions in mm

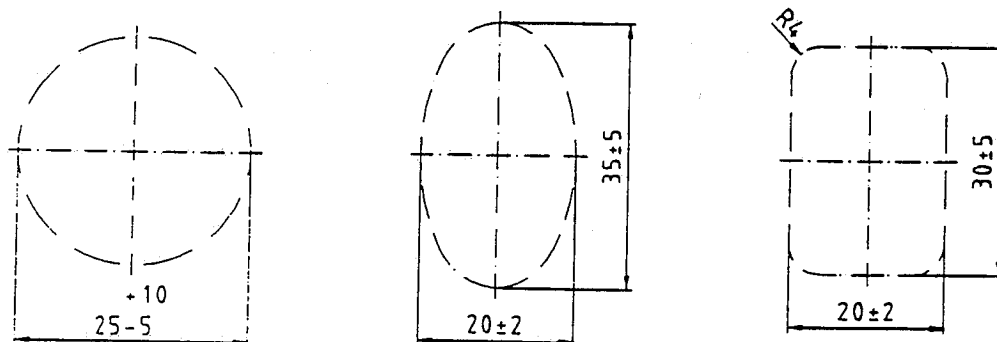

Figure 1: Handles (round, oval, rectangular)

dimensions in mm

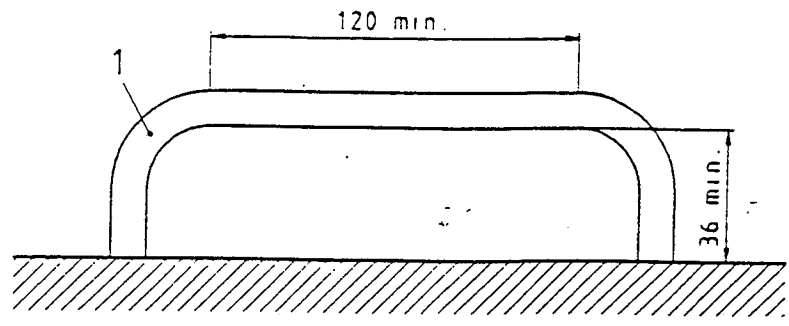
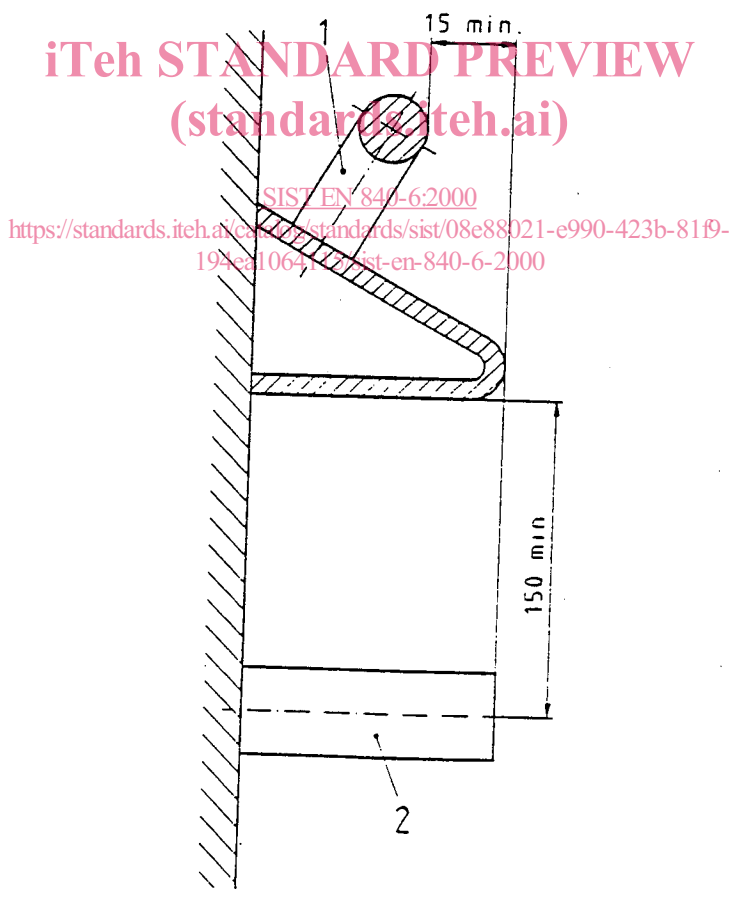

Figure 2: Clearance



- 1 Handle
- 2 Trunnion

Figure 3: Handles above trunnion

5 Wheels

5.1 Containers with 4 wheels and a capacity not exceeding 2000 l shall have all wheels as swivel castors.

5.2 The wheels and their position shall ensure a minimum of pushing/pulling force and a good stability.

5.3 All wheels on all containers shall have a diameter of nominal 200 mm. Wheels diameter of 160 mm on 4wheeled containers may be optional as long as the pulling and pushing forces are not exceeded (see 3.3).

5.4 All wheels respectively castors shall be constructed to resist static and dynamic stress, e. g. by rolling against kerbstones (test according to EN 840-5).

6 Direction Block

When direction blocks are fitted on containers with 4 wheels they shall be fitted to at least 2 wheels.

7 Brakes

When brakes are fitted on containers with 4 wheels they shall be fitted to at least 2 wheels.

7.1 The brakes shall be adjustable and able to hold the container on a 10° (ten degrees) incline at a minimum.

7.2 Brakes shall be able to be easily used by the operator.

7.3 If containers are fitted with a central brake locking system it must be possible to secure it against unauthorized unlocking.

7.4 The brakes are to be tested according to 4.9.3 of EN 840-5:1997.

8 Edges

8.1 Sharp edges have to be avoided in any case.

8.2 All edges which may be used for manoeuvring shall be rounded so that nobody can be injured.

9 Lids

9.1 To avoid the danger of crushed fingers when closing the lid, dome lids shall have a safety clearance to the front edge of at least 35 mm. The gap shall be closed by an elastic material.

Flat lids shall not damage fingers.

9.2 Containers with dome lids are to be provided with a mechanism to hold the lid open automatically and prevent it from accidentally closing.

9.3 Containers with assisted lids are to be provided with a device to ensure that the container lid cannot cause injury by its movement.

10 Cleaning

Containers shall be designed for easy cleaning.

11 Instructions for use

11.1 Instructions for use are to be supplied so that the operator can have access to all available information on the correct use of containers.

Those instructions are to give information on all relevant factors to enable correct usage of a container. Also safety and health requirements shall be included.

11.2 In order to give purchasers and all operators of the container information necessary for a correct choice and safe use of the containers, as a minimum the following information shall be given in the instructions:

- number of the European Standard (e.g. EN 840-2)
- the volume
- the total permissible mass
- the wheel diameter
- the type of the wheel bearings
- whenever direction blocks are fitted or not
- whenever brakes are equipped or not
- the adjusted braking torque
- whether central brake lock is equipped
- the pulling force, measured during the type test (see EN 840-5)
- essential dimensions including height of handles in the upright and tilted position.

These information shall be conform with the delivered container.

Annex A (informative)**Bibliography**

Council directive 89/392/EEC of 14 June 1989 on the approximation of the laws of the Member States relating to machinery

Council directive 91/368/EEC of 20 June 1991 as an amendment to the directive 89/392/EEC on the approximation of the laws of the Member States relating to machinery

Council directive 93/44/EEC of 14 June 1993 as an amendment to the directive 89/392/EEC on the approximation of the laws of Member States relating to machinery

Council directive 93/68/EEC of 22 July 1993 as an amendment to the directive 89/392/EEC (Machinery)

iTeh STANDARD PREVIEW
(standards.iteh.ai)

[SIST EN 840-6:2000](https://standards.iteh.ai/catalog/standards/sist/08e88021-e990-423b-81f9-194ea1064115/sist-en-840-6-2000)

<https://standards.iteh.ai/catalog/standards/sist/08e88021-e990-423b-81f9-194ea1064115/sist-en-840-6-2000>