



**SLOVENSKI STANDARD**  
**SIST EN 22338:1996**

**01-april-1996**

---

**Valjasti zatiči, nekaljeni**

Parallel pins, unhardened (ISO 2338:1986)

Zylinderstifte, ungehärtet (ISO 2338:1986)

Goupilles cylindriques non trempées (ISO 2338:1986)

**Ta slovenski standard je istoveten z: EN 22338:1992**

[SIST EN 22338:1996](https://standards.iteh.ai/catalog/standards/sist/aebba94b-83f7-4435-ab6c-bce6608f4bef/sist-en-22338-1996)

<https://standards.iteh.ai/catalog/standards/sist/aebba94b-83f7-4435-ab6c-bce6608f4bef/sist-en-22338-1996>

**ICS:**

21.060.50      Zatiči, žablji      Pins, nails

**SIST EN 22338:1996**      **en**

**iTeh STANDARD PREVIEW**  
**(standards.iteh.ai)**

SIST EN 22338:1996

<https://standards.iteh.ai/catalog/standards/sist/aebba94b-83f7-4435-ab6c-bce6608f4bef/sist-en-22338-1996>

EUROPEAN STANDARD

EN 22338:1992

NORME EUROPÉENNE

EUROPÄISCHE NORM

July 1992

UDC 621.886.112

Descriptors: Fasteners, straight pins, dimensions, specifications, designation

English version

**Parallel pins, unhardened (ISO 2238:1986)**

Goupilles cylindriques non trempées (ISO 2238:1986)

Zylinderstifte, ungehärtet (ISO 2238:1986)

**iTeh STANDARD PREVIEW**  
**(standards.iteh.ai)**SIST EN 22338:1996<https://standards.iteh.ai/catalog/standards/sist/aebba94b-83f7-4435-ab6c-bce6608f4bef/sist-en-22338-1996>

This European Standard was approved by CEN on 1992-07-17. CEN members are bound to comply with the CEN/CENELEC Internal Regulations which stipulate the conditions for giving this European Standard the status of a national standard without any alteration.

Up-to-date lists and bibliographical references concerning such national standards may be obtained on application to the Central Secretariat or to any CEN member.

The European Standards exist in three official versions (English, French, German). A version in any other language made by translation under the responsibility of a CEN member into its own language and notified to the Central Secretariat has the same status as the official versions.

CEN members are the national standards bodies of Austria, Belgium, Denmark, Finland, France, Germany, Greece, Iceland, Ireland, Italy, Luxembourg, Netherlands, Norway, Portugal, Spain, Sweden, Switzerland and United Kingdom.

**CEN**European Committee for Standardization  
Comité Européen de Normalisation  
Europäisches Komitee für Normung

Central Secretariat: rue de Stassart, 36 B-1050 Brussels

## FOREWORD

In 1992, CEN Technical Committee CEN/TC 185 "Threaded and non threaded mechanical fasteners and accessories" the secretariat of which is held by DIN decided to submit the International Standard

ISO 2238:1986 - "Parallel pins, unhardened"

to the formal vote procedure.

The result was positive.

In the countries bound to implement this European Standard a national standard identical to this European standard shall be published at the latest by 1993-01-31 and conflicting national standards shall be withdrawn at the latest by 1993-01-31.

According to the CEN/CENELEC Common Rules the following countries are bound to implement this European Standard : Austria, Belgium, Denmark, Finland, France, Germany, Greece, Iceland, Ireland, Italy, Luxembourg, Netherlands, Norway, Spain, Portugal, Sweden, Switzerland and United Kingdom.

**iTeh STANDARD PREVIEW**  
(standards.iteh.ai)  
SIST EN 22338:1996  
<https://standards.iteh.ai/catalog/standards/sist/aebba94b-83f7-4435-ab6c-bce6608f4bef/sist-en-22338-1996>

### Endorsement notice

The text of the International Standard ISO 2338:1986 was approved by CEN as a European Standard without any modification.

---

# International Standard



# 2338

---

INTERNATIONAL ORGANIZATION FOR STANDARDIZATION • МЕЖДУНАРОДНАЯ ОРГАНИЗАЦИЯ ПО СТАНДАРТИЗАЦИИ • ORGANISATION INTERNATIONALE DE NORMALISATION

---

## Parallel pins, unhardened

*Goupilles cylindriques non trempées*

Second edition — 1986-11-01

**iTeh STANDARD PREVIEW**  
**(standards.iteh.ai)**

SIST EN 22338:1996

<https://standards.iteh.ai/catalog/standards/sist/aebba94b-83f7-4435-ab6c-bce6608f4bef/sist-en-22338-1996>

---

UDC 621.886.53

Ref. No. ISO 2338-1986 (E)

Descriptors : fasteners, pins (mechanics), straight pins, specifications, dimensions, designation.

## Foreword

ISO (the International Organization for Standardization) is a worldwide federation of national standards bodies (ISO member bodies). The work of preparing International Standards is normally carried out through ISO technical committees. Each member body interested in a subject for which a technical committee has been established has the right to be represented on that committee. International organizations, governmental and non-governmental, in liaison with ISO, also take part in the work.

Draft International Standards adopted by the technical committees are circulated to the member bodies for approval before their acceptance as International Standards by the ISO Council. They are approved in accordance with ISO procedures requiring at least 75 % approval by the member bodies voting.

International Standard ISO 2338 was prepared by Technical Committee ISO/TC 2, *Fasteners*.

This second edition cancels and replaces the first edition (ISO 2338:1972), of which it constitutes a technical revision. <https://standards.iteh.ai/catalog/standards/sist/aebba94b-83f7-4435-ab6c-bce66084bef/sist-en-22338-1996>

Users should note that all International Standards undergo revision from time to time and that any reference made herein to any other International Standard implies its latest edition, unless otherwise stated.

## Parallel pins, unhardened

### iTeh STANDARD PREVIEW (standards.iteh.ai)

#### 1 Scope and field of application

[SIST EN 22338:1996](#)

This International Standard specifies the characteristics of unhardened parallel pins, with metric dimensions and nominal diameters,  $d$ , from 0,6 to 50 mm inclusive.

<https://standards.iteh.ai/catalog/standards/sist/a6bba94b-83f7-4435-ab6c-bce66084bef/sist-en-22338-1996>

#### 2 References

ISO 2081, *Metallic coatings — Electroplated coatings of zinc on iron or steel.*

ISO 3269, *Fasteners — Acceptance inspection.*

ISO 4520, *Chromate conversion coatings on electroplated zinc and cadmium coatings.*

ISO 2338-2986 (E)

3 Dimensions

Surface roughness values in micrometres

Type A

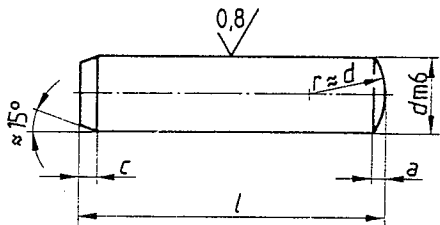

Type B

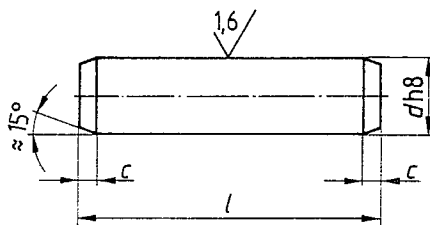

Type C

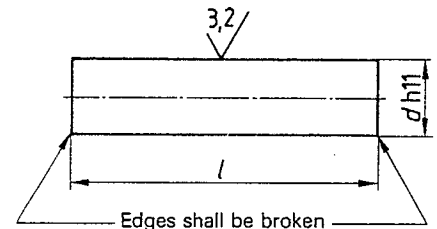

Dimensions in millimetres

d	0,6	0,8	1	1,2	1,5	2	2,5	3	4	5	6	8	10	12	16	20	25	30	40	50	
a	≈ 0,08	0,1	0,12	0,16	0,2	0,25	0,3	0,4	0,5	0,63	0,8	1	1,2	1,6	2	2,5	3	4	5	6,3	
c	≈ 0,12	0,16	0,2	0,25	0,3	0,35	0,4	0,5	0,63	0,8	1,2	1,6	2	2,5	3	3,5	4	5	6,3	8	
nom.	l <sup>1)</sup>																				
	min.	max.																			
2	1,75	2,25																			
3	2,75	3,25																			
4	3,75	4,25																			
5	4,75	5,25																			
6	5,75	6,25																			
8	7,75	8,25																			
10	9,75	10,25																			
12	11,5	12,5																			
14	13,5	14,5																			
16	15,5	16,5																			
18	17,5	18,5																			
20	19,5	20,5																			
22	21,5	22,5																			
24	23,5	24,5																			
26	25,5	26,5																			
28	27,5	28,5																			
30	29,5	30,5																			
32	31,5	32,5																			
35	34,5	35,5																			
40	39,5	40,5																			
45	44,5	45,5																			
50	49,5	50,5																			
55	54,25	55,75																			
60	59,25	60,75																			
65	64,25	65,75																			
70	69,25	70,75																			
75	74,25	75,75																			
80	79,25	80,75																			
85	84,25	85,75																			
90	89,25	90,75																			
95	94,25	95,75																			
100	99,25	100,75																			
120	119,25	120,75																			
140	139,25	140,75																			
160	159,25	160,75																			
180	179,25	180,75																			
200	199,25	200,75																			

iTeh STANDARD PREVIEW  
(standards.iteh.ai)

SIST EN 22338:1996

<https://standards.iteh.ai/catalog/standards/sist/aebba94b-83f7-4435-ab6c-bce6608f4bf/sist-en-22338-1996>

Range

of

commercial

lengths

1) For nominal lengths above 200 mm, steps of 20 mm.