



Standard Specification for Lap-Joint Type Flange Adapters for Polyethylene Pressure Pipe in Nominal Pipe Sizes $\frac{3}{4}$ in. to 65 in.¹

This standard is issued under the fixed designation F2880; the number immediately following the designation indicates the year of original adoption or, in the case of revision, the year of last revision. A number in parentheses indicates the year of last reapproval. A superscript epsilon (ϵ) indicates an editorial change since the last revision or reapproval.

Table 5 has been included, editorial changes were made throughout, and the year date was changed on July 22, 2014.

1. Scope ~~Scope~~*

1.1 This specification covers the polyethylene material and dimensions applicable to flange adapters (FAs) used to connect polyethylene pipes to other flanged pipe and components such as valves and flanged fittings. This standard describes outside diameter controlled polyethylene (PE) pipe flange adapters (FAs) in diameters ranging from $\frac{3}{4}$ in. through 65 in. (12 mm through 1600 mm). The flange adapters may be manufactured by various methods including injection molding, compression molding, and machining from billet or thick-wall polyethylene pipe.

1.2 The flange adapter (FA) is the principal component of the lap-joint flanged assembly widely used for several decades in low-pressure to high-pressure polyethylene pipe systems for all types of pressurized flow (gas and liquid) applications. The flange adapter's physical shape consists of the pipe-like Neck which is monolithic with its Hub. The Neck is intended to be butt-fused or fusion coupled to the pipe-line; while the Hub face is intended to affect the seal when subjected to the distributed load from the back up ring with its properly torqued bolt-studs and nuts.

NOTE 1—Polyethylene pipe flange adapters with slip on bolt rings are intended for use being bolted to each other or to be bolted to metal flanges having (primarily) Class 150 bolt hole patterns such as those presented in metal flange standards ASME B16.5, ASME B16.47 and AWWA C207.

1.3 The values stated in inch-pound units are to be regarded as standard. The values given in parentheses are mathematical conversions to SI units that are provided for information only and are not considered standard.

1.4 The use of gaskets and gasket selection are often an integral component of the flange adapter assembly. See the Plastic Pipe Institute Technical Note TN-38 for more information regarding HDPE flanged joints.

1.5 *This standard does not purport to address all of the safety concerns, if any, associated with its use. It is the responsibility of the user of this standard to establish appropriate safety and health practices and determine the applicability of regulatory limitations prior to use.*

2. Referenced Documents

2.1 ASTM Standards:²

[D2122 Test Method for Determining Dimensions of Thermoplastic Pipe and Fittings](#)

[D2513 Specification for Polyethylene \(PE\) Gas Pressure Pipe, Tubing, and Fittings](#)

[D2837 Test Method for Obtaining Hydrostatic Design Basis for Thermoplastic Pipe Materials or Pressure Design Basis for Thermoplastic Pipe Products](#)

[D3035 Specification for Polyethylene \(PE\) Plastic Pipe \(DR-PR\) Based on Controlled Outside Diameter](#)

[D3261 Specification for Butt Heat Fusion Polyethylene \(PE\) Plastic Fittings for Polyethylene \(PE\) Plastic Pipe and Tubing](#)

[D3350 Specification for Polyethylene Plastics Pipe and Fittings Materials](#)

[F714 Specification for Polyethylene \(PE\) Plastic Pipe \(DR-PR\) Based on Outside Diameter](#)

[F2206 Specification for Fabricated Fittings of Butt-Fused Polyethylene \(PE\) Plastic Pipe, Fittings, Sheet Stock, Plate Stock, or Block Stock](#)

[F3034 Specification for Billets made by Winding Molten Extruded Stress-Rated High Density Polyethylene \(HDPE\)](#)

¹ This specification is under the jurisdiction of ASTM Committee F17 on Plastic Piping Systems and is the direct responsibility of Subcommittee F17.10 on Fittings. Current edition approved July 22, 2014; May 1, 2014. Published July 2014. Originally approved in 2011. Last previous edition approved in 2011 as F2880-11-11a. DOI: 10.1520/F2880-14A.10.1520/F2880-14.

² For referenced ASTM standards, visit the ASTM website, www.astm.org, or contact ASTM Customer Service at service@astm.org. For *Annual Book of ASTM Standards* volume information, refer to the standard's Document Summary page on the ASTM website.

*A Summary of Changes section appears at the end of this standard

2.2 ASME Standards:³

B16.5 “Pipe Flanges and Flanged Fittings”

B16.47 “Large Diameter Steel Flanges: NPS 26 through NPS 60” Class #150 – Series A

B36.10M Welded and Seamless Wrought Steel Pipe

B36.19M Stainless Steel Pipe

2.3 AWWA Standards:⁴

C207 “Standard for Steel Pipe Flanges for Waterworks Service, Sizes 4 In. Through 144 In. (100 mm Through 3,600 mm) ; Class #150 /Series B, D & E.

C901 “Standard for Polyethylene (PE) pressure pipe and tubing, ½ ” through 3” for Water Service.”

C906 Standard for Polyethylene (PE) Pressure Pipe and Fittings, 4 In. (100 mm) Through 63 In. (1,600 mm), for Water Distribution and Transmission

M55 Polyethylene Pipe - Design and Installation

2.4 NSF Standards:⁵

NSF/ANSI Standard No. 14 for Plastic Piping Components and Related Materials

NSF/ANSI Standard No. 61 for Drinking Water System Components—Health Effects

2.5 PPI Documents:⁶

TN-38 “Bolt Torque for Polyethylene Flanged Joints”

TR-3 “Policies and Procedures for Developing Hydrostatic Design Basis (HDB), Pressure Design Basis (PDB), Strength Design Basis (SDB), and Minimum Required Strength (MRS) Ratings for Thermoplastic Piping Materials or Pipe

TR-4 “HDB/HDS/SDB/PDB/MRS Listed Materials”

PPI Handbook of Polyethylene Pipe and Fittings

3. Terminology

3.1 Definitions of Terms Specific to This Standard:

3.1.1 *billet, n*—a mass formed from a single polyethylene compound in the approximate shape of a thick-walled cylindrical shell (see Specification F3034).

3.1.2 *dimension ratio (DR)*—The ratio of a pipe’s specified nominal outside diameter to its specified minimum wall thickness. DR as applied to Flange Adapters is Neck OD ÷ neck minimum wall.

3.1.3 *DIPS*—Ductile-Iron Pipe Size; the outside diameter (OD) of plastic pipe that matches the nominal standard diameters of metal ductile iron, or, cast-iron pipes; also commonly referred to as DIOD, Ductile Iron Outside Diameter, previously known as CIOD or cast-iron OD.

ASTM F2880-14

<https://standards.iteh.ai/catalog/standards/sist/aa5ac402-bd82-4d47-ac48-7aea42542b77/astm-f2880-14>

³ Available from American Society of Mechanical Engineers (ASME), ASME International Headquarters, Three Park Ave., New York, NY 10016-5990, <http://www.asme.org>.

⁴ Available from American Water Works Association (AWWA), 6666 W. Quincy Ave., Denver, CO 80235, <http://www.awwa.org>.

⁵ Available from NSF International, P.O. Box 130140, 789 N. Dixboro Rd., Ann Arbor, MI 48113-0140, <http://www.nsf.org>.

⁶ Available from Plastics Pipe Institute (PPI), 105 Decker Court, Suite 825, Irving, TX 75062, <http://www.plasticpipe.org>.

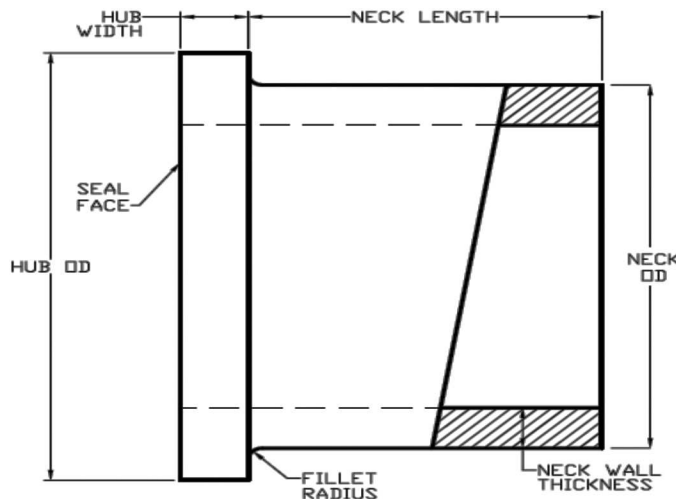

FIG. 1 Polyethylene Flange Adapter Geometry

3.1.4 *flange adapter*—One component of the two piece lap-joint flange assembly; It is a one piece polyethylene device whose geometry consists of two shapes: the wide, circular, seal-face disk, with central hole, which transitions along its length into pipe of smaller diameter and wall thickness, matched to the pipe-main to which it is to be joined. (Refer to Fig. 1).

3.1.5 *Hub*—The disk ring, or collar, extending radially outward from the pipe OD at the pipe termination.

3.1.6 *Hydrostatic design stress (HDS)*—The maximum allowable hoop stress in the pipe wall for pipe that is subjected to sustained long-term hydrostatic pressure. The hydrostatic design stress is determined by multiplying the hydrostatic design basis by the PPI recommended design factor for water service. HDS ratings for PE materials are published by PPI in TR-4.

3.1.7 *IPS*—Iron Pipe Size (steel pipe) outside diameters; replaced with nominal pipe sizes (NPS) per as listed with the plastic pipe standards and B36.10M and B36.19M.

3.1.8 *lap-joint flange ring*—the loose metal ring that transfers the load from the bolts through the hub to the seal face.

3.1.9 *neck*—The long barrel of the flange adapter with OD and wall thickness matched to the pipeline dimensions. The neck length must be sufficient for fusion joining in the fusion machine used.

3.1.10 *seal face*—The front of the Hub, which contacts the mating flange, which radially confines fluid pressure by compressive stress when subjected to distributed load from torqued bolts.

3.1.11 *residual sealing stress*—The long-term compressive stress intensity from the load distributed over the seal face area which is in contact with a mating flange.

3.1.12 *pressure rating (PR)*—maximum sustained internal water pressure at 80°F (27°C) and lower service temperature with specified maximum allowances for pressure surges.

$$PR = \frac{2 \times HDS \times F_T}{(DR - 1)} \quad (1)$$

where:

HDS = hydrostatic design stress for water at 73°F, psi (kPa)

F_T = temperature factor (1.00 for 80°F (27°C) and lower water service temperature)

DR = dimension ratio. Surge pressure allowances are applied above the sustained internal pressure and are integral to the working pressure rating.

4. Polyethylene Materials for Flange

4.1 *General*—Table 1 contains the list of polyethylene materials that are acceptable for use in manufacture of the flange adapters. Usually, the flange adapter material has the same material designation as the specified polyethylene pipeline material, for the purpose of chemical resistance and heat-fusion joining. Commercial virgin PE material compounds shall meet Table 1 physical properties, Specification D3350 requirements and shall be classified per Specification D3350 as shown in Table 1. The PE material compound shall have HDB ratings at 73°F (23°C) and at 140°F (60°C) and HDS ratings at 73°F (23°C) determined in accordance with Test Method D2837 and PPI TR-3.

4.2 *Color*—The PE material in the pipe shall contain color and ultraviolet (UV) stabilizer meeting the requirements of Code C or E per Specification D3350. Code C material shall contain between 2 to 3 percent carbon black by weight.

4.3 *Rework*—Clean rework pipe-grade polyethylene material derived from pipe and or fittings production by the same manufacturer are acceptable as part of a blend with virgin material for the production of flange adapters provided that (a) the cell

TABLE 1 Property Values and Specification D3350 Cell Classification for Materials

Property	Materials Designation Code								
	PE2606	PE2706	PE2708 ^A	PE3608 ^A	PE3708	PE3710	PE4608	PE4708	PE4710 ^A
	Property Values								
HDB at 140°F (60°C) per ASTM D 2837 and PPI TR-3, psi (MPa)	C	C	C	C	C	C	C	C	C
HDS at 73°F (23°C) per ASTM D 2837 and PPI TR-3, psi (MPa)	630 (4.6)	630 (4.6)	800 (5.5)	800 (5.5)	800 (5.5)	1000 (6.9)	800 (5.5)	800 (5.5)	1000 (6.9)
	Specification D3350 Cell Classification ^B Values								
Density (natural base resin)	2	2	2	3	3	3	4	4	4
Melt Index	3-4	3-4	3-4	4	4	4	4	4	4
Flexural Modulus	3-4	3-4	3-4	≥4	≥4	≥4	≥4	≥4	≥5
Tensile Strength at Yield	≥3	≥3	≥3	≥4	≥4	≥4	≥4	≥4	≥4
SCG Resistance	6	7	7	6	7	7	6	7	7
Hydrostatic Strength Classification	3	3	3	4	4	4	4	4	4
Color and UV Stabilizer	C or E	C or E	C or E	C or E	C or E	C or E	C or E	C or E	C or E

^AHDB at 140°F (60°C) per ASTM D2837 and PPI TR-3 at 140°F required; contact manufacturer for listed value.

^BSpecification D3350 cell classification values reflect typical property values for numerous lots of the material and do not include variability in testing or manufacturing tolerances. Values for individual material lots can vary from typical values. Contact the manufacturer for information about variability in testing and material manufacturing tolerances.

classification or materials designation code of the rework material is the same as the virgin material compound to which it is added, and (b) the rework materials complied with applicable requirements as virgin materials.

4.4 *Potable Water*—Materials used for products intended for use in the transport of potable water shall be evaluated and certified as safe for this purpose by a testing agency acceptable to the local health authority. The evaluation shall be in accordance with requirements for chemical extraction, taste, and odor that are no less restrictive than those included in NSF/ANSI Standard No. 14 or NSF/ANSI Standard No. 61. The seal or mark of the laboratory making the evaluation should be included on the piping per 7.1.3.7.

5. Flange Adaptor Dimensions and Working Pressure Ratings

5.1 *General*—This standard describes 10 dimension ratios (DR's) for nominal flange adaptor sizes ranging from ¾ in. through 65 in. (12 mm through 1 600 mm). Flange adaptor outside diameters (ODs) conform to the outside diameter dimensions of iron pipe sizes (IPS), or to equivalent outside diameters for ductile-iron (DI) pipe (DIPS). Polyethylene flange adaptors are classified by dimension ratios (DR's) ranging from 7.0 to 32.5. The resultant combinations of PE material designations and DR's define flange adaptors with pressure ratings ranging from 40 to 333 psig (276 to 2 299 kPa) when conveying water at 80°F (27°C) and lower temperatures. Use at temperatures above 80°F (27°C) up to 140°F (60°C) is acceptable at pressure ratings that are appropriately reduced for the service temperature.

5.2 *Outside diameters*—The neck Outside Diameter (OD) of the flange adaptor measured at 73.4 ± 3.6°F (23 ± 2°C) shall conform to the applicable OD dimension requirements specified in the related polyethylene pipe standards : Specifications F714, D2513, D3035, and AWWA C901 and C906. Measurements shall be made according to the methods specified in Test Method D2122. The tolerance on outside diameter shall not exceed ±0.45 percent of the average outside diameter, as presented in the tables for NPS 4-in. and larger.

5.2.1 *Special Sizes*—Where existing system conditions or special local requirement make other diameters or dimension ratios necessary, other sizes or dimension ratios, or both, shall be acceptable for engineered applications when mutually agreed upon by the customer and the manufacturer, if the flange adaptor is manufactured from plastic compounds meeting the material requirements of this specification, and the strength and design requirements are calculated on the same basis as those use in this specification. For diameters not shown in Table 2, Table 3 or Table 4, the tolerance shall be the same percentage as that shown in the corresponding tables for the next smaller listed size.

TABLE 2 Minimum Neck Length, in. for IPS and DIPS Flange Adaptors

NOTE 1—Minimum Neck Length = Nominal Fusion Machine Clamp width + stop-protursion + 1 in. + Back Up Ring
Neck Length may be longer; consult Flange Adaptor manufacturer.

Nominal Pipe Size	Minimum Neck Length				
	IPS	DIPS	DR 7	DR 9	DR 11 -DR 32.5
¾ in.	X		2.88	2.88	2.88
1 in.	X		3.75	3.75	3.75
1 ¼ in.	X		3.88	3.88	3.88
1 ½ in.	X		4.00	4.00	4.00
2 in.	X		4.25	4.25	4.25
3 in.	X		4.50	4.50	4.50
4 in.	X	X	5.38	5.38	6.00
5 in.	X		6.50	6.50	6.50
6 in.	X	X	6.75	6.75	6.75
8 in.	X	X	6.50	6.13	6.13
10 in.	X	X	6.50	6.13	6.13
12 in.	X	X	7.38	7.38	7.75
14 in.	X	X	8.13	7.75	7.75
16 in.	X	X	8.44	8.00	8.00
18 in.	X	X	8.50	8.13	8.13
20 in.	X	X	8.94	8.38	8.38
22 in.	X		9.03	8.63	8.63
24 in.	X	X	9.50	8.69	8.69
26 in.	X		10.38	10.13	10.13
28 in.	X		10.63	10.25	10.13
30 in.	X	X	10.88	10.38	10.25
32 in.	X		11.13	10.88	10.75
34 in.	X		12.13	11.50	10.88
36 in.	X	X	13.13	12.19	11.31
1000mm / 40 in.	X		*	*	12.63
42 in.	X	X	*	*	12.63
48 in.	X	X	*	*	12.88
54 in.	X		*	*	20.13
1400mm /55 in.			*	*	20.50
63 in.	X		*	*	20.50
65 in.	X		*	*	21.50